

NO.	REVISION	DATE
FILE	DRAWN	ISSUED
17759x101	SKJ	06/19/2020

SHEET TITLE
Furniture, Fixture and Equipment Plan

SHEET NUMBER

38.02

Permit Documents

- GENERAL NOTES
 THIS SHEET ONLY
1. VERIZON MUST COMPLY WITH ALL FEDERAL, STATE AND LOCAL ACCESSIBILITY REQUIREMENTS FOR ALL EMPLOYEES AND THE PUBLIC WITH RESPECT TO ALL FURNITURE, FIXTURES, DISPLAYS AND SIGNAGE WHICH THEY PROVIDE.
 2. ALL DIMENSIONS ARE FINISH DIMENSIONS UNLESS NOTED OTHERWISE.
 3. PROVIDE CONTINUOUS 3/4" x 20" FIRE RATED PLYWOOD BLOCKING WITH BOTTOM AT 70" A.F.F. BEHIND SHELF AND MONITOR MOUNTED TO WALL - SEE TYPICAL WALL BLOCKING DETAILS ON SHEET 36.01 FOR ADDITIONAL INFORMATION.
 4. PROVIDE BLOCKING FOR WALL CASE FIXTURES SEE DETAILS ON SHEET 36.01 FOR ADDITIONAL INFORMATION.
 5. REFER TO SHEET 10.02 FOR ADA FIXTURE MOUNTING HEIGHTS.

- KEYNOTES
 THIS SHEET
1. DIGITAL DISPLAY - 15" FROM WALL TO ADJ WALL TO CENTER OF FIXTURE TO BE PLACED CENTERED WITHIN 6" FROM WALL. IF CONDITIONS PERMIT IT, ENSURE PROPER CLEARANCE FOR VIEWING SHIRT/DROP. IF THERE IS ANY DIGITAL DISPLAY (MONITOR) ZONE "B-G" (BUSINESS-GENERAL) DISPLAY WHICH FACES EXTERIOR SHALL BE "STATIONARY" DISPLAY (NO MONITOR OR MOVING IMAGES) DISPLAY WHICH FACES INTERIOR SALES AREA SHALL BE "STATIONARY" DISPLAY.
 2. SMART BOARD DISPLAY LCD MONITOR - CENTER @ 64" A.F.F. - SEE DETAIL 5 & 47 36.01 & ELECTRICAL DRAWINGS FOR ADDITIONAL INFORMATION.
 3. FLOOR COPIER (EQ2).
 4. SHREDDING BIN (EQ120).
 5. ADA COMPLIANT POS STATION, COUNTER HEIGHT @ 34" A.F.F. (max.).
 6. UNDER CABINET TASK LIGHTING @ WORKSTATION, TYP.
 7. SLATWALL / PEGBOARD (EQ311) TRIAD: SLATWALL TO BE PROVIDED ON THE ENTIRE WALL PERIMETER WITHIN THE INVENTORY SPACE. 8"W x 4'-0" GRAY MELAMINE SLATWALL w/ALUMINUM INSERTS AND PEG HOOKS. SLATWALL FROM FINISHED FLOOR TO 24" BELOW FINISHED CEILING. VERIFY CEILING HEIGHT PRIOR TO ORDERING. GROOVES ARE 3" o.c. PROVIDED & INSTALLED BY GENERAL CONTRACTOR.
 8. PROVIDE SIGN STATING "NO SMOKING WITHIN 25' OF ENTRANCE".
 9. LADDER AND HANGER (EQ420, EQ421).
 10. FLOOR MOUNTED MOP SINK WITH NEW STAINLESS STEEL MOP RACK ABOVE (EQ430) - SEE PLUMBING DRAWINGS FOR ADDITIONAL INFORMATION.
 11. WALL MOUNTED SECURITY/EMPLOYEE SAFETY MONITOR - CENTER @ 64" A.F.F. SEE 5 & 47 36.01 & ELECTRICAL DRAWINGS FOR ADDITIONAL INFORMATION.
 12. CISCO IP DOCK.
 13. INVOICER CHARGER AND PROGRAMMER.
 14. 18" x 24" LOCKING BULLETIN BOARD (EQ030).
 15. TABLET CHARGING STATION (EQ355).
 16. 48" x 30" DESK (FN411).
 17. MICROWAVE (EQ220).
 18. 4' x 3' SMALL BULLETIN BOARD (EQ020).
 19. DUAL ACCESS ELECTRONIC SAFE (EQ322).
 20. ADA COMPLIANT BREAK AREA SINK - SEE PLUMBING DRAWINGS FOR MORE INFORMATION.
 21. COUNTERTOP WATER FILTRATION SYSTEM (EQ250) - SEE PLUMBING DRAWINGS FOR ADDITIONAL INFORMATION.
 22. COFFEE MAKER (EQ230).
 23. SAFE - INVENTORY ROOM (EQ320).
 24. HAND SANITIZER (EQ851).
 25. MEDICAL CABINET (EQ242) BOTTOM AT 50" A.F.F.
 26. HAND SOAP DISPENSER (EQ850).
 27. 36" LATERAL FILE CABINET.
 28. REFRIGERATOR (EQ210).
 29. WALL MOUNTED COAT RACK (EQ241).
 30. 12" WIDE x 15" DEEP (MULTI-TIER) EMPLOYEE LOCKERS (EQ011).
 31. REFUSE BIN (EQ052) w/REFUSE BIN LID (EQ052a).
 32. RECYCLING BIN (EQ050, EQ051) w/RECYCLING BIN LID (EQ050a, EQ051a).
 33. 6' x 4' LARGE BULLETIN BOARD (EQ021).
 34. TABLE AND CHAIRS.

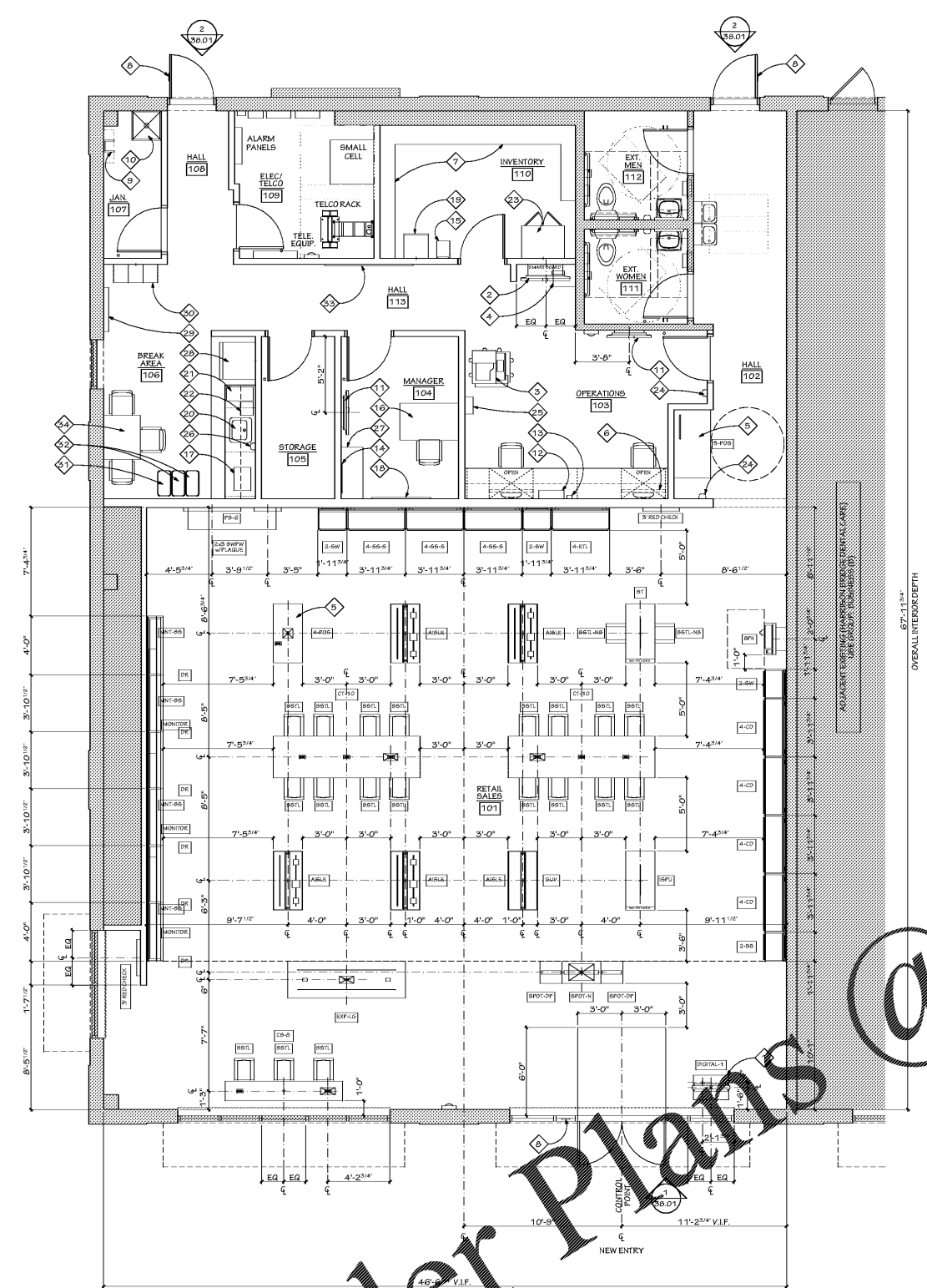

True
 NORTH
1 FIXTURE PLAN
 SCALE: 1/4" = 1'-0"
 0 2' 4' 8'

Order Plans @

WWW.LDILine.com