

SPACE	OCC. GROUP	OCC. LOAD FACTOR	OCCUPIED AREA	OCC. AREA Type	OCC. LOAD	Occupant Load Calculated	Area Type	OCC Load Check (Calc vs. Transcribed)
STORAGE AREA	S1	500 SF	47048.7 SF	G ROBS	94	94.10	Building Common Area	-5.10

ARRANGEMENT OF EXITS

	REQ. # EXITS	PROV. # EXITS	ALLOWABLE TRAVEL DISTANCE	ACTUAL TRAVEL DISTANCE	REQ. DIST. BETWEEN EXIT DOORS	ACTUAL DISTANCE SHOWN ON PLANS
LOBBY	1	1	100 FT	54.07'	N/A	N/A
STORAGE AREA	2	2	400 FT	332.07'	1000.0'	1417.0'

LIFE SAFETY LEGEND

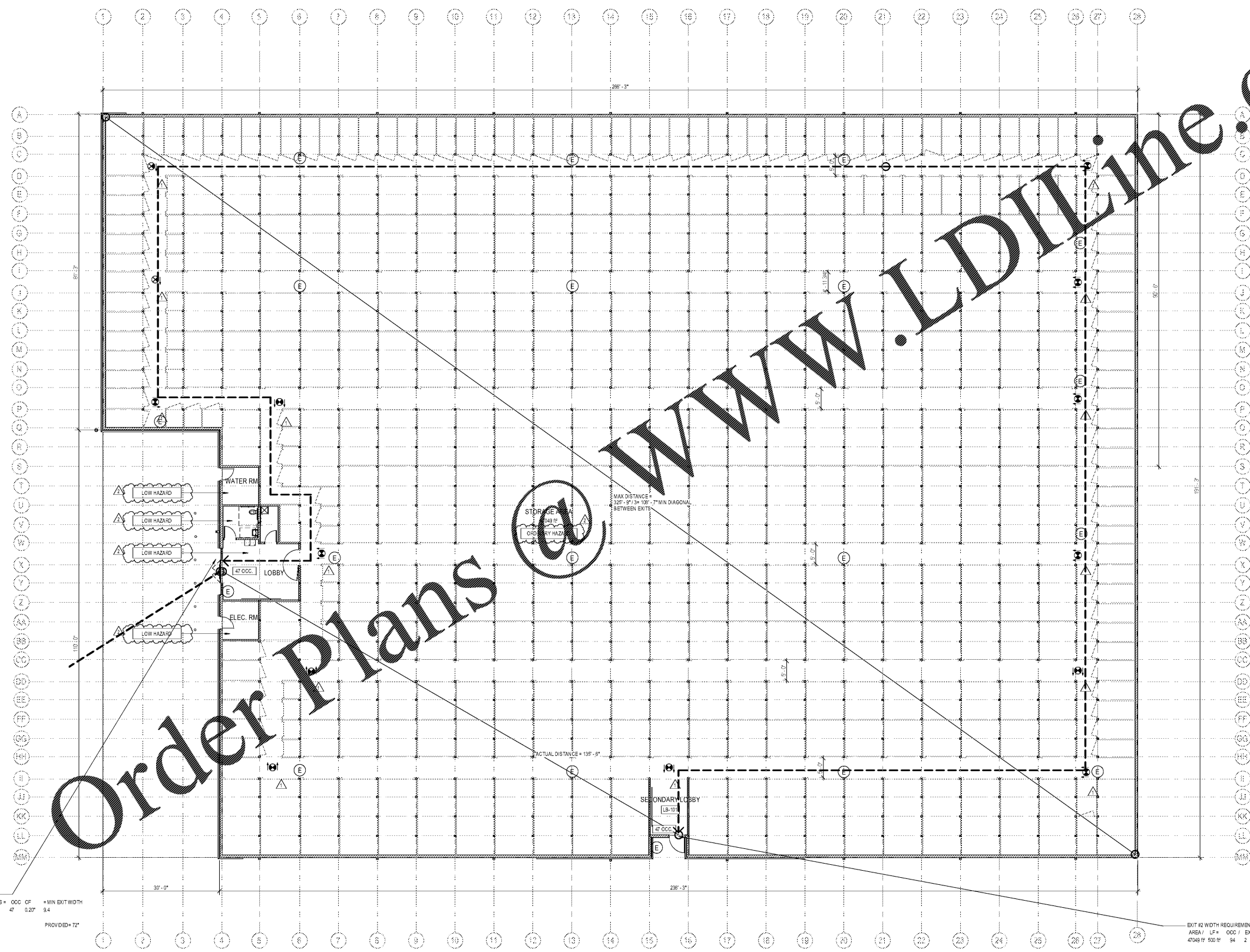
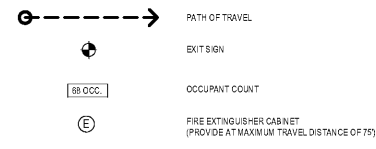

EXIT #1 WIDTH REQUIREMENTS
 AREA / LF+ OCC / EXITS = OCC OF +MIN EXIT WIDTH
 47048 SF 500 SF 94 2 47 0.20' 9.4
 PROVIDED= 72"

EXIT #2 WIDTH REQUIREMENTS
 AREA / LF+ OCC / EXITS = OCC OF +MIN EXIT WIDTH
 47048 SF 500 SF 94 2 47 0.20' 9.4
 PROVIDED= 36"

1 EGRESS PLAN
 SCALE: 3/32" = 1'-0"
 N

NOT FOR CONSTRUCTION

COPYRIGHT
 THESE PLANS ARE AN INSTRUMENT OF SERVICE AND ARE THE PROPERTY OF GALLOWAY, AND MAY NOT BE DUPLICATED, REPRODUCED, OR REPRODUCED WITHOUT THE WRITTEN CONSENT OF GALLOWAY. COPYRIGHTS AND INFRINGEMENTS WILL BE ENFORCED AND PROSECUTED.

Public Storage

PUBLIC STORAGE
 SEMINOLE COUNTY, FL
 PS#28091
 2431 S. Orange Blossom Trail
 Apopka, FL

#	Date	Issue/Description
1	03/02/2020	PERMIT SUBMITTAL
2	04/24/2020	2ND PERMIT SUBMITTAL
3	06/11/2020	3RD PERMIT SUBMITTAL

Project No: PS000991
 Drawn By: AT
 Checked By: KKS

CODE ANALYSIS / EGRESS PLAN