

Plotted By: Anderson, Sarah - Sheet Set: 147654001 - Seminole Public Storage - PAVING, GRADING AND DRAINAGE PLAN - June 11, 2020 06:28:16pm - R:\VRE_LDEV\147654001 - Public Storage - Seminole County\CAD\PerSheets\C-200 PAVING, GRADING AND DRAINAGE PLAN - 147654001.dwg
 This document, together with the concepts and designs presented herein, is an instrument of service, is intended only for the specific purpose and client for which it was prepared. Reuse of any portion of this document without written authorization and completion by Kimley-Horn and Associates, Inc. shall be without liability to Kimley-Horn and Associates, Inc.

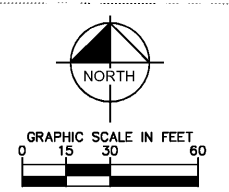

ANN E. POLASEK, TRUSTEE
 JOHN C. POLASEK, TRUSTEE
 O.A. 589, PG. 102

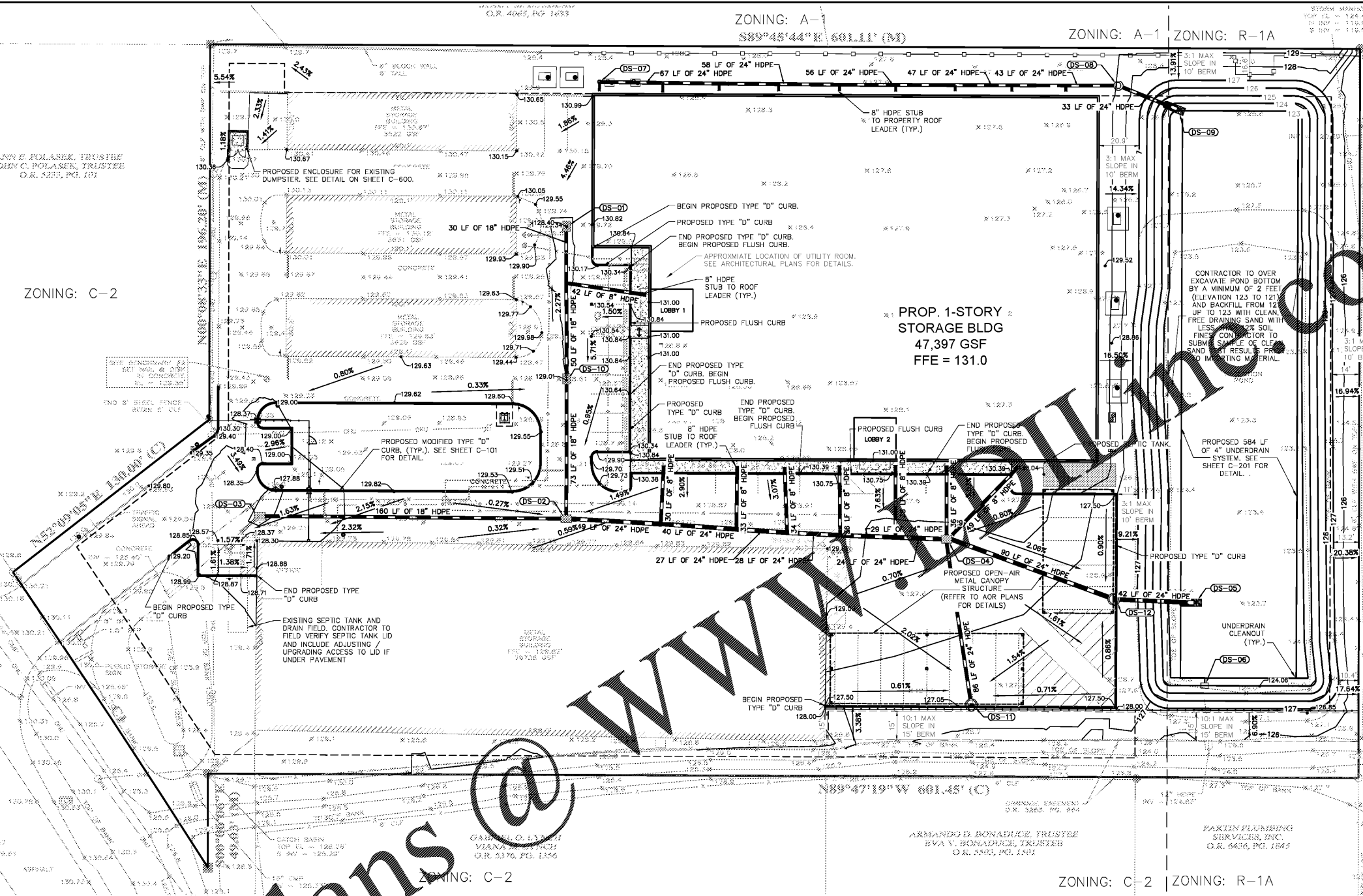

Order Plans @

NOTES

- CONTRACTOR TO CONSTRUCT DRAINAGE STRUCTURES WITH USF GRATES, RIMS AND COVERS AS CALLED OUT OR APPROVED EQUAL. SHOP DRAWINGS ARE TO BE PROVIDED TO ENGINEER FOR APPROVAL PRIOR TO ANY CONSTRUCTION.
- CONTRACTOR TO REFER TO FDOT DESIGN STANDARD (AND NOT LIMITED TO) INDEXES 200, 201, 210, 211, 214, 232 & 233 FOR MANHOLE, INLET AND GRATE SPECIFICATIONS.
- ALL DRAINAGE STRUCTURES SHALL BE CONSTRUCTED WITH (4) SIDED BEARING HEAVY DUTY H-20 RATED TRAFFIC RIMS AND GRATES.
- CONTRACTOR TO VERIFY ALL EXISTING UTILITY RINGS AND COVERS ON SITE ARE HEAVY DUTY TRAFFIC RATED. CONTRACTOR TO REPLACE DEFICIENT RINGS AND COVERS WITH HEAVY DUTY TRAFFIC RATED RINGS AND COVERS. CONTRACTOR TO ADJUST RIM ELEVATIONS TO MATCH PROPOSED FINISHED GRADE OF ANY EXISTING UTILITIES TO REMAIN THAT CHANGE IN ELEVATION DURING CONSTRUCTION.
- ALL CLEANOUT COVERS SHOULD BE RATED FOR HEAVY DUTY TRAFFIC.
- ALL EXISTING PAVEMENT AND CONCRETE TO BE JOINED SHALL BE SAWCUT.
- SIDEWALKS AND CROSSWALKS SHALL NOT EXCEED 2% CROSS SLOPE NOR 5% LONGITUDINALLY. GRADES IN ACCESSIBLE PARKING SPACES SHALL NOT EXCEED 2% IN ANY DIRECTION. IN CASES OF SIDEWALK AT BUILDING ENTRANCES, GRADES SHALL NOT EXCEED 2% IN ANY DIRECTION. ACCESSIBLE CURB RAMPS SHALL NOT EXCEED 6" IN LENGTH, 6" RISE, AND 1:12 SLOPE. LANDINGS ASSOCIATED WITH RAMPS AND AT CHANGES IN DIRECTION SHALL BE MINIMUM 60"X60" AND SHALL NOT EXCEED 2% SLOPE IN ANY DIRECTION. MINIMUM GRADE ON SIDEWALKS IN THE FIRST TEN (10) FEET ADJACENT TO BUILDINGS SHALL BE 1.5% MINIMUM.
- SPOT ELEVATIONS ARE AT FACE OF CURB AND EDGE OF PAVEMENT UNLESS OTHERWISE NOTED.
- EXISTING GRADES AND DRAINAGE HAVE BEEN TAKEN FROM A SURVEY PREPARED BY LEADING EDGE LAND SERVICES, INC., DATED JUNE 17, 2019. THE ELEVATIONS SHOWN HEREON ARE BASED ON THE NORTH AMERICAN VERTICAL DATUM (NAVD) OF 1988. ORANGE COUNTY BENCHMARK NUMBER L991045, A 2-1/2" ORANGE COUNTY CONTROL DISK IN CENTERLINE OF HEADWALL, 30 FEET EAST OF OVERLAND ROAD, 120 FEET WEST OF CENTERLINE OF ORANGE BLOSSOM TRAIL, PUBLISHED ELEVATION 129.70 FEET. SITE BENCHMARKS ARE AS SHOWN.
- HDPE STORM PIPE-CONTRACTOR IS RESPONSIBLE FOR OBTAINING THE STORM DRAINAGE PIPE INSTALLATION MANUAL AND SPECIFICATIONS AND COMPLYING WITH ALL MANUFACTURER'S INSTALLATION PROCEDURES AND REQUIREMENTS. TESTING OF BACKFILL MATERIAL AND COMPACTION OF BACKFILL MATERIAL IS THE CONTRACTOR'S RESPONSIBILITY.
- ALL DRAINAGE PIPE JOINTS SHALL BE FILTER FABRIC WRAPPED PER FDOT INDEX #280. ALL DRAINAGE PIPE JOINTS NEED TO BE FILTER FABRIC WRAPPED REGARDLESS OF MATERIAL.
- EXISTING STORM INLETS AND PIPES ON PROPERTY TO BE JETTED AND CLEANED PRIOR TO ENGINEER'S ACCEPTANCE OF SYSTEM.
- CONTRACTOR SHALL COORDINATE PAVING IMPROVEMENTS TO AVOID THE MARKS FROM CONSTRUCTION ACTIVITY. FINAL PAVING SHALL BE AS SMOOTH AS POSSIBLE AND FREE FROM ANY MARKS, SCRAPES, GOUGES, THE MARKS, ETC. CAUSED DURING CONSTRUCTION ACTIVITY.
- CONTRACTOR TO ENSURE POSITIVE RUNOFF FROM THE BUILDING. PAVING SHALL BE FREE OF PONDING AND MAINTAIN POSITIVE OUTFALL TO THE DRAINAGE SYSTEM. CONTRACTOR SHALL FIELD VERIFY EXISTING DRAINAGE PATTERNS AND THE IN GRADES AND ALERT OWNER AND ENGINEER SHOULD ANY CONFLICTS ARISE.
- DURING CONSTRUCTION AND AFTER FINAL GRADING, NO SURFACE WATER RUNOFF MAY BE DIRECTED TO ADJACENT PROPERTIES, AND ALL SURFACE WATER RUNOFF MUST BE ROUTED TO APPROVED DRAINAGE FACILITIES OR BE RETAINED ON SITE. ALL RUNOFF FROM THE SITE, BOTH DURING AND AFTER CONSTRUCTION, MUST BE FREE OF POLLUTANTS, INCLUDING SEDIMENT, PRIOR TO DISCHARGE.
- ALL SLOPES STEEPER THAN 6:1 SHALL BE SODDED.
- ALL SIDEWALKS BEHIND AND ADJACENT TO LANDSCAPE ISLANDS WILL BE SLOPED TO PREVENT STANDING WATER ALONG THE LANDSCAPE ISLAND. CONTRACTOR TO REFER TO THE ARCHITECTURAL PLANS FOR BUILDING EXTERIOR WALL AND SIDING MATERIAL TO DETERMINE THE GRADING FROM BUILDING FFE FOUNDATION AND IF AN INSPECTION STRIP IS REQUIRED.

- BLOCK WITHOUT COVERING = 0 INCHES
- WOOD SIDING = 6 INCHES ABOVE GRADE OR 2 INCHES ABOVE CONCRETE AND PAVED AREAS.
- STUCCO = CMU WITH TRUE STUCCO FINISH 5/8 INCH THICK ON CMU = 6 INCHES
- STUCCO (ADJACENT TO CONCRETE OR PAVED AREA) = 2 INCHES
- LESS THAN 5/8 INCH THICK STUCCO (CEMENTITIOUS COATING) DOES NOT REQUIRE AN INSPECTION STRIP.
- WOOD FRAME STUCCO = 6 INCHES ABOVE GRADE OR 4 INCHES ABOVE CONCRETE OR PAVED AREAS.
- WOOD SIDING = 6 INCHES ABOVE GRADE OR 2 INCHES ABOVE CONCRETE OR PAVED AREAS.
- WOOD FRAME = 6 INCHES ABOVE GRADE AND 4 INCHES ABOVE PAVED OR PAVED SURFACE.
- FOR ALL OTHER SURFACES, CONTRACTOR TO CONTACT BUILDING DEPARTMENT AND MANUFACTURER

DRAINAGE STRUCTURE TABLE			
STRUCTURE	TYPE	RIM EL. (FT.)	INV. EL. (FT.)
DS-01	TYPE C	RIM: 128.40	INV. EL: 128.70(0)
DS-02	TYPE C	RIM: 129.50	INV. EL: 129.80(0) EX. INV. 129.80(0) PK. INV. 124.30(5)
DS-03	TYPE C	RIM: 127.80	INV. EL: 128.00(0) EX. INV. 128.00(0) PK. INV. 124.30(5)
DS-04	TYPE C	RIM: 128.51	INV. EL: 128.80(0) EX. INV. 128.80(0) PK. INV. 124.30(5)
DS-05	MIS WITH RP-RAP	RIM: 128.58	INV. EL: 123.00(0)
DS-06	CONTROL STRUCTURE TYPE D FRAME AND GRADE	RIM: 128.43	EX. INV. 124.80(0) 12' HDPE INV. 123.00(0)
DS-07	MI	RIM: 129.80	INV. EL: 128.00(0)
DS-08	MI	RIM: 129.54	INV. EL: 127.00(0)
DS-09	MIS WITH RP-RAP	RIM: 125.21	INV. EL: 123.00(0)
DS-10	TYPE C	RIM: 128.01	INV. EL: 127.00(0) PK. INV. 123.00(0) PK. INV. 124.30(5)
DS-11	CURB INLET	RIM: 127.03	INV. EL: 126.20(0)
DS-12	CURB INLET	RIM: 127.02	INV. EL: 126.10(0) PK. INV. 123.00(0)

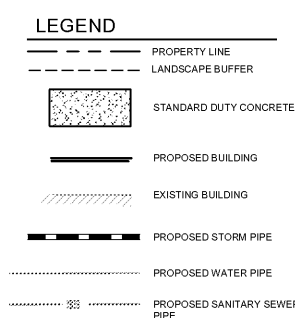

No.	REVISIONS	DATE	BY

Kimley»Horn
 © 2020 KIMLEY-HORN AND ASSOCIATES, INC.
 445 24TH STREET, SUITE 200, VERO BEACH, FL 32960
 PHONE: 772-794-4100
 WWW.KIMLEY-HORN.COM CA 00000686

PROFESSIONAL
 LICENSED PROFESSIONAL
 CHRISTOPHER J. HOLLEN, P.E.
 FLORIDA LICENSE NUMBER
 74685

PAVING, GRADING AND DRAINAGE PLAN

PUBLIC STORAGE APOPKA
 2431 S. ORANGE BLOSSOM TRAIL
 SEMINOLE COUNTY, FLORIDA
 SHEET NUMBER
C-200

