

**CONSULTING
CONSTRUCTION
ENGINEERING, LLC**
 1028 23rd Street South
 Birmingham, Alabama 35205
 Phone: (205) 352-2500 Web: www.cce-eng.com
 CCE No. 20-H-006 Date: Jun 23, 2020
 File: ES-01.dwg Time: 7:40:23 pm

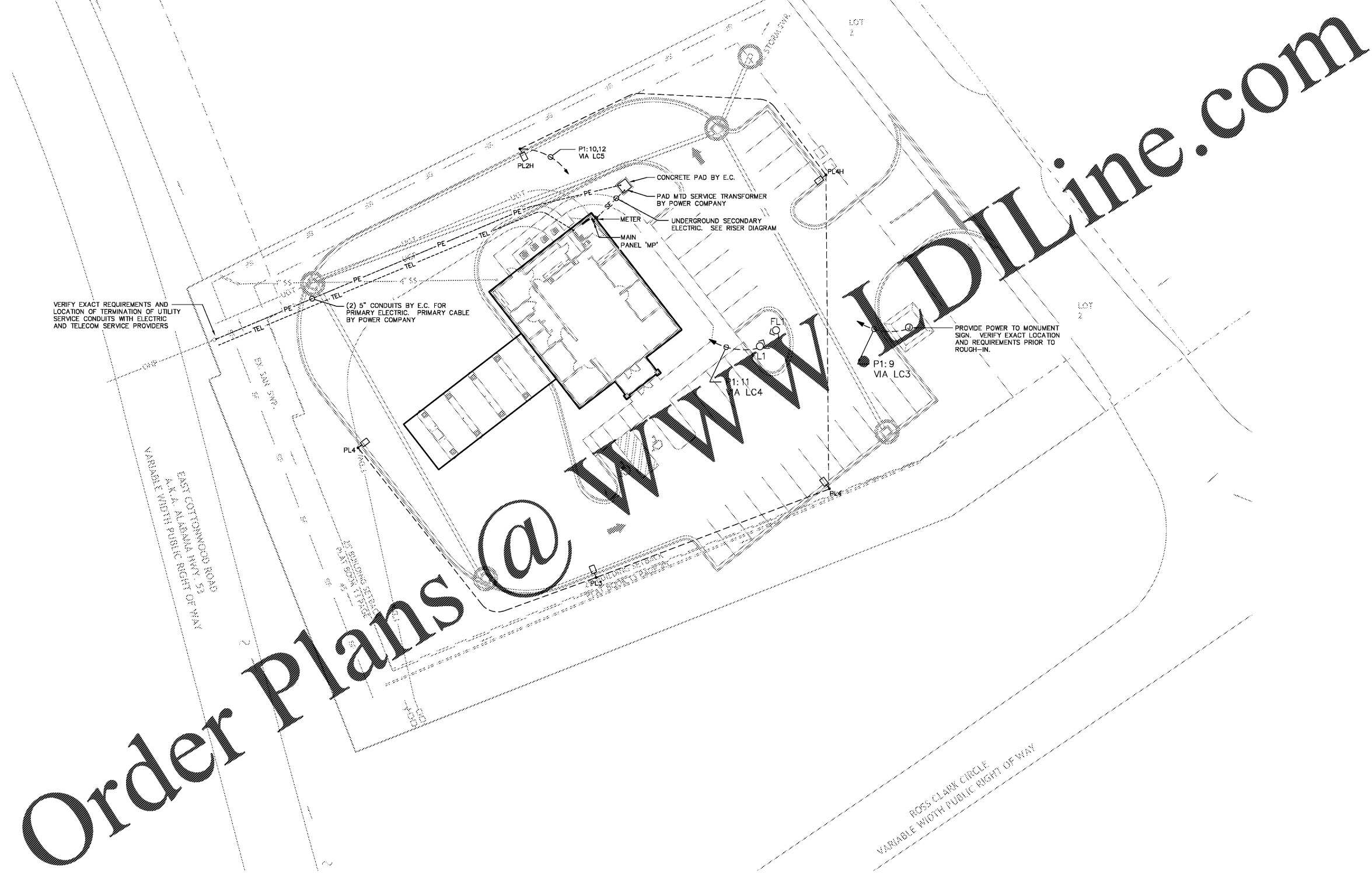

**hendon
huckestein
architects, PC**
 architecture . planning . interior design
 2126 Morris Avenue Birmingham, AL
 35203
 Phone: (205) 322-1751
 Fax: (205) 322-1778
 email: info@hpla-ha.com
 www.hpla-ha.com



Order Plans @ www.LDILine.com

SITE PLAN - ELECTRICAL
 SCALE: 1" = 20'-0"

A New Branch Bank for
Tyndall
 FEDERAL CREDIT UNION
 Dothan, Alabama

RELEASES / DESCRIPTION / DATES	
NOT FOR CONSTRUCTION	<input type="checkbox"/>
RELEASED FOR CONSTRUCTION	<input checked="" type="checkbox"/>
DATE	06.23.2020
DRAWN	—
CHECKED	—
APPROVED	HHHA
PROJECT NUMBER	20012.01
SHEET TITLE	SITE PLAN - ELECTRICAL
DRAWING NO.	E1.01