

Order Plans @ WWW.LDILL.COM

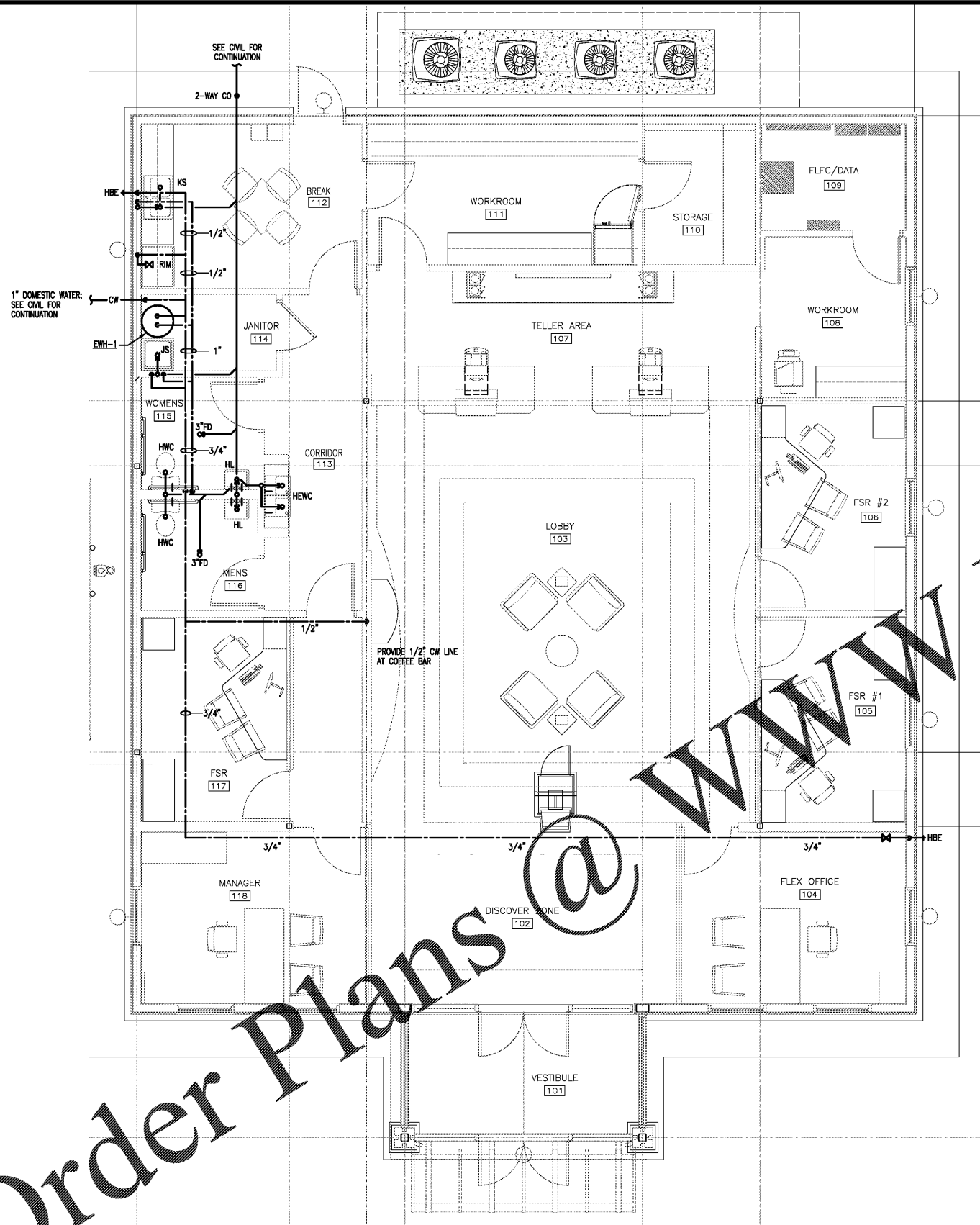

PLUMBING PLAN

Scale 1/4" = 1'-0"

PLUMBING FIXTURE SCHEDULE				
MARK	FIXTURE	SANITARY	C.W.	H.W.
HWC	WATER CLOSET, FLOOR, TANK TYPE, ADA COMPLIANT	3"	3/4"	-
HL	LAVATORY, WALL HUNG, ADA COMPLIANT	1 1/4"	1/2"	1/2"
HEWC	ELECTRIC WATER COOLER, ADA COMPLIANT	1 1/4"	1/2"	-
JS	JANITOR SINK	1 1/2"	1/2"	1/2"
KS	KITCHEN SINK	1 1/2"	1/2"	1/2"
RM	REFRIGERATOR ICE MAKER CONNECTION	-	1/2"	-
FD	FLOOR DRAIN W/ TRAP PRIMER	ON DWG	-	-
HBE	EXTERIOR HOSE BIBB, KEYED, PROVIDE SHUT-OFF VALVE	-	3/4"	-
EWH-1	ELECTRIC WATER HEATER, 30 GALLON, 4.5 KW ELEMENTS, 3 YR. WAR. EQUAL TO AO SMITH DEL30; INSTALL ON SHELF ABOVE JANITOR SINK	T&P	3/4"	3/4"

- GENERAL PLUMBING NOTES**
- FURNISH ALL LABOR, MATERIALS AND EQUIPMENT NEEDED TO PROVIDE A COMPLETE PLUMBING SYSTEM. THIS INCLUDES, BUT IS NOT LIMITED TO, WATER PIPING, WASTE AND VENT PIPING, AND ALL NECESSARY VALVES, TRAPS, AND ACCESSORIES.
 - ALL WORK SHALL BE PERFORMED BY SKILLED AND EXPERIENCED WORKMEN. WORK SHALL COMPLY WITH ALL APPLICABLE STATE AND LOCAL CODES. THIS CONTRACTOR SHALL BE RESPONSIBLE FOR ALL REQUIRED PERMITS, LICENSES, AND INSPECTIONS.
 - ROUGH-INS SHALL BE MADE FROM ARCHITECTURAL DRAWINGS INCLUDING VERIFICATION, NOT FROM PLUMBING DRAWINGS AS THEY ARE ONLY SCHEMATIC. THIS CONTRACTOR SHALL VERIFY ALL UTILITY LOCATIONS AND TAPS, AND FOR CHECKING ALL ELEVATIONS, GRADES, AND DIMENSIONS BEFORE THE START OF CONSTRUCTION. IF UNSATISFACTORY CONDITIONS EXIST, NOTIFY THE ARCHITECT IMMEDIATELY.
 - THIS CONTRACTOR SHALL COORDINATE ALL WORK WITH THE ELECTRICAL, MECHANICAL, AND FIRE PROTECTION CONTRACTORS TO AVOID CONFLICTS WITH OTHER TRADES. MAKE DEVIATIONS AS NECESSARY FROM THE WORK SHOWN ON THE DRAWINGS TO ENSURE THE WORK FITS THE SPACE(S) PROVIDED. NOTIFY THE ARCHITECT OF ANY NECESSARY DEVIATIONS.
 - IF NEW CONNECTIONS REQUIRE INTERRUPTION OF EXISTING SERVICES, ALL PREPARATORY WORK SHALL BE COMPLETED EARLY TO MINIMIZE TIME. WHERE POSSIBLE, PROVIDE TEMPORARY CONNECTIONS TO MAINTAIN UTILITY SERVICES.
 - ALL MATERIALS AND EQUIPMENT SHALL BE NEW AND WITHOUT DEFECTS. SUBMIT SHOP DRAWINGS FOR ALL EQUIPMENT AND MATERIALS. ALL WORK DONE BY THIS CONTRACTOR SHALL BE WARRANTED FOR ONE YEAR FROM THE TIME THE OWNER GIVES ACCEPTANCE OR GAINS BENEFICIAL USE, WHICHEVER IS FIRST.
 - ALL SANITARY AND VENT LINES SHALL BE HUBLESS CAST IRON PIPE (CISPI 310-78 STANDARD WEIGHT) WITH SPIGOT ENDS FOR COUPLING. HUBLESS CAST IRON JOINTS TO BE CISPI 310 STAINLESS STEEL SHIELD OVER ONE PIECE NEOPRENE. THIS CONTRACTOR MAY USE PVC PIPE AND FITTINGS CONFORMING TO ASTM D-2665 WHERE ALLOWED BY CODE.
 - ROOF PENETRATIONS SHALL BE FLASHED AND MADE WATER-TIGHT IN A MANNER APPROVED BY THE MANUFACTURER OF THE ROOFING MATERIAL AND COMPLYING WITH ARCHITECTURAL REQUIREMENTS.
 - PROVIDE CLEANOUTS WHERE INDICATED ON PLANS AND AS NECESSARY TO COMPLY WITH THE STANDARD PLUMBING CODE. ALL CLEANOUTS SHALL BE IN ACCESSIBLE LOCATIONS.
 - INSULATE ALL DOMESTIC WATER PIPING ABOVE GRADE WITH 3/4" THICK FLEXIBLE CLOSED-CELL POLYETHYLENE INSULATION. SEAL ALL JOINTS AND SEAMS AND INSULATE FITTINGS IN ACCORDANCE WITH THE MANUFACTURER'S INSTRUCTIONS.
 - HANGERS FOR EQUIPMENT AND PIPING SHALL BE SECURED TO THE BUILDING STRUCTURE. NO HANGERS SHALL BE ATTACHED TO THE FLOOR OR ROOF DECK MATERIAL, OR CONCRETE DECKS LESS THAN 4" THICK.
 - INSTALL SHOCK ABSORBERS VERTICALLY AT EACH FIXTURE. OFFSET AS NEEDED TO GAIN A MINIMUM HEIGHT OF 18". ALL SHOCK ABSORBERS SHALL BE A MINIMUM OF ONE PIPE SIZE LARGER THAN THE BRANCH BEING SERVED.
 - PROVIDE CHROME PLATED BRASS ESCUTCHEON PLATES AT ALL PENETRATIONS OF WALLS, FLOORS OR CEILING IN FINISHED AREAS AND UNDER LAVATORIES. PROVIDE STOPS AND TRAPS FOR ALL FIXTURES. LEAK TEST WATER PIPING FOR NOT LESS THAN 90 MINUTES AT 100 PSI. FILL SANITARY SEWER SYSTEM TO A MINIMUM HEIGHT OF TEN FEET AND LET STAND FOR AT LEAST 30 MINUTES WITHOUT LEAKAGE. AFTER PRESSURE TESTS HAVE BEEN MADE, THOROUGHLY FLUSH THE ENTIRE DOMESTIC WATER SYSTEM WITH WATER UNTIL ALL ENTRAINED DIRT AND MUD HAVE BEEN REMOVED, AND STERILIZE. THE STERILIZING MATERIAL SHALL BE EITHER LIQUID CHLORINE CONFORMING TO THE FED. SPEC. BB-C-120, OR HYPOCHLORITE CONFORMING TO FED. SPEC. O-C-114, OR FED. SPEC. O-S-602M. THE CHLORINATING AGENT SHALL PROVIDE A MINIMUM DOSAGE OF 50 PPM AND SHALL BE RETAINED IN THE SYSTEM FOR 90 MIN. THE SYSTEM WILL THEN BE FLUSHED WITH CLEAN POTABLE WATER UNTIL THE RESIDUAL CHLORINE IS REDUCED TO LESS THAN 1.0 PPM. HAVE THREE STATE-APPROVED INDEPENDENT TESTING FACILITIES TAKE SAMPLES AND DELIVER CERTIFICATES OF APPROVAL TO THE OWNER. ANY NEGATIVE RESULTS MUST BE INVESTIGATED, AND IF NECESSARY CORRECTED, BEFORE THE BUILDING MAY BE ACCEPTED.

PLUMBING LEGEND	
	SOIL OR WASTE LINE
	VENT
	COLD WATER (CW)
	HOT WATER (HW)
	COLD WATER (EXTERIOR)
	GATE VALVE
	T & P RELIEF VALVE
	WALL CLEANOUT
	FLOOR CLEANOUT
	SHOCK ABSORBER
	VENT THRU ROOF

328 Brooks Street SE
Fort Walton Beach, FL 32548
850.244.6188V 850.244.0545F

627 Grace Avenue
Panama City, FL 32401
850.215.4068V 850.215.4068F

Alabama #CD-2429-E Arkansas #1654 Florida #00009014
Georgia #PEF003983 Mississippi #E-00000862
Tennessee #737347

JOHNSON PEADEN ENGINEERING INC.

These plans, the ideas and the concepts contained herein including any digital information are the sole property of Johnson, Peaden Engineering, Inc. They are not to be reproduced, copied, modified or changed without the expressed written permission of Johnson, Peaden Engineering, Inc.

JPE Job Number: 2026

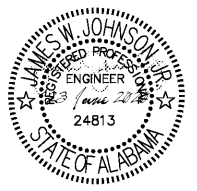

Hendon Huckestein architects, PC
architecture . planning . interior design
2126 Morris Avenue
Birmingham, AL 35203
Phone (205) 322-1751
Fax (205) 322-1778
email info@hplusha.com
www.hplusha.com

A New Branch Bank for

Tyndall

FEDERAL CREDIT UNION

Dothan, Alabama

RELEASES / DESCRIPTION / DATES	
NOT FOR CONSTRUCTION	<input type="checkbox"/>
RELEASED FOR CONSTRUCTION	<input checked="" type="checkbox"/>
DATE	06.23.2020
DRAWN	JMP
CHECKED	JWJ
APPROVED	HHA
PROJECT NUMBER	20012.01
SHEET TITLE	PLUMBING PLAN
DRAWING NO.	P1.0