

POPEYES
1702 RALEIGH ROAD PKY NW
WILSON, NORTH CAROLINA
LOUISIANA KITCHEN PLK DESIGN STANDARDS
88 SEATS / DUAL-LINE PRODUCTION/PLK1711-DL

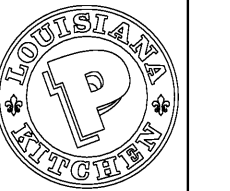

REVISIONS:
2 8/18/20 HEALTH COMMENT

A3
REFLECTED CEILING PLAN
DATE: 5/18/20
PROJECT NO: G20-05
CHECKED: JS

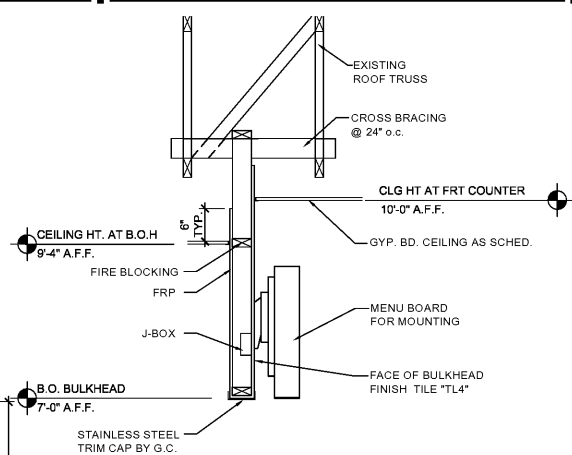
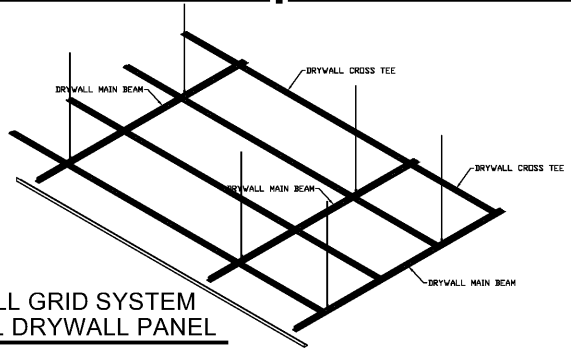

2 SECTION @ MENUBOARD
3/4"=1'-0"

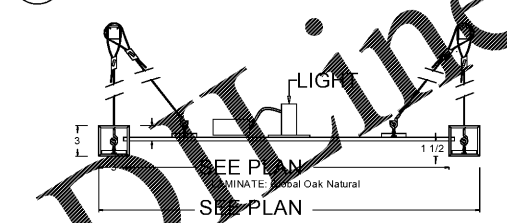

3 SECTION @ TRELIS
3/4"=1'-0"

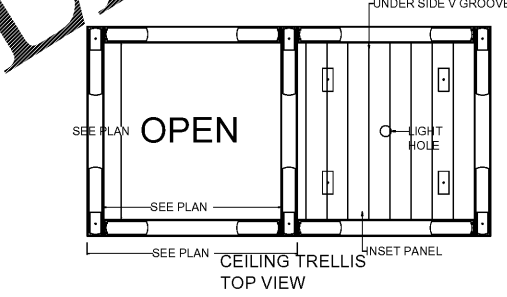

4 PLAN @ TRELIS
3/4"=1'-0"

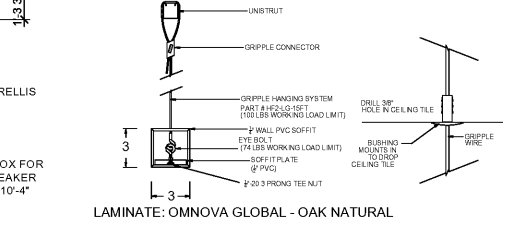

5 DETAIL @ TRELIS
3/4"=1'-0"

SYMBOL LEGEND:

- GRID1 - GRID SPECIFICATION
- ACOU1 - TILE SPECIFICATION
- 9'-4" - CEILING LIGHT
- L-1 - SIGN ACCENT LIGHT GOOSENECK ORANGE
- L-2 - OFFIT RECESSED DT CANOPY (APPLIED BY SIGN SUPPLIER)
- L-3 - WALL PAK LIGHT
- L-4 - EXTERIOR SPEAKER
- L-5 - COMMUNITY TABLE LIGHT MANUFACTURER: HERMITAGE MODEL: H-HLP2STPNLSN FINISH: 101 BRUSHED ALUMINUM (CANOPY PLATE), 91-BLACK (STEM), 97-RED (TOP OF SHADE), 101 OR 118 (ELBOW COUPLING), 93-WHITE (INTERIOR SHADE) COLOR TEMP: 9-12W WARM WHITE WATTAGE/VOLTAGE: 9-12W
- L-6 - FAMILY NOOK MANUFACTURER: HERMITAGE MODEL: H-PP18SHD80P FINISH: RED (SHADE), 11-SATIN STEEL (STEM & CANOPY), OPAL (GLOBE) COLOR TEMP: 1-MEDIUM BASE INC WATTAGE/VOLTAGE: 100W
- L-7 - PERIMETER WALL BOOTHS MANUFACTURER: HERMITAGE MODEL: GALATIN GALA FINISH: TAN COLOR TEMP: LED 2700K
- LL5 - DINING, FSC, RESTROOM MANUFACTURER: LSI MODEL: PDL6KADJ-LED-07-30-120-PDL6KADJHSGNC 6"D FINISH: WHITE COLOR TEMP: LED 3000K WATTAGE: 14W
- L-7 - TRELIS 2" LED LIGHTING (SUPPLIED BY DECOR SUPPLIER)
- EX - EMERGENCY LIGHTING
- EX - EXTERIOR EMERGENCY LIGHTING
- EM - INTERIOR EMERGENCY LIGHTING
- S - INTERIOR SPEAKER
- A - 2' x 4'
- AA - 2' x 2'
- B - 1' x 4' LED FIXTURE - WALK IN COOLER/FREEZER
- MECH - RETURN AIR
- MECH - SUPPLY

HERMITAGE LIGHTING CONTACT INFORMATION:
CHAD LISTER
(618) 843-3372
clister@hermitagelighting.com

SPECIFICATIONS:
DIVISION 9: FINISHES

SECTION 9C: SUSPENDED CEILING
GENERAL PROVISIONS
1. SCOPE: FURNISH AND INSTALL ACOUSTICAL TILE PANELS WITH SUSPENSION SYSTEM.
PERFORMANCE
1. INSTALLATION: GRID SHALL BE INSTALLED AS SHOWN AND IN STRICT ACCORDANCE WITH MANUFACTURER'S INSTRUCTIONS. LEVEL ACCURATELY AND HANG FROM #9 GAUGE ANNEALED WIRE NOT OVER 4" ON CENTERS. PROVIDE HOLD-DOWN CLIPS. COOPERATE IN FITTING AROUND AIR CONDITIONING AND VENTILATION OUTLETS.

GENERAL NOTES

- 1) CEILING GRID SHALL BE SUPPORTED FROM STRUCTURAL MEMBERS ONLY. GRID SHALL NOT BE SUPPORTED FROM OTHER TRADES WORK.
- 2) COORDINATE GRID INSTALLATION WITH LOCATION OF MECHANICAL EQUIPMENT AS INDICATED ON SHEET M-1 AND E-1.
- 3) HANGER WIRES FOR GRID SHALL BE INSTALLED AT NOT MORE THAN 48" O.C. AND AT EACH CORNER OF LAY-IN LIGHT FIXTURES. SEE ELECTRICAL PLANS FOR FIXTURE LOCATIONS.

MATERIALS:

- GRID1 - DX26 15/16" EXPOSED GRID SYSTEM, ALUMINUM CAP #2XA BY U.S.G. -COLOR: WHITE.
- ACOU1 - U.S.G. "GLACIER" # 707, REVEALED EDGE, 24"x24"x 5/8", WHITE
- ACOU1 - U.S.G. "RADAR CLIMAPLUS" # 2420, STL EDGES, 24"x48"x5/8", (OPTIONAL) WHITE
- GPBD1 - 1/2" WMR GYPSUM BOARD SURFACE: WASHABLE PAINT, W/ NO TEXTURE COLOR: WHITE.
- GRID2 - 15/16" DBL. WEBB HOT DIPPED GALV. STEEL TEE, ALUMINUM CAP #2XA BY U.S.G. -COLOR: WHITE
- ACOU2 - U.S.G. SHEETROCK BRAND LAY-IN CEILING TILE -"CLIMAPLUS" #3270, WHITE VINYL 24"x48"x1/2"

MANUFACTURERS AND COLORS SHALL BE AS SPECIFIED. SUBSTITUTIONS WILL NOT BE ACCEPTED. PAINT TO BE APPLIED IN ACCORDANCE WITH MANUFACTURERS TECHNICAL DATA SHEETS.

DRYWALL GRID SYSTEM TYPICAL DRYWALL PANEL

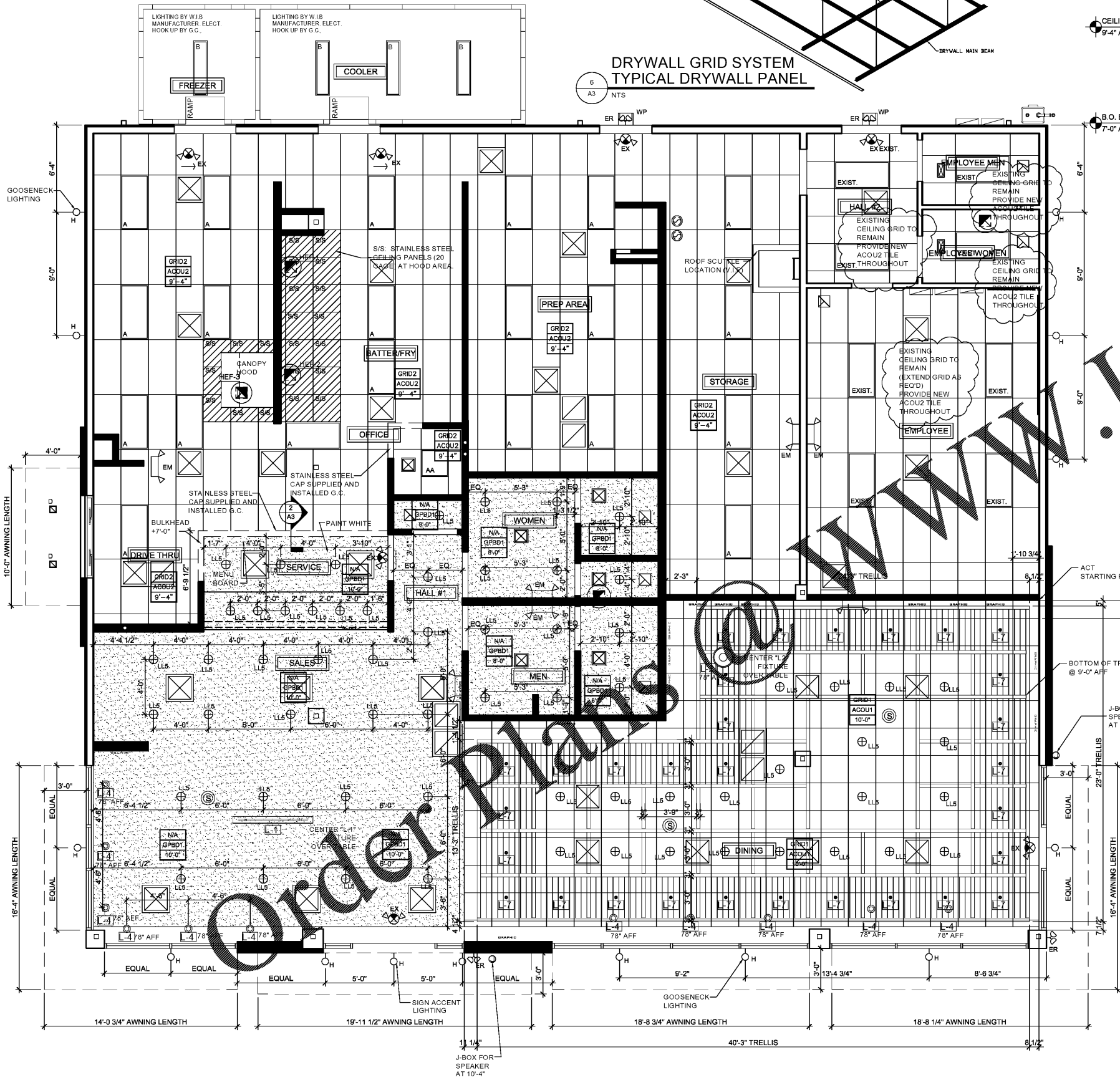

1 REFLECTED CEILING PLAN
1/4"=1'-0"