

Order Plans @ [www.LDILine.com](http://www.LDILine.com)

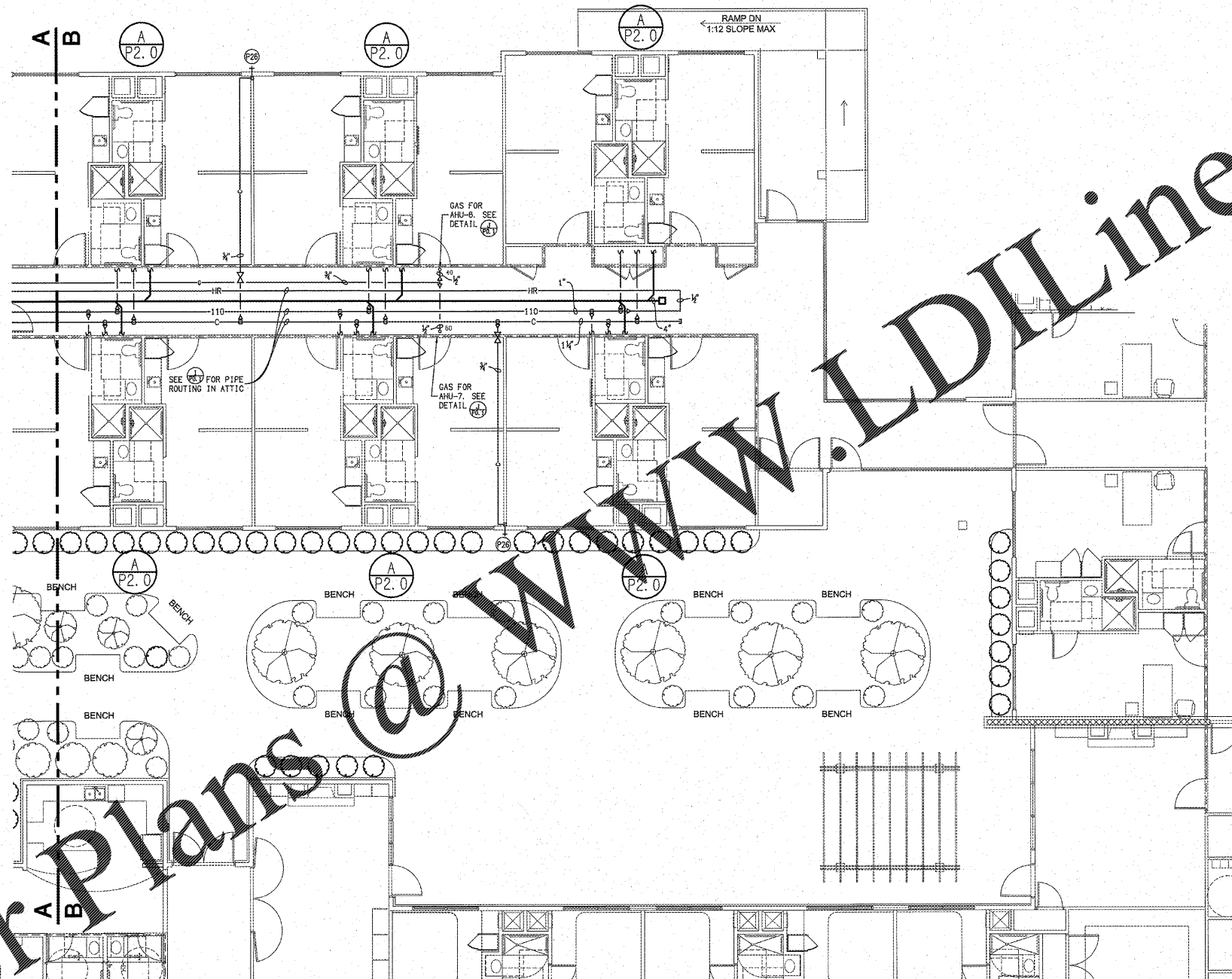

**A PLUMBING PLAN - AREA B**  
**P1.2** SCALE: 1/8" = 1'-0"

ARCHITECT  
 TIMOTHY  
 KURMASKIE  
 AIA, NCARB

1030 Washington St  
 Raleigh, NC 27605  
 Phone: 919-846-1600  
 Fax: 919-846-9404  
 ARCHITECTSKT.COM

THE DRAWINGS AND DESIGN SHOWN ARE THE PROPERTY OF ARCHITECT TIMOTHY KURMASKIE, AIA, NCARB. THE REPRODUCTION OR USE OF THIS PROPERTY WITHOUT THE WRITTEN CONSENT FROM THE ARCHITECT IS PROHIBITED AND ANY INFRINGEMENT OF THESE RIGHTS IS SUBJECT TO LEGAL ACTION.

COPYRIGHT 2019  
 ARCHITECT TIMOTHY KURMASKIE, AIA, NCARB



DAVID SIMS & ASSOCIATES, P.C.  
 Consulting Engineers  
 Arboretum Centre  
 108 Giles Avenue - Suite 100  
 Wilmington, N.C. 28403  
 (910) 791-8016 (OFFICE)  
 (910) 395-5734 (FAX)

ALTERATION & ADDITION TO:

**PruittHealth  
 Savannah**

12825 WHITE BLUFF ROAD  
 SAVANNAH, GA 31419

Project Reference Numbers  
 Architect's Project No. 180017

Drawn By:

REVISIONS

DATES

PHASE	ISSUED
PERMIT SET	05/22/19

PARTIAL PLUMBING PLAN  
 AREA B

SHEET NUMBER

**P1.2**