

LEGEND

- 2 X 4 RECESSED FLOURESCENT LIGHT FIXTURE
- OVER BED LIGHTING
- PENDANT LIGHT FIXTURE
- 6" RECESSED CAN LIGHT FIXTURE
- SHOWER LIGHT FIXTURE
- PENDANT LIGHT FIXTURE
- WALL SCONCE FIXTURE
- WALL SCONCE FIXTURE
- SUPPLY DIFFUSER
- RETURN DIFFUSER
- EXHAUST FAN
- EXIT SIGN
- CEILING ACCESS PANEL - LARSEN'S MANUF. CO. 24" X 36" "NON-FIRE-RATED PANEL" OR APPROVED EQUIV.

NOTE: SEE FIRE PROTECTION, MECH. & ELEC. PLANS FOR DETAILS

NOTE: IMPORTANT! USE MOISTURE RESISTANT GYP. BD. IN ALL BATHING & SHOWER AREAS

NOTE: ALL CEILINGS TO BE PAINTED MOISTURE & MOLD RESISTANT GYP. BD. UNLESS NOTED OTHERWISE.

NOTE: SEE MECH., ELEC. & ID DWG'S FOR LIGHTING AND DIFFUSER LOCATIONS & ADDITIONAL INFO.

KEY PLAN

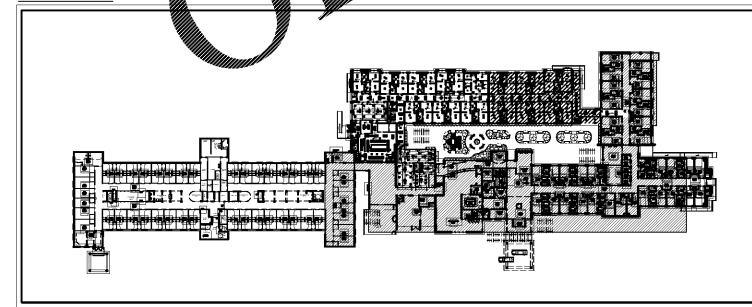

HATCH REPRESENTS AREA OF ADDITION ON KEY PLAN

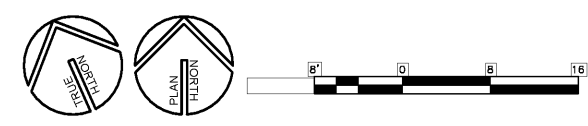

NEW ADDITION
reflected ceiling plan
SCALE: 1/8" = 1'-0"

01

ARCHITECT
TIMOTHY
KURMASKIE
AIA, NCARB

1030 Washington Street
Raleigh, NC 27605
Phone: 919-846-1600
Fax: 919-846-9404
TIM@ARCHITECTSKT.COM

THE DRAWINGS AND DESIGN SHOWN ARE THE PROPERTY OF ARCHITECT TIMOTHY KURMASKIE, AIA, NCARB. THE REPRODUCTION OR USE OF THIS PROPERTY WITHOUT THE WRITTEN CONSENT FROM THE ARCHITECT IS PROHIBITED AND ANY INFRINGEMENT OF THESE RIGHTS IS SUBJECT TO LEGAL ACTION.

COPYRIGHT 2019
ARCHITECT TIMOTHY KURMASKIE, AIA, NCARB

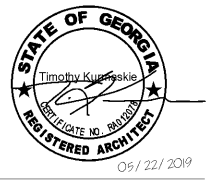

DATE: 05/22/2019
DRAWN BY: NK/WMB
CHECKED BY: NK/WMB
PROJECT NO: 180017
SHEET NO: 01 OF 01

ALTERATION & ADDITION TO:
PruittHealth Savannah
12825 WHITE BLUFF ROAD
SAVANNAH, GA 31419

Project Reference Numbers
Architect's Project No. 180017

Drawn By: NK/WMB

REVISIONS	
NO.	DESCRIPTION

REFLECTED
CEILING PLAN

SHEET NUMBER
A10.2