

**WALL TYPES LEGEND**

NOTE: SEE SHEET CS3 FOR UL DETAILS

- 01 N/A SMOKE PARTITION @ CORRIDORS  
NON LOAD BEARING & LOAD BEARING. 1 LAYER OF 5/8" GYPSUM BOARD ON BOTH SIDES OF METAL STUDS @ 16" O.C. (STUD SIZE VARIES - SEE PLAN). FILL CAVITY FULL W/ MINERAL WOOL OR FIBERGLASS BATT INSUL. FULL HEIGHT OF WALL - FLOOR TO UNDER SIDE OF MONOLITHIC CEILING
- 02 CS3 NEW 2-HOUR FIRE / SMOKE WALL  
NON - LOAD BEARING 8" C.M.U. FULL HEIGHT - FLOOR TO 30" ABOVE ROOF DECK. REINF. HORIZONTALLY W/ GALV. TRUSS TYPE MASONRY WALL REINF. @ 16" O.C. VERT. SEE STRUCT. DWGS. FOR VERT. REINF. - FILL CELLS FULL W/ FOAM INSUL. - 5/8" GYP. BD. OVER 7/8" METAL FURRING CHANNELS @ 2'-0" O.C. ON EXPOSED INTERIOR SURFACES. TERMINATING AT CEILING
- 03 CS3 INTERIOR LOAD BEARING/NON-LOAD BEARING 4 HOUR FIRE BARRIER  
(1) LAYER 5/8" "GOLD BOND" XP" GYP. BD. ON BOTH SIDES OF METAL STUDS @ 16" O.C. FILL CAVITY W/ MINERAL WOOL OR FIBERGLASS BATT. INSUL. FULL HT. OF WALL. FIN. FLR. UP TO ROOF DECK
- 04 CS3 INTERIOR SMOKE BARRIER 1-HR FIRE RATED  
(1) LAYER 5/8" "GOLD BOND" XP" GYP. BD. ON BOTH SIDES OF METAL STUDS @ 16" O.C. FILL CAVITY W/ MINERAL WOOL OR FIBERGLASS BATT. INSUL. FULL HT. OF WALL. FIN. FLR. UP TO ROOF DECK

NOTE: ALL CEILING IN SOILED LINEN CLOSETS & SOILED LAUNDRY TO HAVE 1-HR RATED CEILING PER UL DETAIL P522

**PLAN SYMBOLS LEGEND**

- INDICATES AREA OF NO WORK
- INDICATES NEW WALL CONSTRUCTION (1) LAYER 5/8" GYPSUM BOARD ON BOTH SIDES OF 3 5/8" METAL STUDS @ 16" O.C.
- 1 HOUR RATED FIRE BARRIER
- 1 HOUR RATED SMOKE BARRIER
- SMOKE TIGHT PARTITION
- 2-HOUR RATED FIRE/SMOKE WALL-UL DETAIL U905. SEE SHEET CS3

**KEYED CONSTRUCTION NOTES**

- 01 NEW IPC HANDRAIL (SEE DETAIL A3-02) MOUNT TOP AT 2'-10" A.F.F. - NEW 4"x4" 12L-IPC MODEL ACP-1600 WALL BUMPER GUARDS - COORDINATE COLOR WITH OWNER. MOUNT TOP EDGE AT 1'-4" A.F.F.
- 02 DIMPLEX BF33DXP ELECTRIC FIREPLACE. INSTALLED TO PROVIDE FIRE EFFECT WITH NO HEAT. PROVIDE SWITCH NEAR FIREPLACE. SEE ID DRAWINGS.
- 03 SEMI-RECESSED FIRE EXTINGUISHER AND CABINET. FIRE EXTINGUISHERS TO BE 2A-10B.C RATED (MINIMUM) NFPA 10-3.2.1. MOUNT @ 48" MAX TO 15" MIN. A.F.F.
- 04 MILLWORK - SEE ID DRAWINGS
- 05 EXISTING DOOR TO REMAIN IN PLACE. VERIFY CONDITION. REPLACE IF NEEDED POST CONSTRUCTION
- 06 PLUMBING TO CONNECT TO ECOLAB CHEMICAL DISPENSER
- 07 VTAC-SEE MECHANICAL DRAWINGS
- 08 WOOD BENCH/WOOD BRIDGE - RUSSELL LANDSCAPE/OWNER PROVIDED
- 09 ADJUSTABLE SHELVING-COORDONATE W/ OWNER

**NOTE:** CONFIRM ALL FINISH SELECTIONS WITH ID AND OWNER PRIOR TO PURCHASING.

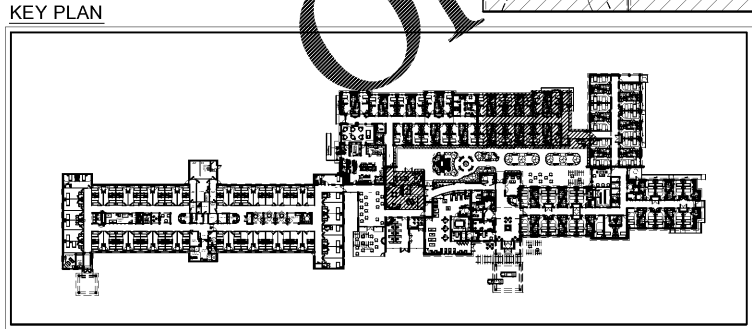

HATCH REPRESENTS AREA OF WORK SHOWN ON THE SHEET



**AREA B NOTATION**

floor plan

SCALE: 1/8" = 1'-0"

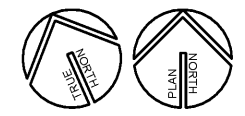

01

ARCHITECT  
**TIMOTHY KURMASKIE**  
AIA, NCARB

1030 Washington Street  
Raleigh, NC 27605  
Phone: 919-846-1600  
Fax: 919-846-9404  
TIM@ARCHITECTSKT.COM

UL DESIGN NO. : U905  
UL DESIGN NO. : U419

THE DRAWINGS AND DESIGN SHOWN ARE THE PROPERTY OF ARCHITECT TIMOTHY KURMASKIE, AIA, NCARB. THE REPRODUCTION OR USE OF THIS PROPERTY WITHOUT THE WRITTEN CONSENT FROM THE ARCHITECT IS PROHIBITED AND ANY INFRINGEMENT OF THESE RIGHTS IS SUBJECT TO LEGAL ACTION.



ALTERATION & ADDITION TO:  
**PruittHealth Savannah**  
12825 WHITE BLUFF ROAD  
SAVANNAH, GA 31419

Project Reference Numbers  
Architect's Project No. 180017

Drawn By: NK/WMB

**REVISIONS**

EQPT REV.	03-26-2020
DCH COM.	04-23-2020
OWNER COM.	06-10-2020

**DATES**

PHASE	ISSUED
PERMIT SET	05/22/19

AREA B  
FLOOR PLAN  
NOTATION  
SHEET NUMBER

**A1.2B**