

PLANTING NOTES

- IT IS THE RESPONSIBILITY OF THE LANDSCAPE CONTRACTOR TO CONFIRM ALL MATERIAL QUANTITIES. IN THE EVENT OF A DISCREPANCY, THE QUANTITIES SHOWN ON THE PLAN SHALL TAKE PRECEDENCE OVER THE MATERIAL SCHEDULE.
- NO SUBSTITUTIONS AS TO TYPE, SIZE, OR SPACING OF PLANT MATERIALS SPECIFIED ON THIS PLAN MAY BE MADE WITHOUT THE APPROVAL OF THE OWNER'S REPRESENTATIVE.
- THE CONTRACTOR IS TO VERIFY THE EXACT LOCATION OF ALL EXISTING UTILITIES. TAKE CARE TO PROTECT UTILITIES THAT ARE TO REMAIN, REPAIR ANY DAMAGE ACCORDING TO LOCAL STANDARDS AND AT CONTRACTOR'S EXPENSE. COORDINATE ALL CONSTRUCTION WITH THE APPROPRIATE UTILITY COMPANY.
- ALL PLANTING BEDS TO RECEIVE HARDWOOD MULCH. MULCH TO BE INSTALLED TO 3" DEPTH UNLESS OTHERWISE INDICATED ON THE PLANTING DETAILS.
- NEW TREE PLANTINGS TO BE STAKED PER PLANTING DETAILS.
- DIMENSIONS LISTED FOR HEIGHTS, SPREAD AND TRUNK SPECIFICATIONS ON THE PLANT MATERIAL SCHEDULE ARE GENERAL GUIDE FOR THE MINIMUM REQUIRED SIZE OF EACH PLANT.
- PRE-EMERGENT HERBICIDE SHALL BE APPLIED TO ALL PLANTING BEDS IMMEDIATELY PRIOR TO PLACEMENT OF MULCH FOR WEED CONTROL.
- ALL DISTRIBUTED AREAS OF THE SITE ARE TO BE SEEDED AND/OR SODDED IN ACCORDANCE WITH THE SPECIFICATIONS.
- NO EXCAVATION OR PLANTING PIT SHALL BE LEFT OPEN OVERNIGHT.
- THE LANDSCAPE CONTRACTOR SHALL OBTAIN ANY NECESSARY PERMITS, LICENSES, ETC. AND SHALL GIVE ALL NOTICES AND COMPLY WITH ALL APPLICABLE LAWS, ORDINANCES, CODES, RULES AND REGULATIONS DURING THE COURSE OF THE INSTALLATION OF THIS PROJECT.
- ALL PLANT MATERIALS TO BE NURSERY GROWN AND TO COMPLY WITH THE AMERICAN STANDARD FOR NURSERY STOCK FOR SIZE AND QUALITY.
- THE LANDSCAPE ARCHITECT RESERVES THE RIGHT TO REFUSE ANY PLANT MATERIAL OR ANY DEFECTIVE WORKMANSHIP.
- ALL PLANTS SHALL HAVE A WELL-FORMED HEAD WITH MINIMUM CALIPER, HEIGHT AND SPREAD OF THE SIDE BRANCHES AS SHOWN ON THE PLANT LIST. TRUNKS SHALL BE UNDAMAGED AND SHAPE SHALL BE TYPICAL OF THE SPECIES.
- MEASUREMENT OF CONIFER HEIGHT SHALL INCLUDE NOT MORE THAN FIFTY PERCENT (50%) OF THIS YEARS VERTICAL GROWTH (TOP CANDLE).
- THE LANDSCAPE CONTRACTOR WILL BE RESPONSIBLE FOR STAKING AND LAYOUT OF PLANTINGS ON THIS PROJECT. THE LANDSCAPE ARCHITECT OR OWNER SHALL BE ADVISED WHEN STAKES ARE READY FOR INSPECTION ON VARIOUS PLANTING AREAS. ALL LAYOUT WORK SHALL BE INSPECTED AND APPROVED BY THE LANDSCAPE ARCHITECT OR OWNER PRIOR TO OPENING ANY PLANT PITS.
- IT IS THE RESPONSIBILITY OF THE LANDSCAPE CONTRACTOR TO VERIFY THAT EACH EXCAVATED TREE OR SHRUB PIT WILL PERCOLATE (DRAIN) PRIOR TO ADDING TOPSOIL AND INSTALLING TREES OR SHRUBS. THE CONTRACTOR SHALL FILL THE BOTTOM OF SELECTED HOLES WITH SIX INCHES OF WATER. THIS WATER SHOULD PERCOLATE OUT WITHIN A 24-HOUR PERIOD. THE OWNER OR LANDSCAPE ARCHITECT SHALL VERIFY ACCURACY AND EFFECT OF PERCOLATION TESTING. IF THE SOIL AT A GIVEN AREA DOES NOT DRAIN PROPERLY, A P V C DRAIN OR GRAVEL SLUMP SHALL BE INSTALLED OR THE PLANTING RELOCATED.
- SHOULD THE LANDSCAPE CONTRACTOR ENCOUNTER UNSATISFACTORY SURFACE OR OTHER SUBSURFACE DRAINAGE CONDITIONS, SOIL DEPTH, LATENT SOILS, HARD PAN, STEAM OF OTHER UTILITY LINES OR OTHER CONDITIONS THAT WILL JEOPARDIZE THE HEALTH AND VIGOR OF THE PLANTS, HE MUST ADVISE THE LANDSCAPE ARCHITECT IN WRITING OF THE CONDITIONS PRIOR TO INSTALLING THE PLANTS. OTHERWISE THE LANDSCAPE CONTRACTOR WARRANTS THAT THE PLANTING AREAS ARE SUITABLE PROPER GROWTH AND DEVELOPMENT OF THE PLANTS TO BE INSTALLED.
- NO MATERIAL SHALL BE PLANTED BEFORE FINISH GRADING HAS BEEN COMPLETED.
- ALL BEDS ARE TO BE TILLED TO A DEPTH OF 8" WITH THE ADDITION OF: (1) 6 CU. FT. BALE OR SPHAGNUM PEAT MOSS PER 40 SQ. FT. OF BED AREA; (25#) 10-10-10 FERTILIZER PER 1000 SQ. FT.
- CONTRACTOR SHALL NOTIFY THE LANDSCAPE ARCHITECT WHEN THE PLANT MATERIALS ARE AVAILABLE AT THE JOB SITE FOR REVIEW BY THE LANDSCAPE ARCHITECT PRIOR TO INSTALLATION.

IRRIGATION NOTES

- LANDSCAPE CONTRACTOR TO PROVIDE IRRIGATION SYSTEM ON A DESIGN/BUILD ARRANGEMENT FOR AREA NOTED ON THE PLAN. CONTRACTOR TO PREPARE DESIGN DRAWINGS IN ACCORDANCE WITH PERFORMANCE SPECIFICATIONS CONTAINED IN THE PROJECT MANUAL AND SUBMIT SAME FOR APPROVAL BY THE OWNER'S REPRESENTATIVE PRIOR TO CONSTRUCTION.
- CONTRACTOR TO CONFIRM ADEQUATE PRESSURE EXISTS TO OPERATE SYSTEM PRIOR TO INSTALLATION.
- IRRIGATION SPRINKLER HEADS SHALL BE MANUFACTURED BY EITHER TORO OR RAIBIRD. IRRIGATION CONTROLLER SHALL BE TORO VISION II MODEL OR APPROVED EQUAL.
- MAIN LINE TO BE CLASS 200 PVC PIPE. LATERAL LINES TO BE CLASS 150 PVC.
- IRRIGATION SYSTEM TO BE OPERATIONAL BEFORE PLANTING MATERIALS MAY BE INSTALLED IN PLANTING BEDS.
- INSTALL SPRINKLER HEADS ACCORDING TO MANUFACTURERS SPECIFICATIONS. FLUSH ALL LINES BEFORE INSTALLING NOZZLES.
- WIRE CONNECTIONS TO BE MADE BY USING RAIBIRD MODEL ST-103/P-ST SNAP-TITE CONNECTIONS OR APPROVED EQUAL.
- LEAVE 18 INCHES OF ADDITIONAL WIRE AT EACH VALVE LOCATION. ROLL WIRE INTO COIL AT EACH LOCATION.
- ALL VALVES SHALL BE LOCATED IN AMATEX 10 INCH CIRCULAR VALVE BOXES WITH COVER, OR APPROVED EQUAL.
- IRRIGATION CONTRACTOR TO COORDINATE PLACEMENT OF REQUIRED SLEEVES WITH GENERAL CONTRACTOR PRIOR TO PAVING AND CONCRETE INSTALLATION BEING COMPLETED.

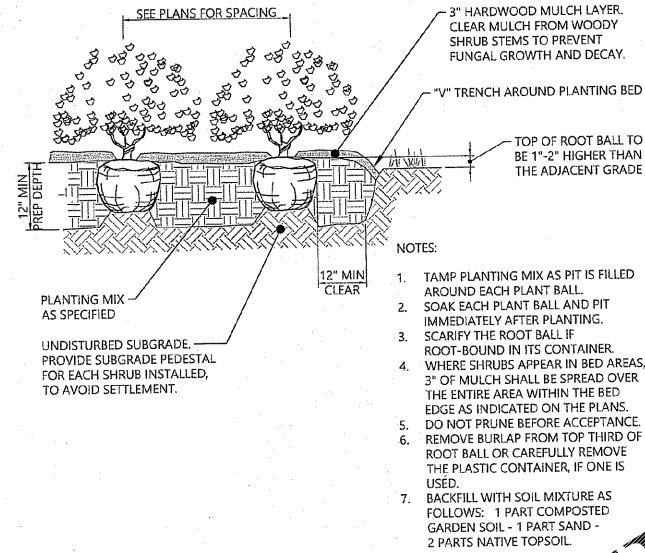

3 SHRUB PLANTING
NO SCALE

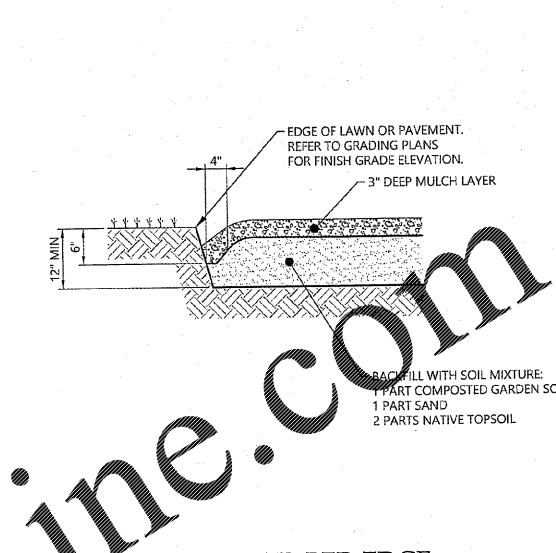

1 SPADED BED EDGE
NO SCALE

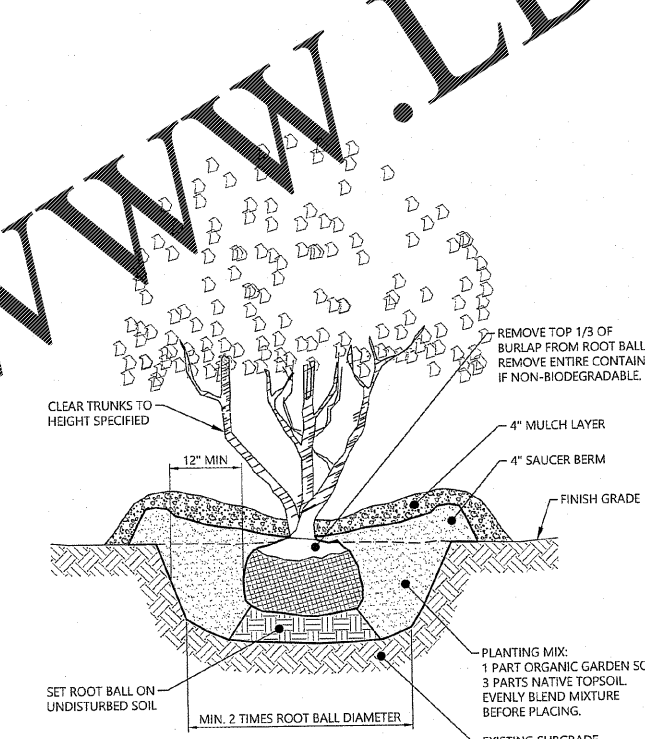

4 MULTI-TRUNK PLANTING
NO SCALE

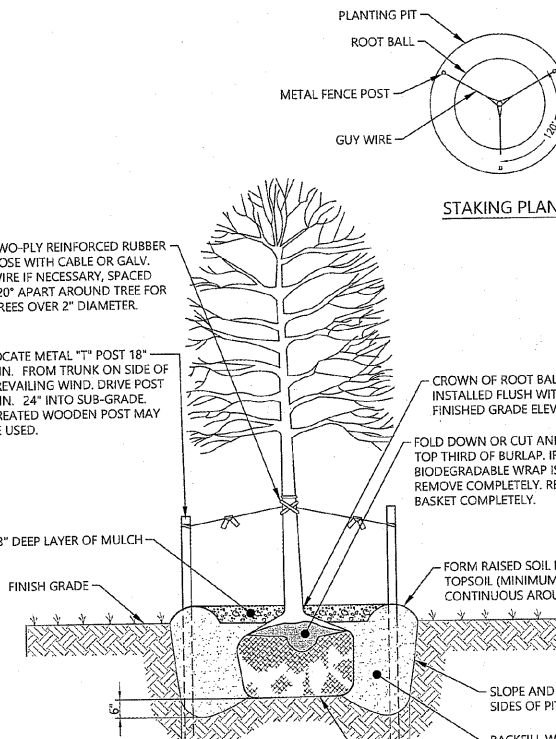

2 TREE PLANTING
NO SCALE

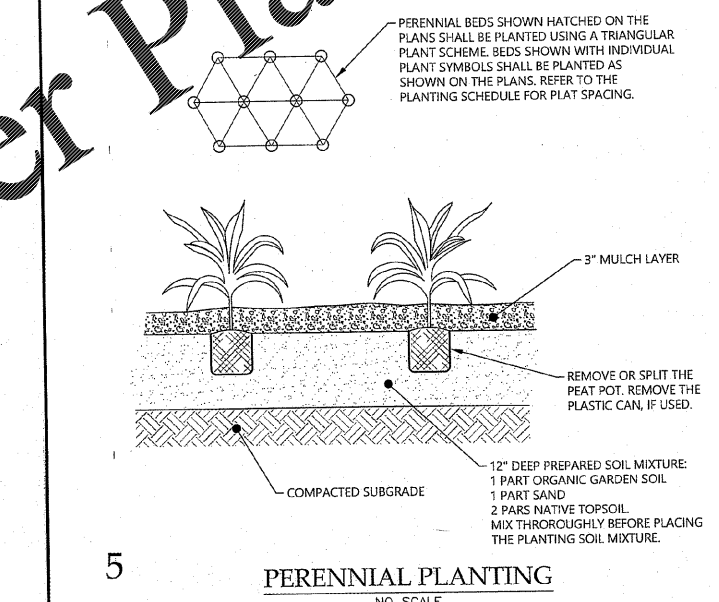

5 PERENNIAL PLANTING
NO SCALE

Order Plans @ WWW.LDILine.com

LDI
360D QUALITY CIRCLE NW,
SUITE 450
HUNTSVILLE, AL 35896
(256) 837-8882

**NEW GENERATION
FOODS, LLC**
P.O. BOX 736
ATHENS, AL 35612
256.729.9136



NO.	DATE	BY	CHK	DESCRIPTION
2	4-7-2020	JM		CITY'S FINAL TECHNICAL REVIEW
		BW		CITY'S TECHNICAL REVIEW
		HW		
		BW		

LANDSCAPE NOTES AND DETAILS
CONSTRUCTION DOCUMENTS
ROJANGLES - J.E. BRISCOE WAY & MADISON BLVD.
MADISON, MADISON COUNTY, ALABAMA

PROJECT NUMBER
518220002
DRAWING NUMBER
L1.1

DRAWING PATH: C:\Projects\2020\5182-20-002_MJZ_Birmingham-Madison Blvd\Construction\518220002_LAN.dwg