

SITE DATA
 SITE ADDRESS: 101 J.E. BRISCOE WAY
 SITE TOTAL ACREAGE: 1.41 AC. (61,420 SF ±)
 SITE DEVELOPED ACREAGE: 1.35 AC.
 EXISTING ZONING: B3 GENERAL BUSINESS DISTRICT
 PROPOSED USE: RESTAURANT

PARKING SUMMARY
 PARKING REQUIRED: 1 SPACE PER 275 GFA=3,948/275=39 SPACES
 PARKING PROVIDED: 50 SPACES

BUILDING SIZE: 3,948 SF
BUILDING HEIGHT: ONE STORY, 22'

MINIMUM BUILDING SETBACKS:
 REQUIRED: PROVIDED:
 FRONT: 20' 104.89'(WEST) 67.24'(NORTH)
 SIDE: 15' 92.07'
 SIDF: 20' 195'

LANDSCAPE BUFFER REQUIREMENTS:
 RIGHT-OF-WAY LENGTH = 500'
 (500'-2x24') / 30 = 15 TREES REQUIRED
 7 TREES PROVIDED
 43 SHRUBS PROVIDED (= 8 TREES)

PERIMETER LANDSCAPE REQUIREMENTS:
 PERIMETER LENGTH: 490'
 490' / 50 = 10 TREES REQUIRED
 490' / 50 = 9.8 X 6 = 60 SHRUBS REQUIRED

10 TREES PROVIDED (U&D EASEMENT ON SOUTH PERIMETER)
 62 SHRUBS PROVIDED.

INTERIOR LANDSCAPING:
 PARKING PROVIDED = 50 STALLS
 50 x 18 = 900 SF INT. LANDSCAPE SPACE REQUIRED
 1,188 SF INT. LANDSCAPE SPACE PROVIDED

900 / 200 = 5 TREES REQUIRED
 900 / 200 = 4.5 X 4 = 18 SHRUBS REQUIRED

6 TREES PROVIDED
 36 SHRUBS PROVIDED

TOTAL LANDSCAPE REQUIREMENT:
 SITE AREA = 61,420 SQ. FT. x 15%
 9,213 SQ. FT. REQUIRED
 17,221 SQ. FT. PROVIDED

BUILDING CODE NOTES:
 TYPE OF CONSTRUCTION: VB - SPRINKLED
 BUILDING OCCUPANCY TYPE: A-2

OWNER: NEW GENERATION FOODS, LLC
 ADDRESS: P.O. BOX 736
 ATHENS, AL, 35612
 256.729.9136
PHONE NO.:
CONTACT NAME: JUSTIN HADDOCK
CONTACT E-MAIL ADDRESS: jhaddock@bojanglesngf.com

PROJECT REPRESENTATIVE: S&ME, INC.
 ADDRESS: 3600 QUALITY CIRCLE NW, SUITE 450
 HUNTSVILLE, ALABAMA 35806
 256.837.8882
PHONE NO.:
CONTACT NAME: BRETT WISEMAN
CONTACT E-MAIL ADDRESS: bwiseman@smeinc.com

THIS PROPERTY LIES IN ZONE "X" AS SHOWN ON THE FEDERAL INSURANCE ADMINISTRATION'S FLOOD INSURANCE RATE MAPS FOR THE CITY OF MADISON, ALABAMA, FIRM PANEL # 01089C0311F, DATED AUGUST 16, 2018.

MADISON UTILITIES
 THE UNDERSIGNED, AS AUTHORIZED BY MADISON UTILITIES OF MADISON, ALABAMA, HEREBY APPROVED THE WITHIN SITE PLAN

THIS THE 14th DAY OF MAY, 2020.

[Signature]
 MADISON UTILITIES

MADISON UTILITIES GENERAL NOTE:
 CONSTRUCTION SPECIFICATION FOR WATER AND SANITARY SEWER, LATEST EDITION AS ADOPTED BY MADISON UTILITIES (MU), IS HEREBY MADE A PART OF THESE PLANS. CONTRACTOR SHALL CONTACT MU TO SCHEDULE A PRE-CONSTRUCTION MEETING PRIOR TO THE START OF ANY WATER OR SEWER CONSTRUCTION.

CERTIFICATE OF APPROVAL BY CITY ENGINEER
 THE UNDERSIGNED, AS CITY ENGINEER OF THE CITY OF MADISON, ALABAMA HEREBY APPROVED THE WITHIN SITE PLAN

THIS THE 14th DAY OF MAY, 2020

[Signature]
 CITY ENGINEER
 CITY OF MADISON, ALABAMA

CERTIFICATE OF APPROVAL BY PLANNING DIRECTOR
 THE UNDERSIGNED, AS DIRECTOR OF PLANNING FOR THE CITY OF MADISON, ALABAMA HEREBY CERTIFIES THAT THE PROPERTY AND SITE PLAN HAS BEEN INSPECTED, REVIEWED, AND FOUND TO BE COMPLIANT WITH ZONING ORDINANCE AND SUBDIVISION REGULATIONS.

THIS THE 14th DAY OF MAY, 2020

[Signature]
 PLANNING DIRECTOR

CERTIFICATE OF APPROVAL BY FIRE DEPARTMENT
 THE UNDERSIGNED, AS A DULY AUTHORIZED REPRESENTATIVE OF THE MADISON FIRE DEPARTMENT, CITY OF MADISON, ALABAMA CERTIFIES THE WITHIN SITE PLAN HAS BEEN REVIEWED AND APPROVED

THIS THE 14th DAY OF May, 2020

[Signature]
 MADISON FIRE DEPARTMENT
 CITY OF MADISON

CONSTRUCTION DOCUMENTS

BOJANGLES - J.E. BRISCOE WAY & MADISON BLVD.

MADISON, MADISON COUNTY, ALABAMA

ISSUE DATE: 4-27-2020

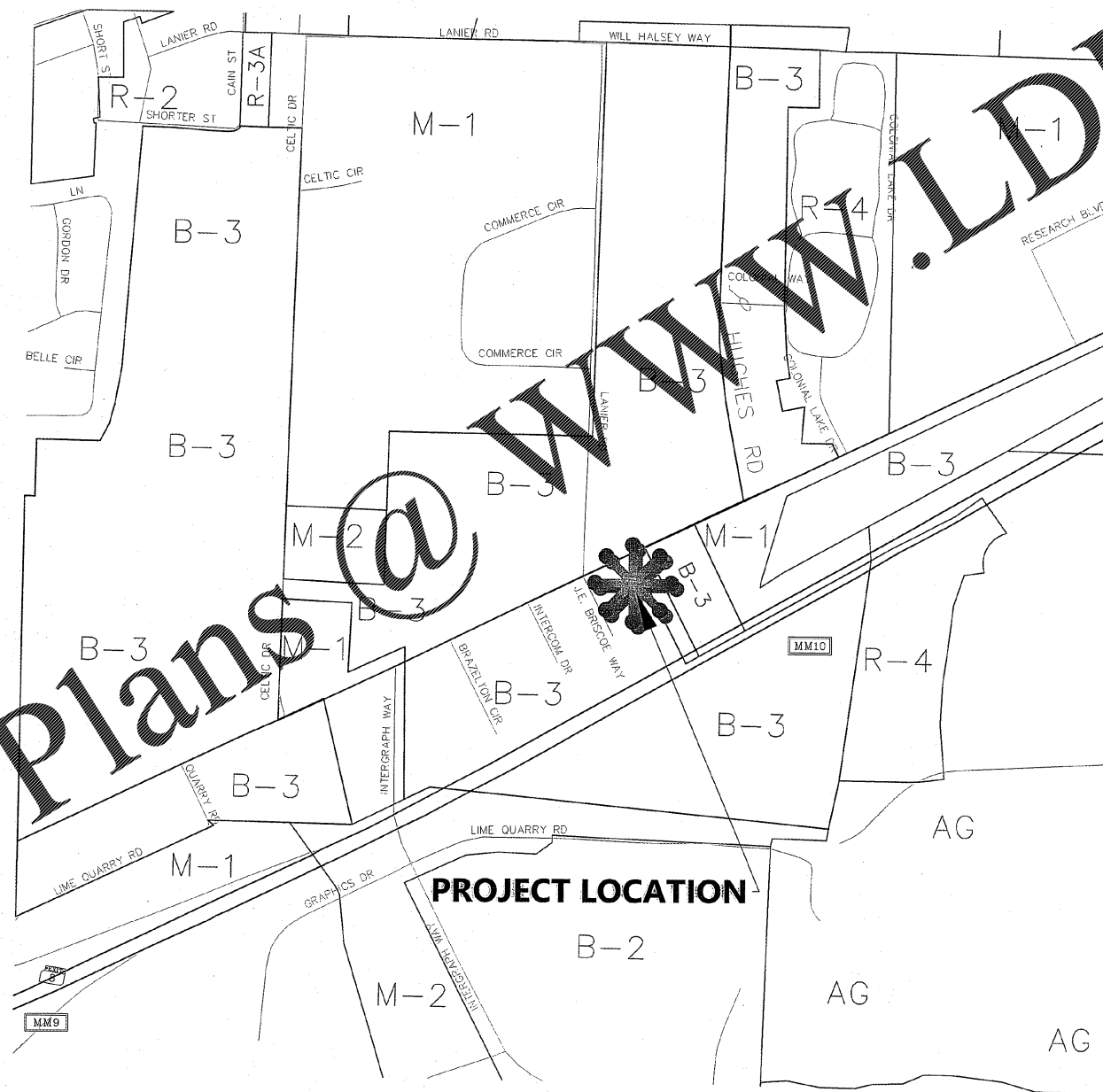

VICINITY MAP
 NOT TO SCALE

Sheet List Table	
Sheet Number	Sheet Title
COV	COVER
C1.0	EXISTING CONDITIONS & DEMOLITION PLAN
C2.0	INITIAL EROSION CONTROL PLAN
C2.1	SEDIMENT AND EROSION CONTROL DETAILS
C3.0	LAYOUT PLAN
C4.0	GRADING, DRAINAGE, AND FINAL EROSION CONTROL PLAN
C4.1	GRADING NOTES AND STORM SEWER INFORMATION
C5.0	UTILITY PLAN
C6.0	SITE DETAILS
C6.1	SITE DETAILS
C6.2	SITE DETAILS
C6.3	SITE DETAILS
L1.0	LANDSCAPE PLAN
L1.1	LANDSCAPE NOTES AND DETAILS
A-2	PROPOSED EXTERIOR ELEVATIONS

PREPARED FOR

NEW GENERATION FOODS, LLC

P.O. BOX 736
 ATHENS, AL, 35612
 256.729.9136

CIVIL ENGINEER/LANDSCAPE ARCHITECTURE



3600 QUALITY CIRCLE NW,
 SUITE 450
 HUNTSVILLE, AL 35806
 (256) 837-8882

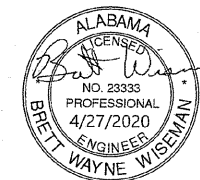

FINAL FOR DEVELOPMENT
 MAY 14, 2020

'CONSTRUCTION SPECIFICATIONS FOR WATER AND SANITARY SEWER', LATEST EDITION AS ADOPTED BY MADISON UTILITIES (MU), IS HEREBY MADE A PART OF THESE PLANS. CONTRACTOR SHALL CONTACT MU TO SCHEDULE A PRE-CONSTRUCTION MEETING PRIOR TO THE START OF ANY WATER OR SEWER CONSTRUCTION.

COV