

- TRUSS WEBS AND THEIR CONFIGURATIONS SHALL BE DESIGNED BY PRE-ENGINEERED TRUSS MANUFACTURER.
- ALL WOOD ROOF TRUSSES SHALL HAVE MINIMUM 4" NOMINAL BEARING EACH END, AND MAXIMUM 2'-0" ON CENTER SPACING, UNLESS OTHERWISE NOTED.
- WOOD ROOF TRUSSES, TEMPORARY AND PERMANENT TRUSS BRIDGING AND TRUSS BRACING SHALL BE DESIGNED BY TRUSS MANUFACTURER IN ACCORDANCE WITH STATE AND LOCAL CODES AND ALL APPLICABLE REQUIREMENTS. CONTRACTOR SHALL SUBMIT SHOP DRAWINGS AND CALCULATIONS TO THE CHRISTIAN BROTHERS AUTHORIZED REPRESENTATIVE FOR REVIEW AND APPROVAL.
- ALL TRUSSES SHALL BE SECURELY BRACED IN ACCORDANCE WITH "BRACING WOOD TRUSSES", COMMENTARY AND RECOMMENDATIONS (HB-91 & DSA-89), AS PUBLISHED BY THE TRUSS PLATE INSTITUTE.
- REFER TO LUMBER AND WOOD TRUSS NOTES FOR ADDITIONAL INFORMATION.

A TRUSS PROFILES
S-8 N.T.S.

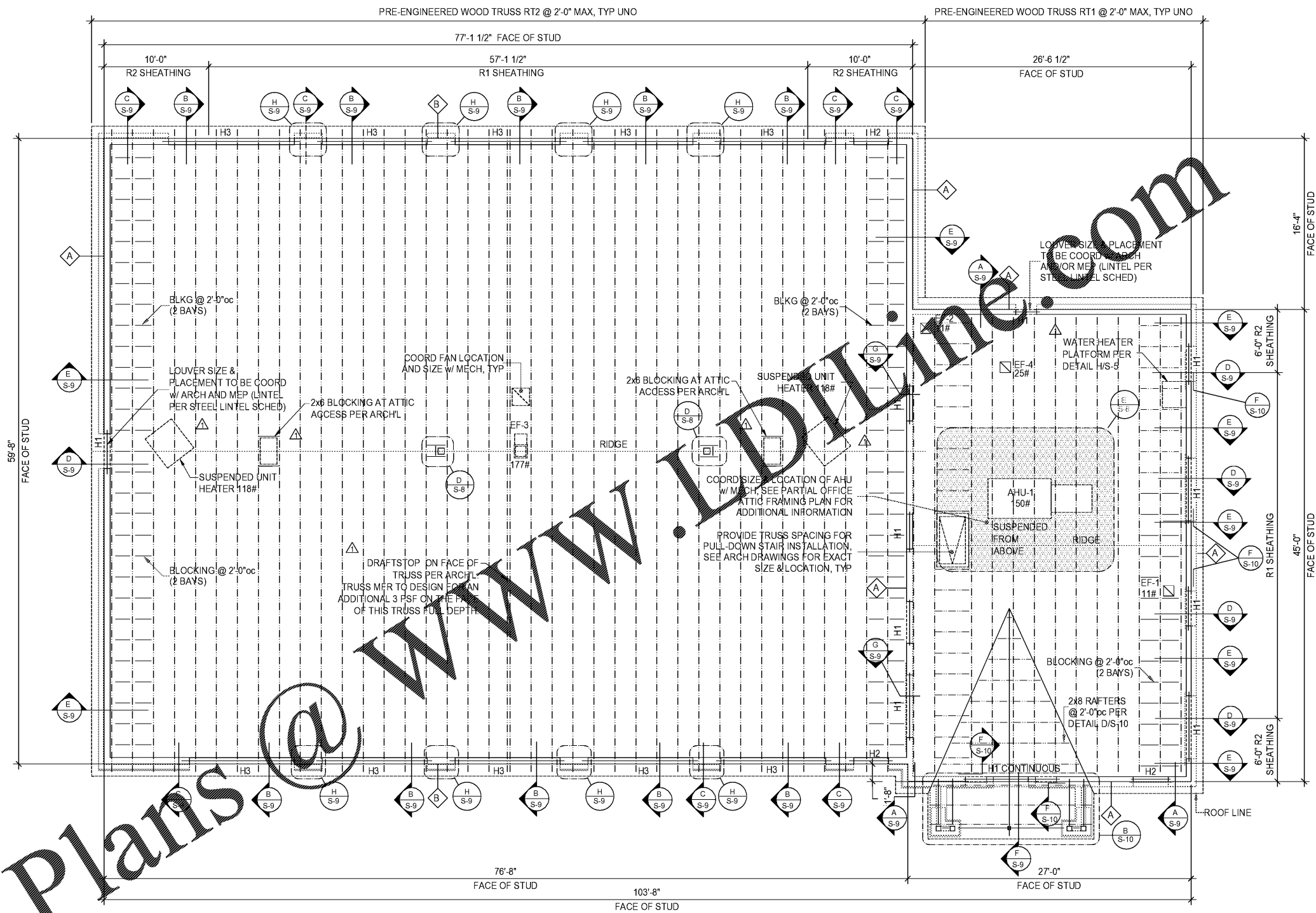

WWW.IDLINE.COM

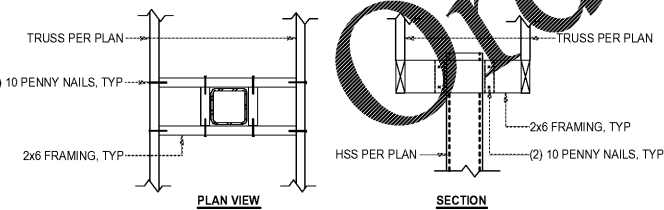

D TYP ROOF BRACING @ HSS COLUMN
S-8 N.T.S.

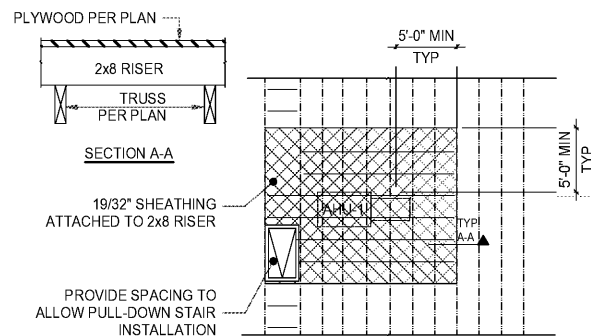

E PARTIAL OFFICE ATTIC FRAMING PLAN
S-8 N.T.S.

LEGEND - FRAMING PLAN

- INDICATES WINDOW OPENING PER ARCHITECTURAL DRAWINGS
- INDICATES HEADER PER WOOD HDR DETAIL SCHEDULE
- INDICATES TOP PLATE SPLICE PER TYPICAL TOP PLATE SPLICE DETAIL

WOOD HEADER SCHEDULE		
MARK	SIZE	JACK & KING STUDS
H1	(3) - 2x6	(1) JACK, (2) KING
H2	(3) - 2x12	(1) JACK, (2) KING STUDS & BEAM
H3	(4) 1 3/4" x 11 7/8" LVL	(2) KING STUD (2) JACK STUD

ROOF FRAMING PLAN

PLAN NOTES

- SEE SHEETS S-1 THRU S-5 FOR GENERAL NOTES AND TYPICAL DETAILS.
- ROOF CONSTRUCTION: 5/8" PLYWOOD ROOF SHEATHING, ATTACHED TO SUPPORTS PER LUMBER NOTES, SCHEDULE, AND DETAILS.
- PROVIDE TRUSS BRIDGING AND SPACING PER PLAN.
- TRUSS MANUFACTURER TO COORDINATE WITH CONTRACTORS TO DETERMINE RTU AND TRANSFORMER LAYOUTS, WEIGHTS, AND FOOTPRINTS. MANUFACTURER TO COORDINATE WITH ROOF HATCH SUPPLIER FOR SIZE AND LOCATION. RTU AND EXHAUST HOOD LOADS ARE TO BE IN ADDITION TO OTHER DESIGN LOADS.
- MAXIMUM TRUSS SPACING = 2'-0" UNO.
- ALL ELEVATIONS ARE REFERENCED FROM FINISHED MAIN FLOOR = 100'-0"
 - JST/BRG = JOIST BEARING ELEVATION = PER PLAN.
- SEE ARCH DRAWINGS FOR ADDITIONAL DIMENSIONS, SECTIONS, AND ELEVATIONS.

SCALE: 3/16" = 1'-0"

PROJECT NUMBER: 19-1252 PROJECT MANAGER: RAD
 PROJECT ENGINEER: RAD PROJECT DRAFTER: JSB

THESE DRAWINGS/CALCULATIONS ARE CONSIDERED PRELIMINARY - NOT FOR CONSTRUCTION OR RECORDING UNLESS THE STRUCTURAL ENGINEER OF RECORD'S SEAL IS AFFIXED WITH WRITTEN SIGNATURE.

CARUSO TURLEY SCOTT INC.
 consulting structural engineers
 1215 W. Rio Salado Pkwy
 Suite 200
 Tempe, Arizona 85281
 (480) 774-1700
 (480) 774-1701 FAX
 www.ctsar.com

300
 STEWART - REINDERSMA ARCHITECTURE, PLLC
 5450 E. High Street, Suite 200
 Phoenix, Arizona 85054
 P. 480.515.5123
 www.sra300.com

Christian Brothers Automotive
 Wickham Road
 Melbourne, Florida

Christian Brothers Automotive
 17725 Katy Freeway, St. 200
 Houston, TX 77064

PAUL G. SCOTT
 LICENSE
 No. 39322
 STATE OF ARIZONA
 REGISTERED PROFESSIONAL ENGINEER
 Date

Revisions

11/13/19 - Prototype Update
4/1/20 - CITY COMMENTS

Project No. 19-097
 Drawn By:
 Date: 03/06/20
 Sheet Title:
ROOF FRAMING PLAN
 Drawing No.
S-8
 10RHS-11-2019