

SHEETS BEARING THIS SEAL ARE AUTHENTICATED. RESPONSIBILITY FOR ALL OTHER PLANS, SPECIFICATIONS OR INSTRUMENTS ARE DISCLAIMED.

O'Reilly AUTO PARTS
 CORPORATE OFFICES
 233 SOUTH PATTERSON
 SPRINGFIELD, MISSOURI 65802
 (417) 862-2674 TELEPHONE

PROJECT: **NEW O'REILLY AUTO PARTS STORE**
2425 COUNTY HIGHWAY 484
OCALA, FLORIDA
FRAMING DETAILS

JS Smith Consulting Engineers, P.C.
 Florida State Capitol Building
 1801 W. 24th St. Bldg. 8, Ste. 104 - JOPUN, MISSOURI 64804
 Aaron D. Smith, P.E. License No. 78885
 O. Ben. #1026444444 FAX #178264930



DRAWN BY: **KW** CHECKED BY: **AS**
 DATE: **04/01/20**
 REVISION:
 PROJECT NUMBER:
OF7
 SHEET NUMBER

S4

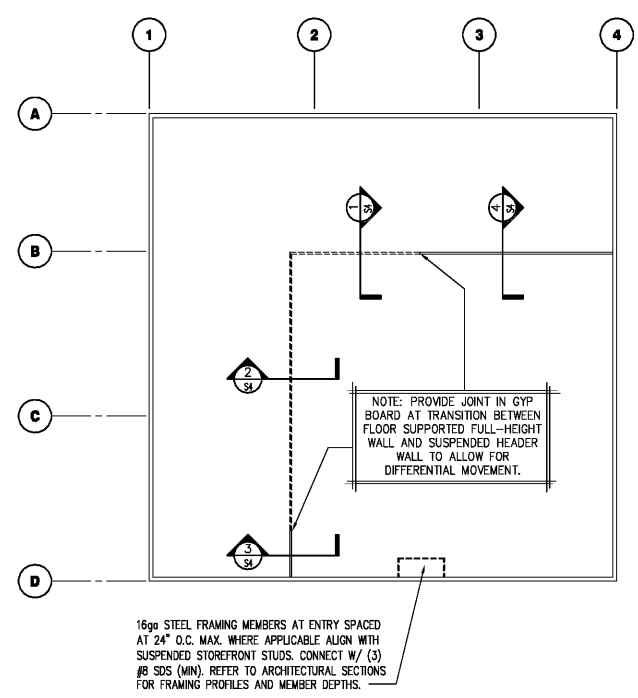

STRUCTURAL PLAN
 SCALE: NONE

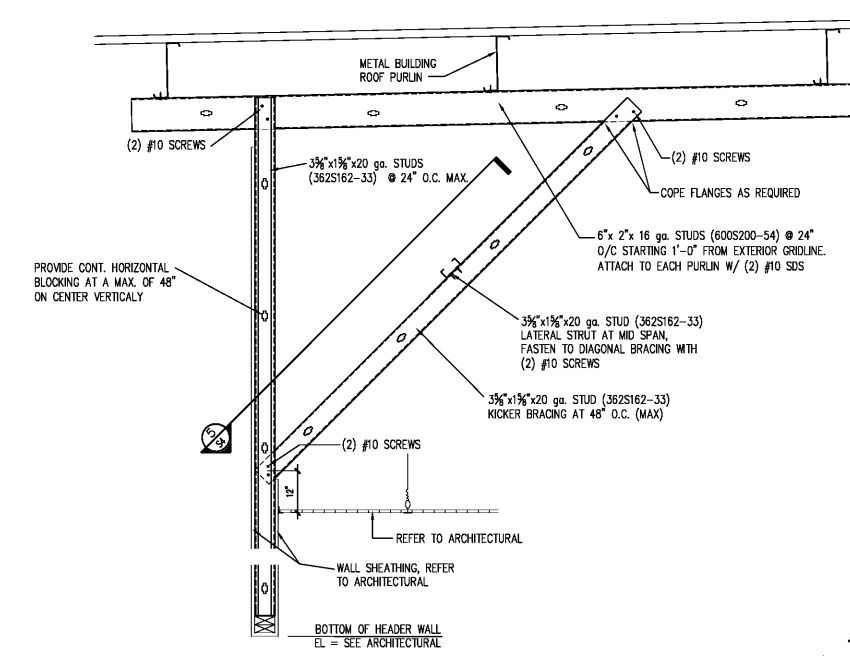

1 SECTION
 S4 SCALE: 3/4" = 1'-0"

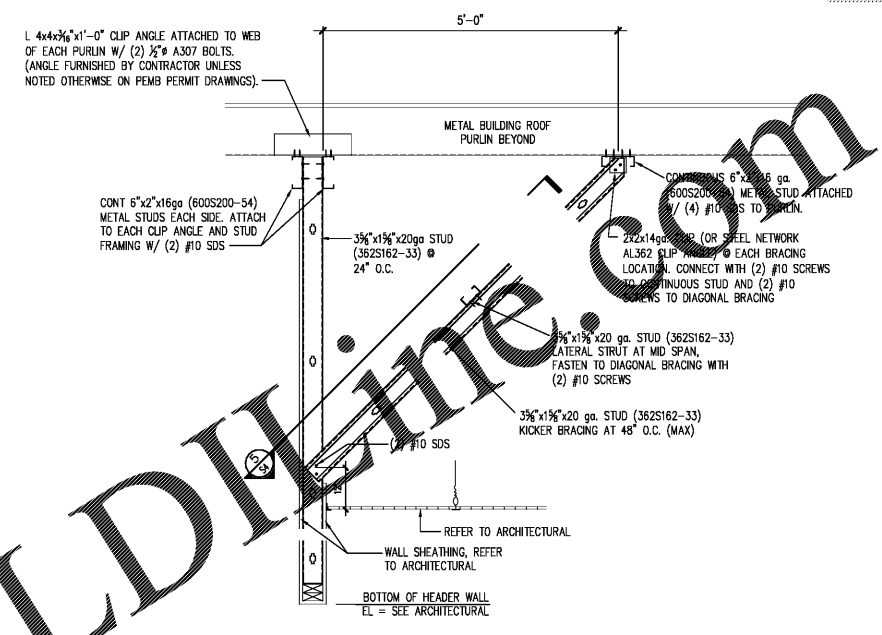

2 SECTION
 S4 SCALE: 3/4" = 1'-0"

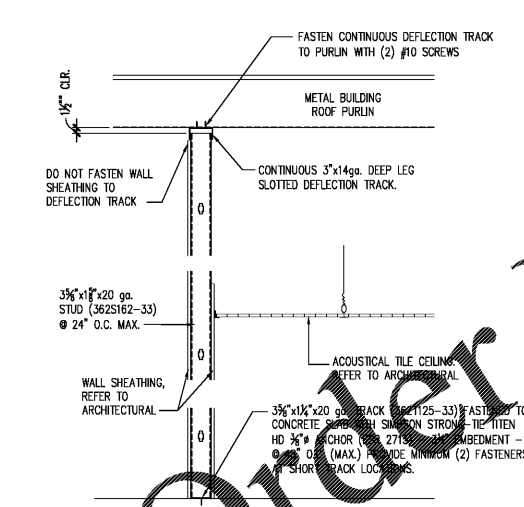

3 SECTION
 S4 SCALE: 3/4" = 1'-0"

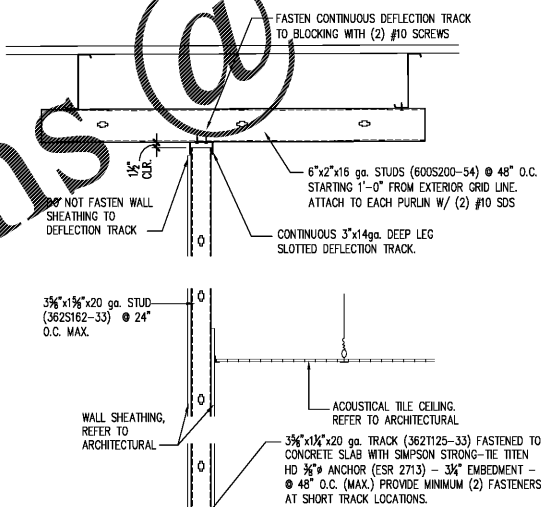

4 SECTION
 S4 SCALE: 3/4" = 1'-0"

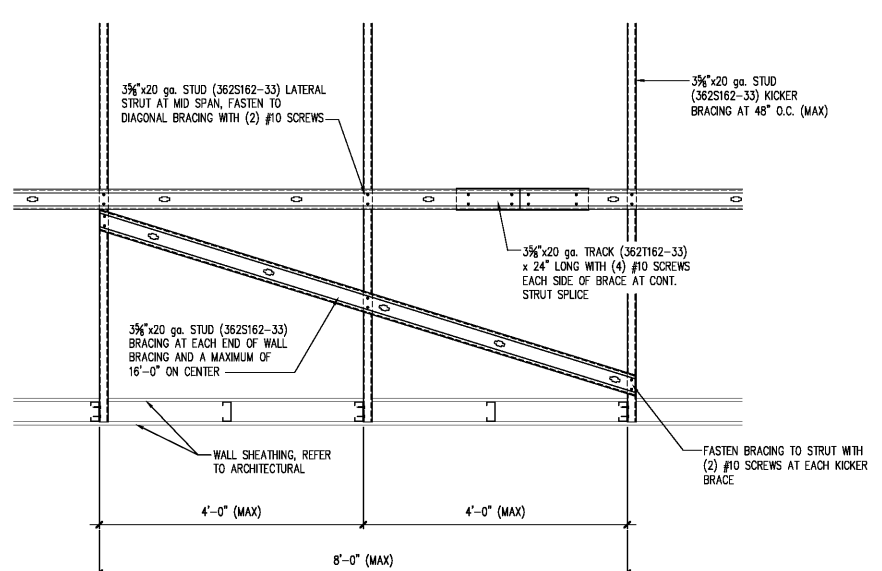

5 SECTION
 S4 SCALE: 3/4" = 1'-0"

Order Plans @ www.LDOnline.com

REPRODUCTION PROHIBITED WITHOUT THE EXPRESSED WRITTEN CONSENT OF THE DESIGN PROFESSIONAL. COPYRIGHT 2020