

SUITE-A GAS METER	
GAS LOAD AND SIZING SUMMARY:	
1. LOAD SUMMARY:	
SPACE HEATING (RTU-4)	= 100 MBH
KITCHEN AREA (FUTURE)	= 700 MBH
TOTAL	= 800 MBH
2. PIPE SIZING SUMMARY:	
<ul style="list-style-type: none"> 7" W.C INLET PRESSURE 0.5" W.C PRESSURE DROP 65 FT TOTAL EQUIV. LENGTH IFGC TABLE 402.4(2) SCHEDULE 40 METALLIC PIPE IS USED. 	
3. CONTRACTOR TO VERIFY PRESSURE AND PIPING LENGTHS ON SITE AND ADJUST PIPE SIZES IN ACCORDANCE WITH IFGC CHAPTER 4.	

SUITE-B GAS METER	
GAS LOAD AND SIZING SUMMARY:	
1. LOAD SUMMARY:	
SPACE HEATING (RTU-5)	= 100 MBH
TOTAL	= 100 MBH
2. PIPE SIZING SUMMARY:	
<ul style="list-style-type: none"> 7" W.C INLET PRESSURE 0.5" W.C PRESSURE DROP 95 FT TOTAL EQUIV. LENGTH IFGC TABLE 402.4(2) SCHEDULE 40 METALLIC PIPE IS USED. 	
3. CONTRACTOR TO VERIFY PRESSURE AND PIPING LENGTHS ON SITE AND ADJUST PIPE SIZES IN ACCORDANCE WITH IFGC CHAPTER 4.	

SUITE-C GAS METER	
GAS LOAD AND SIZING SUMMARY:	
1. LOAD SUMMARY:	
SPACE HEATING (RTU-6)	= 100 MBH
TOTAL	= 100 MBH
2. PIPE SIZING SUMMARY:	
<ul style="list-style-type: none"> 7" W.C INLET PRESSURE 0.5" W.C PRESSURE DROP 125 FT TOTAL EQUIV. LENGTH IFGC TABLE 402.4(2) SCHEDULE 40 METALLIC PIPE IS USED. 	
3. CONTRACTOR TO VERIFY PRESSURE AND PIPING LENGTHS ON SITE AND ADJUST PIPE SIZES IN ACCORDANCE WITH IFGC CHAPTER 4.	

SUITE-D GAS METER	
GAS LOAD AND SIZING SUMMARY:	
1. LOAD SUMMARY:	
SPACE HEATING (RTU-7)	= 100 MBH
TOTAL	= 100 MBH
2. PIPE SIZING SUMMARY:	
<ul style="list-style-type: none"> 7" W.C INLET PRESSURE 0.5" W.C PRESSURE DROP 155 FT TOTAL EQUIV. LENGTH IFGC TABLE 402.4(2) SCHEDULE 40 METALLIC PIPE IS USED. 	
3. CONTRACTOR TO VERIFY PRESSURE AND PIPING LENGTHS ON SITE AND ADJUST PIPE SIZES IN ACCORDANCE WITH IFGC CHAPTER 4.	

GENERAL NOTES:

- CONTRACTOR SHALL CONFIRM EXISTING CONDITIONS PRIOR TO BID.
- COORDINATE ALL MECHANICAL CONSTRUCTION WITH OTHER TRADES TO AVOID CONFLICTS.
- CONFIRM LOCATIONS OF ALL EXISTING UTILITIES AND ADJUST ROUTING OF TENANT SERVICES AS REQUIRED.
- EXISTING PLUMBING SERVICES (COLD WATER, HOT WATER, WASTE AND VENT) WHICH ARE NOT TO BE REUSED SHALL BE REMOVED BACK TO ACTIVE MAINS AND CAPPED. THERE SHALL BE NO "DEAD ENDS" LEFT IN PIPING SYSTEMS.

KEYED NOTES:

- PROVIDE ASSE 1070 TEMPERATURE VALVE, SET TO 110°F OUTLET, AT EACH LAVATORY.
- PROVIDE GAS COOKING SEDIMENT TRAP AND UNION AT CONNECTION TO EQUIPMENT. SEDIMENT TRAP SHALL BE INSTALLED AFTER THE GAS COOK AS CLOSE TO THE UNIT CONNECTION AS PRACTICAL, AND SHALL HAVE A REMOVABLE CAP FOR CLEANING.

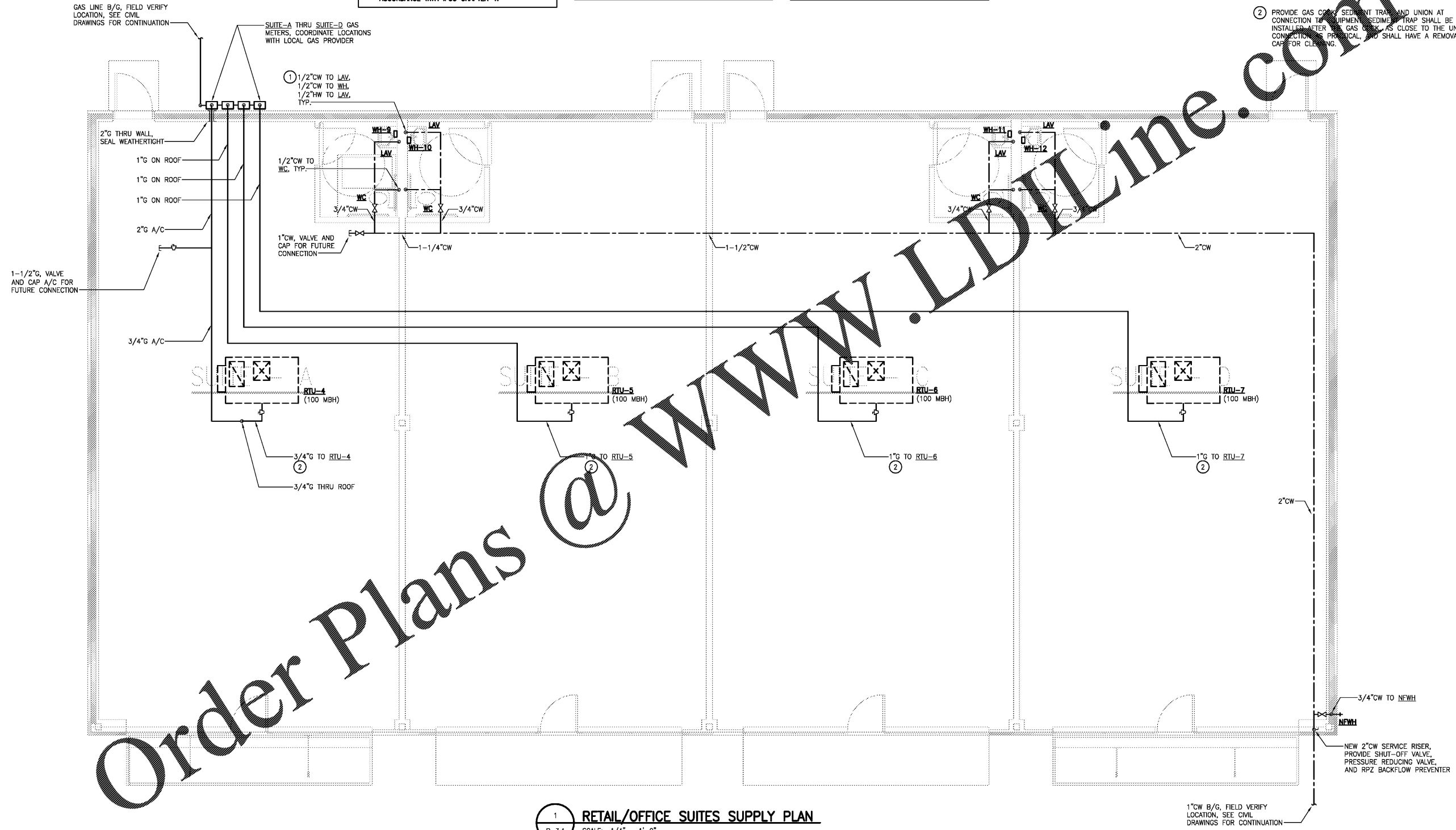

Order Plans @

1 RETAIL/OFFICE SUITES SUPPLY PLAN
P-3.1 SCALE: 1/4" = 1'-0"



engineering consultant
 general contractor
 2100 SHELITE BLVD - SUITE 400 - DULUTH, GEORGIA 30097
 VOICE: 404-254-3500 FAX: 404-254-3501
 WWW.BLACKWATERCONSTRUCTION.COM

Blackwater Construction
 2100 Shelite Blvd - Suite 400 - Duluth, Georgia 30097
 Voice: 404-254-3500 Fax: 404-254-3501
 www.blackwaterconstruction.com

RETAIL/OFFICE SUITES SUPPLY PLAN
 WILD WOLF - COMMERCIAL DEVELOPMENT
 BOYD MORRIS ROAD & GA HWY 293 SPUR
 BARTOW COUNTY, GEORGIA 30120

DRAWING NO. P-3.1
 DATE 06/16/20