

N:\2020 Projects\Substation\Retail Development\20-0135_Topography\Restaurant\Byron G&E\Engineering\Contributions\Document\20-0135-C.dwg Apr 22, 2020 - 8:58 am

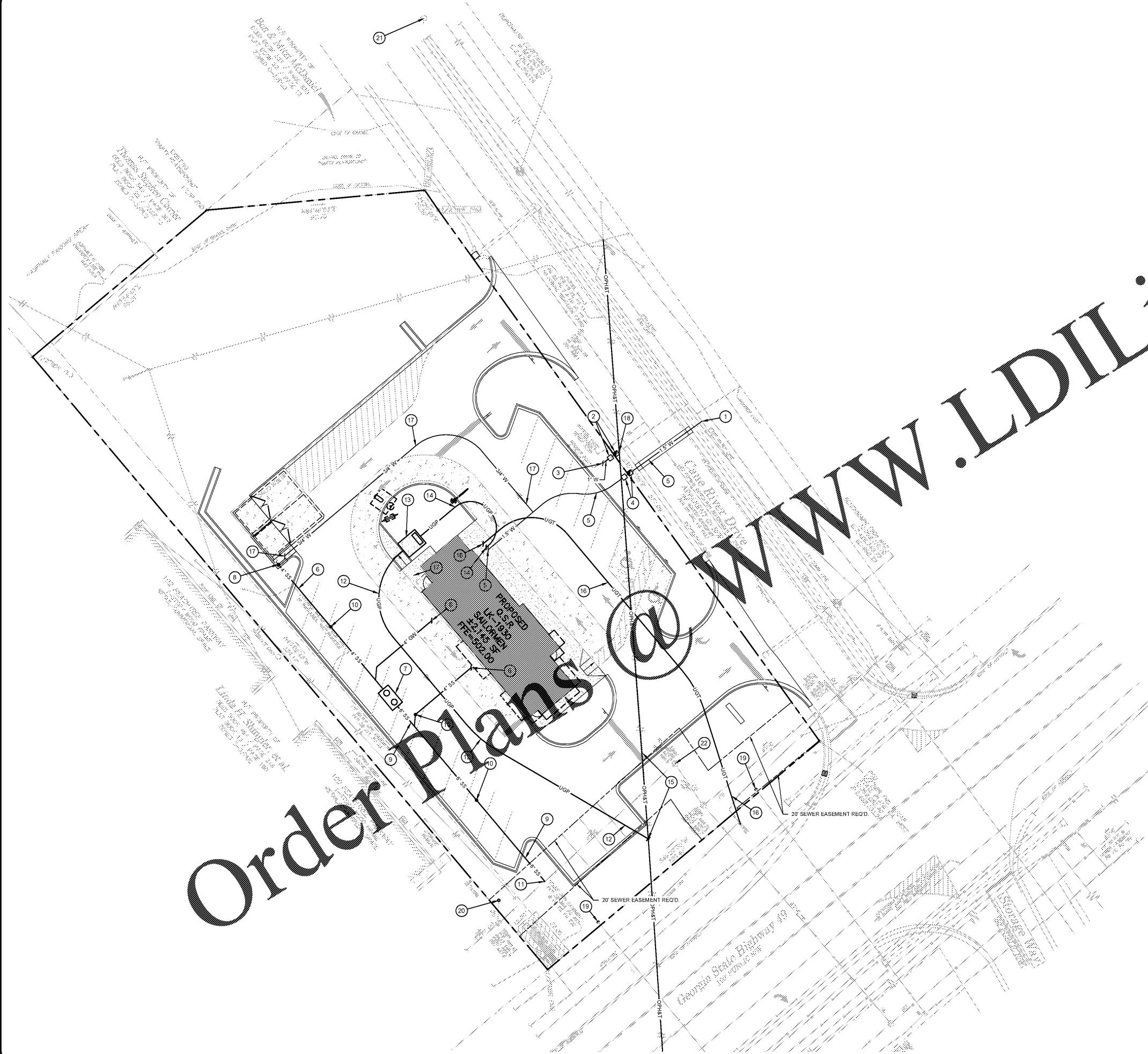

Order Plans

WWW.LDILine.com

UTILITY LEGEND

- 1 TIE TO EXISTING WATER SERVICE REQ'D. PER WATER COMPANY SPECIFICATIONS.
- 2 1" IRRIGATION WATER METER AND BACKFLOW PREVENTER REQ'D. PER WATER COMPANY SPECIFICATIONS.
- 3 1" IRRIGATION WATER SERVICE REQ'D. SEE IRRIGATION PLANS FOR CONTINUATION INTO SITE.
- 4 1/2" DOMESTIC WATER METER AND BACKFLOW PREVENTER REQ'D. PER WATER COMPANY SPECIFICATIONS.
- 5 1/2" DOMESTIC WATER SERVICE REQ'D. SEE PLUMBING PLANS FOR CONTINUATION INTO BUILDING. SERVICE UP TO METER SHALL BE PER WATER COMPANY SPECIFICATIONS.
- 6 4" SANITARY SEWER LATERAL @ MINIMUM 2.0% GRADE REQ'D. SEE PLUMBING PLANS FOR CONTINUATION INTO BUILDING.
- 7 GREASE TRAP REQ'D. SEE BUILDING PLANS FOR DETAILS.
- 8 DUMPSTER DRAIN REQ'D. SEE BUILDING PLANS FOR DETAILS. TOP = 500.70
- 9 6" SANITARY SEWER LATERAL @ MINIMUM 1.0% GRADE REQ'D.
- 10 ONE-WAY CLEANOUT REQ'D. SEE DETAIL.
- 11 TIE TO EXISTING SANITARY SEWER MAIN REQ'D. PER SEWER COMPANY SPECIFICATIONS.
- 12 (2) 5" PVC CONDUITS FOR PRIMARY UNDERGROUND ELECTRICAL SERVICE REQ'D. PER POWER COMPANY SPECIFICATIONS.
- 13 CONCRETE TRANSFORMER PAD REQ'D. PER POWER COMPANY SPECIFICATIONS.
- 14 SECONDARY UNDERGROUND ELECTRICAL SERVICE REQ'D. SEE ELECTRICAL PLANS FOR MORE INFORMATION.
- 15 RELOCATE EXISTING UTILITY POLE REQ'D. CONTRACTOR SHALL COORDINATE WITH POWER COMPANY.
- 16 UNDERGROUND TELECOMMUNICATIONS SERVICE REQ'D. PER TELEPHONE COMPANY SPECIFICATIONS. CONTRACTOR SHALL COORDINATE WITH TELEPHONE COMPANY.
- 17 3/4" DOMESTIC WATER SERVICE REQ'D. SEE ARCHITECTURAL PLANS FOR WATER CONNECTION AT DUMPSTER.
- 18 TIE TO EXISTING WATER STUBOUT REQ'D. PER WATER COMPANY SPECIFICATIONS.
- 19 CAP AND PLUG EXISTING WATER SERVICE REQ'D. PER WATER COMPANY SPECIFICATIONS.
- 20 SAWCUT AND REMOVE EXISTING SEWER LATERAL REQ'D. PER WATER COMPANY SPECIFICATIONS AND TERMINATE WITH CLEANOUT.
- 21 EXISTING FIRE HYDRANT.
- 22 ADJUST TOP OF EXISTING MANHOLE REQ'D. PER SEWER COMPANY SPECIFICATIONS. TOP = 501.00

UTILITY NOTES

- 1. CONTRACTOR SHALL NOTIFY THE UTILITY AUTHORITIES INSPECTORS 72 HOURS BEFORE CONNECTING TO ANY EXISTING LINE.
- 2. LINES UNDERGROUND SHALL BE INSTALLED, INSPECTED, AND APPROVED BEFORE BACKFILLING.
- 3. CONTRACTOR IS CAUTIONED THAT ALL UTILITIES ON SITE MAY NOT BE SHOWN AND THE UTILITIES SHOWN ARE APPROXIMATE.
- 4. THE MINIMUM HORIZONTAL CLEARANCE BETWEEN WATER SUPPLY LINES AND SANITARY SEWER LINES IS 10 FEET. THE MINIMUM VERTICAL CLEARANCE BETWEEN WATER SUPPLY LINES AND SANITARY SEWER LINES IS 18".
- 5. FOR ALL DOMESTIC WATER SERVICES, FIRE PROTECTION, SANITARY SEWER, GAS, TELEPHONE, AND POWER ENTANCES TO THE BUILDING, REFER TO APPROPRIATE PLANS IN ARCHITECTURAL DRAWINGS FOR EXACT LOCATIONS. FIELD MODIFY LOCATIONS SHOWN, IF REQUIRED.
- 6. SANITARY SEWER LATERAL PIPE SHALL BE SDR 26 PVC OR CLASS 350 DIP.
- 7. WATER SERVICES SHALL BE COPPER TUBE TYPE L (SOFT) PER ANSI 816.22 OR PVC, 200 PSI, PER ASTM D1784 AND D2241.
- 8. CONTRACTOR SHALL MAINTAIN A MINIMUM OF 3'-0" COVER ON ALL WATER LINES.
- 9. IN THE EVENT OF A VERTICAL CONFLICT BETWEEN WATER LINES, SANITARY LINES, STORM LINES, AND GAS LINES (EXISTING AND PROPOSED) OR WHERE A MINIMUM CLEARANCE OF 18" CANNOT BE MAINTAINED, THE SANITARY LINE SHALL BE DUCTILE IRON PIPE WITH MECHANICAL JOINTS AT LEAST 10 FEET ON BOTH SIDES OF THE CROSSING, AND THE WATER LINE SHALL HAVE MECHANICAL JOINTS WITH APPROPRIATE THRUST BLOCKING AS REQUIRED TO PROVIDE A MINIMUM OF 18" OF CLEARANCE, MEETING THE REQUIREMENTS OF ANSI A21.10 OR ANSI C11.11 (AWWA C-151) (CLASS 50). BACKFLOW PREVENTION SHALL BE PROVIDED BY THE CONTRACTOR ON DOMESTIC WATER SERVICE, IRRIGATION, AND FIRE PROTECTION SYSTEMS IN ACCORDANCE WITH WATER DEPARTMENT REQUIREMENTS, SPECIFICATIONS, AND PROCEDURES.
- 11. THE CONTRACTOR SHALL BE RESPONSIBLE FOR COMPLETING ALL WATER, GAS, ELECTRIC, TELEPHONE SERVICES FROM THE POINT THE UTILITY SERVICE COMPLETES THEIR WORK TO THE POINT OF SERVICE AT THE BUILDING.
- 12. REFER TO INTERIOR PLUMBING DRAWINGS FOR TIE-IN OF WATER, SEWER, AND GAS SERVICES.
- 13. REFER TO ELECTRICAL PLANS FOR MENU BOARD, SIGN, AND SITE LIGHTING CONDUITS AND CIRCUITRY AND FOR TIE-IN OF POWER AND TELEPHONE SERVICES.

NO.	REVISIONS	DESCRIPTION
0	ISSUED FOR PERMITTING	

SITE UTILITY PLAN

FAST FOOD RESTAURANT
 GEORGIA HIGHWAY 49 & CAJON RIVER DRIVE
 BYRON, GEORGIA
30AIP BYRON, LLC
 SANTA ROSA BEACH, FLORIDA

DWN. BY: M. SIMS, PE
 CKD. BY: M. GONZALEZ, PE

SCALE: 1"=20'

DATE: 4/9/2020

GONZALEZ - STRENGTH & ASSOCIATES, INC.
 CIVIL ENGINEERING - TRANSPORTATION ENGINEERING - LAND SURVEYING
 LAND PLANNING - LANDSCAPE ARCHITECTURE
 1550 WOODS OF RIVERCHASE DRIVE SUITE 200
 HOOPER, ALABAMA 35024
 PHONE: (205) 445-5050
 FAX: (205) 445-5058
 WWW.GONZALEZ-STRENGTH.COM

© Copyright 2020



DWG. NO.
C5.0

PROJECT
20-0135