

N:\2020 Projects\Substation Retail Development\CD-0135\_Topography\Restaurant Byron GAE\Engineering\Construction Documents\0135-C.dwg Apr 23, 2020 - 7:38 am

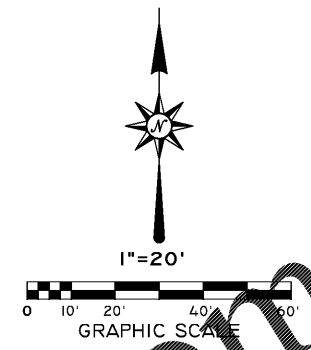
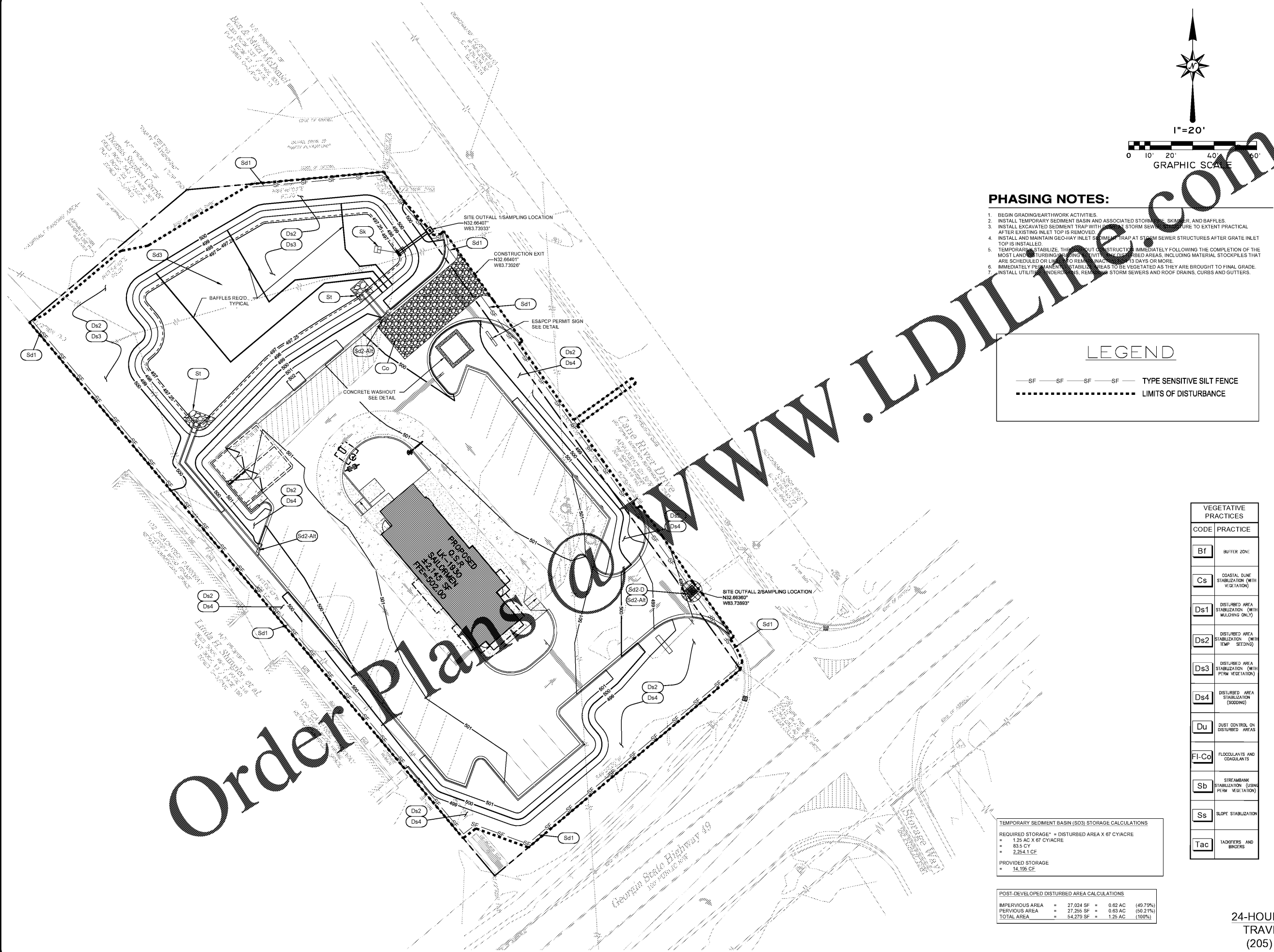

**PHASING NOTES:**

- BEGIN GRADING/EARTHWORK ACTIVITIES.
- INSTALL TEMPORARY SEDIMENT BASIN AND ASSOCIATED STORM SEWER SKIMMER, AND BAFFLES.
- INSTALL EXCAVATED SEDIMENT TRAP WITH 1' STORM SEWER INLET TO EXTENT PRACTICAL AFTER EXISTING INLET TOP IS REMOVED.
- INSTALL AND MAINTAIN GEO-HAY INLET SEDIMENT TRAP AT STORM SEWER STRUCTURES AFTER GRATE INLET TOP IS INSTALLED.
- TEMPORARILY STABILIZE THE DISTURBED AREAS IMMEDIATELY FOLLOWING THE COMPLETION OF THE MOST LAND DISTURBING WORK IN ANY DISTURBED AREAS, INCLUDING MATERIAL STOCKPILES THAT ARE SCHEDULED OR LIKELY TO REMAIN IN CONTACT WITH THE SOIL FOR 13 DAYS OR MORE.
- IMMEDIATELY PERMANENTLY STABILIZE AREAS TO BE VEGETATED AS THEY ARE BROUGHT TO FINAL GRADE.
- INSTALL UTILITIES UNDER EXISTING RELAY BOXES, STORM SEWERS AND ROOF DRAINS, CURBS AND GUTTERS.

**LEGEND**

- SF — SF — SF — SF — TYPE SENSITIVE SILT FENCE
- LIMITS OF DISTURBANCE

CODE	PRACTICE
Bf	BUFFER ZONE
Cs	COASTAL DUNE STABILIZATION (WITH VEGETATION)
Ds1	DISTURBED AREA STABILIZATION (WITH MULCHING ONLY)
Ds2	DISTURBED AREA STABILIZATION (WITH TEMP. SEEDING)
Ds3	DISTURBED AREA STABILIZATION (WITH PERM. VEGETATION)
Ds4	DISTURBED AREA STABILIZATION (SOODING)
Du	DUST CONTROL ON DISTURBED AREAS
Fl-Co	FLOCCULANTS AND COAGULANTS
Sb	STREAMBANK STABILIZATION (USING PERM. VEGETATION)
Ss	SLOPE STABILIZATION
Tac	TACKIFIERS AND BINDERS
Bf	VEGETATIVE PRACTICES

STRUCTURAL PRACTICES	
CODE	PRACTICE
Cd	CHECKDAM
Ch	CHANNEL STABILIZATION
Co	CONSTRUCTION EXIT
Cr	CONSTRUCTION ROAD STABILIZATION
Dc	STREAM DIVERSION CHANNEL
Di	DIVERSION
Dn1	TEMPORARY DOWNDRAIN STRUCTURE
Dn2	PERMANENT DOWNDRAIN STRUCTURE
Fr	FILTER RING
Ga	GABION
Gr	GRADE STABILIZATION STRUCTURE
Lv	LEVEL SPREADER
Rd	ROCK FILTER DAM
Re	RETAINING WALL
Rt	RETRO FITTING
Sd1	SEDIMENT BARRIER
Sd2	INLET SEDIMENT TRAP
Sd3	TEMPORARY SEDIMENT BASIN
Sd4	TEMPORARY SEDIMENT TRAP
Sk	FLOATING SURFACE SKIMMER
Spb	SEEP BERM
Sr	TEMPORARY STREAM CROSSING
St	STORMDRAIN OUTLET PROTECTION
Su	SURFACE ROUGHENING
Tc	TURBIDITY CURTAIN
Tp	TOPSOILING
Tr	TREE PROTECTION
Wt	VEGETATED WATERWAY OR STORMWATER CONVEYANCE CHANNEL

**TEMPORARY SEDIMENT BASIN (SD3) STORAGE CALCULATIONS**  
 REQUIRED STORAGE\* = DISTURBED AREA X 67 CY/ACRE  
 = 1.25 AC X 67 CY/ACRE  
 = 83.5 CY  
 = 2,254.1 CF  
 PROVIDED STORAGE  
 = 14,195 CF

**POST-DEVELOPED DISTURBED AREA CALCULATIONS**  
 IMPERVIOUS AREA = 27,024 SF = 0.62 AC (49.79%)  
 PERVIOUS AREA = 27,255 SF = 0.63 AC (50.21%)  
 TOTAL AREA = 54,279 SF = 1.25 AC (100%)

DATE	DESCRIPTION
4/21/2020	ISSUED FOR PERMITTING
0	

**ES&PCP - PHASE II**  
**FAST FOOD RESTAURANT**  
 GEORGIA HIGHWAY 49 & CANE RIVER DRIVE  
 BYRON, GEORGIA  
**30AIP BYRON, LLC**  
 SANTA ROSA BEACH, FLORIDA  
 DWN. BY M. SIMS, PE  
 CND. BY J. DANIEL, PE  
 SCALE 1"=20'  
 DATE 4/9/2020

**GONZALEZ - STRENGTH & ASSOCIATES, INC.**  
 CIVIL ENGINEERING - TRANSPORTATION ENGINEERING - LAND SURVEYING  
 LAND PLANNING - LANDSCAPE ARCHITECTURE  
 1550 WOODS OF RIVERCHASE DRIVE SUITE 200  
 HOOPER, ALABAMA 35024  
 PHONE (205) 942-5086  
 FAX (205) 942-5088  
 WWW.GONZALEZ-STRENGTH.COM  
 © Copyright 2020

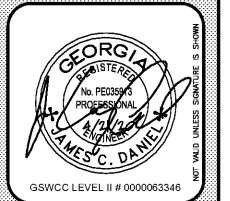

**24-HOUR CONTACT**  
 TRAVIS MEYER  
 (205) 370-0362

DWG. NO. C4.4  
 PROJECT 20-0135