

KEYED NOTES:

- 1 4" (MIN.) SANITARY SEWER. CONNECT TO MAIN. COORDINATE WITH CIVIL. VERIFY INVERT REQUIREMENTS PRIOR TO COMMENCEMENT OF WORK.
- 2 PROVIDE AND INSTALL A SCHIER GB-250 GREASE INTERCEPTOR. VERIFY EXACT REQUIREMENTS WITH AHJ AND CIVIL. REFER TO DETAIL ON SHEET P-3 FOR MINIMUM REQUIREMENTS. VERIFY INVERT REQUIREMENTS PRIOR TO COMMENCEMENT OF WORK. SEE CIVIL FOR EXACT LOCATION OF GREASE INTERCEPTOR.
- 3 TRENCH DRAINS IN RESTROOMS SHALL HAVE TRAP PRIMERS INSTALLED. REFER TO SHEET P-2 FOR PRIMER LOCATION AND SPECIFICATIONS.
- 4 STEAMER'S (ITEM #15) WASTE LINE BRANCH SHALL BE CAST IRON.
- 5 ROUTE CONDENSATE DRAIN FROM FREEZER/COOLER EVAPORATOR COILS AND SPILL TO HUB DRAIN AT STEAMER. PROVIDE A 2" AIR GAP.
- 6 4" VENT THRU ROOF. MAINTAIN 10 FEET TO AIR INTAKES ON ROOF.
- 7 PROVIDE AND INSTALL ROOF DRAIN (RD) AND 4" PVC LEADER. REFER TO SCHEDULE ON P-3 FOR ROOF DRAIN. REFER TO ARCHITECTURAL SHEETS FOR DETAILS AND INFORMATION OF SECONDARY DRAINAGE. EXTEND STORM LINE DOWN IN WALL WITH ACCESSIBLE CLEANOUT. REFER TO CIVIL FOR CONTINUATION.
- 8 FLOOR SINK FOR DISHWASHER (#30) SHALL BE CONNECTED TO SEWER NOT GREASE WASTE.

GREASE INTERCEPTOR CALCULATION

FIXTURE	DIMENSION	2 MIN. DRAIN	QTY
3 COMP	18" x 24" x 14" (3)	29.45	1
HAND	10" x 14" x 5"	3.42	3
JANITOR SINK	36" x 24" x 6"	8.42	1
VEGGIE PREP SINK	18" x 24" x 14"	9.82	1
TOTAL		51.1 GPM	

PROVIDE AN EXTERIOR, SCHIER GB-250 GREASE INTERCEPTOR. VENT PER LOCAL CODE.

ROOF DRAINAGE CALCULATION

AREA OF FLAT ROOF	2,061 SQFT
VERTICAL WALL AND PARAPET	314 SQFT
TOTAL SURFACE AREA TO DRAIN	2,375 SQFT
@ 1/4" SLOPE & 4 IN/HR = 4" REQUIRED	

(2) TWO 4" ROOF DRAINS PROVIDED

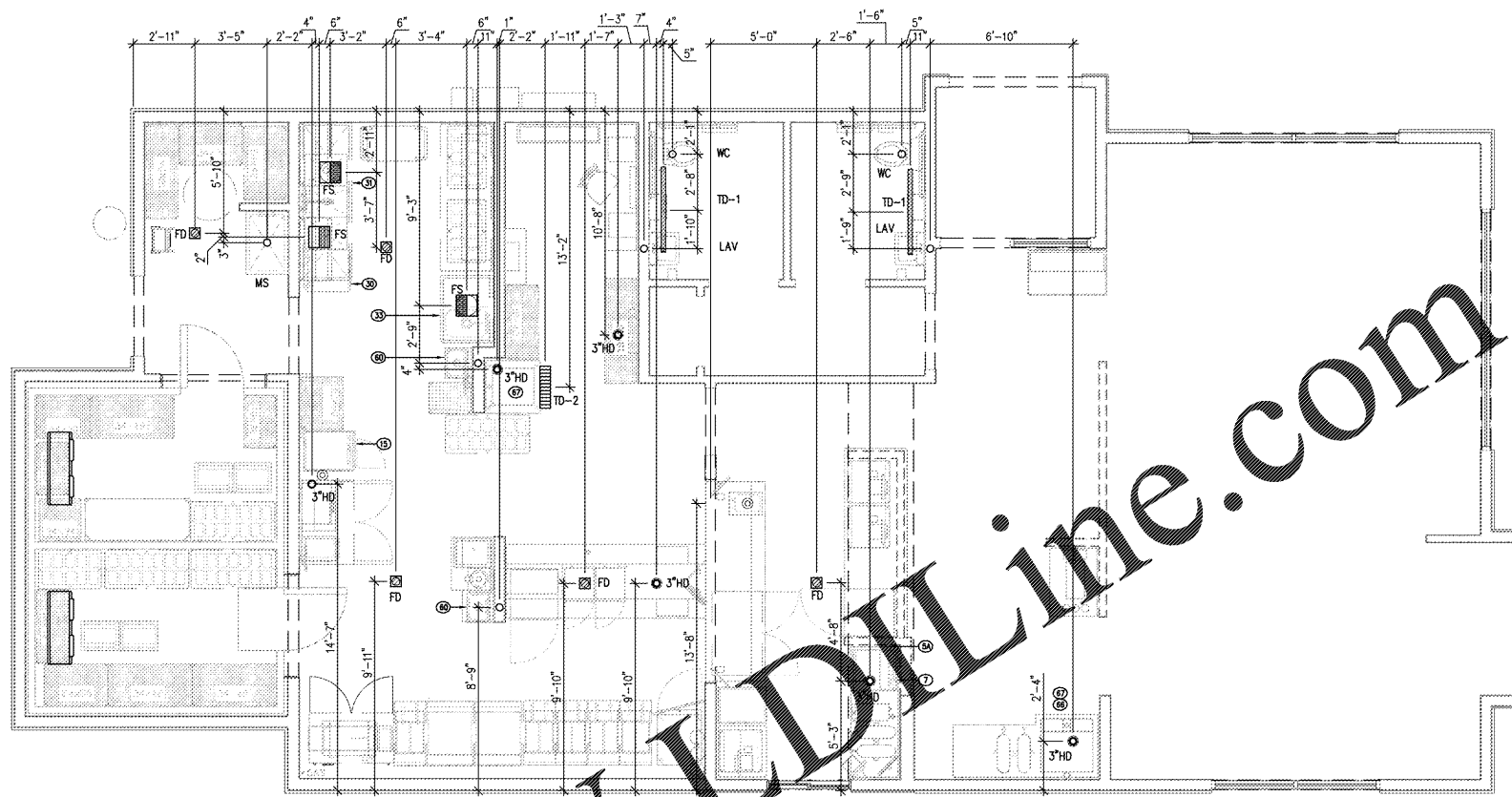

2 SANITARY ROUGH-IN PLAN

P-1 SCALE 1/4" = 1'-0"

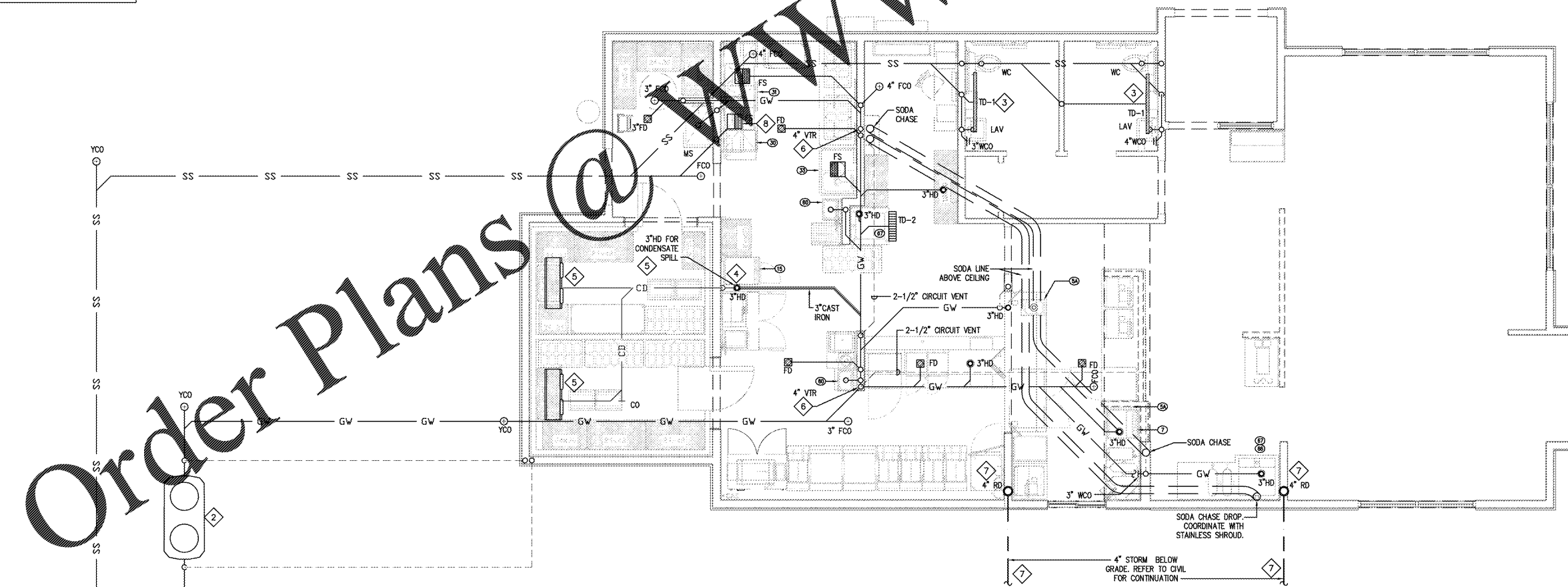

1 SANITARY FLOOR PLAN

P-1 SCALE 1/4" = 1'-0"

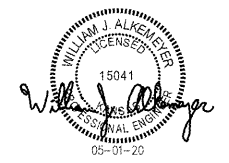

A NEW LOCATION FOR
CAPTAIN D'S
 7525 STATE AVENUE
 KANSAS CITY, KS 66112
CAPTAIN D'S, LLC
 624 GRASSMERE PARK DRIVE,
 SUITE 30
 NASHVILLE, TN 37211

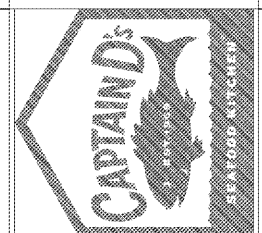

Job Number:

Revisions:

P-1
 PLUMBING-WASTE
 FLOOR PLAN

Order Plans @ www.JDLine.com