

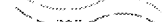





MATCHLINE - SEE GRADING AND DRAINAGE PLAN NO. 1

LEGEND

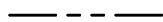
-  EXISTING CONTOUR
-  PROPOSED CONTOUR
-  PROPOSED PAVEMENT
-  GRADING LIMITS
-  EXISTING PIPE
-  PROPOSED PIPE



Michael Baker INTERNATIONAL

Designer: CPC	
Technician: KJM	
Checked by: JWS	
Project Number: 174297	

- Notes:
- REFER TO DRAWING BM-1 FOR SITE BENCHMARK DATA.
 - PROPOSED CONTOURS ARE AT 0.5' AND 1.0' INTERVALS.
 - CONTRACTOR SHALL LOCATE FAA AND AIRFIELD ELECTRICAL CABLES PRIOR TO CONSTRUCTION, AND HAVE CABLE LOCATIONS FIELD VERIFIED BY AIRPORT PRIOR TO DEMOLITION AND GRADING TO ENSURE NO CABLES ARE CUT. CONTRACTOR SHALL PAY ALL FEES ASSOCIATED WITH REPAIRS AND FINES PER PROJECT SPECIFICATIONS.
 - REFER TO PIPE PROFILES AND DRAINAGE DETAILS FOR ADDITIONAL STORM DRAINAGE INFORMATION.

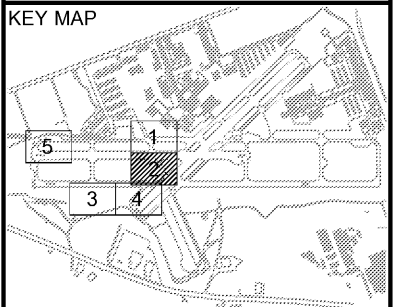

REVISIONS

No.	Description	Date	By

Project Name:
RUNWAY INCURSION MITIGATION IMPROVEMENTS (PDK 11)

Drawing Name:
GRADING AND DRAINAGE PLAN NO. 2

ITB# 20-101257

Date: FEBRUARY, 2020	Sheet Number: 21 of 72
Scale: 1" = 30'	Drawing Number: GP-2

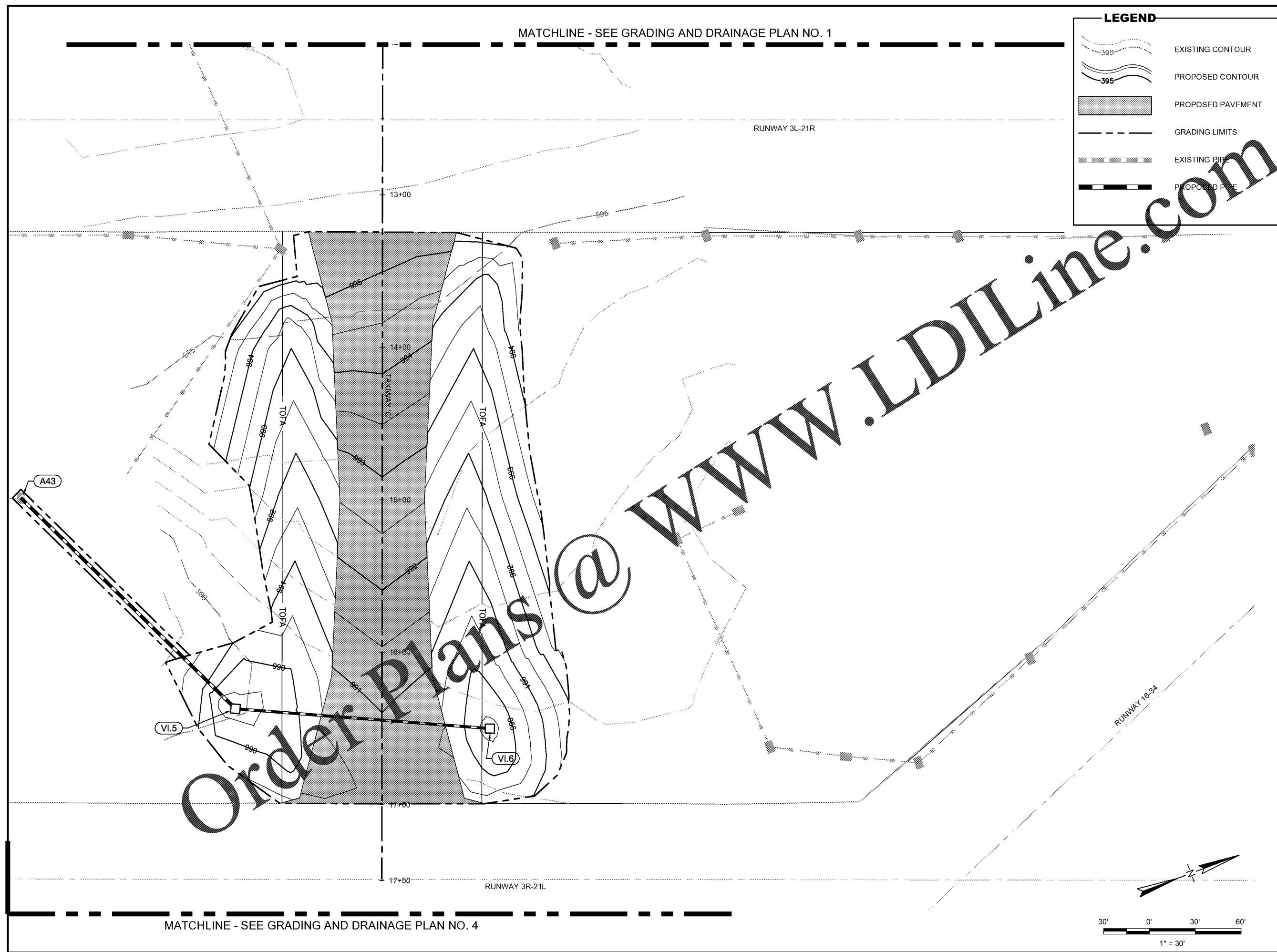

MATCHLINE - SEE GRADING AND DRAINAGE PLAN NO. 4