

ENGINEER'S SEAL:



Digitally signed
by Harold G
Higgenbotham
Date:
2020.02.12
17:28:13 -05'00'

HAROLD G. HIGGENBOTHAM, P.E.
VIRGINIA LIC. NO. 042964

REVISIONS
NO. DATE REMARKS

FOOD LION
2110 Executive Drive, Salisbury, NC 28145
Telephone: 704.633.8550
www.foodlion.com
Food Lion is a DISCOUNT AMERICA company.

FOOD LION
REMODEL
STORE #1208
13490 DUMFRIES RD
MANASSAS, VA 20112

PROJECT NO: 2019.0917
DATE: 02-13-20

21 OF 47
S1.01
STRUCTURAL SLAB PLAN

CHECKED: HIGH DRAWN: RED

STRUCTURAL SLAB PLAN
SCALE: 3/32" = 1'-0"



FOUNDATION NOTES:

- 1.) TOP OF EXISTING SLAB = 0'-0" FIELD VERIFY. 0'-0" IS FOR REFERENCE ONLY.
- 2.) SEE ARCHITECTURAL DRAWINGS FOR DIMENSIONS NOT SHOWN.
- 3.) SEE ARCH. AND MECH FOR ALL SLEEVE PIPES, INSERTS AND EMBEDDED ITEMS.
- 4.) SEE ARCH. FOR SLOPES AND RECESSES.
- 5.) APPROX. LIMITS OF CONC. SLAB REPLACEMENT. SEE ARCH FOR LOCATION AND EXTENTS. WHERE REQUIRED, PROVIDE NEW 4" THICK CONCRETE SLAB ON GRADE REINF. W/6X6 W1.4 x W1.4 WWF, ON 10 MIL VAPOR BARRIER ON 4" COMPACTED POROUS BASE, ON COMPACTED FILL PER GEOTECHNICAL ENGINEER'S RECOMMENDATIONS. DOWEL NEW SLAB INTO EXIST. SLAB PER SECTION 1/SS.01.
- 6.) SLAB INFILL AT EXISTING HUB DRAIN. SEE ARCH FOR LOCATION AND EXTENTS. PROVIDE NEW 4" MIN. THICK CONCRETE SLAB ON GRADE ON 10 MIL VAPOR BARRIER ON 4" COMPACTED POROUS BASE, ON COMPACTED FILL PER GEOTECHNICAL ENGINEER'S RECOMMENDATIONS. ROUGHEN SIDES OF EXISTING SLAB OPENING AND APPLY BONDING AGENT PRIOR TO PLACING NEW CONCRETE.
- 7.) APPROX. LIMITS OF CONC. SLAB INFILL AT EXISTING PIT. SEE ARCH FOR LOCATION AND EXTENTS. WHERE REQUIRED, PROVIDE NEW 4" THICK CONCRETE SLAB ON GRADE REINF. W/6X6 W1.4 x W1.4 WWF, ON 10 MIL VAPOR BARRIER ON 4" COMPACTED POROUS BASE, ON COMPACTED FILL PER GEOTECHNICAL ENGINEER'S RECOMMENDATIONS. DOWEL NEW SLAB INTO EXIST. SLAB PER SECTION 1/SS.01. AT QUARRY TILE LOCATIONS, RECESS TOP OF NEW CONCRETE SLAB INFILL AT PIT PER SECTION 2/SS.01.
- 8.) RECESS TOP OF NEW CONCRETE SLAB TO ALLOW TOP OF QUARRY TILE TO MATCH TOP OF ADJACENT SLAB. SEE 2/SS.01.

NOTE: SEE ARCH FOR EXTENTS OF DEMOLITION

EXISTING STRUCTURAL MEMBERS:
THE GENERAL CONTRACTOR SHALL FIELD VERIFY LOCATIONS, DIMENSIONS, ELEVATIONS, AND CONDITION OF ALL PERTINENT EXISTING STRUCTURAL MEMBERS, (CONCEALED AND EXPOSED) PRIOR TO FABRICATION AND CONSTRUCTION. THE GENERAL CONTRACTOR SHALL NOTIFY THE ARCHITECT AND STRUCTURAL ENGINEER OF RECORD AND FOOD LION CONSTRUCTION SUPERVISOR OF ANY DISCREPANCIES A MINIMUM OF 48 HOURS IN ADVANCE PRIOR TO CONSTRUCTION, TO ALLOW FOR MODIFICATION OF DESIGN PER UNFORESEEN FIELD CONDITIONS

WWW.LDILine.com

Order Plans @

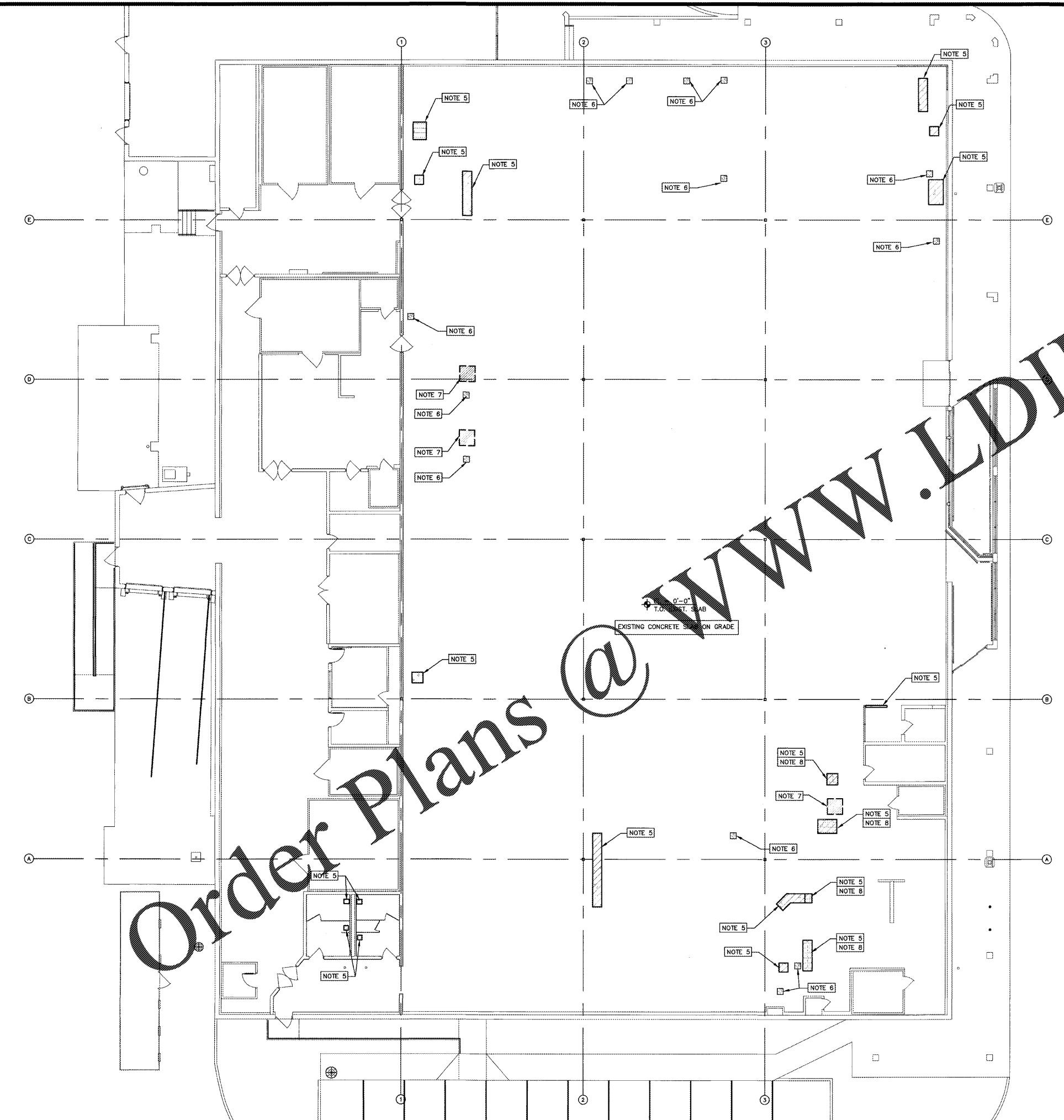

COPYRIGHT © 2020 INTERPLAN LLC. RESERVES COPYRIGHT & OTHER RIGHTS RESTRICTING THESE DOCUMENTS TO THE ORIGINAL USER OF PURPOSE FOR WHICH THEY WERE PREPARED. REPRODUCTIONS, CHANGES OR ASSIGNMENTS ARE PROHIBITED.