

DEMOLITION NOTES:

1. DASHED BOLD LINES INDICATE EXTENT OF DEMOLITION INCLUDING THE FOLLOWING:
 - INTERIOR PARTITIONS, REMOVED TO STRUCTURE UNLESS OTHERWISE NOTED. ALL LOAD BEARING WALLS TO BE COORDINATED WITH STRUCTURAL ENGINEER.
 - FLOOR FINISHES (TO CONCRETE) INCLUDING CARPET, RVT, SHEET VINYL, CERAMIC TILE, ETC.
 - CABINETWORK, SHELVING, AND BASES.
 - TOILET PARTITIONS AND ACCESSORIES
 - EQUIPMENT ITEMS
 - PLUMBING FIXTURES
2. CONTRACTOR SHALL FIELD VERIFY ALL EXISTING CONDITIONS.
3. ALL LIGHT OR HALFTONE LINES INDICATE EXISTING TO REMAIN. EXISTING WALLS TO REMAIN ARE HAVE A SOLID GREY HATCH PATTERN.
4. SEE SPECIFICATIONS SECTIONS 1044, CUTTING AND PATCHING AND 02050, DEMOLITION,
5. SEE ROOM FINISH SCHEDULE, MECHANICAL PLANS, AND ELECTRICAL PLANS FOR EXTENT OF NEW CEILING CONSTRUCTION OR CEILING PATCHING IN EXISTING AREAS.
6. SEE ROOM FINISH SCHEDULE FOR EXTENT OF NEW FLOORING MATERIAL IN EXISTING AREAS. REMOVE EXISTING FLOORING AS NEEDED.
7. SEE ROOM FINISH SCHEDULE FOR EXTENT OF NEW WALL COVERING MATERIAL IN EXISTING AREAS. WHERE NEW FINISHES ARE REQUIRED, REMOVE EXISTING WALL FINISHES, (TEXTURED PLASTIC COATING, VINYL WALL COVERING, PANELING, BASE, ETC.).
8. CONTRACTOR TO VERIFY ALL WALL CONSTRUCTION & FINISHES NOTED FOR REMOVAL. TAKE INTO ACCOUNT ANY DISCREPANCY AND MAKE PROPER ADJUSTMENT TO ACCOMPLISH REQUIRED CONSTRUCTION & FINISHES. IF IT APPEARS THAT STRUCTURAL INTEGRITY MAY BE VIOLATED, CONTACT THE ARCHITECT AND STRUCTURAL ENGINEER.
9. ALL PHASING OF THE PROJECT IS TO BE COORDINATED AND APPROVED BY THE OWNER.
10. COORDINATE REMOVAL OF FURNITURE AND EXISTING EQUIPMENT WITH THE OWNER.
11. SAW CUT EDGES OF EXISTING FLOOR SLAB FOR REMOVAL AND INSTALLATION OF UTILITIES. REFER TO MECHANICAL AND ELECTRICAL DRAWINGS.
12. REMOVE FURRING OR GWB ONLY WHERE REQUIRED TO COMPLETE CONSTRUCTION. PATCH AND MATCH WALLS AS REQUIRED TO COMPLETE AND MATCH EXISTING CONDITIONS, UNLESS AN ALTERNATE MATERIAL AND FINISH IS INDICATED.
13. REMOVE CEILINGS ONLY AS REQUIRED FOR NEW CONSTRUCTION. REINSTALL, REPLACE, OR PATCH AS REQUIRED.
14. ANY FIXTURES AND/OR FURNITURE NOT SHOWN IS TO BE REMOVED. LIGHTING AND PLUMBING FIXTURES, AS WELL AS STUDS AND USEFUL BUILDING MATERIALS TO BE STORED NEATLY ON-SITE. CHECK WITH OWNER OR ARCHITECT BEFORE LANDFILLING POTENTIALLY RE-USABLE ITEMS.
15. BUILDING MUST NOT BE LEFT EXPOSED TO THE ELEMENTS OR VANDALS. ANY WINDOWS, DOORS, OR STOREFRONTS THAT ARE REMOVED AND LEAVE HOLES TO THE OUTSIDE MUST BE TEMPORARILY CLOSED UP UNTIL NEW UNITS ARE INSTALLED.
16. COORDINATE ALL STRUCTURAL DEMOLITION WITH STRUCTURAL DRAWINGS.
17. COORDINATE MECHANICAL, PLUMBING, SPRINKLER, AND ELECTRICAL DEMOLITION WITH MECHANICAL, PLUMBING, AND ELECTRICAL DRAWINGS. PARTS OF THESE SYSTEMS WILL REMAIN OR BE REUSED.
18. ALL DEMOLISHED MATERIALS, THAT ARE TO BE DISPOSED OF ARE TO BE DONE SO OFF-SITE IN COMPLIANCE WITH ALL APPLICABLE CODES AND/OR LAWS. ALL DUMP FEES/PERMIT COSTS ARE TO BE INCLUDED IN BIDS. RECYCLE ANY MATERIALS THAT CAN BE RECYCLED. ANY MATERIALS OR EQUIPMENT THAT ARE SCRAPPED FOR COMPENSATION ARE TO BE LISTED AS A LINE ITEM IN BID PROPOSALS OR SAID COMPENSATION RETURNED TO THE OWNER.
19. ALL DEMOLITION ITEMS ARE NOT SHOWN. COORDINATE DEMOLITION AMONG TRADES TO AVOID INTERFERENCES/CONFLICTS.
20. ALL DEMOLITION ITEMS SHALL BE (U.N.O.) INCLUDED IN THE BID PRICE. ITEMS WHICH ARE NOT SHOWN, BUT ARE READILY APPARENT AT THE SITE ARE IMPLIED BY THESE DOCUMENTS AND SHALL BE INCLUDED IN THE BID PRICE.
21. EACH AND EVERY ITEM OF DEMOLITION WORK CANNOT REASONABLY BE INDIVIDUALLY DEFINED ON THE PLANS (INCLUDING REMOVAL OF PIPE, CONDUITS, THERMOSTATS, CONTROLS, ETC.). BUT ALL VISIBLE ITEMS, EITHER ABOVE OR BELOW CEILINGS THAT WILL NOT BE REUSED/REMAIN IN PLACE AS PER M,E,P DRAWINGS SHOULD BE CONSIDERED AS PART OF THE DEMOLITION SCOPE OF WORK. IT IS THE RESPONSIBILITY OF THE CONTRACTOR TO EXAMINE THE BUILDING AND PROJECT SITE AND INCLUDE THE COST OF SUCH IN THEIR BIDS.
22. EXISTING WALLS AND FIXTURES ARE NOT NECESSARILY SHOWN IN THEIR ENTIRETY OR CORRECT LOCATION. CONTRACTOR TO VERIFY EXISTING CONDITIONS PRIOR TO BIDDING. ANY DISCREPANCIES TO BE BROUGHT TO THE ATTENTION OF THE ARCHITECT FOR DIRECTION AND OR CLARIFICATION.
23. ALL EXISTING FACILITIES THAT ARE TO REMAIN ARE TO BE PROTECTED DURING DEMOLITION AND CONSTRUCTION BY THE GENERAL CONTRACTOR (G.C.). ANY DAMAGED MATERIALS TO BE REPAIRED, REPLACED OR REBUILT IN A MANNER ACCEPTABLE TO THE OWNER AND ARCHITECT.
24. G.C. TO PROVIDE DUST CONTROL PARTITIONS, DEVICES, FLOOR MATS, ETC. TO MAINTAIN CLEAN INTERFACES WITH ADJACENT OCCUPIED BUILDINGS - AS NECESSARY. G.C. WILL BE RESPONSIBLE FOR MAINTAINING A "CLEANUP AREA" AT EACH OF THESE INTERFACES.
25. WHEN STRUCTURAL MEMBERS ARE TO BE REMOVED, ASSOCIATED STRUCTURAL MEMBERS MUST BE BRACED DURING THE COURSE OF CONSTRUCTION AS NECESSARY. IF THERE IS ANY DOUBT ABOUT STRUCTURAL CAPACITY CONSULT THE STRUCTURAL ENGINEER.

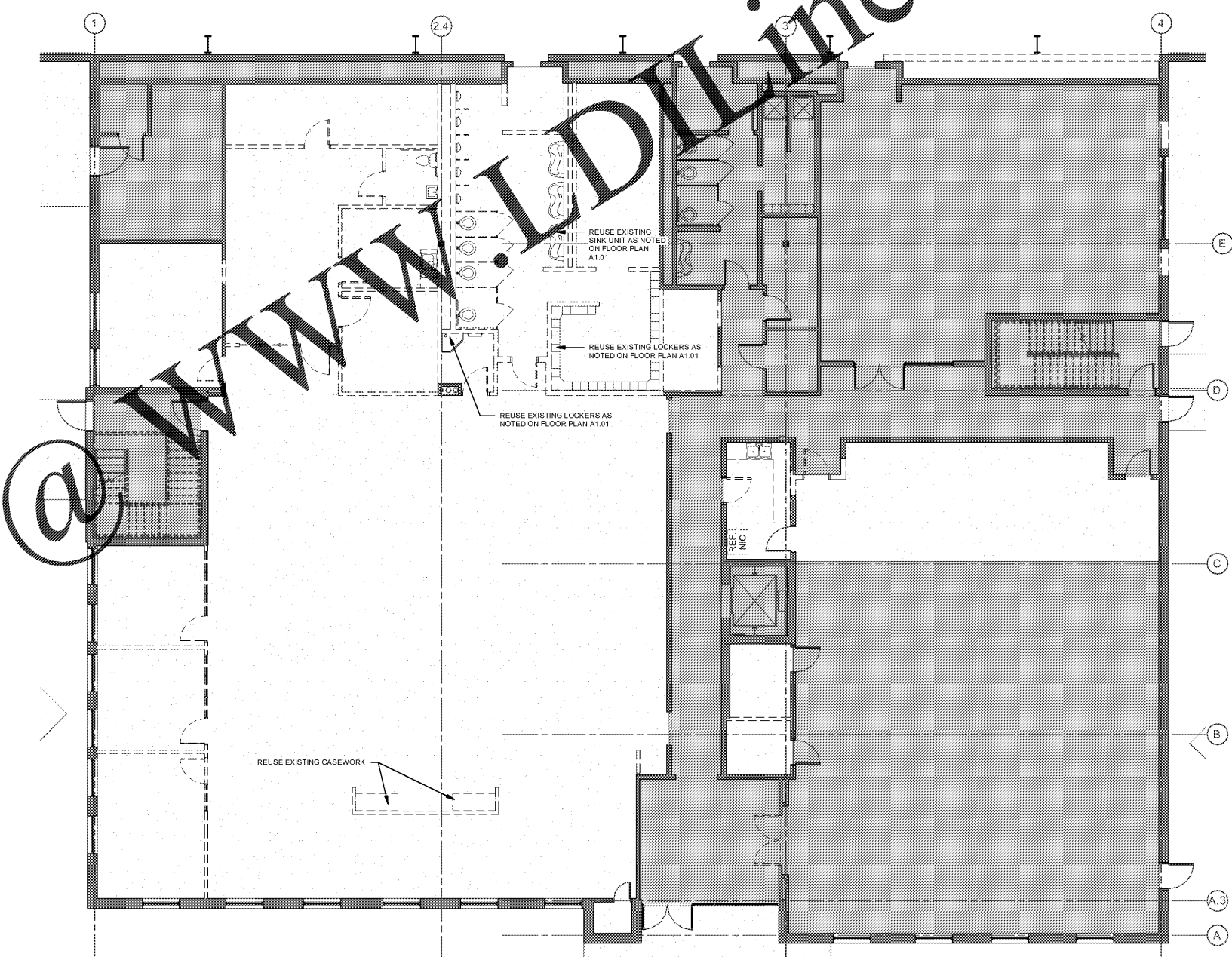

1 DEMOLITION PLAN- FIRST FLOOR
1/8" = 1'-0"

PRICING SET
NOT FOR
CONSTRUCTION

EXPIRATION DATE:
COPYRIGHT NOTICE
THE DRAWINGS ARE THE
PROPERTY OF RIVER STREET
ARCHITECTURE LLC. ANY USE,
REUSE, REPRODUCTION, DISPLAY,
OR SALE OF THESE DRAWINGS
WITHOUT THE EXPRESS WRITTEN
CONSENT OF THE ARCHITECT IS
STRICTLY PROHIBITED.

river street
ARCHITECTURE
123 E 7th street, suite 400 chattanooga, tennessee 37402
P-423 634 0806 www.riverstreetarchitecture.com

DRS. BRUCE & SMITH MEDICAL OFFICES
ORTHOPEDIC OFFICES
1ST FLOOR
RIVERFRONT PARKWAY
CHATTANOOGA, TN 37402

Revision Schedule		
Rev. #	Rev. Date	Revision Description

Release Date: 05.10.2020
Project No.: 20021

DEMOLITION PLAN

AD1.0

6/11/2020 1:59:23 PM