

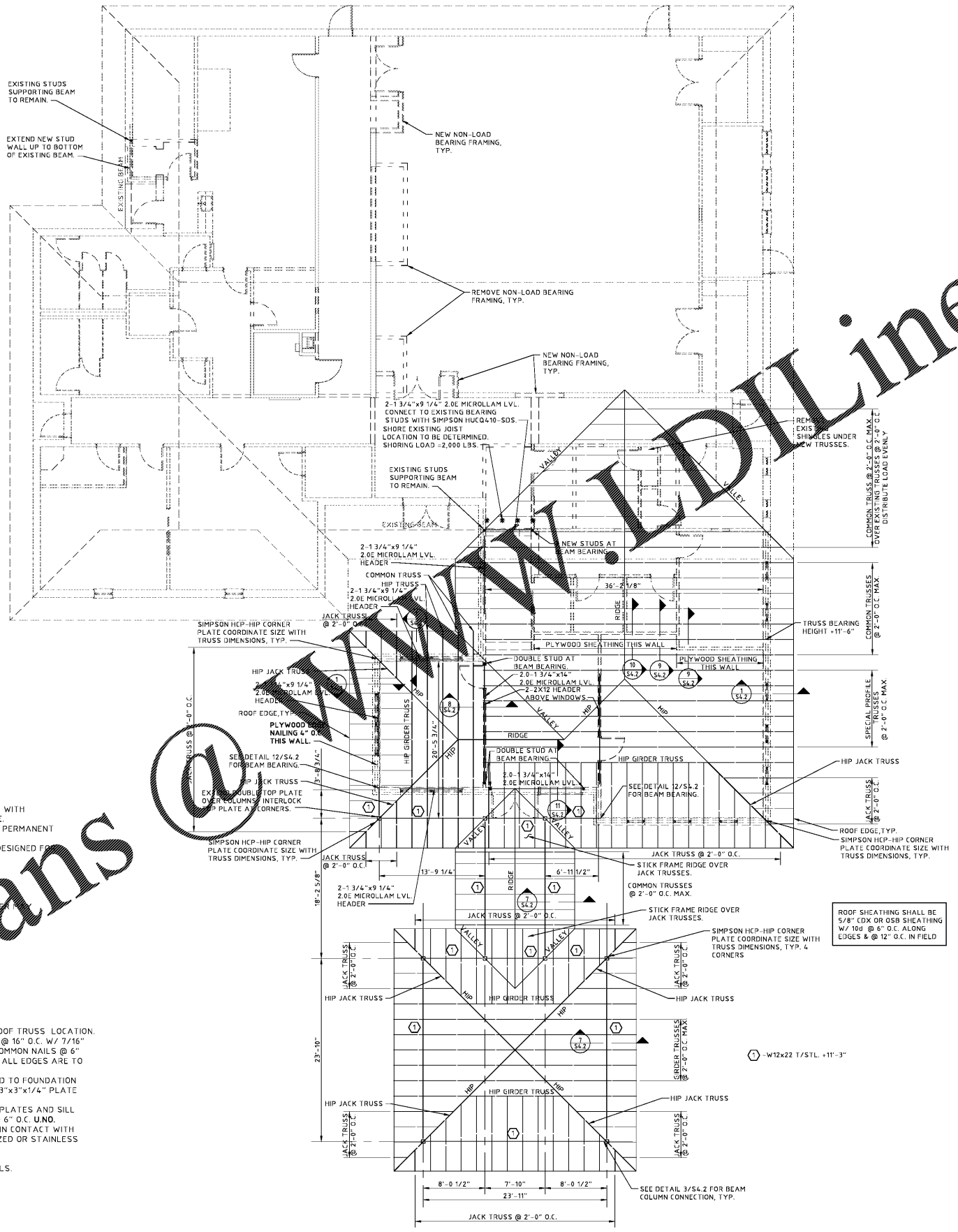

THIS DOCUMENT IS THE PROPERTY OF STUDIO 3 DESIGN GROUP, P.C. THE UNAUTHORIZED REPRODUCTION, COPYING OR OTHERWISE USE OF THIS DOCUMENT IS STRICTLY PROHIBITED AND ANY INFRINGEMENT THEREUPON MAY BE SUBJECT TO LEGAL ACTION.
COPYRIGHT 2007
STUDIO 3 DESIGN GROUP, P.C.

- MEMBERS OF THE
AMERICAN INSTITUTE OF ARCHITECTS
- CIVIL ENGINEER
CIVIL DESIGN SOLUTIONS
 - STRUCTURAL ENGINEER
SLATER ENGINEERING
 - PLUMBING ENGINEER
DELTA ENGINEERING GROUP, LLC.
 - MECHANICAL ENGINEER
DELTA ENGINEERING GROUP, LLC.
 - ELECTRICAL ENGINEER
DELTA ENGINEERING GROUP, LLC.



- TRUSS NOTES:**
- 1) EACH ROOF TRUSS SHALL BE FASTENED TO SUPPORT WITH 1-SIMPSON HH HURRICANE TIE, UNLESS NOTED OTHERWISE.
 - 2) ROOF TRUSSES ARE TO HAVE BOTH TEMPORARY AND PERMANENT BRACING PER MANUFACTURER'S REQUIREMENTS.
 - 3) ROOF TRUSSES AND TRUSS CONNECTIONS SHALL BE DESIGNED FOR THE FOLLOWING LOADS:
TOP CHORD LIVE LOAD = 20 PSF
TOP CHORD DEAD LOAD = 15 PSF
BOTTOM CHORD DEAD LOAD = 10 PSF
 - 4) SEE ARCH. DRAWINGS FOR TRUSS PROFILES.
 - 5) TRUSS LAYOUT IS SCHEMATIC. TRUSS MANUFACTURER SHALL MAKE ADJUSTMENTS TO LAYOUT AS NECESSARY.

- WALL FRAMING NOTES:**
- 1) WALL STUDS SHALL BE LOCATED AT EACH ROOF TRUSS LOCATION.
 - 2) WALL FRAMING SHALL BE 2x4 #2 SPF STUDS @ 16" O.C. W/ 7/16" 15# SHEATHING W/ 0.131 (8d) x 2 1/2" COMMON NAILS @ 6" O.C. (E.O.) ALONG EDGES & @ 12" O.C. IN FIELD. ALL EDGES ARE TO BE BLOCKED.
 - 3) LOAD BEARING STUD WALLS TO BE ANCHORED TO FOUNDATION WALL WITH 1/2" φ HOOKED ANCHOR BOLTS AND 3"x3"x1/4" PLATE WASHERS @ 4'-0" O.C. MAX. UNO.
 - 4) EXTERIOR SHEATHING TO BE NAILED TO TOP PLATES AND SILL PLATES WITH 0.131 (8d) x 2 1/2" COMMON NAILS @ 6" O.C. UNO.
 - 5) ALL FASTENERS, INCLUDING ANCHOR BOLTS, IN CONTACT WITH PRESSURE TREATED WOOD, SHALL BE GALVANIZED OR STAINLESS STEEL TO RESIST THE CORROSIVE EFFECTS.
 - 6) SEE TYPICAL FRAMING DETAIL 4/S4.2.
 - 7) SEE DETAILS 2/S4.2 FOR LOOSE STEEL LINTELS.

ROOF FRAMING PLAN
1/8" = 1'-0"

Order Plans

www.LDLine.com

ROOF FRAMING PLAN

**ADDITION AND RENOVATIONS TO THE
BURKE COUNTY SENIOR
CENTER**

717 WEST 6TH STREET
WAYNESBORO, GEORGIA

PROJECT NUMBER	201903
DRAWN BY	REVISIONS
CHECKED BY	DATE
ISSUE DATE	04/15/20
PLOT DATE	04/15/20



S3.1