

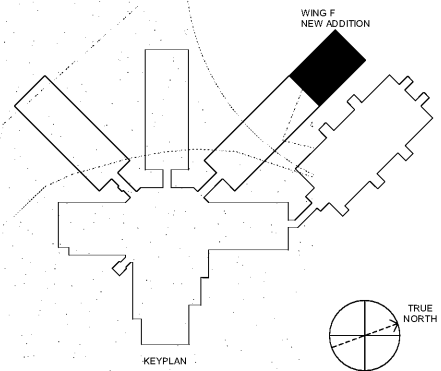

Order Plans @

www.LDILine.com



- ELECTRICAL SITE PLAN NOTES:**
1. NEW OVERHEAD FEEDER, INSTALLED ABOVE EXISTING CEILING, FROM EXISTING SWITCHBOARD MSG1 TO NEW PANELBOARD HFF. COORDINATE EXACT PATHWAY TO ACCOMMODATE EXISTING CONDITIONS.
 2. APPROXIMATE LOCATION OF EXISTING MAIN INTERCOM SYSTEM EQUIPMENT RACK. ROUTE NEW INTERCOM CIRCUITS TO THIS LOCATION.
 3. APPROXIMATE LOCATION OF EXISTING INTRUSION DETECTION SYSTEM CONTROL PANEL.
 4. APPROXIMATE LOCATION OF EXISTING MAIN FIRE ALARM CONTROL PANEL.
 5. TRANSFORMER SECONDARY GROUNDING CONDUCTOR AND GROUND ROD. REFER TO TRANSFORMER INSTALLATION DETAIL FOR REQUIREMENTS.
 6. APPROXIMATE LOCATION OF EXISTING INTERMEDIATE DATA DISTRIBUTION FRAME. ROUTE NEW HORIZONTAL CABLING FROM DATA OUTLETS IN NEW BUILDING ADDITION TO THIS LOCATION.

SA&E PROJECT NUMBER	01-632-056
BID PACKAGE	BP-1
ISSUED FOR CONSTRUCTION	FEB. 4, 2020
Southern AE 7951 Truon Circle Austell, Ga 30168 (770) 819-7777 architects & engineers	REVISIONS
	R # Doc # Date
<small>© COPYRIGHT 2020 BY SOUTHERN AE, LLC. ALL RIGHTS RESERVED. THIS DOCUMENT IS THE PROPERTY OF SOUTHERN AE, LLC AND SHALL NOT BE COPIED OR REPRODUCED IN ANY MANNER WITHOUT EXPRESS WRITTEN PERMISSION BY SOUTHERN AE, LLC.</small>	

FACILITY CODE NUMBER: 672-0109
 (6) CLASSROOM ADDITION TO:
CREEKSIDE MIDDLE SCHOOL
 CATAULA, GEORGIA
HARRIS COUNTY BOARD OF EDUCATION
 HAMILTON, GEORGIA

ELECTRICAL SITE PLAN

		DRAWING NUMBER
		E002

1 ELECTRICAL OVERALL/SITE PLAN
 E002 1" = 20'-0"