

Order Plans @

EXISTING MEDIA CENTER
BASED ON 900 FTE.
REQUIRED IS 1,975 S.F.
EXIST. SQUARE FOOTAGE
IS 4,432 S.F.

EXISTING KITCHEN
BASED ON 900 FTE
REQUIRED IS 2,400 S.F.
EXIST. SQUARE FOOTAGE
IS 4,809 S.F.

EXISTING CAFETERIA
BASED ON 900 FTE
900 FTE x 3.809 = 3,428 S.F.
EXIST. SQUARE FOOTAGE
IS 5,678 S.F.

1 OVERALL FLOOR PLAN
A101 1" = 20'-0"

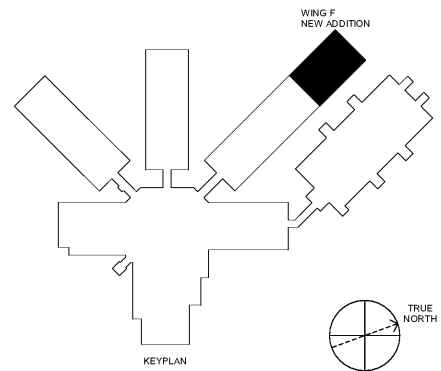

SA&E PROJECT NUMBER	01-632-056
BID PACKAGE	BP-1
ISSUED FOR CONSTRUCTION	FEB. 4, 2020
Southern AE 7951 Tricon Circle Austell, Ga 30168 (770) 819-7777 architects & engineers	REVISIONS
	R # Doc # Date
<small>© COPYRIGHT 2020 BY SOUTHERN AE, LLC. ALL RIGHTS RESERVED. THIS DOCUMENT IS THE PROPERTY OF SOUTHERN AE, LLC AND SHALL NOT BE COPIED OR REPRODUCED IN WHOLE OR IN PART WITHOUT EXPRESS WRITTEN CONSENT BY SOUTHERN AE, LLC.</small>	

FACILITY CODE NUMBER: 672-0109
(6) CLASSROOM ADDITION TO:
CREEKSIDE MIDDLE SCHOOL
CATAULA, GEORGIA
HARRIS COUNTY BOARD OF EDUCATION
HAMILTON, GEORGIA

OVERALL FLOOR PLAN	
	DRAWING NUMBER
	A101