

Design and construction documents are instruments of service, and given in accordance with the professional seal and license of the architect. The use of the drawings for any purpose other than the specific project for which they were prepared is strictly prohibited. Reproduction or transmission in any form or by any means without the written consent of Michael Crislip Architect is prohibited.

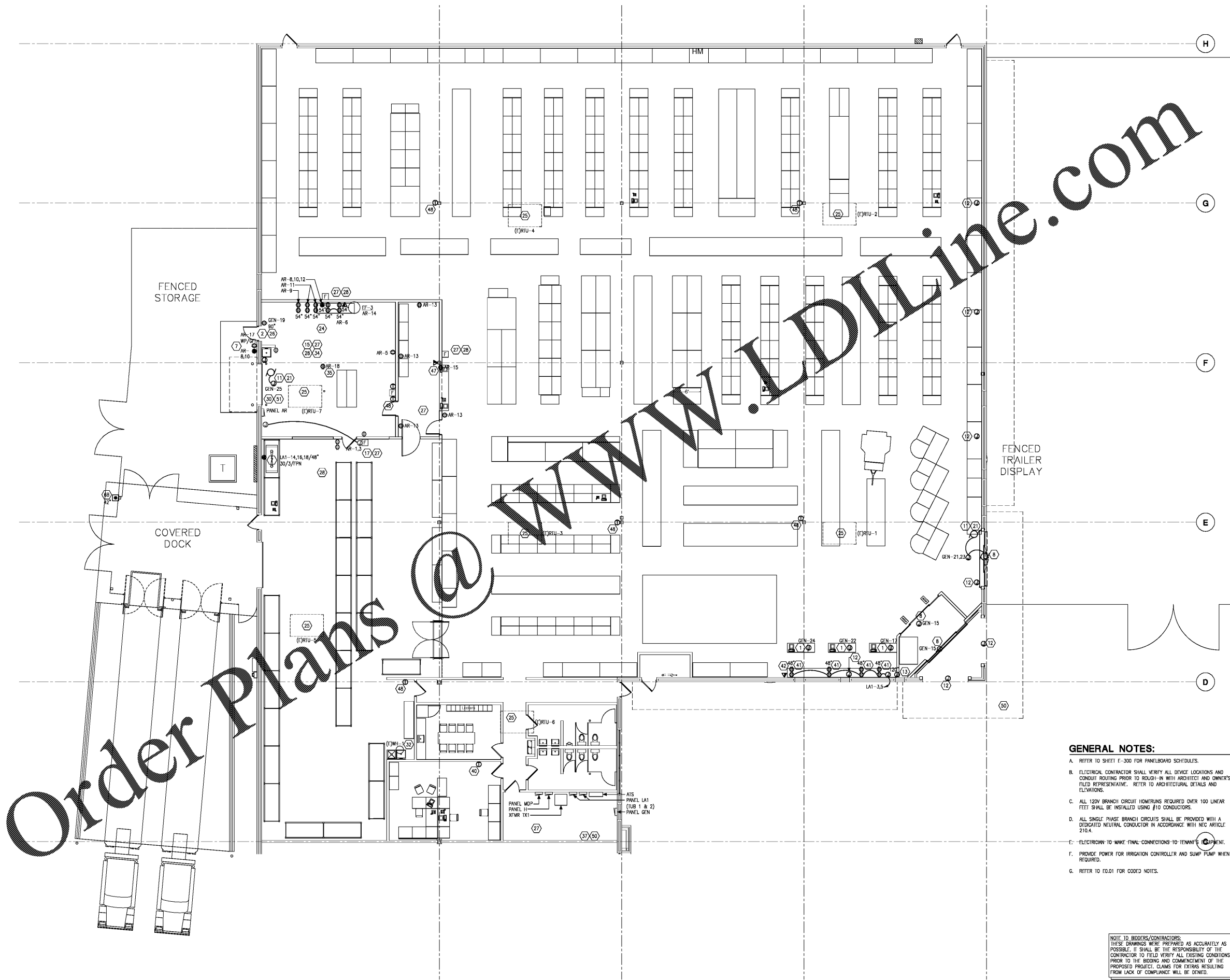

Order Plans @

- GENERAL NOTES:**
- REFER TO SHEET E-300 FOR PANELBOARD SCHEDULES.
 - ELECTRICAL CONTRACTOR SHALL VERIFY ALL DEVICE LOCATIONS AND CONDUIT ROUTING PRIOR TO ROUGH-IN WITH ARCHITECT AND OWNER'S FIELD REPRESENTATIVE. REFER TO ARCHITECTURAL DETAILS AND ELEVATIONS.
 - ALL 120V BRANCH CIRCUIT HOMERUNS REQUIRED OVER 100 LINEAR FEET SHALL BE INSTALLED USING #10 CONDUCTORS.
 - ALL SINGLE PHASE BRANCH CIRCUITS SHALL BE PROVIDED WITH A DEDICATED NEUTRAL CONDUCTOR IN ACCORDANCE WITH NEC ARTICLE 210.4.
 - ELECTRICIAN TO MAKE FINAL CONNECTIONS TO TENANT'S EQUIPMENT.
 - PROVIDE POWER FOR IRRIGATION CONTROLLER AND SUMP PUMP WHEN REQUIRED.
 - REFER TO FD.01 FOR CODED NOTES.

NOTE TO BIDDERS/CONTRACTORS:
 THESE DRAWINGS WERE PREPARED AS ACCURATELY AS POSSIBLE. IT SHALL BE THE RESPONSIBILITY OF THE CONTRACTOR TO FIELD VERIFY ALL EXISTING CONDITIONS PRIOR TO THE BIDDING AND COMMENCEMENT OF THE PROPOSED PROJECT. CLAIMS FOR DAMAGES RESULTING FROM LACK OF COMPLIANCE WILL BE DENIED.

DATE PLOTTED: 09/09/20 09:45:11 AM
 PLOTTER: HP DesignJet T1100e
 PLOT SCALE: 1/8" = 1'-0"