

Design and construction documents are instruments of service, and their use is limited to the project and site for which they were prepared. The use of these documents for any other project or site without the written consent of Michael Crislip Architect is strictly prohibited.

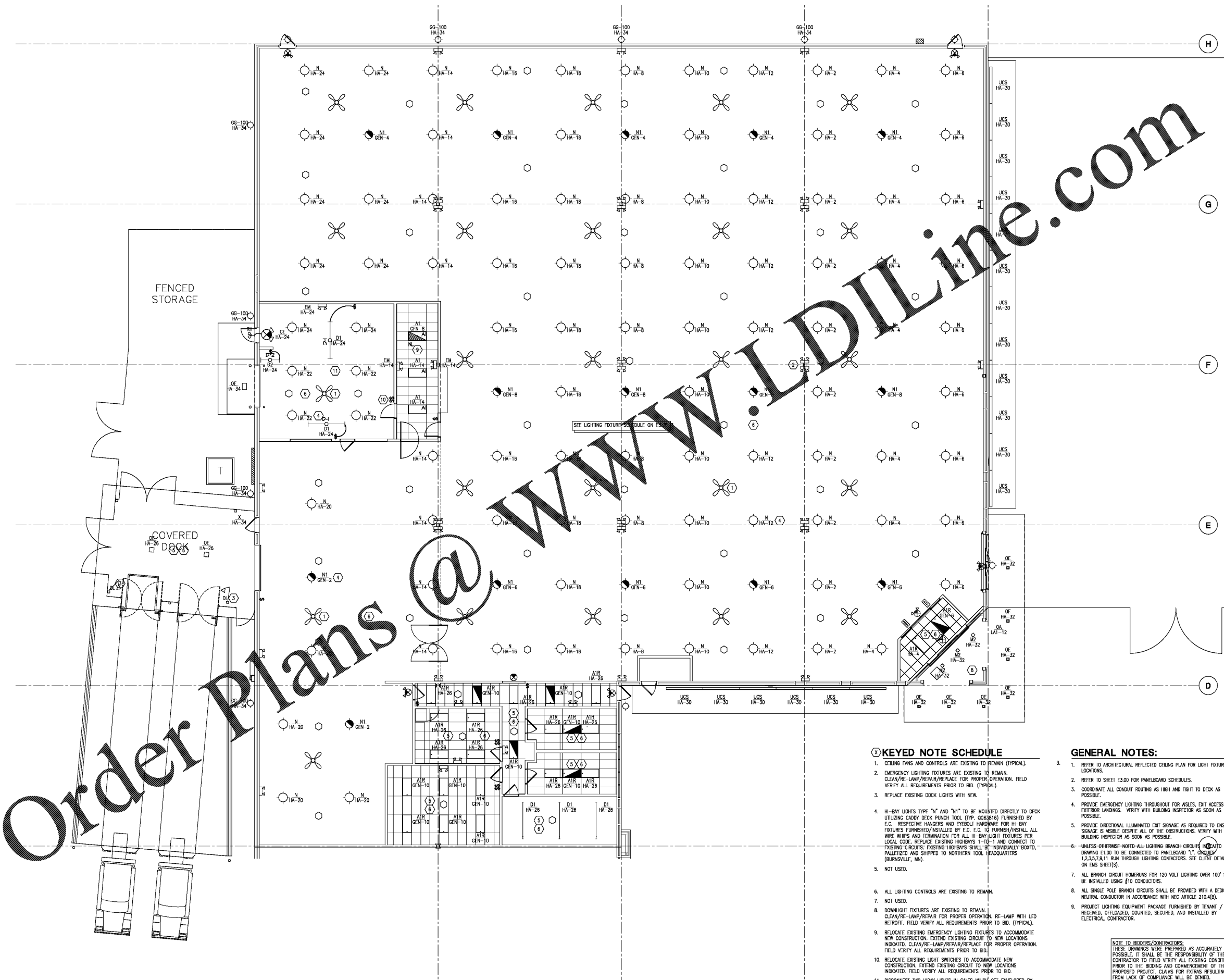

Order Plans @ WWW.LDLine.com

KEYED NOTE SCHEDULE

1. CEILING FANS AND CONTROLS ARE EXISTING TO REMAIN (TYPICAL).
2. EMERGENCY LIGHTING FIXTURES ARE EXISTING TO REMAIN. CLEAN/RE-LAMP/REPAIR/REPLACE FOR PROPER OPERATION. FIELD VERIFY ALL REQUIREMENTS PRIOR TO BID. (TYPICAL).
3. REPLACE EXISTING DOCK LIGHTS WITH NEW.
4. HI-BAY LIGHTS TYPE "N" AND "N1" TO BE MOUNTED DIRECTLY TO DECK UTILIZING CADDY DECK PUNCH TOOL (MP. 0063816) FURNISHED BY E.I.C. RESPECTIVE HANGERS AND FITTINGS HARDWARE FOR HI-BAY FIXTURES FURNISHED/INSTALLED BY E.I.C. TO FURNISH/INSTALL ALL WIRE WHIPS AND TERMINATION FOR ALL HI-BAY LIGHT FIXTURES PER LOCAL CODE. REPLACE EXISTING HIGBAYS 1-10-1 AND CONNECT TO EXISTING CIRCUITS. EXISTING HIGBAYS SHALL BE INDIVIDUALLY BOXED, PALLETIZED AND SHIPPED TO NORTHERN TOOL HEADQUARTERS (BURNSVILLE, MN).
5. NOT USED.
6. ALL LIGHTING CONTROLS ARE EXISTING TO REMAIN.
7. NOT USED.
8. DOWNLIGHT FIXTURES ARE EXISTING TO REMAIN. CLEAN/RE-LAMP/REPAIR/REPLACE FOR PROPER OPERATION. RE-LAMP WITH LED RETROFIT. FIELD VERIFY ALL REQUIREMENTS PRIOR TO BID. (TYPICAL).
9. RELOCATE EXISTING EMERGENCY LIGHTING FIXTURES TO ACCOMMODATE NEW CONSTRUCTION. EXTEND EXISTING CIRCUIT TO NEW LOCATIONS INDICATED. CLEAN/RE-LAMP/REPAIR/REPLACE FOR PROPER OPERATION. FIELD VERIFY ALL REQUIREMENTS PRIOR TO BID.
10. RELOCATE EXISTING LIGHT SWITCHES TO ACCOMMODATE NEW CONSTRUCTION. EXTEND EXISTING CIRCUIT TO NEW LOCATIONS INDICATED. FIELD VERIFY ALL REQUIREMENTS PRIOR TO BID.
11. DISCONNECT TWO HI-BAY LIGHTS IN SALES WHICH GET ENVELOPED BY PRODUCT PREP ROOM EXPANSION AND INTEGRATES THESE TWO HI-BAY LIGHTS INTO THE EXISTING HI-BAY LIGHT CIRCUIT IN PRODUCT PREP ROOM.

GENERAL NOTES:

1. REFER TO ARCHITECTURAL REFLECTED CEILING PLAN FOR LIGHT FIXTURE LOCATIONS.
2. REFER TO SHEET E3.00 FOR PANELBOARD SCHEDULES.
3. COORDINATE ALL CONDUIT ROUTING AS HIGH AND TIGHT TO DECK AS POSSIBLE.
4. PROVIDE EMERGENCY LIGHTING THROUGHOUT FOR WALKS, EXIT ACCESS AND EXTERIOR LANDINGS. VERIFY WITH BUILDING INSPECTOR AS SOON AS POSSIBLE.
5. PROVIDE DIRECTIONAL ILLUMINATED EXIT SIGNAGE AS REQUIRED TO ENSURE SIGNAGE IS VISIBLE DESPITE ALL OF THE OBSTRUCTIONS. VERIFY WITH BUILDING INSPECTOR AS SOON AS POSSIBLE.
6. UNLESS OTHERWISE NOTED ALL LIGHTING BRANCH CIRCUITS LOCATED ON DRAWING E1.00 TO BE CONNECTED TO PANELBOARD "1" ON SHEETS E1.00, E1.01, E1.02, E1.03, E1.04, E1.05, E1.06, E1.07, E1.08, E1.09, E1.10, E1.11 THROUGH LIGHTING CONDUITORS. SEE CLIENT DETAILS ON EMS SHEETS.
7. ALL BRANCH CIRCUIT HOMERUNS FOR 120 VOLT LIGHTING OVER 100' SHALL BE INSTALLED USING #10 CONDUCTORS.
8. ALL SINGLE POLE BRANCH CIRCUITS SHALL BE PROVIDED WITH A DEDICATED NEUTRAL CONDUCTOR IN ACCORDANCE WITH NEC ARTICLE 210.4(B).
9. PROJECT LIGHTING EQUIPMENT PACKAGE FURNISHED BY TENANT / RECEIVED, OFFLOADED, COUNTED, SECURED, AND INSTALLED BY ELECTRICAL CONTRACTOR.

NOTE TO BIDDERS/CONTRACTORS:
 THESE DRAWINGS WERE PREPARED AS ACCURATELY AS POSSIBLE. IT SHALL BE THE RESPONSIBILITY OF THE CONTRACTOR TO FIELD VERIFY ALL EXISTING CONDITIONS PRIOR TO THE BIDDING AND COMMENCEMENT OF THE PROPOSED PROJECT. CLAIMS FOR EXTRAS RESULTING FROM LACK OF COMPLIANCE WILL BE DENIED.

DATE PLOTTED: 03/09/20 09:45:11 AM
 PLOTTER: HP DesignJet T1100e
 PLOT SCALE: 1/8" = 1'-0"