

**WALL TYPE SCHEDULE**

SYMBOL	DESCRIPTION
A	EXISTING EXTERIOR WALL
B	EXISTING INTERIOR WALL
C	NEW / INFILL WALL, MATCH ADJACENT WALL, PROVIDE SOUND ATTENUATION BATT TO DECK, PAINT BOTH SIDES
D	600S125-90 HTL STUDS @ 16" O.C. WITH 6" SOUND ATTENUATION BATT TO DECK, 5/8" TYPE X GYPSUM BOARD TO DECK BOTH SIDES, PAINT BOTH SIDES

**NOTE:**

- WAREHOUSE WALLS TO HAVE 5/8" FRT FLYWOOD TO 12'-0" AFF THEN 5/8" GYPSUM BOARD TO DECK.
- INTERIOR WALLS THAT EXTEND TO DECK TO HAVE DEFLECTION TRACK AT DECK.
- ALL GYPSUM BOARD TO BE SMOOTH TAPE AND SANDED, READY FOR PAINT. REFER TO SPECIFICATION BOOK.

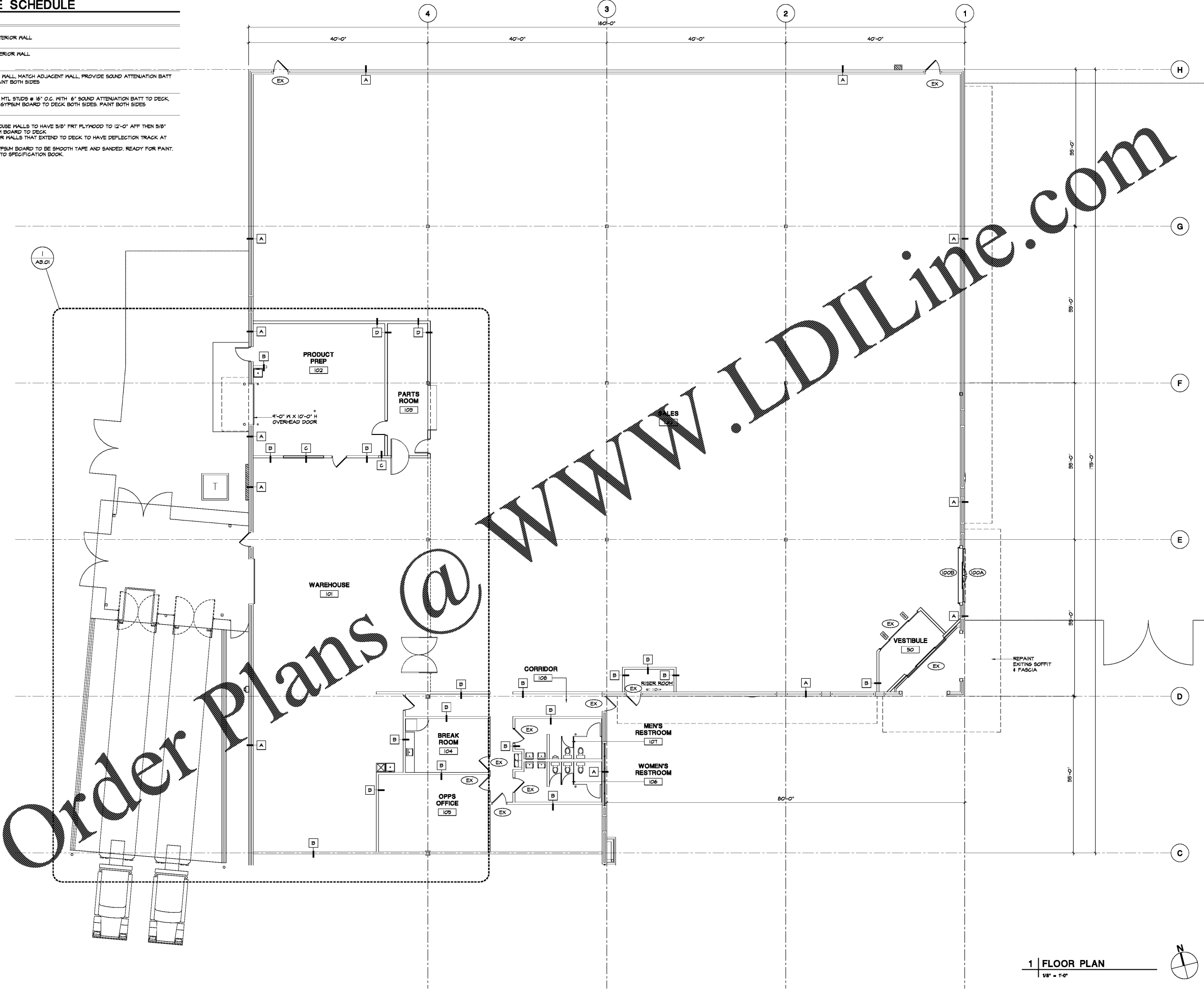

Order Plans @

WWW.LDILine.com

**1 | FLOOR PLAN**  
1/8" = 1'-0"



**MICHAEL CRISLIP ARCHITECT**  
26001 Eberly Road, Suite 400  
Cleveland, Ohio 44128  
216.233.3200 mcris@cris.com

Design and construction documents are instruments of service and shall remain the property of Michael Crislip Architect. The use of the design and construction documents for purposes other than the specific project intended is strictly prohibited without expressed written consent of Michael Crislip Architect.

**NORTHERN TOOL + EQUIPMENT**  
9401 STATESVILLE ROAD  
CHARLOTTE, NC 28269

Project No: 17483  
Drawn By: CGB  
Date: 03-08-20  
Issue For Construction Only

**A1.00**

FLOOR PLAN

DATE PLOTTED: 03/08/20 11:54 AM  
 PLOTTER: HP DesignJet T1100e  
 PLOTTING METHOD: HP DesignJet T1100e  
 PLOTTING SCALE: 1/8" = 1'-0"  
 PLOTTING SHEET: A1.00