

PROJECT DATA

PROPERTY OWNER:
 RACETRAC PETROLEUM
 200 GALLERIA PARKWAY SE
 ATLANTA, GA 30339
 ATTN: CHANCE GRUNIS
 EMAIL: CGRUNIS@RACETRAC.COM
 PHONE: 770-431-7600

AUTHORIZED AGENT & PERMIT APPLICANT:
 W&A ENGINEERING
 2470 DANIELS BRIDGE RD. SUITE 161
 ATLANTA, GA 30309
 ATTN: FRANK PITMAN, P.E.
 EMAIL: FPITMAN@W&AENGINEERING.COM
 PHONE: 706-310-0400

PHYSICAL ADDRESS: 839 LOGANVILLE HIGHWAY (BARROW COUNTY)
TAX PARCEL: XX052 103
G.M.D.: 249
TOTAL PROJECT ACREAGE: +/- 6.91 ACRES (301059.94 SF.)
CONTOUR INTERVAL: 2" FIELD RUN TOPO BY W&A ENGINEERING DATED 12/21/2017.
BOUNDARY SURVEY: THIS DRAWING WAS PREPARED USING A W&A ENGINEERING ALTA/NRPS LAND TITLE SURVEY FOR: RACETRAC PETROLEUM, INC. AND FIRST AMERICAN TITLE INSURANCE COMPANY, DATED 12/21/2017.
EXISTING ZONING: C3
PROPOSED ZONING: C3
EXISTING USE: VACANT LOT
PROPOSED USE: CONVENIENCE STORE / GAS STATION
FLOOD PLAN: NO PORTION OF THIS PROPERTY LIES WITHIN THE FLOOD PLAN ACCORDING TO COMMUNITY PANEL NUMBER 1301300110C DATED 12/18/2009.
 THERE ARE NO STATE WATERS ON-SITE, OR WITHIN 200' OF THE SITE.
 THERE ARE NO WETLANDS DELINEATED ON SITE.
 NO TREES EXIST WITHIN THE GDOT RIGHT-OF-WAY.
 PLAN PREPARED BY: MICHAEL GREENLEAF, P.E., PVID

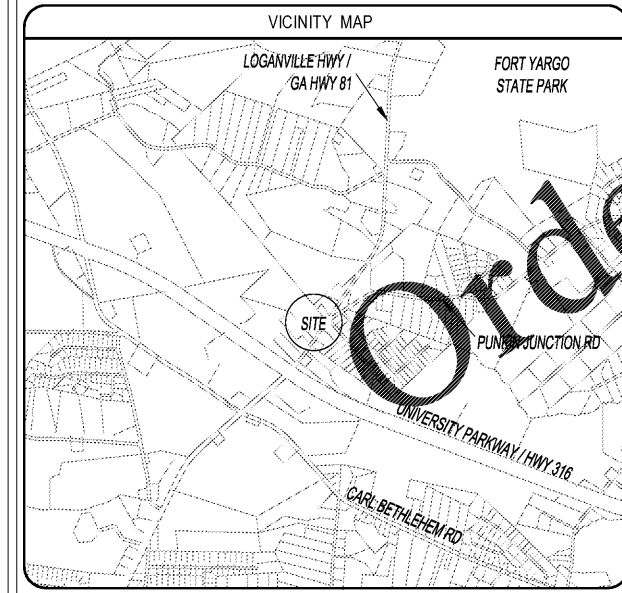
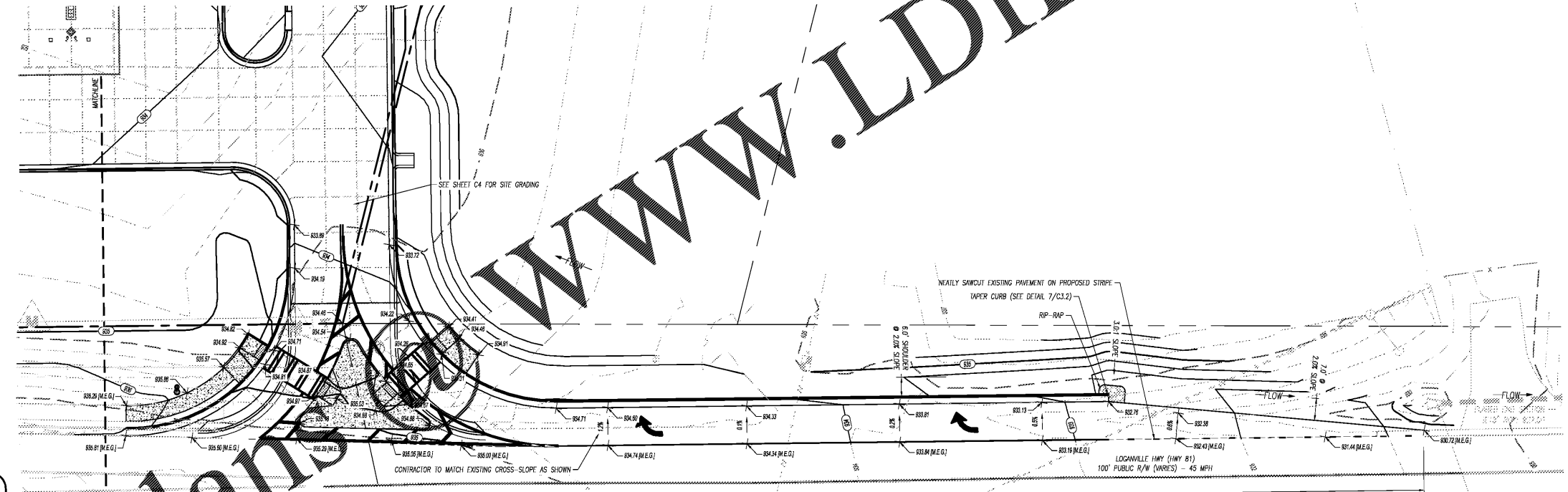

CONTACT RACETRAC PETROLEUM, INC. PROJECT MANAGER PRIOR TO ANY REVISIONS TO THE PLAN SUPPLIED BY RACETRAC PETROLEUM, INC.

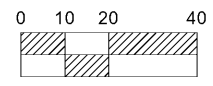

NO.	REVISION	DATE
5	REVISED PER GDOT COMMENTS	02.13.2019
4	REVISED PER GDOT COMMENTS	02.11.2019
3	REVISED PER GDOT COMMENTS	02.05.2019
2	REVISED PER GDOT & RACETRAC COMMENTS	01.14.2019
1	REVISED PER GDOT & RACETRAC COMMENTS	12.03.2018

W&A Engineering
 CIVIL ENGINEERING - LANDSCAPE ARCHITECTURE
 SURVEYING - SOIL AND ENVIRONMENTAL LABORATORY
 TRAFFIC ENGINEERING - TECHNICAL DRAFTING

THESE PLANS ARE LEGAL INSTRUMENTS. ANY USE OF SAME WITHOUT THE EXPRESSED WRITTEN PERMISSION OF RACETRAC PETROLEUM, INC. IS PROHIBITED.

Racetrac
 RACETRAC PETROLEUM, INC.
 200 GALLERIA PARKWAY SE
 SUITE 900 ATLANTA, GA 30339
 (770) 431-7600

DECEL. LANE GRADING PLAN
 RACETRAC 316@81
 839 Loganville Highway
 Bethlehem, Georgia
 Barrow County

DRAWN-BY: AGRUNER
 DATE: 02.28.2018
 SCALE: 1" = 20'
 DRAWING NAME: Conset-17293.dwg
C11
 SHEET NO. VERSION