



Know what's below.
Call before you dig.

LEGEND

- PROPOSED 4" THICK CONCRETE SIDEWALK
- PROPOSED 6" THICK CONCRETE PAVING WITH #3 REBARS @ 16" OC EACH WAY WITH 14" LAP SPLICE. (SEE DETAIL THIS SHEET)
- PROPOSED 8" THICK CONCRETE PAVING FOR DUMPSTER & TANK PAVEMENT WITH #3 REBARS @ 16" OC EACH WAY WITH 24" LAP SPLICE. (SEE DETAIL THIS SHEET)
- PROPOSED 8" THICK CONCRETE CURB BACKING (SEE DETAIL 3, SHEET SD1)
- ASPHALT PAVING / DOT PAVING SPEC / COUNTY PAVING SPEC
- ARCHITECTURAL STAMPED CONCRETE (REFER TO ARCHITECTURAL PLANS)
- CATCH CURB (SEE DETAIL 1, SHEET SD1)
- SHED CURB (SEE DETAIL 2, SHEET SD1)

BENCHMARK: 600 NAIL
N: 1436696.9301
E: 2421897.51
ELEV: 938.65'

BENCHMARK: 10' 5/8" REBAR
N: 1436364.53' E: 2422148.64'
ELEV: 938.18'

Order Plans

SR 81

LOGANVILLE HWY (HWY 81)
100' PUBLIC R/W (VARIES) - 45MPH

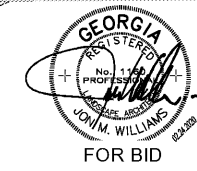

FOR BID

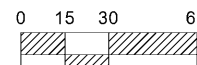

CONTACT RACETRAC PETROLEUM, INC. PROJECT MANAGER PRIOR TO ANY REVISIONS TO THE PLAN SUPPLIED BY RACETRAC PETROLEUM, INC.

KAYM ENTERPRISES, INC
PARCEL XX072 016

AKINS, MAYNARD & BARILETTI, LLP
PARCEL XX072 015

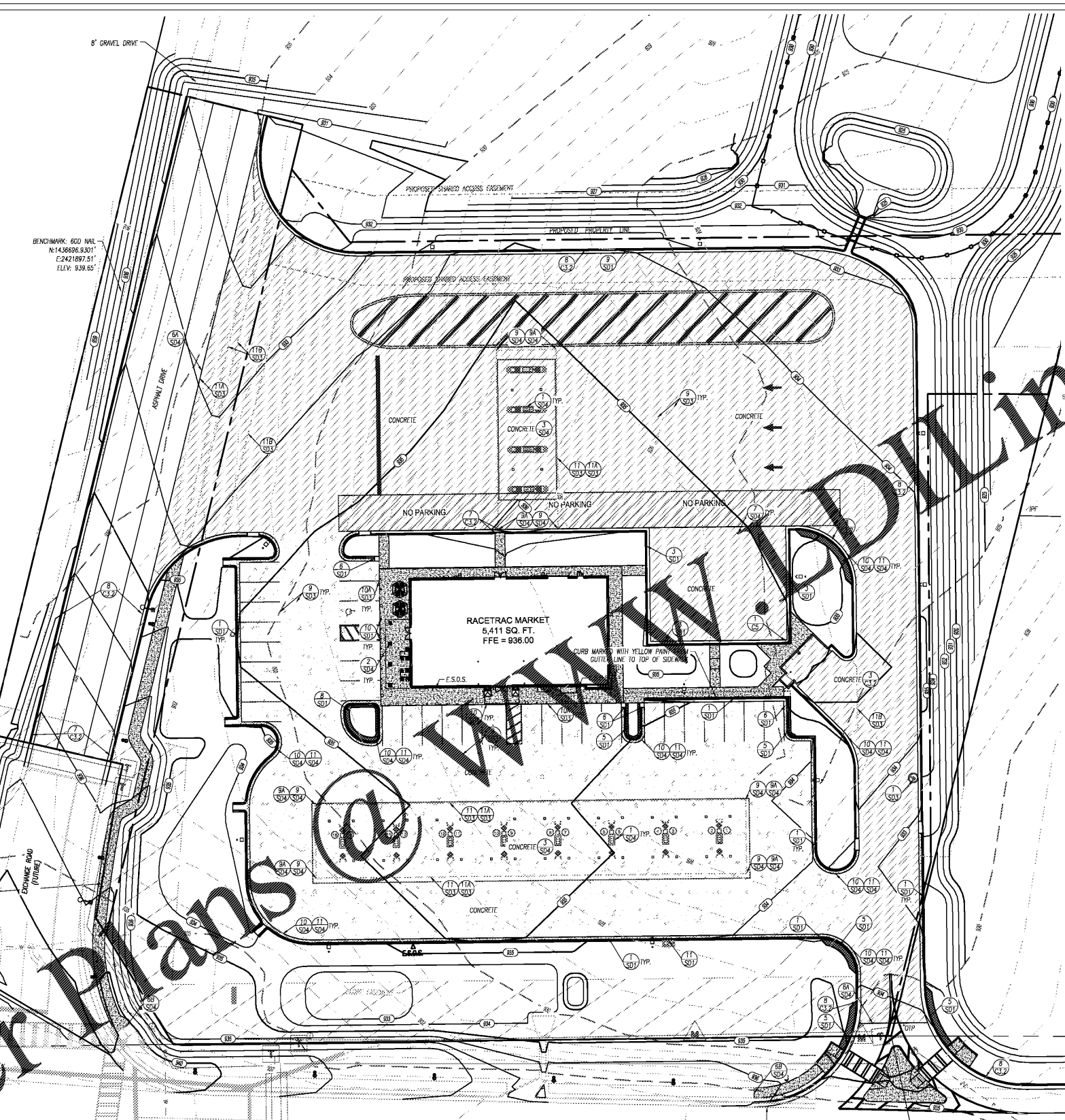

PAVING PLAN NOTES:

ALL SIGNS, PAVEMENT MARKINGS, AND OTHER TRAFFIC CONTROL DEVICES SHALL CONFORM TO THE 'MANUAL ON UNIFORM TRAFFIC CONTROL DEVICES' LATEST EDITION.

TRAFFIC CONTROL SHALL BE IN ACCORDANCE WITH THE STATE DOT STANDARD SPECIFICATIONS FOR ROADS AND BRIDGES. CONTRACTOR SHALL REVIEW ALL TRAFFIC CONTROL DEVICES WITH DOT PRIOR TO INSTALLATION.

CONTRACTOR SHALL FURNISH AND INSTALL ALL PAVEMENT MARKINGS FOR PARKING STALLS, HANDICAPPED PARKING SYMBOLS, AND MISCELLANEOUS STRIPING WITHIN PARKING LOT AND AROUND BUILDING.

ALL HANDICAP RAMPING, STRIPING, AND PAVEMENT MARKINGS SHALL CONFORM TO THE AMERICANS WITH DISABILITIES ACT OF 1990.

CONTRACTOR TO SUBMIT A JOINTING PLAN TO THE CONSTRUCTION MANAGER PRIOR TO THE BEGINNING OF ANY PAVING WORK.

PAVING CONTRACTOR TO COORDINATE WITH BUILDING CONTRACTOR ON THE CONSTRUCTION AND PAVING NEAR THE SCREENING WALLS AND THE DUMPSTER PADS.

ALL DISCREPANCIES FOUND BY CONTRACTOR RELATIVE TO UNDERGROUND UTILITIES OR OTHER APPURTENANCES SHALL BE RESOLVED TO THE SATISFACTION OF OWNER AND ENGINEER PRIOR TO PLACEMENT OF ANY PAVING. CONTRACTOR TO ASSURE POSITIVE DRAINAGE FROM THE PROPOSED BUILDINGS AND NO PONDING IN SUBGRADE AREAS TO BE PAVED. ADVISE OWNER AND ENGINEER IF ANY DISCREPANCIES ARE FOUND PRIOR TO INSTALLATION OF ANY PAVING.

EXISTING MANHOLE TOPS, VALVE BOXES, ETC. SHALL BE ADJUSTED AS REQUIRED TO MATCH PROPOSED GRADES. IF NECESSARY, RE-ADJUSTMENTS SHALL BE PERFORMED UPON COMPLETION OF PAVING AND FINE GRADING TO ENSURE A SMOOTH TRANSITION.

ALL PAVEMENT TO BE SLOPED FOR POSITIVE DRAINAGE.

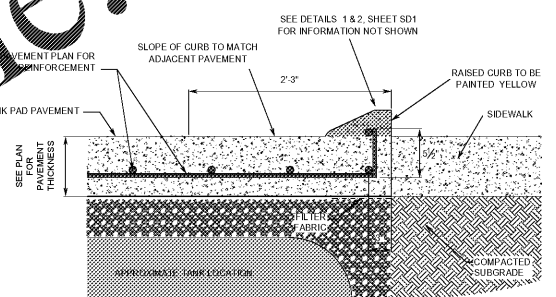

- NOTES:
- CURB CONSTRUCTION AND CONTRACTION JOINTS LOCATIONS NOT TO EXCEED 10 FEET.
 - SAWCUT CONTRACTION JOINTS 1/8" WIDE BY 1-1/2" DEEP AS SOON AS CONCRETE HAS HARDENED SUFFICIENTLY TO PREVENT RAVELING OR DISLODGING OF AGGREGATES.
 - SAWCUT CONTRACTION JOINTS 1/8" WIDE BY 1" DEEP, SIMILAR TO DETAIL 9A, SHEET SD3. VERIFY JOINT LOCATIONS WITH THE OWNER'S REPRESENTATIVE.
 - THIS CURB TYPE IS TO BE USED ALONG THE CURB LINE ADJACENT TO THE TANK PAVEMENT. SEE PLAN FOR LOCATION.
 - WHERE CONCRETE ABUTS LANDSCAPE AREA, TRANSITION CURB BACK-FILL & ENSURE POSITIVE DRAINAGE.

1 TANK AREA CURB DETAIL
C5 NTS

03.03.2020	REVISION PER DEVELOPER CHANGES	NO.	DATE
02.24.2020	REVISION PER DEVELOPER CHANGES	5	02.24.2020
10.07.2019	REVISION PER DEVELOPER CHANGES	4	10.07.2019
02.11.2019	REVISION PER BARROW COUNTY GASWCC & RACETRAC COMMENTS	3	02.11.2019
08.01.2018	REVISION PER BARROW COUNTY GASWCC & RACETRAC COMMENTS	2	08.01.2018
05.17.2018	REVISION PER BARROW COUNTY GASWCC & RACETRAC COMMENTS	1	05.17.2018

 W&A Engineering CIVIL ENGINEERING - LANDSCAPE ARCHITECTURE ARCHITECTURE - SOIL AND ENVIRONMENTAL ENGINEERING TRAFFIC ENGINEERING - TECHNICAL SURVEYING	THESE PLANS ARE LEGAL SUBJECT TO ANY APPLICABLE COPYRIGHT LAWS. ANY USE OF SAME WITHOUT THE EXPRESSED WRITTEN PERMISSION OF RACETRAC PETROLEUM, INC. IS PROHIBITED.
 RACETRAC PETROLEUM, INC. 200 GALLERIA PARKWAY SE SUITE 600 ATLANTA, GA 30339 (770) 431-7600	PAVING PLAN RACETRAC 316@81 839 Loganville Highway Bethlehem, Georgia Barrow County
DRAWN-BY: AGRUNER DATE: 02.28.2018 SCALE: 1" = 30' DRAWING NAME: Conset-17293.dwg	SHEET NO. C5 VERSION