

KNOW WHAT'S BELOW
CALL BEFORE YOU DIG
THREE WORKING DAYS
BEFORE YOU DIG

LEGEND

- DB = DRED BOOK
- FB = PLAT BOOK
- ZDL = ZONING DEMARCATION LINE
- TP = TYPICAL
- IX = EXISTING
- PR = PROPOSED
- BA = TO BE ABANDONED
- TR = TO BE TRIMMED
- TF = TO BE FILLED
- U.E. = UTILITY EASEMENT
- SS = SANITARY SEWER EASEMENT
- DE = DRAINAGE EASEMENT
- C = COMPACT PARKING SPACE
- OSSA = OPEN SOIL SURFACE AREA
- SSL = BUILDING SETBACK LINE
- PSL = PARKING SETBACK LINE
- FTE = FINISHED FLOOR ELEVATION
- SSM = SANITARY SEWER MANHOLE
- UP = UTILITY POLE
- PC = PROPERTY CORNER
- PCF = PROPERTY CORNER FOUND
- PCRF = PROPERTY CORNER FOUND
- IPF = IRON PIN FOUND
- IPS = IRON PIN SET 1/2" REBAR
- CMF = CONCRETE MONUMENT FOUND
- OIP = OPEN TOP PIPE
- CO = CLEAN OUT
- SSM = SANITARY SEWER MANHOLE
- DIP = DUCTILE IRON PIPE
- FI = FIRE HYDRANT
- WM = WATER METER
- WV = WATER VALVE
- TP = TELEPHONE POLE
- PP = POWER POLE
- PTP = POWER TELEPHONE POLE
- LP = LIGHTPOST
- TSIG = TRAFFIC SIGNAL
- UPED = UNDERGROUND TELEPHONE PEDestal
- FD = FIBER OPTIC PEDESTAL
- TRNS = TRANSFORMER
- DI = DRAIN INLET
- GI = GRATE INLET
- HGI = HOODED GRATE INLET
- JB = JUNCTION BOX
- OCS = OUTLET CONTROL STRUCTURE
- RCP = REINFORCED CONCRETE PIPE
- CMF = CORRUGATED METAL PIPE
- HDP = HIGH DENSITY POLYETHYLENE
- E = INVERT ELEVATION
- UBCB = LEFT WING CATCH BASIN
- RCB = RIGHT WING CATCH BASIN
- UCB = DOUBLE WING CATCH BASIN
- FES = FLARED END SECTION
- SDY WIRE =
 - SS - SANITARY SEWER
 - W - WATER
 - U - UNDERGROUND UTILITY
 - W - OVERHEAD UTILITY
 - T - UNDERGROUND TELECOMM.
 - GAS - GAS
 - LOC - LIMITS OF CLEARING

NPDES "STAND ALONE CONSTRUCTION" PERMIT NOTES

1. THE DESIGN PROFESSIONAL WHO PREPARED THE ES&PC PLAN IS TO INSPECT THE INSTALLATION OF THE INITIAL SEDIMENT STORAGE REQUIREMENTS AND PERIMETER CONTROL BMP'S WITHIN 7 DAYS AFTER INSTALLATION.
2. NON-EXEMPT ACTIVITIES SHALL NOT BE CONDUCTED WITHIN THE 25 OR 50-FOOT UNDISTURBED STREAM BUFFERS AS MEASURED FROM THE POINT OF THE WRISTED VEGETATION OR WITHIN 25-FEET OF THE COASTAL MARSHLAND BUFFER AS MEASURED FROM THE JURISDICTIONAL DETERMINATION LINE WITHOUT FIRST ACQUIRING THE NECESSARY VARIANCES AND PERMITS.
3. AMENDMENTS/REVISIONS TO THE ES&PC PLAN WHICH HAVE A SIGNIFICANT EFFECT ON BMP'S WITH A HYDRAULIC COMPONENT MUST BE CERTIFIED BY THE DESIGN PROFESSIONAL AND APPROVED BY ATHENS-CLARKE COUNTY DEPARTMENT OF TRANSPORTATION & PUBLIC WORKS.
4. WASTE MATERIALS SHALL NOT BE DISCHARGED TO WATERS OF THE STATE, EXCEPT AS AUTHORIZED BY A SECTION 404 PERMIT.
5. THE ESCAPE OF SEDIMENT FROM THE SITE SHALL BE PREVENTED BY THE INSTALLATION OF EROSION AND SEDIMENT CONTROL MEASURES AND PRACTICES PRIOR TO LAND DISTURBING ACTIVITIES.
6. EROSION CONTROL MEASURES WILL BE MAINTAINED AT ALL TIMES. IF FULL IMPLEMENTATION OF THE APPROVED PLAN DOES NOT PROVIDE FOR EFFECTIVE EROSION CONTROL, ADDITIONAL EROSION AND SEDIMENT CONTROL MEASURES SHALL BE IMPLEMENTED TO CONTROL OR TREAT THE SEDIMENT SOURCE.
7. ANY DISTURBED AREA LEFT EXPOSED FOR A PERIOD GREATER THAN 14 DAYS SHALL BE STABILIZED WITH MULCH OR TEMPORARY SEEDING.

LIMITS OF DISTURBANCE

LIMITS OF DISTURBANCE IS THE SAME AS INDICATED BY THE LIMITS OF CLEARING AND GRADING/CLEARING LIMITS SHOWN ON THE PLANS.

ENVIRONMENTAL BUFFERS NOTE

WHEN PRESENT, ALL ENVIRONMENTAL BUFFERS SHALL BE CLEARLY DELINEATED IN THE FIELD BEFORE CLEARING AND GRUBBING BEGINS.

OUTFALL SAMPLING POINT

⊕ INDICATES THE LOCATION OF OUTFALL SAMPLING POINTS.

BENCHMARK

BENCHMARK TO BE IRON PIN FOUND AT THE CORNER OF PROPERTIES XX052 103, XX072 009A, AND XX072 010.
(NORTHING: 1437131.20' - EASTING: 2422134.08' - ELEVATION: 923.01')

EROSION AND SEDIMENT CONTROL NOTES

1. IF SEASONAL LIMITATIONS DELAY PLANTING OF GRASS THEN STRAW MULCH STABILIZATION SHALL BE PLACED IN ACCORDANCE WITH COUNTY STANDARDS.
2. THE CONSTRUCTION OF THE SITE WILL COMMENCE WITH THE INSTALLATION OF EROSION CONTROL MEASURES SUFFICIENT TO CONTROL SEDIMENT DEPOSITS AND EROSION.
3. STANDARDS AND SPECIFICATIONS: ALL DESIGNS WILL CONFORM TO AND ALL WORK WILL BE PERFORMED IN ACCORDANCE WITH THE STANDARDS AND SPECIFICATIONS OF THE PUBLICATION ENTITLED "MANUAL FOR SOIL EROSION AND SEDIMENT CONTROL IN GEORGIA".
4. ADDITIONAL EROSION CONTROL MEASURES WILL BE EMPLOYED WHERE DETERMINED NECESSARY BY ACTUAL SITE CONDITIONS AND/OR AS SPECIFIED BY THE COUNTY INSPECTOR.
5. ACCUMULATED SILT SHALL BE REMOVED WHEN IT REACHES A DEPTH OF 6" AT THE EROSION PROTECTION DEVICE.
6. ALL SEDIMENT CONTROL SHALL BE MAINTAINED UNTIL ALL UPSTREAM GROUND HAS BEEN COMPLETELY STABILIZED WITH PERMANENT VEGETATION.
7. ALL CONSTRUCTION IS TO BE IN ACCORDANCE WITH STATE LAWS AND LOCAL ORDINANCES AND SPECIFICATIONS. IT IS THE CONTRACTOR'S RESPONSIBILITY TO NOTIFY COUNTY OFFICIALS OF ALL REQUIRED INSPECTIONS.
8. THE CONSTRUCTION EXIT SHALL BE MAINTAINED IN A CONDITION WHICH WILL PREVENT TRACKING OF MUD ONTO PUBLIC RIGHTS OF WAY.
9. ALL CONSTRUCTION CONTRACTORS MUST OBSERVE THE LIMITS OF CONSTRUCTION OR DISTURBANCE AS SHOWN.
10. MULCH WHERE NECESSARY WILL BE APPLIED AT A RATE OF 2 1/2 TONS PER ACRE.
11. 6/15/12 FERTILIZER SHALL BE APPLIED AT A RATE OF 1500 POUNDS PER ACRE TO REVEGETATED AREAS. APPLY LIME AT A RATE OF 2 TONS PER ACRE.
12. ALL SILT FENCE IS TYPE "NS" UNLESS OTHERWISE SPECIFIED.
13. INSTALL GEOTEXTILE LINER UNDERNEATH CONSTRUCTION EXIT AS SHOWN IN DETAIL ON UNIFORM COORDINATE SHEET.

EROSION AND SEDIMENT CONTROL MEASURES SHALL BE ESTABLISHED PRIOR TO ANY OTHER CONSTRUCTION ACTIVITIES ON SITE. ALL EROSION AND SEDIMENT CONTROL FACILITIES SHALL BE MAINTAINED UNTIL PERMANENT GROUND COVER IS ESTABLISHED.
STORMWATER MANAGEMENT FACILITIES SHALL BE INSTALLED IN ACCORDANCE WITH ALL LOCAL, STATE, AND OTHER APPROPRIATE ORDINANCES AND REGULATIONS.
WASHOUT OF A CONCRETE MIXER OR DRUM IS PROHIBITED.

ES&PC POND DETAIL - PHASE II

GRADING PHASE NOTES

1. THE FOLLOWING EROSION CONTROL MEASURES SHALL BE IMPLEMENTED DURING THE GRADING PHASE OF CONSTRUCTION.
 2. DURING CONSTRUCTION, THE CONTRACTOR SHALL MAINTAIN CAREFUL SCHEDULING AND PERFORMANCE TO ENSURE THAT LAND STORAGE OF ITS NATURAL GROUND COVER IS EXPOSED ONLY IN SMALL QUANTITIES AND THEREFORE LIMITED DURATIONS, BEFORE PERMANENT EROSION PROTECTION IS ESTABLISHED.
 3. EARTHWORK OPERATIONS IN THE VICINITY OF STREAM BUFFERS SHALL BE CAREFULLY CONTROLLED TO AVOID DUMPING OR SLOUGHING INTO THE BUFFER AREAS.
 4. SEDIMENT SHALL NOT BE ALLOWED TO WASH INTO INLETS. IT SHALL BE REMOVED FROM THE SEDIMENT TRAPS AND DISPOSED OF OR STABILIZED SO THAT IT WILL NOT ENTER THE INLETS AGAIN.
 5. EROSION CONTROL DEVICES SHALL BE INSTALLED IMMEDIATELY AFTER GROUND DISTURBANCE OCCURS. THE LOCATION OF SOME OF THE EROSION CONTROL DEVICES MAY HAVE TO BE ALTERED FROM THAT SHOWN ON THE APPROVED PLANS IF DRAINAGE PATTERNS DURING CONSTRUCTION ARE DIFFERENT FROM THE PROPOSED DRAINAGE PATTERNS. IT IS THE CONTRACTOR'S RESPONSIBILITY TO ACCOMPLISH EROSION CONTROL FOR ALL DRAINAGE PATTERNS CREATED AT VARIOUS STAGES DURING CONSTRUCTION. ANY DIFFICULTY IN CONTROLLING EROSION DURING ANY PHASE OF CONSTRUCTION SHALL BE REPORTED TO THE DESIGN PROFESSIONAL IMMEDIATELY.
 6. THE CONTRACTOR SHALL MAINTAIN ALL NECESSARY BARRICADES WHILE THE SITE IS UNDER CONSTRUCTION AND IMPROVEMENTS ARE BEING MADE.
 7. THE TYPE AND HEIGHT OF SILT FENCE SHOULD BE INSTALLED AT THE TOP OF ALL SLOPES 3:1 OR GREATER IN HEIGHT. THE SILT FENCE SHOULD BE PLACED ACCORDING TO THE MANUAL FOR EROSION CONTROL IN GEORGIA, TABLE 302.2. THE SILT FENCE SHALL BE MAINTAINED UNTIL PERMANENT GROUND COVER IS ESTABLISHED ON THE SLOPE. SILT SHALL BE REMOVED WHEN ACCUMULATION REACHES 1/2 HEIGHT OF THE BARRIER. ADDITIONALLY, DIVERSION CHANNELS SHALL BE CONSTRUCTED ALONG THE TOP OF ALL SLOPE TELL SLOPES WITH THE USE OF TEMPORARY DOWN DRAINS TO CONTROL STORM WATER RUN OFF AS SHOWN ON THE PLANS. SEE SEPARATE DETAILS FOR ADDITIONAL INFORMATION.
 8. THE CONTRACTOR SHALL BE RESPONSIBLE FOR ESTABLISHING BARRIERS AT THE TOP OF ALL SLOPES UNDER CONSTRUCTION. THESE BARRIERS SHALL BE AS SHOWN IN THE PLANS. THESE BARRIERS MAY BE RELOCATED AND REPLACED AFTER PERMANENT SLOPE STABILIZATION BECOMES FULLY ESTABLISHED, AS THEY ARE RELOCATED, ANY DEFECTIVE MATERIALS IN THE BARRIER SHALL BE REMOVED. IN ADDITION, ALL DEBRIS AND SILT AT THE PREVIOUS LOCATION SHALL BE REMOVED.
 9. CUT AND FILL SLOPES ARE NOT TO EXCEED "3H:1V", UNLESS SHOWN AND LABELED ON THE PLANS.
 10. THE FOLLOWING EROSION CONTROL MEASURES SHALL BE IMPLEMENTED DURING THE PRELIMINARY GRADING PHASE OF CONSTRUCTION:
 - a. TYPE "A" SILT FENCE SHALL BE PLACED AT THE TOP OF ALL DIRT STOCK PILE AREAS. SEE SEPARATE DETAILS SHEET FOR ADDITIONAL INFORMATION.
 - b. INLET SEDIMENT PROTECTION MEASURES SHALL BE INSTALLED ON ALL STORM STRUCTURES AS THEY ARE CONSTRUCTED. SEE PLAN VIEW FOR SPECIFIC TYPE AND SEPARATE DETAILS SHEET FOR ADDITIONAL INFORMATION ON THE TYPE OF INLET PROTECTION SPECIFIED.
 - c. STORM DRAIN OUTLET PROTECTION SHALL BE PLACED AT ALL OUTLET HEADWALLS AS SOON AS THE HEADWALL IS CONSTRUCTED. SEE SEPARATE DETAILS SHEET FOR ADDITIONAL INFORMATION.
 - d. STONE CHECK DAMS SHALL BE INSTALLED IN AREAS OF CONCENTRATED FLOWS AS SHOWN ON THE PLAN. SEE SEPARATE DETAILS SHEET FOR ADDITIONAL INFORMATION.
 - e. ALL DRAINAGE SWALES AND GRADED AREAS SHALL BE APPLIED WITH VEGETATIVE COVER AS SOON AS FINAL GRADE IS ACHIEVED.
 - f. MULCH OR TEMPORARY GRASSING SHALL BE APPLIED TO ALL EXPOSED AREAS WITHIN 14 DAYS OF LAND DISTURBANCE.
 - g. ALL DISTURBED AREAS LEFT MULCHED AFTER 30 DAYS SHALL BE STABILIZED WITH TEMPORARY GRASSING.
 - h. AFTER PRELIMINARY GRADING ACTIVITIES, THE CONTRACTOR SHALL CONSTRUCT OR MAINTAIN TEMPORARY SEDIMENT BASINS AND DIVERSION DITCHES AS SHOWN ON PLAN. THE CONTRACTOR SHALL MAINTAIN THE SEDIMENT POND UNTIL PERMANENT GROUND COVER IS ESTABLISHED. SEDIMENT SHALL BE CLEANED OUT OF THE PONDS WHEN IT REACHES THE 1/2 DEPTH OF BASIN. SEE SEPARATE DETAILS SHEET FOR ADDITIONAL INFORMATION.
 - i. SEDIMENT AND EROSION CONTROL MEASURES SHALL BE CHECKED AFTER EACH RAIN EVENT. EACH DEVICE IS TO BE MAINTAINED OR REPLACED IF SEDIMENT ACCUMULATION HAS REACHED ONE HALF THE CAPACITY OF THE DEVICE. ADDITIONAL DEVICES MUST BE INSTALLED IF NEW CHANNELS HAVE DEVELOPED.
 - j. THE CONSTRUCTION EXIT SHALL BE MAINTAINED IN A CONDITION WHICH WILL PREVENT THE TRACKING OR FLOW OF MUD ONTO PUBLIC RIGHTS OF WAY. THIS MAY REQUIRE PERIODIC TOP DRESSING WITH 1"-1 1/2" OF STONE, AS CONDITIONS DEMAND. ALL MATERIALS SPILLED, DROPPED, WASHED, OR TRACKED FROM VEHICLES ONTO PUBLIC ROADWAYS OR INTO STORM DRAINS MUST BE REMOVED IMMEDIATELY.
 - k. THE CONTRACTOR SHALL INSPECT CONTROL MEASURES AT THE END OF EACH WORKING DAY TO ENSURE MEASURES ARE FUNCTIONING PROPERLY.
 - l. EROSION CONTROL MEASURES SHALL BE MAINTAINED AT ALL TIMES. IF FULL IMPLEMENTATION OF THE APPROVED PLAN DOES NOT PROVIDE FOR EFFECTIVE EROSION CONTROL, ADDITIONAL EROSION AND SEDIMENT CONTROL MEASURES SHALL BE IMPLEMENTED TO CONTROL OR TREAT THE SEDIMENT SOURCE AS DIRECTED BY THE ON-SITE INSPECTOR OR THE CIVIL ENGINEER.
- FAILURE TO INSTALL, OPERATE, OR MAINTAIN ALL EROSION CONTROL MEASURES WILL RESULT IN ALL CONSTRUCTION BEING STOPPED ON THE JOB UNTIL SUCH MEASURES ARE CORRECTED BACK TO THE APPROVED EROSION CONTROL PLANS.
- THE SITE CONTRACTOR WILL BE RESPONSIBLE FOR THE MAINTENANCE OF ALL EROSION CONTROL MEASURES INCLUDING REPLACING OR REPAIRING ANY DAMAGED DEVICES DUE TO ANY CONSTRUCTION ACTIVITY BY OTHERS.

EXISTING UTILITIES NOTE

THE CONTRACTOR SHALL VERIFY ALL UTILITY LOCATIONS PRIOR TO DIGGING, INCLUDING GAS, ELECTRICAL AND TELECOMMUNICATION LINES. EXISTING UTILITIES SHOWN ON PLAN ARE APPROXIMATE. ANY DAMAGE TO SUCH UTILITIES SHALL BE REPAIRED AT THE CONTRACTOR'S EXPENSE. W&A ENGINEERING SHALL BE NOTIFIED OF ANY DISCREPANCIES IMMEDIATELY.

EROSION CONTROL NOTES

EROSION AND SEDIMENT CONTROL MEASURES SHALL BE INSTALLED PRIOR TO ANY OTHER CONSTRUCTION ON THE SITE AND SHALL BE MAINTAINED UNTIL A PERMANENT GROUND COVER IS ESTABLISHED.

SOIL EROSION PREVENTION METHODS THAT ARE DEEMED NECESSARY ON THIS SITE WILL BE INSTALLED AND MAINTAINED IN ACCORDANCE WITH ALL FEDERAL, STATE AND LOCAL ORDINANCES AND CODES.

GENERAL NOTES

1. ALL UTILITIES ARE APPROXIMATELY LOCATED.
2. ALL PROPOSED UTILITIES ARE TO BE LOCATED WITHIN UTILITY EASEMENTS.
3. ALL SIGNS SHALL BE IN COMPLIANCE WITH THE BARRON COUNTY LOC AT THE TIME THE PERMITS ARE REQUESTED.
4. STORM WATER MANAGEMENT SHALL BE IN ACCORDANCE WITH ALL COUNTY STATE AND OTHER APPROPRIATE ORDINANCES AND REGULATIONS IN EFFECT AT THE TIME OF CONSTRUCTION PLAN APPROVAL.

24 HR CONTACT:

RACETRAC PETROLEUM
200 GALLERIA PARKWAY SE
ATLANTA, GA 30339
ATTN: CHANCE DENNIS
770-431-7600

SHOULD 24 HOUR CONTACT CHANGE, NOTIFICATION MUST BE MADE TO BUILDING INSPECTOR IMMEDIATELY.

ES&PC PHASE 2 LIMITS OF DISTURBANCE

PHASE 2 DISTURBANCE INCLUDES ALL AREAS DESIGNATED FOR SITE GRADING AS WELL AS AREAS NECESSARY TO MAINTAIN THE CONSTRUCTION ENTRANCE, PERIMETER SILT FENCING AND TEMPORARY SEDIMENT BASIN. SLOW POND CONSTRUCTION AND UTILITY INSTALLATION SHALL BEGIN IN ES&PC PHASE 2.

THE TOTAL AREA DRAINED FOR PHASE II IS 13.04 ACRES.

THE TOTAL SEDIMENT STORAGE REQUIRED IS: 13.04 ACRES DISTURBED X 57 CY = 874 CY

SEDIMENT STORAGE WILL BE PROVIDED FOR AS FOLLOWS:
POND: 2189 CY
SILT FENCE (0.14 CY/LS X 1045 LS) = 146 CY
TOTAL SEDIMENT STORAGE PROVIDED = 2335 CY

NOTE: INCREASE SEDIMENT BASINS TO PROVIDE SEDIMENT STORAGE OF AT LEAST 134 CY PER ACRE DRAINED PER APPENDIX 1.
13.04 ACRES DRAINED X 134 CY = 1747 CY

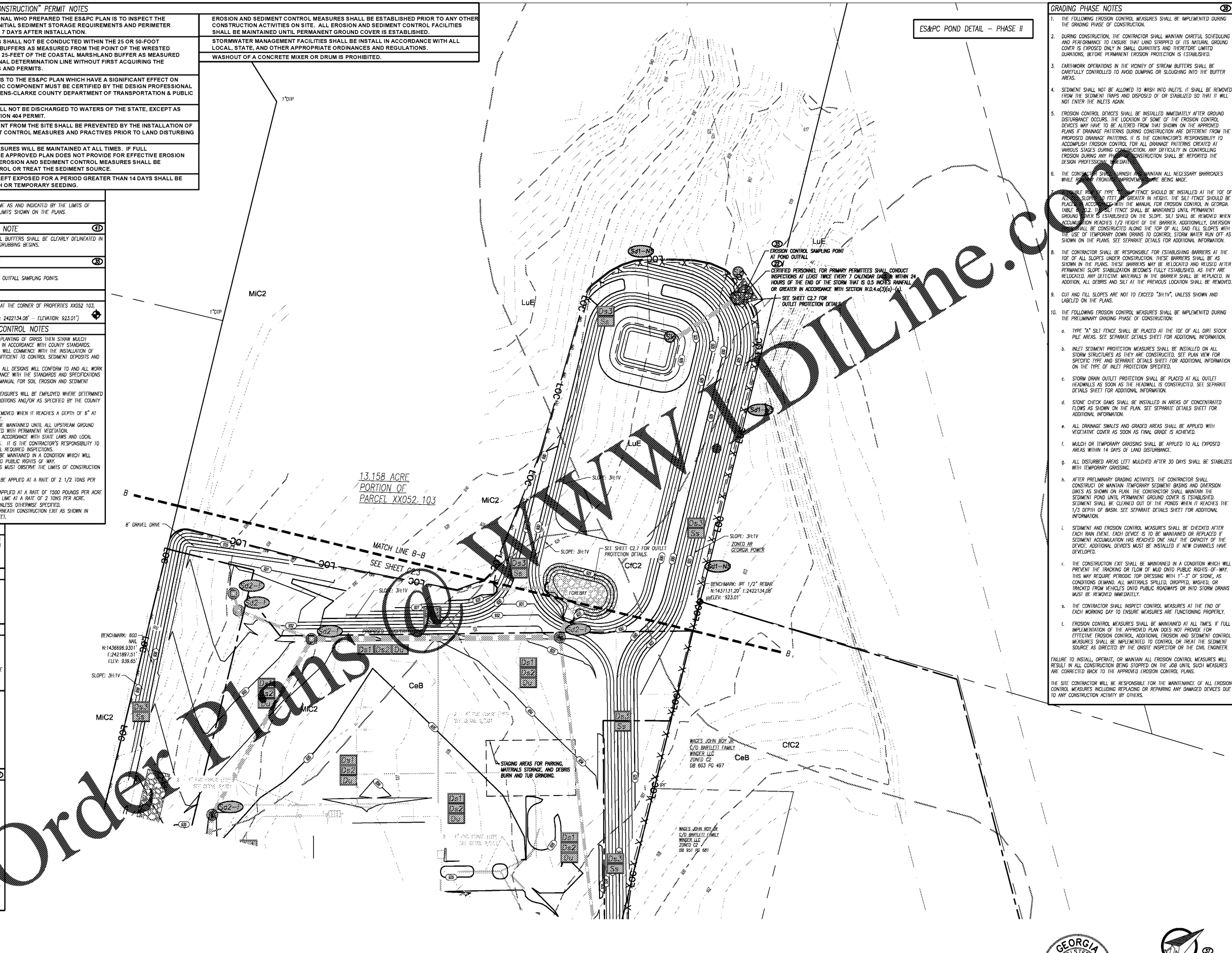

Order Plans

CONTACT RACETRAC PETROLEUM, INC. PROJECT MANAGER PRIOR TO ANY REVISIONS TO THE PLAN SUPPLIED BY RACETRAC PETROLEUM, INC.

SEDIMENT AND EROSION CONTROL CHECKLIST ITEMS CORRESPOND TO ①

NRCS SOILS DATA:

Soil Types Taken From USDA Soil Survey, Barrow, Hall and Jackson Counties, Georgia

MAP SYMBOL	SOIL TYPE	SLOPES	ERODED	DEPTH	PERMEABILITY	K FACTOR
CaB	Coill Sandy Clay Loam	2-6%	>60"	0.8-0.2in./Hrs.	0.20	
CIC2	Coill Sandy Clay Loam	6-10%	Eroded	>60"	0.8-0.2in./Hrs.	0.15
LUE	Rion/Wateren Complex	10-25%	>60"	0.8-2.0in./Hrs.	0.15	
MIC2	Madison Sandy Clay Loam	6-10%	Moderately Eroded	>60"	0.8-2.0in./Hrs.	0.10

GSWCC LEVEL II CERTIFICATION # 3588

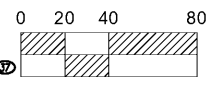

ES&PC PHASE II POND

RACETRAC 316@81

839 Loganville Highway
Bethlehem, Georgia
Barrow County

DATE: 02.28.2018
SCALE: 1" = 40'
DRAWING NAME: Conset-17293.dwg

C2.3.1
SHEET NO. VERSION

W&A Engineering
Civil, Mechanical, Electrical, Landscape Architectural, Surveying, Soil and Environmental Engineering, Construction Management, Technology Development

REVISED PER GSWCC COMMENTS
REVISED PER DEVELOPER CHANGES

NO. 3 2 1

DATE 01.15.2020 12.12.2019 10.07.2019

BY AGRUNER
DATE 02.28.2018
SCALE 1" = 40'
DRAWING NAME Conset-17293.dwg
SHEET NO. C2.3.1
VERSION