



COOPER CARRY
THE CENTER FOR CONNECTIVE ARCHITECTURE

191 Peachtree Street NE
Suite 2400
Atlanta, GA 30303-1770
(404) 237-2000
coopercarry.com

©2019 COOPER CARRY

SCOPE DOCUMENTS

The Contract Documents issued for [Conceptual Design, Schematic Design, Design Development, Partial Construction Documents or Other Issuance up to Issued for Construction] are intended to be at that level of development and as such, may be neither complete nor coordinated. The [Construction Manager, Contractor, Design/Builder] is responsible for complete and coordinated pricing [and execution] of the Work, and shall include items necessary for the proper execution and completion of the Work, as shown, specified, reasonably inferred or required for a complete Project. For Work of designed design, systems, assemblies, components and materials shall comply with national, state and local code requirements. The [Construction Manager, Contractor, Design/Builder] shall inform the Owner and Architect, in timely fashion, of any discovered omissions, inconsistencies or errors in the Contract Documents.

ISSUANCES

No.	Drawing Issue Description	Date
1	DESIGN DEVELOPMENT	3/18/20

- ELECTRICAL FIRE ALARM NOTES**
- FIRE ALARM SYSTEM AND ALL ASSOCIATED OPERATIONS SHALL BE IN ACCORDANCE WITH THE FOLLOWING:
 - GEORGIA ACCESSIBILITY CODE
 - NFPA 72, NATIONAL FIRE ALARM CODE (2012) WITH GEORGIA AMENDMENTS (2014)
 - NFPA 70, NATIONAL ELECTRICAL CODE (2017)
 - NFPA 101, LIFE SAFETY CODE (2012) WITH GEORGIA AMENDMENTS (2013)
 - NFPA 98A, STANDARD FOR THE INSTALLATION OF AIR CONDITIONING AND VENTILATION SYSTEMS
 - OTHER APPLICABLE NFPA STANDARDS
 - AUDIBLE/VISIBLE SIGNAL APPLIANCES SHALL COMPLY WITH THE REQUIREMENTS OF RULE 120-3-30-39 OF THE STATE ACCESSIBILITY CODE AND NFPA 72 (2012) EDITION.
 - PROVIDE SEAL FOR PENETRATION OF FIRE RATED WALLS BY CONDUIT.
 - ALL STROBES AND SPEAKING TROBES HAVE SWITCH SELECTABLE CANDLEA (15, 30, 60, 75, AND 110 CANDLEA) AT TIME OF INSTALLATION SET ALL STROBES AND HORNS TROBES TO 110 CANDLEA UNLESS OTHERWISE NOTED ON THE DRAWINGS BY SUBSCRIPT ADJACENT TO THE DEVICE SYMBOL. STATE ADA CODE REQUIRES A MIN. OF 75 CANDLEA AT ALL LOCATIONS.
 - MOUNT ALL STROBES AND SPEAKING TROBES AT 80 INCHES AFF OR 6 INCHES FROM THE CEILING, WHICH EVER IS LOWER.
 - ALL HVAC DUCT MOUNTED SMOKE DETECTORS TO BE LOCATED ON THE EXTERIOR OF ASSOCIATED DUCT WORK AND WITH EASY ACCESS PROVIDED FOR SERVICING AND TESTING.
 - COORDINATE ALL WALL MOUNTED FIRE ALARM DEVICES IN CLASSROOMS PRIOR TO ROUGH-IN.
 - PROVIDE LEXAN KEYS COVER FOR ALL MANUAL PULL STATIONS, EXISTING AND NEW.
 - PROVIDE FIRE ALARM CONNECTION TO SITE POST INDICATOR VALVE. COORDINATION WITH CIVIL PLANS.
 - PROVIDE ALTERNATE PRICE FOR PROVIDING NOTIFIER FIRE ALARM SYSTEM ONLY.

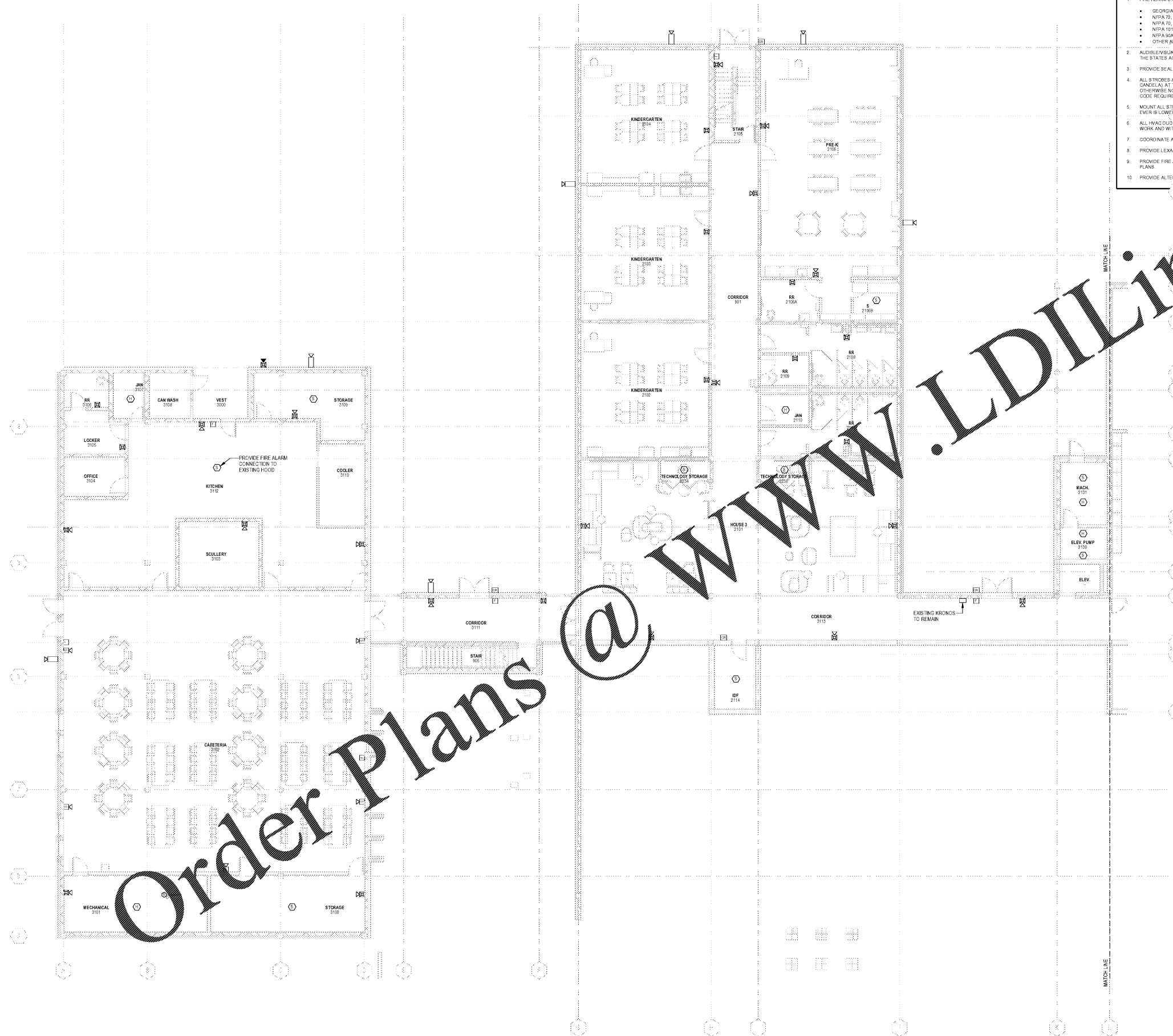

Order Plans @ www.LDILine.com

1 ELECTRICAL PARTIAL SPECIAL SYSTEMS PLAN - LEVEL 1 - AREA A
1/8" = 1'-0"

PROJECT NUMBER: 20190109 PROJECT NAME: BARACK & MICHELLE OBAMA ACADEMY
SHEET NUMBER: E6.11 - ELECTRICAL PARTIAL SPECIAL SYSTEMS PLAN - LOWER LEVEL AREA A
C:\p\m\shared\Drawings\9000's\9040 - BMO School\Electrical\9040 - BMO Academy - Electrical (R19).rvt
3/16/2020 4:25:07 PM

FTE - 450
EXISTING IU - 38
PROPOSED IU - 33

BARACK & MICHELLE OBAMA ACADEMY



970 Martin St SE, Atlanta, GA 30315

ATLANTA PUBLIC SCHOOL

ELECTRICAL PARTIAL SPECIAL SYSTEMS PLAN LOWER LEVEL AREA A

ROBERT JUST	20190109
Principal/Charge	Project No.
S. TARKHAN	03/09/20
Project Manager	Date
B. FERREN	
Project Architect	
E. SAADAT	
Staff Architect	
B. FERREN / J. KLEIN	
Interior Design	

E6.11