



SCOPE DOCUMENTS

The Contract Documents issued for [Conceptual Design, Schematic Design, Design Development, Partial Construction Documents or Other Issuance up to Issued for Construction] are intended to be at that level of development and as such, may be neither complete nor coordinated. The [Construction Manager, Contractor, Design/Builder] is responsible for complete and coordinated pricing [and execution] of the Work, and shall include items necessary for the proper execution and completion of the Work, as shown, specified, reasonably inferred or required for a complete Project. For Work of designed design, systems, assemblies, components and materials shall comply with national, state and local code requirements. The [Construction Manager, Contractor, Design/Builder] shall inform the Owner and Architect, in timely fashion, of any discovered omissions, inconsistencies or errors in the Contract Documents.

ISSUANCES

No.	Drawing Issue Description	Date
1	DESIGN DEVELOPMENT	3/18/20

FTE - 450
EXISTING IU - 38
PROPOSED IU - 33

BARACK & MICHELLE OBAMA
ACADEMY



970 Martin St SE, Atlanta, GA 30315
ATLANTA PUBLIC SCHOOL

ELECTRICAL PARTIAL HVAC/PLUMBING
PLAN LOWER UPPER AREA B

ROBERT JUST	20190109
Principal/Owner	Project No.
S. TARKHAN	03/15/20
Project Manager	Date
B. FERREN	
Project Architect	
E. SAADAT	
Staff Architect	
B. FERREN, J. KLEIN	E5.22
Interior Design	

DRAWING NOTES

- EXISTING HVAC UNIT TO BE RELOCATED. REFER TO MECHANICAL PLANS FOR EXISTING LOCATION. EXTEND AND RECONNECT ALL CIRCUITING.
- DO NOT RECEPTACLE IN WEATHERPROOF ENCLOSURE WITH TAMMAGE DEEP "N-USE" COVER ON ROOF. CIRCUIT TO NEAREST 120-VOLT NON-COMPUTER RECEPTACLE CIRCUIT.
- PROVIDE FIRE ALARM CONNECTION TO SMOKE DAMPERS.
- JUNCTION BOX ABOVE CEILING FOR HVAC CONTROL PANEL.

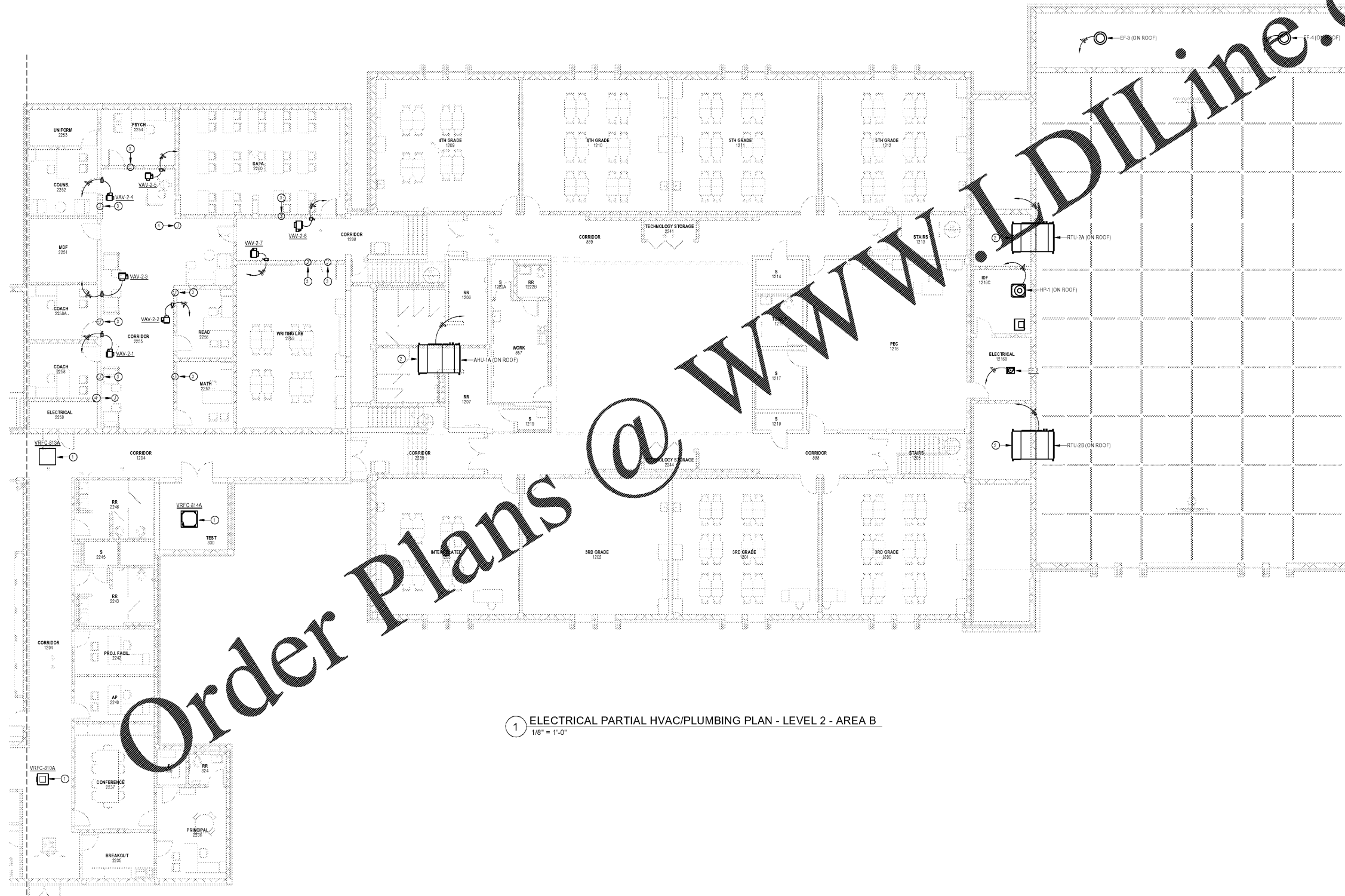

1 ELECTRICAL PARTIAL HVAC/PLUMBING PLAN - LEVEL 2 - AREA B
1/8" = 1'-0"

PROJECT NUMBER: 20190109 PROJECT NAME: BARACK & MICHELLE OBAMA ACADEMY
SHEET NUMBER: E5.22 ELECTRICAL PARTIAL HVAC/PLUMBING PLAN LOWER UPPER AREA B
C:\Egnyte\Shared\Drawings\9000's\9040 - BMO School\Electrical\9040 - BMO Academy - Electrical (R19).rvt
3/16/2020 4:24:42 PM