



COOPER CARRY
THE CENTER FOR CONNECTIVE ARCHITECTURE

191 Peachtree Street NE
Suite 2400
Atlanta, GA 30303-1770
(404) 237-2000
coopercarry.com

©2018 COOPER CARRY

SCOPE DOCUMENTS

The Contract Documents issued for (Conceptual Design, Schematic Design, Design Development, Permit Construction Documents or Other Issuance up to Issued for Construction) are intended to be at that level of (Construction Manager, Contractor, Design/Builder) is responsible for complete and coordinated pricing (and execution) of the Work, and shall include items necessary for the proper execution and completion of the Work, as shown, specified, reasonably inferred or required for a complete components and materials shall comply with national, state and local code shall inform the Owner and Architect, in timely fashion, of any discovered omissions, inconsistencies or errors in the Contract Documents.

| ISSUANCES | | |
|-----------|---------------------------|----------|
| No. | Drawing Issue Description | Date |
| 1 | DC SUBMISSION | 11/14/19 |
| 2 | DESIGN DEVELOPMENT | 3/18/20 |

FTE - 450
EXISTING IU - 38
PROPOSED IU - 33

**BARACK & MICHELLE OBAMA
ACADEMY**



970 Martin St SE, Atlanta, GA 30315

ATLANTA PUBLIC SCHOOLS

**1ST FLOOR PLUMBING
DEMOLITION PLAN - SUPPLY
AREA A**

| | |
|----------------------|----------|
| AG | 20190109 |
| THW | 03/18/20 |
| THW | |
| B. FERREN / J. KLEIN | |

P1.14

NOT ISSUED FOR CONSTRUCTION

GENERAL NOTES

1. SEE P0.01 FOR PLUMBING GENERAL NOTES.

KEY NOTES

- ① REMOVE EXISTING PLUMBING FIXTURE. EXISTING PLUMBING PIPING SHALL REMAIN AND BE REUSED BY NEW FIXTURE AT THE SAME LOCATION.
- ② REMOVE EXISTING PLUMBING FIXTURE. CAP ASSOCIATED PLUMBING PIPING IN CONCEALED LOCATION.
- ③ EXISTING PLUMBING FIXTURE SHALL REMAIN.

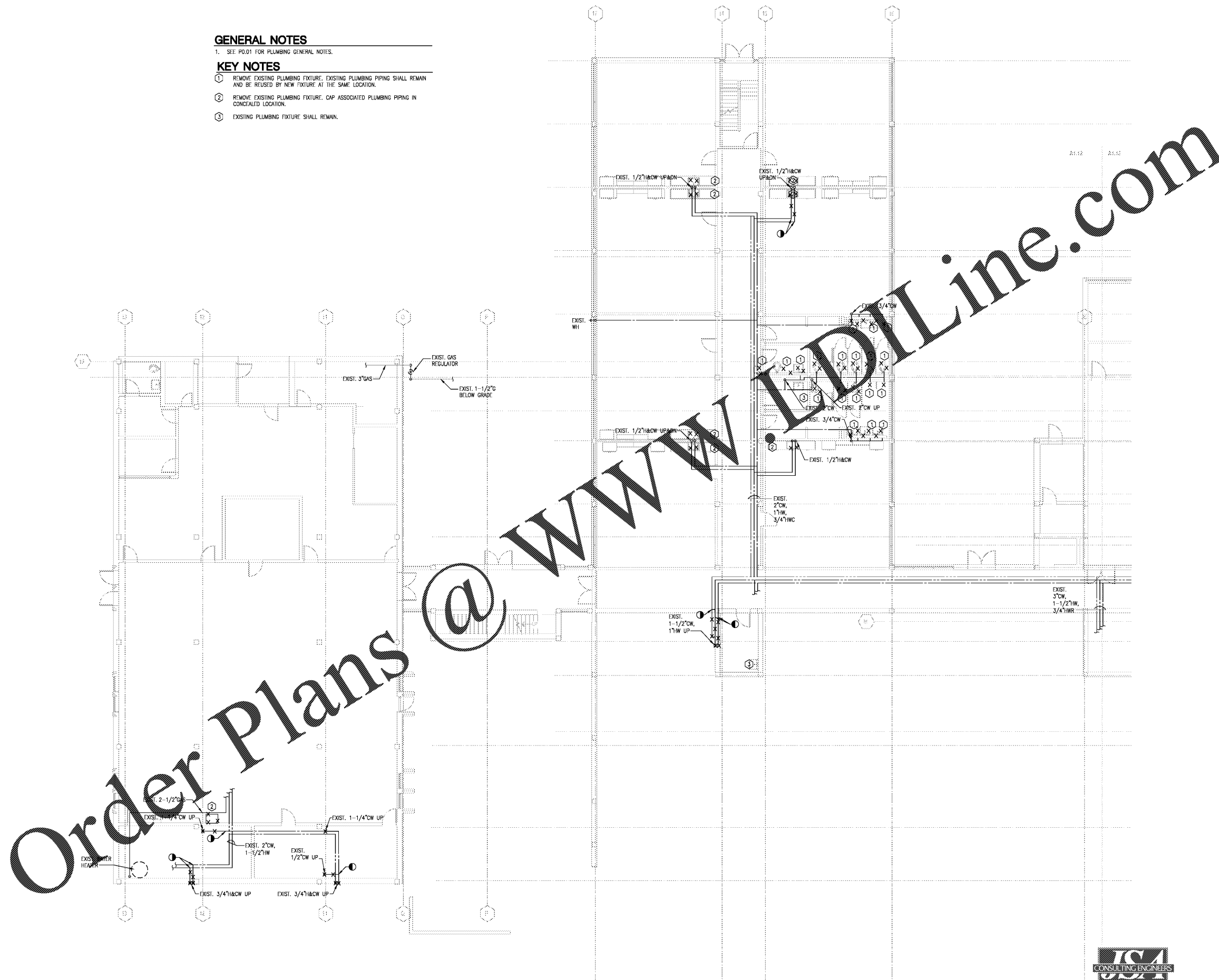

1ST FLOOR PLUMBING DEMOLITION PLAN - SUPPLY - AREA A
SCALE: 1/8" = 1'-0"



**Johnson, Spellman
& Associates, Inc.**
3055 Peachtree Corners, Suite 500
Peachtree Corners, GA 30092
770-447-0250 www.jsai.com

Order Plans @ www.IDLine.com