

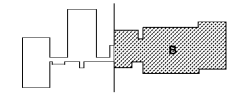

SCOPE DOCUMENTS
The Contract Documents Issued for [Conceptual Design, Schematic Design, Design Development, Partial Construction Documents or Other Issuance up to Issued for Construction] are intended to be at that level of development and as such, may be neither complete nor coordinated. The [Construction Manager, Contractor, Design/Builder] is responsible for complete and coordinated pricing [and execution] of the Work, and shall include items necessary for the proper execution and completion of the Work, as shown, specified, reasonably inferred or required for a complete Project. For Work of designated design, systems, assemblies, components and materials shall comply with national, state and local code requirements. The [Construction Manager, Contractor, Design/Builder] shall inform the Owner and Architect, in timely fashion, of any discovered omissions, inaccuracies or errors in the Contract Documents.

ISSUANCES		
No.	Drawing Issue Description	Date
1	DESIGN DEVELOPMENT	3/18/20

GADOE CODE: 5066
FTE - 450
EXISTING IU - 38
PROPOSED IU - 33



BARACK & MICHELLE OBAMA ACADEMY



970 Martin St SE, Atlanta, GA 30315
ATLANTA PUBLIC SCHOOLS

1ST FLOOR DEMOLITION PLAN - AREA B

ROBERT A. JUST	20190109
Principal Designer	Project No.
S. TARGHAN	031820
Project Manager	Date
B. FERREN	
Staff Architect	
G. HAHN	
Staff Architect	
B. FERREN / G. HAHN	
Interior Design	

A1.13

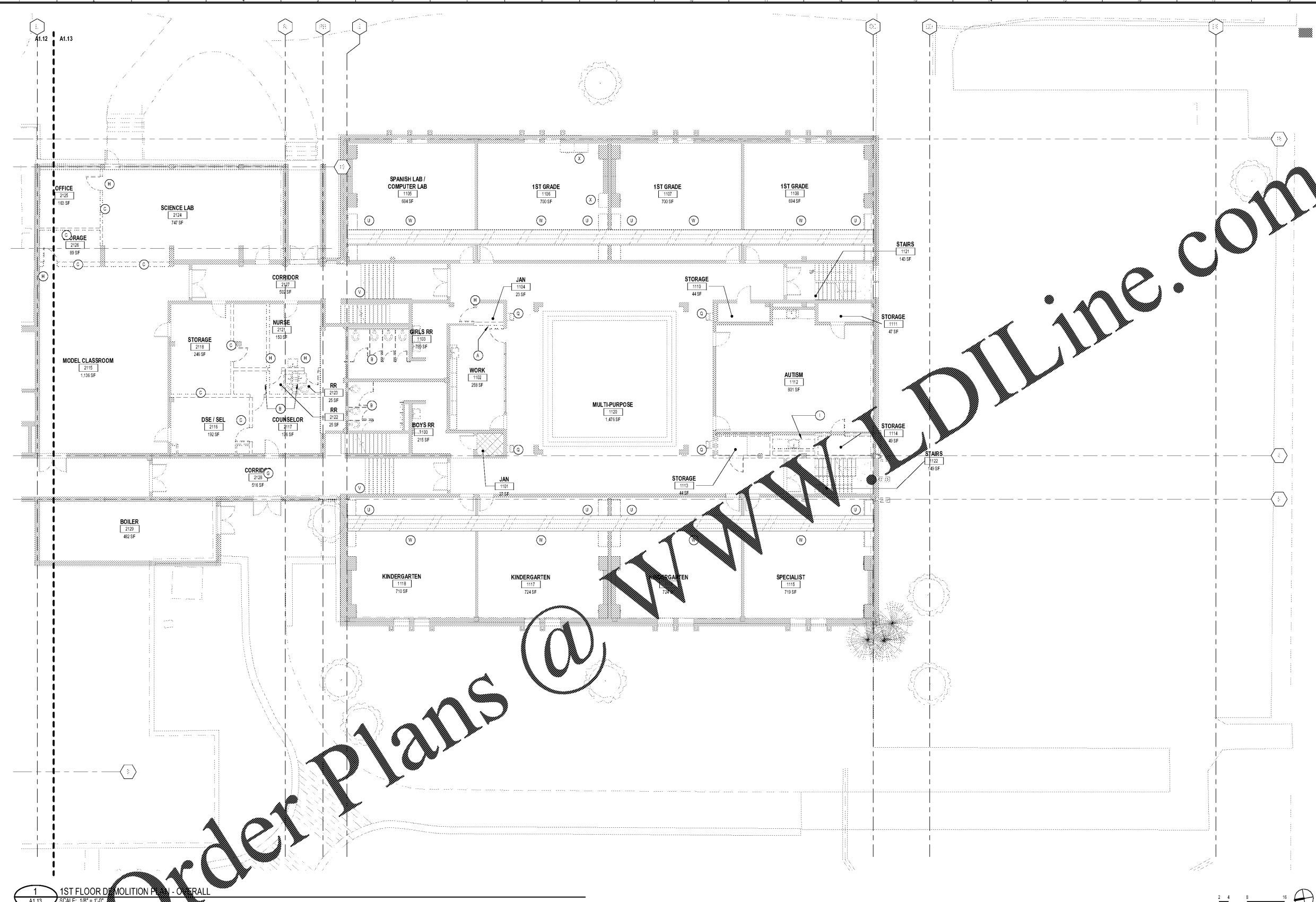

Order Plans @ WWW.LDILine.com

1 1ST FLOOR DEMOLITION PLAN - OVERALL
SCALE: 1/8" = 1'-0"

- DEMOLITION PLAN KEY NOTES**
- A. DEMOLISH A SPACE BETWEEN EXISTING WALLS TO FIT A TYPICAL 36" DOOR U.N.O.
 - B. DEMOLISH ALL THE STALL PARTITIONS AND PLUMBING FIXTURES, INCLUDING TOILETS, URINALS, LAVATORIES / WORKSINKS IN COUNTERS, AND DRINKING FOUNTAINS.
 - C. DEMOLISH EXISTING PARTITION
 - D. STARWAY DEMOLITION, DEMO THE EXTERIOR WALL BETWEEN COLUMNS AS WELL AS THE EXISTING STAIRS.
 - E. DEMOLISH CURB AND PAVED AREA
 - F. SELECTIVE DEMOLITION OF SIDEWALK AS NECESSARY TO MEET CODE REQUIREMENTS
 - G. CUT EXISTING WALL TO RECEIVE NEW WINDOW ASSEMBLY.
 - H. REMOVE EXISTING DOOR AND FRAME. PREP EXISTING OPENING FOR INFILL.
 - I. DEMOLITION OF EXISTING FLOOR SLAB
 - J. DEMOLISH EXISTING COUNTERTOP AND ALSO REPLACE EXISTING WORK SINKS WITH NEW, BASE CABINET TO REMAIN
 - K. DEMOLISH EXISTING GLAZING AND MULLIONS. PARTITIONS TO REMAIN.
 - L. DEMOLISH A SPACE BETWEEN EXISTING WALLS TO FIT WINDOW GLAZING TO MATCH ELEVATION.
 - M. DEMOLISH EXISTING CASEWORK AND WORKSINKS IN COUNTERS.
 - N. KRONOS MACHINE TO REMAIN. PROTECT DURING CONSTRUCTION
 - O. SAVE THE DEMOLISHED CASEWORK FOR REUSE FOR EXISTING CLASSROOM TO ATTACH TO NEW PARTITIONS.
 - P. KILN TO BE REMOVED AND RETAINED FOR REUSE.
 - Q. REMOVE EXISTING DRINKING FOUNTAIN. PREP FOR NEW.
 - R. REMOVE EXISTING CEILING ASSEMBLY. REPAIR LEAK. PREPARE STRUCTURE FOR NEW SOFFIT ASSEMBLY.
 - S. ATLANTA PUBLIC SCHOOLS TO FIELD VERIFY EXISTING KITCHEN EQUIPMENT AND CONFIRM EXTENT OF EQUIPMENT TO BE DEMOLISHED.
 - T. EXISTING ROOF DRAIN TO REMAIN. PROTET DURING CONSTRUCTION
 - U. REMOVE EXISTING COUNTERTOP. PREP BASE CABINETS FOR NEW TOP AND SINK.
 - V. REMOVE EXISTING INCLINE LIFT. PATCH AND REPAIR WALL. PREP SURFACE FOR NEW LIFT UNIT
 - W. TRENCH EXISTING SLAB FOR NEW PLUMBING LINES. SEE PLUMBING. SEE DEDUCTIVE ALTERNATE #2
 - X. REMOVE AND RETAIN BAND CASEWORK FOR REUSE. COORDINATE WITH APS FOR REFINISHING OF UNITS.
 - Y. REMOVE AND RETAIN EXISTING WASHER AND DRYER FOR REUSE. CAP DRYER VENT.

- DEMOLITION PLAN LEGEND**
- EXISTING PARTITION TO BE REMOVED
 - - - EXISTING PARTITION TO REMAIN
 - - - EXISTING DOOR AND FRAME TO BE REMOVED
 - NO WORK IN THIS AREA U.N.O.
 - WORK PROPOSED
 - DEMO EXTENTS

PROJECT NUMBER: 20190109 PROJECT NAME: BARACK & MICHELLE OBAMA ACADEMY
DATE: 02/13/20
3/17/2020 6:41:24 PM