



SCOPE DOCUMENTS

The Contract Documents issued for Conceptual Design, Schematic Design, Design Development, Partial Construction Documents or Other Issuance up to Issued for Construction are intended to be at that level of development and as such, may be neither complete nor coordinated. The [Construction Manager, Contractor, Design/Builder] is responsible for complete and coordinated pricing [and execution] of the Work, and shall include items necessary for the proper execution and completion of the Work, as shown, specified, reasonably inferred or required for a complete Project. For Work of designed design, systems, assemblies, components and materials shall comply with national, state and local code requirements. The [Construction Manager, Contractor, Design/Builder] shall inform the Owner and Architect, in timely fashion, of any discovered omissions, inaccuracies or errors in the Contract Documents.

ISSUANCES

No.	Drawing Issue Description	Date
1	DESIGN DEVELOPMENT	3/18/20

RCP LEGEND

LIGHT FIXTURES		MECHANICAL FIXTURES	
	SURFACE MOUNTED FIXTURE		ACCESS PANEL
	EXIT SIGN WALL MOUNTED		RETURN AIR DIFFUSER
	2x4 EMERGENCY FIXTURE, PARABOLIC LENS		SUPPLY AIR DIFFUSER
	2x2 EMERGENCY FIXTURE, PARABOLIC LENS		LINEAR SLOT DIFFUSER
	2x4 LAY-IN FIXTURE, PARABOLIC LENS		
	2x2 LAY-IN FIXTURE, PARABOLIC LENS		
	2x4 LAY-IN FIXTURE, ACRYLIC LENS		
	2x2 LAY-IN FIXTURE, ACRYLIC LENS		
	WALL MOUNT SCONCE LIGHT FIXTURE		
	STRIP FLUORESCENT FIXTURE		
	TRACK LIGHTING		
	WALL MOUNTED FIXTURE, SCONCE		
	WALL MOUNTED FIXTURE, LINEAR		
	POLE MOUNTED LIGHT FIXTURE		
	2x4 EMERGENCY FIXTURE, ACRYLIC LENS		
	POLE MOUNTED LIGHT FIXTURE		
	EXIT SIGN CEILING MOUNTED		
	RECESSED DOWN LIGHT - DIRECTIONAL		

REFLECTED CEILING PLAN GENERAL NOTES

1. ALL CEILING HEIGHTS TO MATCH EXISTING AND CONTRACT DOCUMENTS.

REFLECTED CEILING PLAN KEY NOTES

- A. TURF SLAB 1MM POLYESTER FELT ACOUSTIC CEILING BAFFLES AT 8' AFF IN EXPOSED CEILING.
- B. REFERENCE ELEVATION FOR HEIGHTS, LOCATIONS, SPACING OF WALL SCONCE LIGHTING
- C. ADD ALTERNATE TECTUM BAFFLE CEILING AT THIS LOCATION. BOD: ARMSTRONGS, TECTUM BLADES AND BAFFLES. 23 3/4"X42" - CUSTOM COLORS.
- D. DECORATIVE RESIN PANELS: ACR-1 AND 6" CYLINDER PENDANT IN EXPOSED CEILING. RESIN PANELS MOUNTING HEIGHT VARIES. REFER TO ENGINEER DRAWINGS FOR LIGHT FIXTURE INFORMATION.
- E. PROVIDE K-13 ACOUSTICAL SPRAY AT STRUCTURE. COLOR TO BE SELECTED FROM MANUFACTURER'S FULL RANGE. SEE ALTERNATE A1.65 PAINT.
- F. ALL CEILINGS CALLED OUT TO BE EXPOSED TO BE PT-5 FINISH. PAINT ALL EXPOSED STRUCTURE, DECK, MECHANICAL SYSTEMS ETC. (EXCEPT PORTIONS OF SYSTEMS NOT INTENDED TO BE PAINTED PER MANUFACTURE RECOMMENDATION)

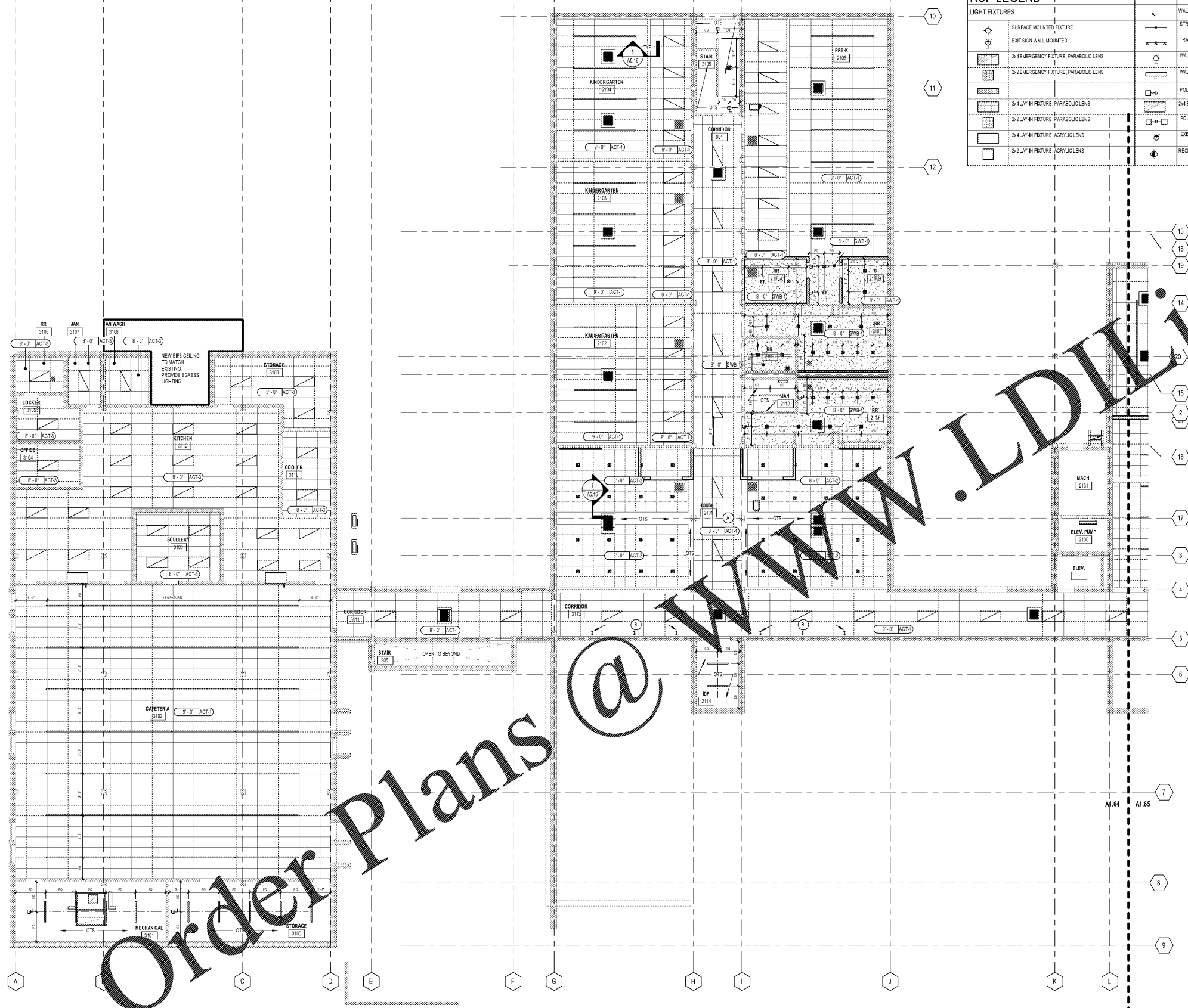

1 1ST FLOOR REFLECTED CEILING PLAN - AREA A
SCALE: 1/8" = 1'-0"



Order Plans @ www.LDOnline.com

PROJECT NUMBER: 2010100 PROJECT NAME: BARACK & MICHELLE OBAMA ACADEMY
DATE: 02/13/20
3/17/2020 6:44:39 PM

GADOE CODE: 5066
FTE - 450
EXISTING IU - 38
PROPOSED IU - 33

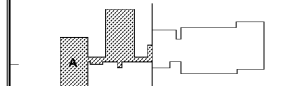

BARACK & MICHELLE OBAMA
ACADEMY



970 Martin St SE, Atlanta, GA 30315

ATLANTA PUBLIC SCHOOLS

1ST FLOOR REFLECTED
CEILING PLAN - AREA A

ROBERT A. JUST	20190109
Principal/Designer	Project No.
S. TARGHAN	03/18/20
Project Manager	Date
B. FERREN	
Project Architect	
G. HAHN / V. MOGWANJA	
Staff Architect	
B. FERREN / G. HAHN	
Interior Design	

A1.64