

DIMENSION PLAN SYMBOL LEGEND	
SYMBOL	DESCRIPTION
	DOUBLE 3/4" BACKING.
	HALF WALL.
	NEW WALL.
	FURDOWN.
	HEADER.
	DEMOLITION WALL.

ELEVATION NOTES	
-	ALL HEADER HEIGHTS ARE TO BE 7'-0" UNLESS OTHERWISE NOTED.
-	FURDOWN AT RECEPTION DESK IS AT 7'-6".
-	INSTALL BLOCKING IN TREATMENT ROOMS FOR TV'S AT TOE WALL. MOUNT AT 60" A.F.F. - TOMMY MORALES TO REVIEW AND APPROVE BLOCKING PLAN.
-	INSTALL BLOCKING AT ALL DOORS FOR WOOD FRAMES.

GENERAL NOTES:

1. PROVIDE DOUBLE METAL STUDS AT EACH SIDE OF WALL OPENINGS. STRAP STUDS AT 24" O.C. (MAX) BOTH SIDES.
2. PROVIDE DEFLECTION CHANNELS OR SLIP TRACKS AT ALL WALL HEAD CONDITIONS. (PARTITION TYPES SHOW SLIP TRACKS) CUT STUDS 3/4" SHORT OF FULL HEIGHT TO PROVIDE PERIMETER RELIEF. PROVIDE CONTINUOUS ACOUSTICAL OR FIRE RATED CAULK W/ BOND BREAKER TAPE OR BACKER ROD AS APPROPRIATE TO MEET WALLS STC AND/OR FIRE RATINGS.
3. PROVIDE CEMENTITIOUS BACKER UNITS IN LIEU OF GYP. BD. AT WALLS TO RECEIVE CERAMIC TILE.
4. PROVIDE WATER RESISTANT GYP. BD. AT ALL WET LOCATIONS.
5. PROVIDE FIRE RESISTANT TYPE SEALANT AT TOP AND BOTTOM OF RATED PARTITIONS PER FIRE-RATED DESIGNS.
6. PROVIDE UL APPROVED FIRE STOPPING MATERIALS AT ALL PENETRATIONS THROUGH ALL FIRE-RATED WALLS (BOTH NEW AND EXISTING WALLS).
7. ALL INTERIOR WOOD BLOCKING SHALL BE FIRE-RETARDANT, TREATED WOOD.
8. PROVIDE 2X6 OR 3/4" PLYWOOD BLOCKING FOR ALL COUNTERTOPS, BASE AND WALL CABINETS, SHELVING, TV BRACKETS, ETC. (SEE MILLWORK AND EQUIPMENT PLANS AND REFERENCE DRAWINGS). LEAN DENTAL DESIGN TO APPROVE ALL BLOCKING BEFORE WALLS ARE CLOSED.
9. PROVIDE BLOCKING FOR ALL CEILING AND WALL MOUNTED DENTAL EQUIPMENT, DENTAL CEILING / TRACK LIGHTS, VIDEO / TV EQUIPMENT AND X-RAY UNITS. (SEE MILLWORK AND EQUIPMENT PLANS, DENTAL EQUIPMENT SCHEDULE, AND REFERENCE DRAWINGS).
10. RECESSED FIXTURES AND ACCESSORIES LOCATED IN FIRE-RATED WALLS SHALL BE BACKED WITH FIRE-RATED CONSTRUCTION.

NOTES:

- ALL INTERIOR DIMENSIONS ARE FINISHED DIMENSIONS. ALL EXTERIOR DIMENSIONS ARE NORMAL.
- FOR FINISHES REFER TO FINISH PLAN AND SCHEDULE SPECIFIED BY OWNER. TBD.
- PATCH ALL OPENINGS THAT REMAIN IN RATED AND/OR TENANT SEPARATION PARTITIONS FROM EITHER CURRENT DEMOLITION OR PRIOR WORK.
- CONTRACTOR SHALL INSTALL 2X6 BLOCKING FOR ALL COUNTERTOP, BASE AND WALL CABINETS, SHELVING, COAT HOOKS, AND APRON HANGERS. SEE MILLWORK AND EQUIPMENT PLAN. BLOCKING PLAN TO BE PROVIDED BY LEAN DENTAL DESIGN.
- CONTRACTOR SHALL INSTALL BLOCKING FOR CEILING AND WALL MOUNTED DENTAL EQUIPMENT, DENTAL CEILING / TRACK LIGHTS, VIDEO / TV EQUIPMENT AND X-RAY UNITS. SEE MILLWORK AND EQUIPMENT AND DENTAL EQUIPMENT SCHEDULE.
- ** OPERATORY - THIS ROOM LABEL IS STANDARD CLINICAL TERMINOLOGY TO DESCRIBE A TYPICAL DENTAL TREATMENT ROOM.

PLAN NOTES:

1. EXISTING DOOR TO BE REMOVED.
2. EXISTING WINDOW TO REMAIN.
3. EXISTING PLUMBING FIXTURES TO BE REMOVED.
4. EXISTING WALL TO BE DEMOLISHED.
5. EXISTING COUNTER TOP AND MILLWORK TO BE REMOVED.
6. EXISTING DOOR TO REMAIN.

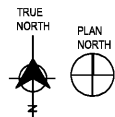
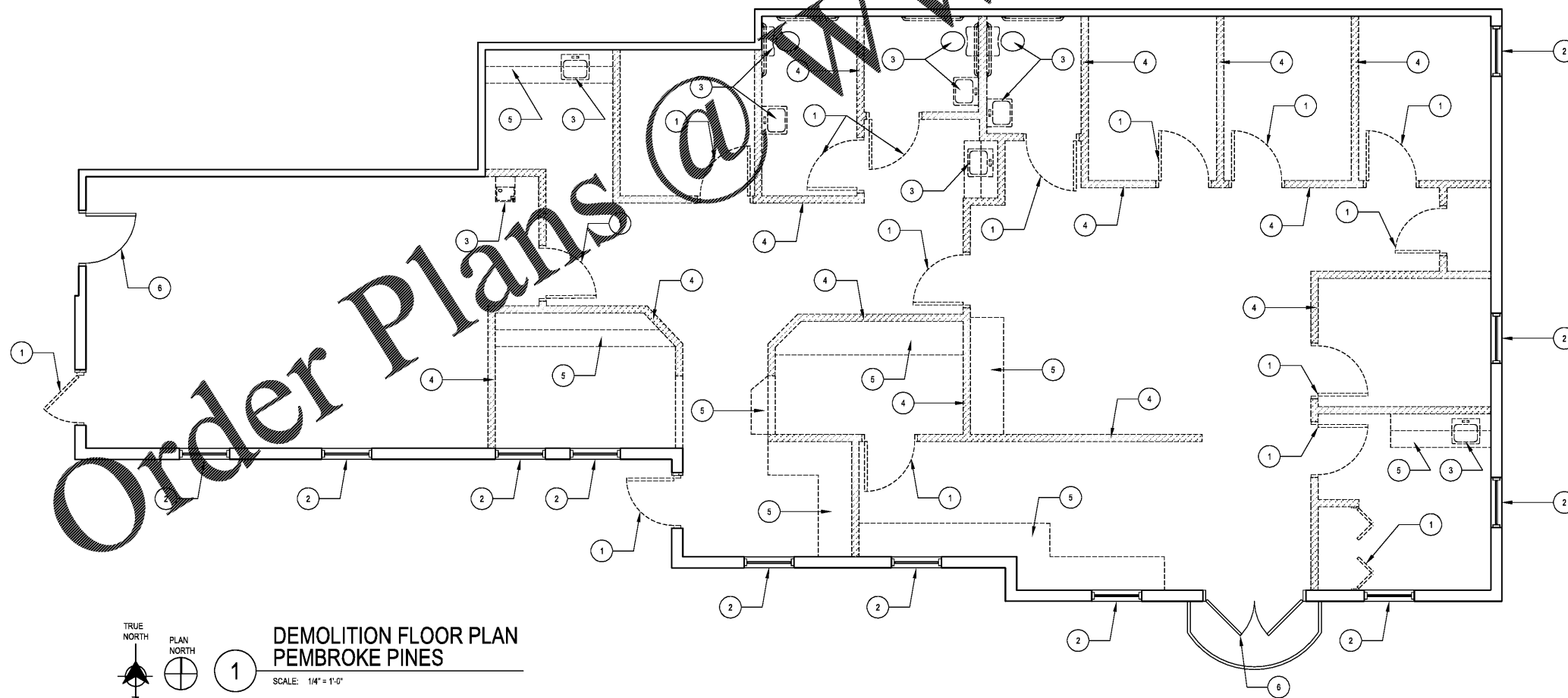

**DEMOLITION FLOOR PLAN
PEMBROKE PINES**

1

SCALE: 1/4" = 1'-0"

LEAN
dental design

8000 IH-10, FRONTAGE RD., STE 300
SAN ANTONIO, TX 78230
210-899-4500

**DENTAL OFFICES OF
DR. FREITAS & DR. SOUZA
DEMOLITION PACKAGE**

1790 I NW 5TH STREET, SUITE 202, PEMBROKE PINES, FL 33029

ISSUE

NO.	DATE	DESCRIPTION
1	2/25/2020	FOR BID & CONSTRUCTION

Project No. _____ Date: _____

Sheet Title:
DEMO FLOOR PLAN

Page No.
A200

SHEET
5 OF 5