

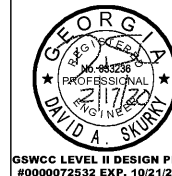

HOLT
CONSULTING COMPANY, L.L.C.
6340 Sugarloaf Parkway, Suite 380
Duluth, GA 30097
678.775.6819-www.holtconsultingco.com

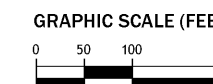

DRAINAGE AREAS TAKEN FROM BARGE DESIGN SOLUTIONS PLANS DATED JULY 2019. AULICK ENGINEERING DID NOT PERFORM STORMWATER MANAGEMENT DESIGN.

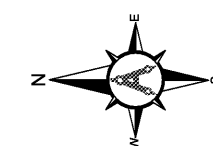

REVISIONS			
No.	Description	Date	By

Project Name:
APRON EXPANSION PROJECT

Sheet Name:
ES&PCP POST-DRAINAGE AREA MAP

GDOT Project Number: APXXX-XXXX-XX(XXX) Holt Project Number: GAxxxx-xx

Designer: W. MCNAMARA Technician: B. GARROW Checked by: D. SKURKY

CAD File: CX06 Drainage Area Maps.dwg Submittal / Issue Date: FEBRUARY, 2020

Plotted: Feb 11, 2020 - 8:20am by George Sumner Drawing Number:

Scale: **1" = 100'**

CE 4.02

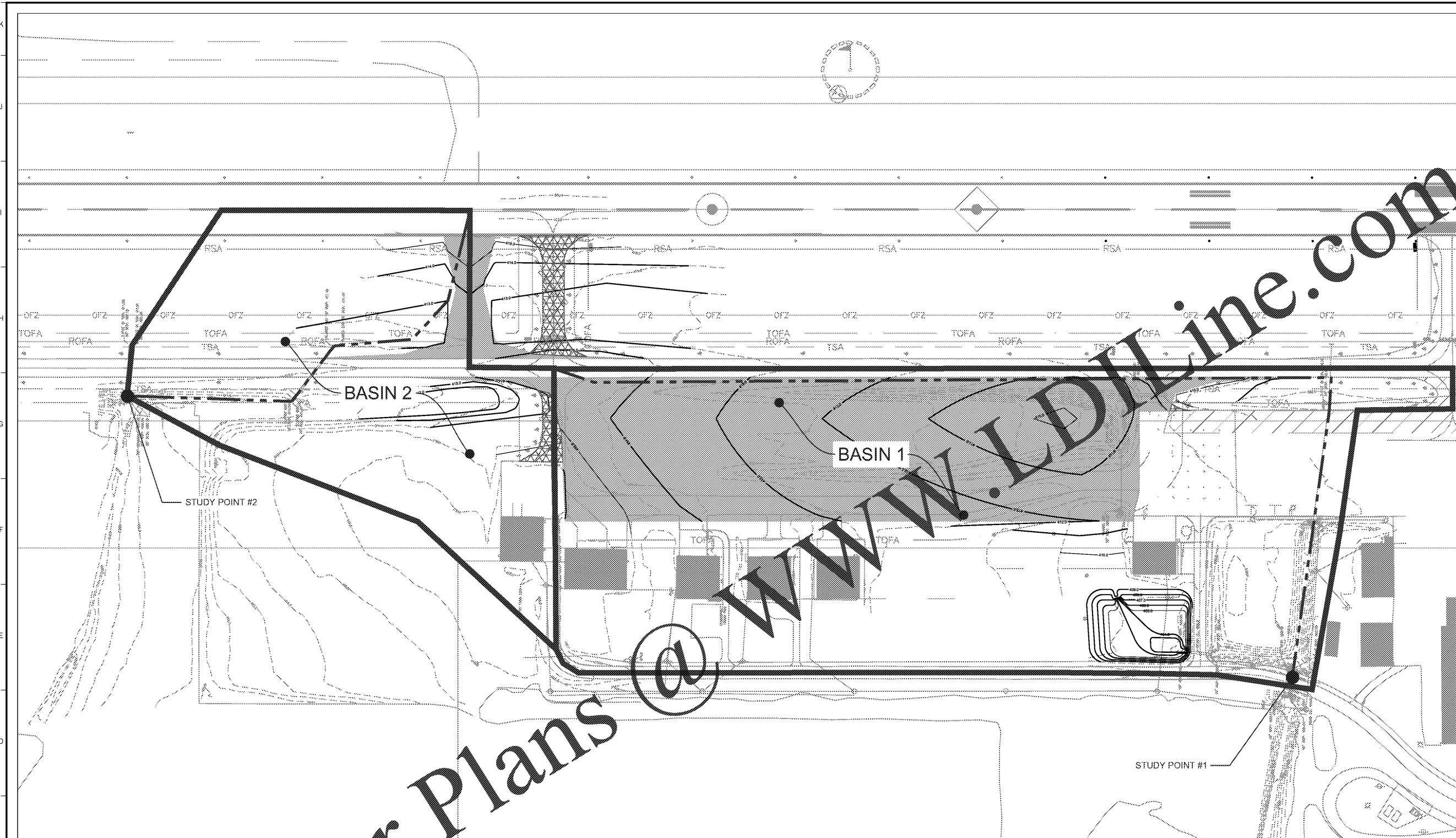

LEGEND

- POST-DRAINAGE BASIN
- NEW IMPERVIOUS AREA
- DEMOLISHED IMPERVIOUS AREA
- TIME OF CONCENTRATION

POST-PROJECT

PXE Apron Expansion	Total Area (AC)	Imperv. 0.95 98	Open Space (Good) 0.50 61	CN 82	Tc (min) 15.0
Basin 1	20.00	11.59	8.41	82	15.0
Basin 2	8.60	1.87	6.73	69	5.0
TOTAL	28.60	13.46	15.14		
Difference (Post-Pre)	-1.10	5.70	-6.81		

ES&PCP PREPARER:
AULICK ENGINEERING
1900 CENTURY PLACE
N.E. SUITE 305
CHAMBLEE, GA
(678)825-8196



Know what's below.
Call before you dig.

24 HOUR CONTACT:
JAMES MARQUART
PHONE: (478)-988-3699

NOTE:
POST CONSTRUCTION STORMWATER BEST MANAGEMENT PRACTICES NOT PROVIDED FOR THIS PROJECT.

Order Plans @ WWW.LDLINE.COM