



HUB/ADA-INT./SSSI/ACO
STORE NUMBER: 02544

101 LEXINGTON CIRCLE
PEACHTREE CITY, GA
CAP CODE: 90,113,88,114

CS PROJECT NUMBER: 138501

ARCHITECT OF RECORD:



I HEREBY CERTIFY THAT THESE PLANS HAVE BEEN PREPARED IN MY OFFICE AND UNDER MY SUPERVISION AND THAT TO THE BEST OF MY KNOWLEDGE, THE SAME COMPLY WITH ALL LAWS, RULES, REGULATIONS AND ORDINANCES OF PEACHTREE CITY, GA, RELATING TO STRUCTURES AND BUILDINGS.

CONSULTANT ENGINEER:

CONSULTANT:

SEAL:

REVISIONS:

DRAWING BY: GM, JP

CHECKED BY: KW

CVS PROJECT MANAGER: CG

DATE: 03/02/2020

JOB NUMBER: 19-2662

TITLE:

HEALTHHUB
ENLARGED PLANS

SHEET NUMBER:

HUB1

COMMENTS:

NOTES

1. VERIFY ALL WORK AND MEASUREMENTS IN FIELD BETWEEN CVS PROJECT MANAGER AND GENERAL CONTRACTOR PRIOR TO ANY WORK BEING DONE.
2. CLEAN ALL FINISHED SURFACES (GLASS, FRAMING, LAMINATE, CARPET, ETC.) AT PROJECT COMPLETION THROUGHOUT ENTIRE STORE.

LEGEND

- EXISTING PARTITION TO REMAIN
- NEW PARTITION
- KEY NOTE DESIGNATION
- WALL TYPE IDENTIFIER RE: PARTITION TYPES
- DOOR TYPE IDENTIFIER - REFERENCE DOOR SCHEDULE
- COLUMN GRID

KEYNOTES

TAG	DESCRIPTION
1	CONSTRUCT NEW WALLS AS SHOWN/SCHEDULED.
2	INSTALL NEW DOOR, FRAME AND CLOSER AS SHOWN/SCHEDULED.
3	INSTALL NEW DOOR USING EXISTING FRAME AND CLOSER AS SHOWN/SCHEDULED.
4	TREAT/POUR NEW CONCRETE AS REQUIRED FOR NEW EXAM ROOM PLUMBING.
5	INSTALL SPECIFICATED CONSULTATION ROOM PER COLONY INSTALLATION GUIDE.
6	INSTALL FURRING TO EXISTING WALL AS NEEDED TO FIT CONSULTATION ROOM AND RECONFIGURE PHARMACY FRONTLINE.

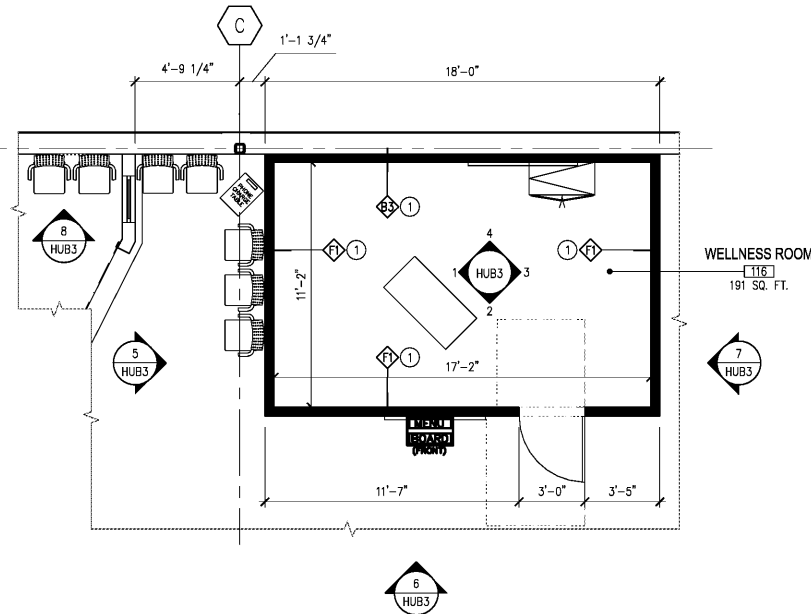
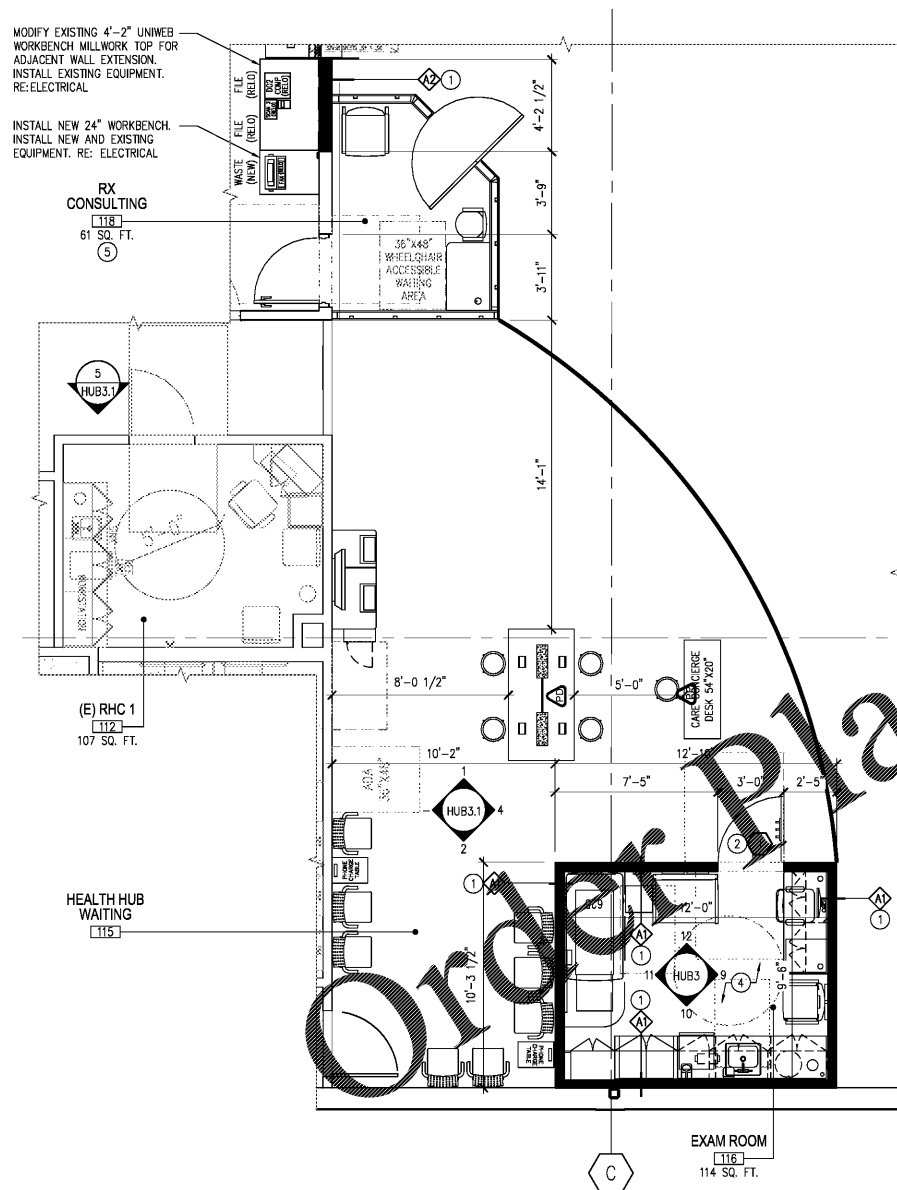

1 ENLARGED FLOOR PLAN
HUB1 1/4" = 1'-0"

2 ENLARGED FLOOR PLAN
HUB1 1/4" = 1'-0"

www.LDILine.com