

- NO SURFACE MOUNTED CONDUIT OR PIPING ALLOWED IN MEAT AND PRODUCE PREP ROOMS.
- REFER TO SHEET E0.1 FOR LEGENDS, NOTES, AND SCHEDULES.
- AT MECHANICAL CHASES AND STORES WITHOUT CEILING IN SALES AREA, GROUP VERTICAL PIPING, REFRIGERATION, ELECTRICAL CONDUIT AND MECHANICAL DROPS NEATLY TOGETHER AS POSSIBLE AND PAINT TO MATCH STRUCTURAL COLUMNS.
- NO ELECTRICAL EQUIPMENT SHALL BE LOCATED UNDERNEATH THE SKYLIGHTS INCLUDING BUT NOT LIMITED TO CONDUIT, LIGHTS, CABLES FOR SIGNAGE, ETC.
- RUN CONDUITS ON TOP OF INSULATED ROOF PANEL. STUB INTO PANEL INTO FIXTURES FOR PREP ROOM LIGHTING.
- THE ONLY SURFACE-MOUNTED CONDUIT PERMITTED IN THE DELI AND BAKERY PREP ROOMS SHALL BE ON THEIR COOLER AND FREEZER WALL AND CEILINGS.
- REFER TO E5 SERIES SHEETS FOR ELECTRICAL STANDARD DETAILS (E5S).
- ALL CONDUITS IN SALES AREA FROM ROOF TO LOW WALLS OR EQUIPMENT SHALL BE COORDINATED AND GROUPED TOGETHER WITH OTHER MECHANICAL CONDUITS.

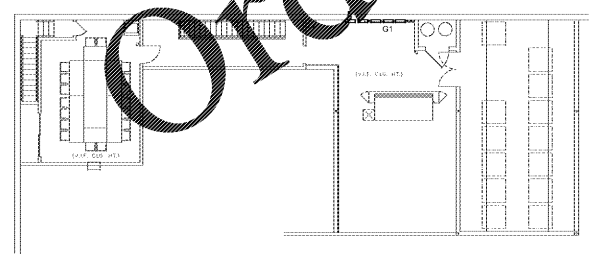

2 ELECTRICAL POWER PLAN - REAR MEZZANINE
3/32" = 1'-0"

3 ELECTRICAL POWER PLAN - FRONT MEZZANINE
3/32" = 1'-0"

1 ELECTRICAL POWER PLAN
3/32" = 1'-0"

POWER KEYNOTE LEGEND

Key Value	Keynote Text
P1	EXISTING EQUIPMENT TO BE RELOCATED. REROUTE ALL ELECTRICAL CIRCUITS TO NEW LOCATION AS REQUIRED. REUSE EXISTING CONDUIT, JUNCTION BOXES, CORD DROPS, ETC. WHERE POSSIBLE. PROVIDE ALL DEVICES AS REQUIRED. MAKE ALL FINAL CONNECTIONS.
P2	EXISTING REFRIGERATED CASE(S) TO BE RELOCATED. REROUTE ALL EXISTING POWER CIRCUITS (FANS, LIGHTS, ANTI-SWEATS) FROM PANELS TO NEW LOCATION. REROUTE ALL EXISTING CIRCUITS AS REQUIRED FROM REFRIGERATION SOURCE TO NEW LOCATION. REFER TO DEPENDENT WIRING DETAIL IN REFRIGERATION PLANS FOR ADDITIONAL INFORMATION. COORDINATE WITH REFRIGERATION INSTALLER PRIOR TO INSTALLATION. PROVIDE NEW WIRING AS REQUIRED. REFER TO REFRIGERATED EQUIPMENT LAYOUT PLAN (SHEET R1) FOR GROUPING OF CASES. REUSE EXISTING CONDUIT, JUNCTION BOXES, CORD DROPS, ETC. WHERE POSSIBLE. PROVIDE ALL DEVICES AS REQUIRED. MAKE ALL FINAL CONNECTIONS.
P3	CONNECT NEW/RELOCATED REFRIGERATED CASE(S) TO EXISTING POWER CIRCUITS (FANS, LIGHTS, ANTI-SWEATS) PREVIOUSLY SERVING DEMOLISHED CASE(S). NEW/RELOCATED REFRIGERATED CASE(S) TO BE CONNECTED TO ALL EXISTING REFRIGERATION CIRCUITS (CONTROL, TEMPERATURE SENSOR, DEFROST TERMINATION SENSOR, ETC.) AS REQUIRED. CONTRACTOR TO VERIFY EXISTING REFRIGERATION CIRCUITRY IS ROUTED TO THE APPROPRIATE REFRIGERATION RACK (SEE SHEET R1) AND REROUTE IF NECESSARY. REFER TO REFRIGERATION PLANS FOR ADDITIONAL INFORMATION. COORDINATE WITH REFRIGERATION INSTALLER PRIOR TO INSTALLATION. PROVIDE NEW WIRING AS REQUIRED. REROUTE CONDUIT AND CONDUCTORS TO NEW LOCATION AS REQUIRED. REFER TO REFRIGERATED EQUIPMENT LAYOUT PLAN (SHEET R1) FOR GROUPING OF CASES. REUSE EXISTING CONDUIT, JUNCTION BOXES, CORD DROPS, ETC. WHERE POSSIBLE. PROVIDE ALL DEVICES AS REQUIRED. MAKE ALL FINAL CONNECTIONS.
P4	EXISTING SELF-SCAN CHECKOUTS TO BE RELOCATED. REROUTE ALL ASSOCIATED ELECTRICAL CIRCUITS (POWER, DATA/TELEPHONE, CORD DROPS, ETC.) TO NEW LOCATION. REUSE EXISTING CONDUIT, JUNCTION BOXES, ETC. WHERE POSSIBLE. MAKE ALL FINAL CONNECTIONS.
P5	125 VOLT OUTLET BOX AT BAR JOIST FOR CONNECTION TO TELE-POWER POLE. TELE-POWER POLES FOR CHECK LANES SHALL BE FURNISHED BY KROGER AND INSTALLED BY GENERAL CONTRACTORS ELECTRICAL SUBCONTRACTOR. TERMINATE AND LABEL CONDUCTORS IN OUTLETS AT BAR JOIST. SEE E30-10, E30-20A AND E30-20B FOR MORE INFORMATION. CONTRACTOR TO PROVIDE ANY OTHER TELE-POWER POLE INDICATED ON THE DRAWINGS. SEE KROGER SPECIFICATION SECTION 26 85 53 FOR ADDITIONAL INFORMATION.
P15	CONNECT NEW EXHAUST FAN TO EXISTING CIRCUIT PREVIOUSLY SERVING DEMOLISHED EXHAUST FAN. CONTRACTOR TO CONFIRM EXISTING CIRCUIT IS ADEQUATE FOR NEW FAN AND PROVIDE NEW IF REQUIRED. CONTRACTOR TO CONFIRM NEW EXHAUST FAN IS WIRED TO REST ROOM LIGHTING SWITCH. SEE E30-20 FOR MORE INFORMATION. CONTRACTOR TO PROVIDE ALL ELECTRICAL DEVICES REQUIRED FOR AN OPERATIONAL SYSTEM. MAKE FINAL CONNECTIONS.
P21	EXISTING REFRIGERATED CASE TO BE CONVERTED FROM LOW TEMPERATURE TO HIGH TEMPERATURE. PROVIDE ALL ELECTRICAL DEVICES AS REQUIRED FOR CONVERSION. COORDINATE REQUIREMENTS WITH REFRIGERATION INSTALLER.
P22	PROVIDE 20A, 208V/1PH CIRCUIT FROM REFRIGERATION SYSTEM L1 FOR FREEZER COLL 2#10 + #10G - 3/4" FIELD VERIFY EXACT REQUIREMENTS WITH REFRIGERATION INSTALLER. PROVIDE ALL ELECTRICAL DEVICES AS REQUIRED.
P23	PROVIDE 60A, 208V/3PH CIRCUIT FROM REFRIGERATION SYSTEM L1 FOR FREEZER DEFROST 3#8 + #10G - 1/2" FIELD VERIFY EXACT REQUIREMENTS WITH REFRIGERATION INSTALLER. PROVIDE ALL ELECTRICAL DEVICES AS REQUIRED.
P25	EXISTING FIRE ALARM NOTIFICATION DEVICE TO REMAIN. DISCONNECT / RECONNECT AS REQUIRED FOR REMODELING. COORDINATE WITH ALL OTHER TRADES.
P26	CONDUIT STUB UPS FOR UNDER-FLOOR HEATING CABLES WITH BUSING FOR FLOOR LOCATIONS. STUB CONDUIT UP 4" ABOVE FREEZER FLOOR LEVEL. SEE E50-1 ON E5 SERIES DRAWINGS. COORDINATE EXACT LOCATION OF CONDUIT'S STUB UPS WITH EQUIPMENT MANUFACTURER PRIOR TO ROUGH-IN.

POWER KEYNOTE LEGEND

Key Value	Keynote Text
P27	PROVIDE CIRCUITS FOR FREEZER UNDER FLOOR HEATING CABLES AS REQUIRED. SEE E50-1 ON E5-SERIES DRAWINGS.
P28	CONNECT NEW EQUIPMENT TO EXISTING CIRCUIT / RECEPTACLE. FIELD VERIFY EXACT LOCATION. EXTEND CIRCUIT / RELOCATE RECEPTACLE AS REQUIRED.
P29	CONNECT NEW BAKERY OVEN TO EXISTING POWER CIRCUITS PREVIOUSLY SERVING DEMOLISHED BAKERY OVEN. CONNECT ALL EQUIPMENT PANEL, CONTROL, ETC. PROVIDE NEW WIRING AS REQUIRED. REROUTE CONDUIT AND CONDUCTORS TO NEW LOCATION AS REQUIRED. REUSE EXISTING CONDUIT, JUNCTION BOXES, CORD DROPS, ETC. WHERE POSSIBLE. PROVIDE ALL DEVICES AS REQUIRED. MAKE ALL FINAL CONNECTIONS.
P30	CONNECT NEW BAKERY RETARDER TO EXISTING CIRCUIT PREVIOUSLY SERVING DEMOLISHED BAKERY RETARDER. FIELD VERIFY EXISTING CIRCUIT MEETS NEW EQUIPMENT REQUIREMENTS. PROVIDE NEW CIRCUIT IF REQUIRED. MAKE ALL FINAL CONNECTIONS.
P31	EXISTING PHARMACY COMPUTER EQUIPMENT TO BE POLE MOUNTED. REROUTE ALL ELECTRICAL CIRCUITS (POWER AND LOW VOLTAGE) TO NEW LOCATION AS REQUIRED. COORDINATE EXACT REQUIREMENTS WITH KROGER PROJECT MANAGER. REUSE EXISTING CONDUIT, JUNCTION BOXES, CORD DROPS, ETC. WHERE POSSIBLE. PROVIDE ALL DEVICES AS REQUIRED. MAKE ALL FINAL CONNECTIONS.
P32	CONNECT RELOCATED REGISTER TO EXISTING CIRCUITS (CLEAN POWER, DIRTY POWER, AND DATA) PREVIOUSLY SERVING DEMOLISHED REGISTER. SEE E30-20 FOR MORE INFORMATION. MAKE ALL FINAL CONNECTIONS.
P33	NEW SELF-SCAN CHECKOUTS TO BE CONNECTED TO CIRCUITS MADE AVAILABLE BY DEMOLITION OF CHECK LANES. SEE ELECTRICAL EQUIPMENT REQUIREMENTS FOR MORE INFORMATION. PROVIDE DEDICATED, ISOLATED CIRCUIT FROM PANEL Y (2) SELF-SCANS PER CIRCUIT. PROVIDE ADDITIONAL CIRCUIT FROM PANEL Y. REUSE EXISTING CONDUIT, JUNCTION BOXES, ETC. WHERE POSSIBLE. SEE E30-20A FOR MORE INFORMATION. MAKE ALL FINAL CONNECTIONS.
P34	CONNECT SELF-CHECKOUT AT TENANT'S STATION TO CIRCUIT MADE AVAILABLE IN PANEL Y. MAKE ALL FINAL CONNECTIONS.
P35	SWITCH FOR FLORAL WORKSTATION LIGHTS. COORDINATE EXACT LOCATION WITH KROGER PROJECT MANAGER.
P36	POWER AND DATA TO BE ROUTED VIA POWER POLE AT EXISTING COLUMN. COORDINATE EXACT LOCATION WITH KROGER PROJECT MANAGER. SEE SPECIFICATION SECTION 26805 FOR POWER POLE REQUIREMENTS.
P37	EXISTING FREEZER DOOR TO BE REPLACED. DISCONNECT / RECONNECT ELECTRICAL AS REQUIRED.
P38	FURNISH AND INSTALL RECEPTACLES WITH IN-USE WEATHERPROOF COVER AND PROVIDE A GFCI BREAKER AS REQUIRED FOR CONNECTION OF HEAT TRACING. SEE E1-RED-28 AND SECTION 26053 OF SPECIFICATIONS.
P39	PROVIDE 20A, 208V/1PH CIRCUIT, ROUTED TO SYSTEM L1, IN COMPRESSOR EQUIPMENT ROOM FOR FREEZER COOLING COLL 2#10 + #10G - 3/4" FIELD VERIFY EXACT LOCATION. COORDINATE EXACT REQUIREMENTS WITH REFRIGERATION INSTALLER. PROVIDE ALL ELECTRICAL DEVICES AS REQUIRED.
P40	PROVIDE 60A, 208V/3PH CIRCUIT, ROUTED TO SYSTEM L1, IN COMPRESSOR EQUIPMENT ROOM FOR FREEZER DEFROST 3#8 + #10G - 3/4" FIELD VERIFY EXACT LOCATION. COORDINATE EXACT REQUIREMENTS WITH REFRIGERATION INSTALLER. PROVIDE ALL ELECTRICAL DEVICES AS REQUIRED.
P41	CONNECT NEW EXHAUST FAN TO EXISTING CIRCUIT PREVIOUSLY SERVING DEMOLISHED EXHAUST FAN. CONTRACTOR TO CONFIRM EXISTING CIRCUIT IS ADEQUATE FOR NEW FAN AND PROVIDE NEW IF REQUIRED. PROVIDE NEW PLOT LIGHT SWITCH AS INDICATED. FIELD COORDINATE SWITCH LOCATION WITH KROGER PROJECT MANAGER. CONTRACTOR TO PROVIDE ALL ELECTRICAL DEVICES REQUIRED FOR AN OPERATIONAL SYSTEM. MAKE FINAL CONNECTIONS.
P42	CIRCUIT FOR INSTANTANEOUS WATER HEATER. SEE DETAIL 10E1.1 MAKE ALL FINAL CONNECTIONS.

ROBERTSON LOJA ROOF ARCHITECTS & ENGINEERS
3460 Princeton Ridge Road - Suite 275 - Alpharetta, GA, 30005
770.974.2607 / www.rljae.com

Kroger GA-291
FOR THE Kroger Company
11715 Park Lake Drive, Atlanta, GA

ELECTRICAL POWER PLAN
03-06-20
20-108
E1.3