

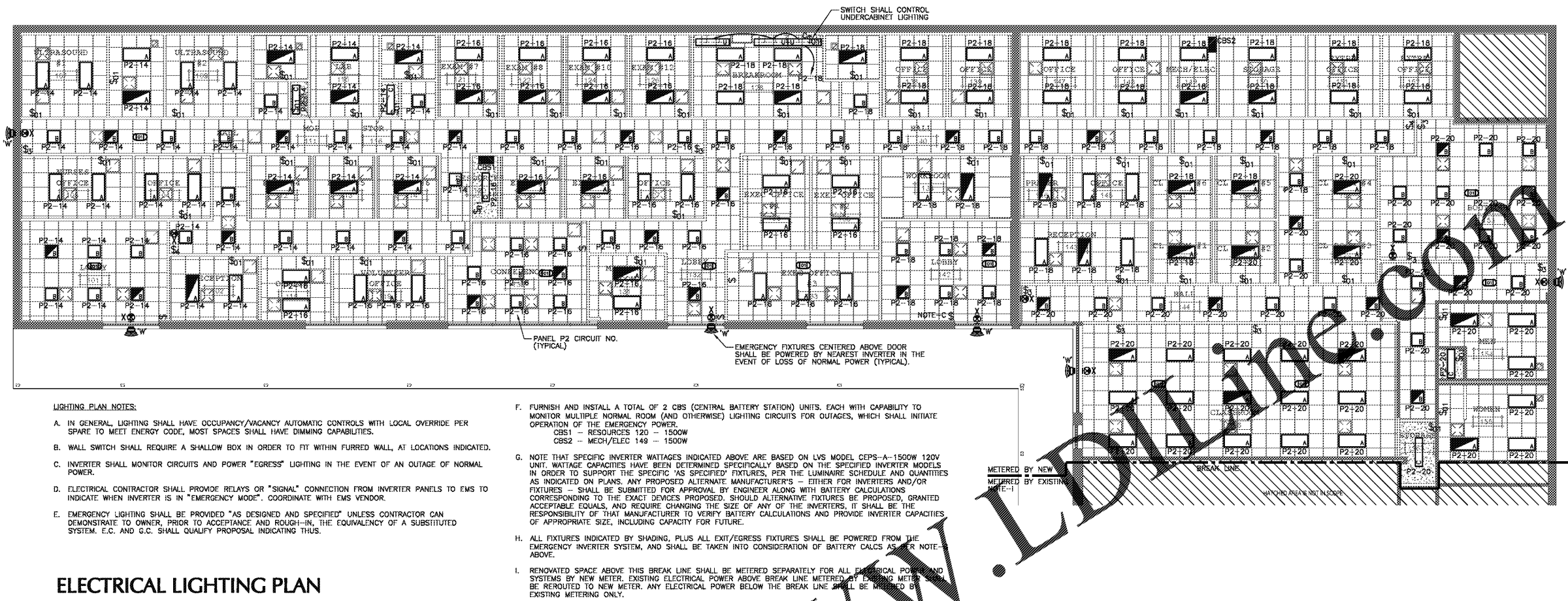

bloom
architecture

400 E. Main Street, #215 Chattanooga, TN 37408
design@bloomco.com | 423-503-4951



- LIGHTING PLAN NOTES:**
- IN GENERAL, LIGHTING SHALL HAVE OCCUPANCY/VACANCY AUTOMATIC CONTROLS WITH LOCAL OVERRIDE PER SPARE TO MEET ENERGY CODE, MOST SPACES SHALL HAVE DIMMING CAPABILITIES.
 - WALL SWITCH SHALL REQUIRE A SHALLOW BOX IN ORDER TO FIT WITHIN FURRED WALL, AT LOCATIONS INDICATED.
 - INVERTER SHALL MONITOR CIRCUITS AND POWER "EGRESS" LIGHTING IN THE EVENT OF AN OUTAGE OF NORMAL POWER.
 - ELECTRICAL CONTRACTOR SHALL PROVIDE RELAYS OR "SIGNAL" CONNECTION FROM INVERTER PANELS TO EMS TO INDICATE WHEN INVERTER IS IN "EMERGENCY MODE". COORDINATE WITH EMS VENDOR.
 - EMERGENCY LIGHTING SHALL BE PROVIDED "AS DESIGNED AND SPECIFIED" UNLESS CONTRACTOR CAN DEMONSTRATE TO OWNER, PRIOR TO ACCEPTANCE AND ROUGH-IN, THE EQUIVALENCY OF A SUBSTITUTED SYSTEM. E.C. AND G.C. SHALL QUALIFY PROPOSAL INDICATING THIS.

- FURNISH AND INSTALL A TOTAL OF 2 CBS (CENTRAL BATTERY STATION) UNITS, EACH WITH CAPABILITY TO MONITOR MULTIPLE NORMAL ROOM (AND OTHERWISE) LIGHTING CIRCUITS FOR OUTAGES, WHICH SHALL INITIATE OPERATION OF THE EMERGENCY POWER.
CBS1 - RESOURCES 120 - 1500W
CBS2 - MECH/ELEC 149 - 1500W
- NOTE THAT SPECIFIC INVERTER WATTAGES INDICATED ABOVE ARE BASED ON LVS MODEL CEPS-A-1500W 120V UNIT. WATTAGE CAPACITIES HAVE BEEN DETERMINED SPECIFICALLY BASED ON THE SPECIFIED INVERTER MODELS IN ORDER TO SUPPORT THE SPECIFIC "AS SPECIFIED" FIXTURES, PER THE LUMINAIRE SCHEDULE AND QUANTITIES AS INDICATED ON PLANS. ANY PROPOSED ALTERNATE MANUFACTURER'S - EITHER FOR INVERTERS AND/OR FIXTURES - SHALL BE SUBMITTED FOR APPROVAL BY ENGINEER ALONG WITH BATTERY CALCULATIONS CORRESPONDING TO THE EXACT DEVICES PROPOSED. SHOULD ALTERNATE FIXTURES BE PROPOSED, GRANTED ACCEPTABLE EQUALS, AND REQUIRE CHANGING THE SIZE OF ANY OF THE INVERTERS, IT SHALL BE THE RESPONSIBILITY OF THAT MANUFACTURER TO VERIFY BATTERY CALCULATIONS AND PROVIDE INVERTER CAPACITIES OF APPROPRIATE SIZE, INCLUDING CAPACITY FOR FUTURE.
- ALL FIXTURES INDICATED BY SHADING, PLUS ALL EXIT/EGRESS FIXTURES SHALL BE POWERED FROM THE EMERGENCY INVERTER SYSTEM, AND SHALL BE TAKEN INTO CONSIDERATION OF BATTERY CALCS AS NOTED ABOVE.
- RENOVATED SPACE ABOVE THIS BREAK LINE SHALL BE METERED SEPARATELY FOR ALL ELECTRICAL POWER AND SYSTEMS BY NEW METER. EXISTING ELECTRICAL POWER ABOVE BREAK LINE METERED BY EXISTING METER. ANY ELECTRICAL POWER BELOW THE BREAK LINE SHALL BE METERED BY EXISTING METERING ONLY.

ELECTRICAL LIGHTING PLAN

SCALE: 1/8" = 1'-0"

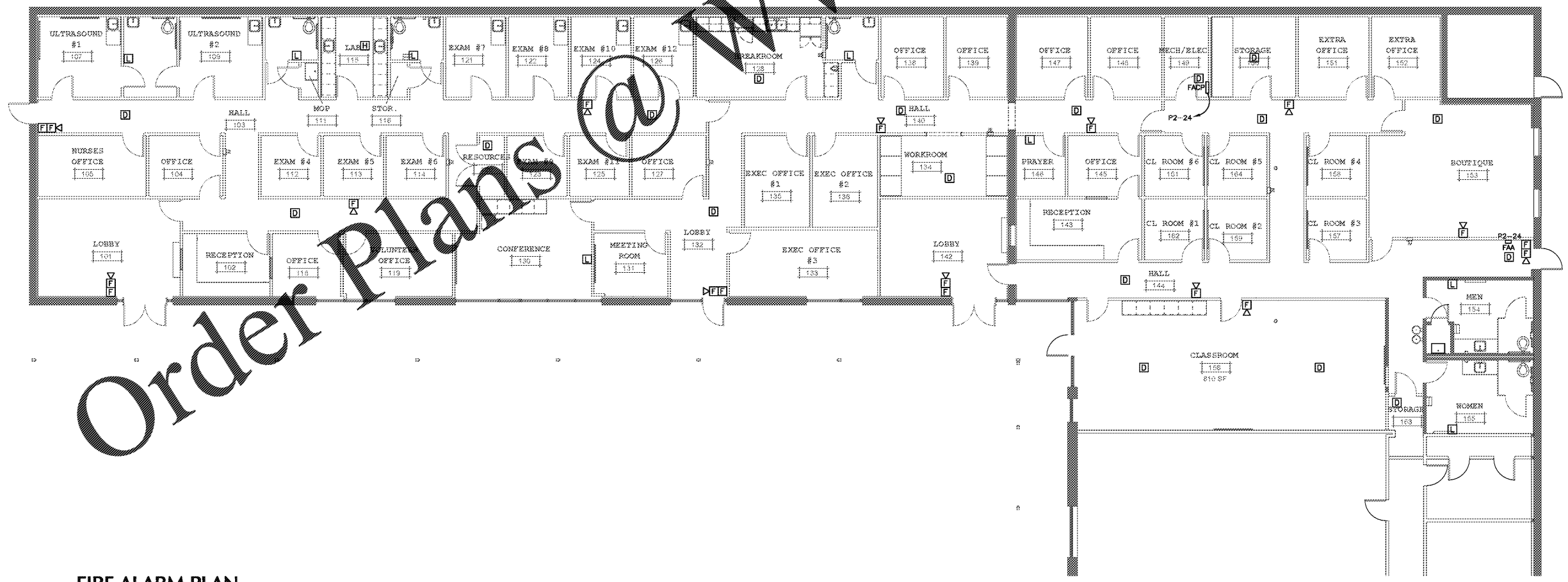

FIRE ALARM PLAN

SCALE: 1/8" = 1'-0"

Order Plans @ WWW.LADLINE.COM

5700 BUILDING: INTERIOR RENOVATION
951 EASTGATE LOOP CHATTANOOGA, TN 37411

No.	Description	Date

PERMIT DOCUMENTS

Project # 19161
20 MAR 2020
ELECTRICAL LIGHTING / FIRE ALARM PLAN

E102