

LIGHTING LEGEND		
MARK	DESCRIPTION	COMMENTS
A	2X4' LED PANEL LIGHT, 3000K	-
B	2X2' LED PANEL LIGHT, 3000K	-
C	LED UTILITY LIGHT	-

CEILING LEGEND	
TYPE	DESCRIPTION
ACT-1	2x2' ACOUSTICAL CEILING SYSTEM
ACT-2	2x2' ACOUSTICAL CEILING SYSTEM - PROVIDE ACOUSTICAL INSULATION ABOVE TILES
GYP-1	5/8" MR. GYPSUM BOARD ATTACHED TO FRAMING

GENERAL CEILING PLAN NOTES

1. ALL FIXTURES MUST CONFORM TO APPLICABLE CODES AND STANDARDS.
2. MOISTURE RESISTANT GYPBD TO BE USED AT CEILING IN BATHROOMS AND SHOWERS.
3. SWITCHES TO BE GANGED IN ONE FACEPLATE WHERE APPLICABLE.

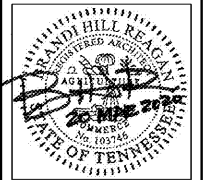

bloom
architecture
400 E. Main Street, #215 | Chattanooga, TN 37409
design@bloomco.com | 423-505-1951

**5700 BUILDING: INTERIOR
RENOVATION**
951 EASTGATE LOOP CHATTANOOGA, TN 37411

No.	Description	Date

Project #: 19161
20 MAR 2020
CEILING PLAN - WEST SIDE

A141

PERMIT SET

Copyright Notice: All drawings and design proposals are the property of Bloom Architecture LLC and cannot be reproduced, used, or sold for any reason without the express written consent of Bloom Architecture.

3/23/2020 9:21:08 AM

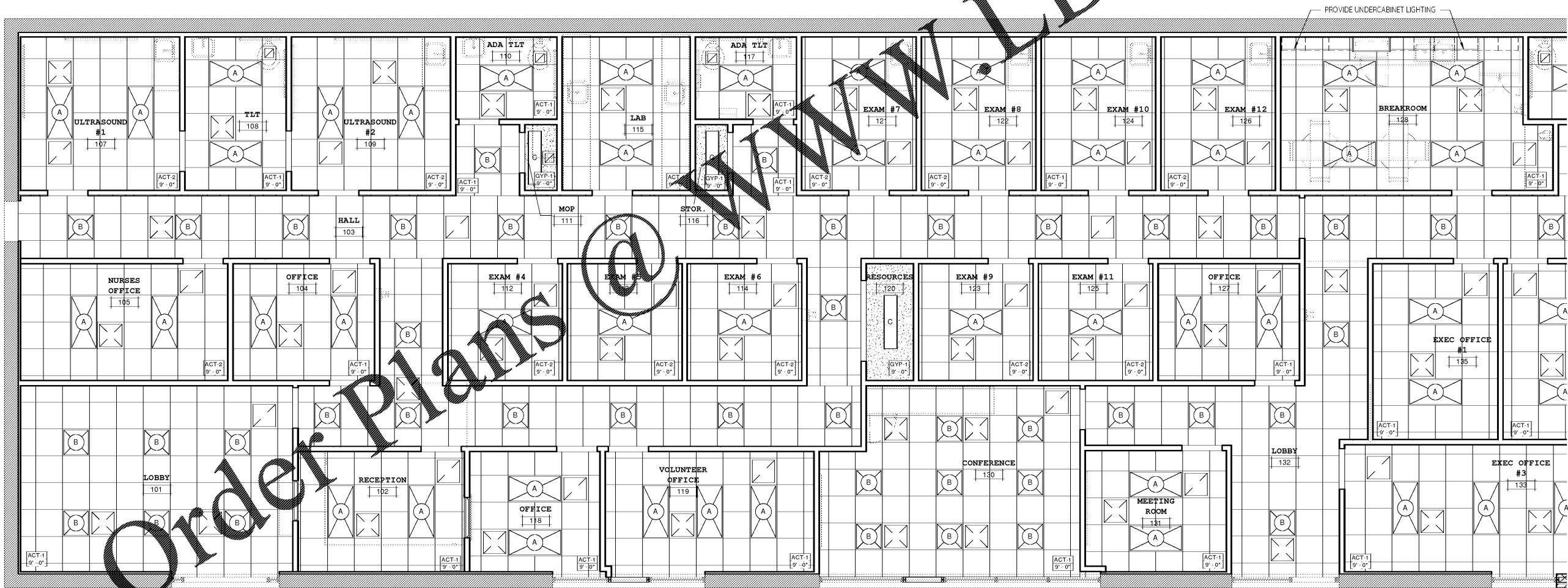

1 - ENL CEILING - WEST
1/4" = 1'-0"

C:\Users\lbranco\Dropbox\3-Bloom\1-projects\1916 5700 Choices\01_BM\15100choices_CAVT

Order Plans @ WWW.DILine.com