

2 SECTION - TYP STEEL LINTEL  
3/4" = 1'-0"

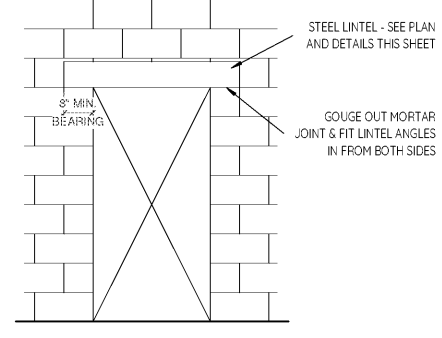

3 ELEVATION - TYP STEEL LINTEL  
1/2" = 1'-0"

**GENERAL PLAN NOTES**  
1. COORDINATE W/CLIENT AND SECURITY SYSTEM PROVIDER FOR LOW VOLTAGE CONDUIT/LOCATIONS AND ELECTRONIC LOCKS.

- FLOOR PLAN NOTATIONS**
- 01 ULTRASOUND (GE VERSANA PREMIER VA, SN: 6041209WX0, P/N: 5791403)
  - 02 REPLACE FORMER STOREFRONT DOOR WITH STOREFRONT WINDOW TO MATCH ADJACENT
  - 03 WALL MOUNTED TV - PROVIDE BLOCKING AND POWER
  - 04 NEW 48"W X 84"H CASED OPENING IN EXISTING CMU WALL - SEE A112 FOR LINTEL DETAIL
  - 05 NEW 36"W X 60"H OPENING FOR WINDOW IN EXISTING CMU WALL - SEE A112 FOR LINTEL DETAIL
  - 06 NEW 36"W X 84"H OPENING IN EXISTING CMU WALL - SEE A112 FOR LINTEL DETAIL
  - 07 SPECIMEN PASS-THRU

**WALL SCHEDULE**

MARK	FIRE RATING	WALL DESCRIPTION	NOTES
S02ER	0 HR	NON-RATED, 5/8" GYPBD / 1-5/8" MTL FURRING, HEIGHT TO ROOF DECK	
S03AR	0 HR	NON-RATED, 5/8" GYPBD / 3-5/8" MTL FRAMING / 5/8" GYPBD, HEIGHT TO ROOF DECK	
S03ER	0 HR	NON-RATED, 5/8" GYPBD / 3-5/8" MTL FRAMING, HEIGHT TO ROOF DECK	

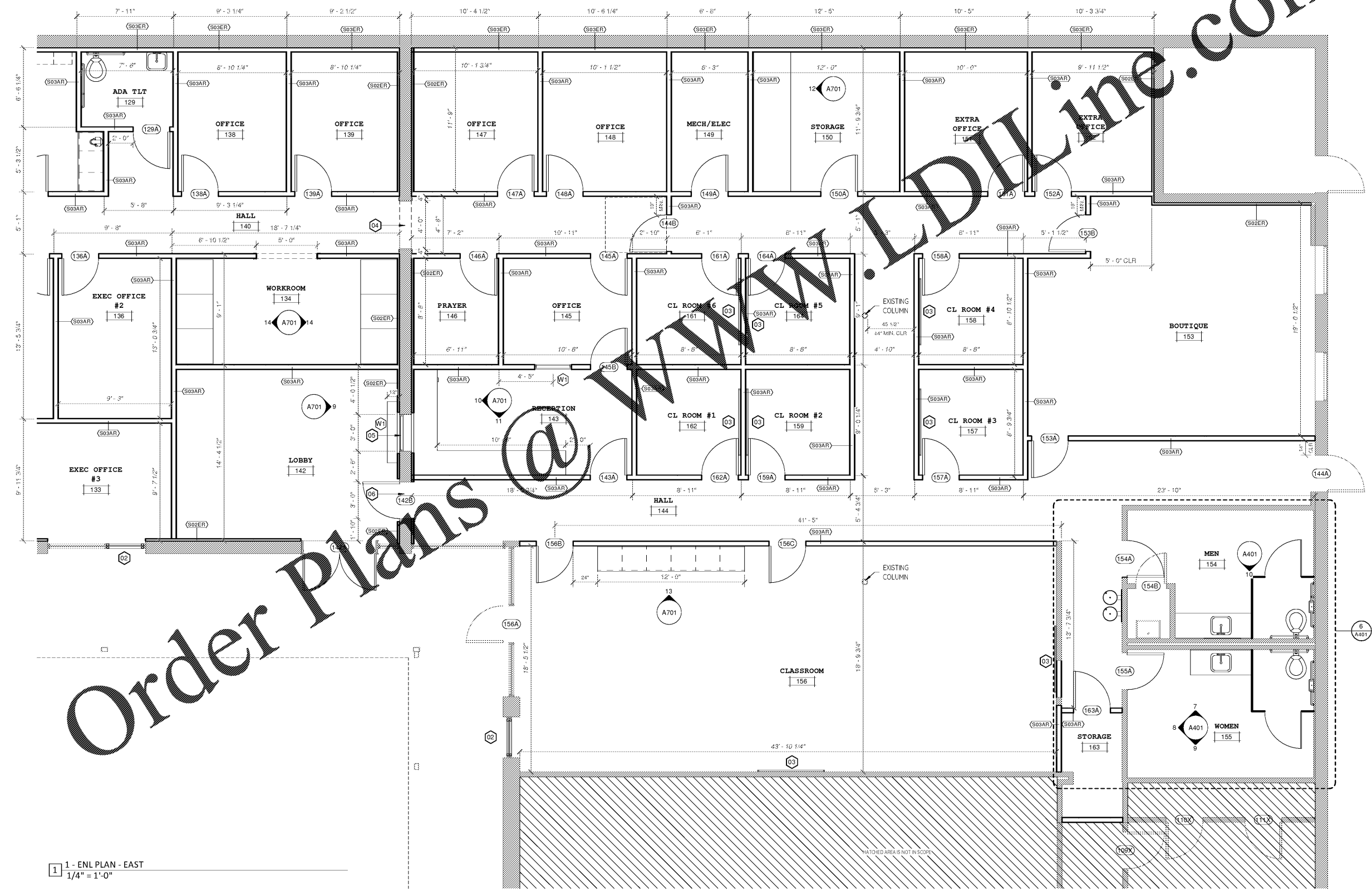

1 - ENL PLAN - EAST  
1/4" = 1'-0"

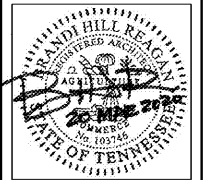

**bloom architecture**  
400 E. Main Street, #215 | Chattanooga, TN 37409  
design@bloomco.com | 423-503-1951

**5700 BUILDING: INTERIOR RENOVATION**  
951 EASTGATE LOOP CHATTANOOGA, TN 37411

No.	Description	Date

Project #: 19161  
20 MAR 2020  
FLOOR PLAN - EAST SIDE

**A112**

PERMIT SET

Copyright Notice: All drawings and design proposals are the property of Bloom Architecture, LLC and cannot be reproduced, copied, or used for any reason without the express written consent of Bloom Architecture.