

THE DRAWINGS & WRITTEN MATERIAL HEREIN CONSTITUTE ORIGINAL WORK OF THE ARCHITECT, & AS SUCH, ARE SUBJECT TO COPYRIGHT & MAY NOT BE REPRODUCED, TRANSMITTED, REPRODUCED, OR USED IN ANY MANNER WITHOUT EXPRESS WRITTEN CONSENT OF THE ARCHITECT
© 2020 IN+EGRA

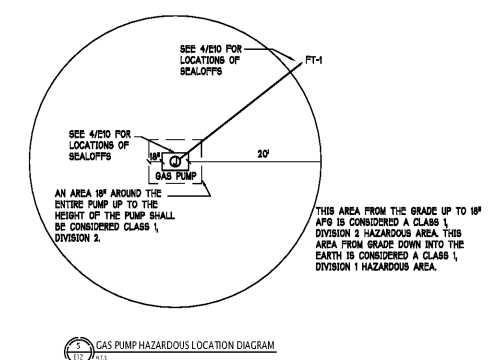

Seals:
VP ENGINEERING
V. PAPPAS
CONSULTING ENGINEERS, P.A.
PO Box 23847, Charlotte, NC 28273
2016 Caddess Road, Suite 180
Charlotte, NC 28202
704.372.3785
www.vpengine.com
CORPORATE NC LICENSE #C-2409

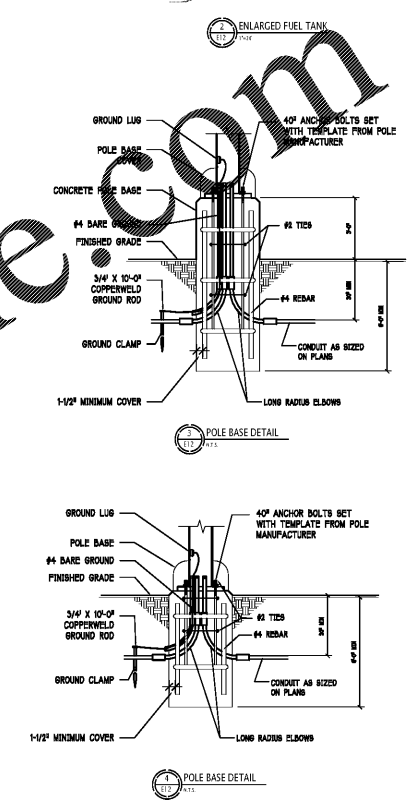
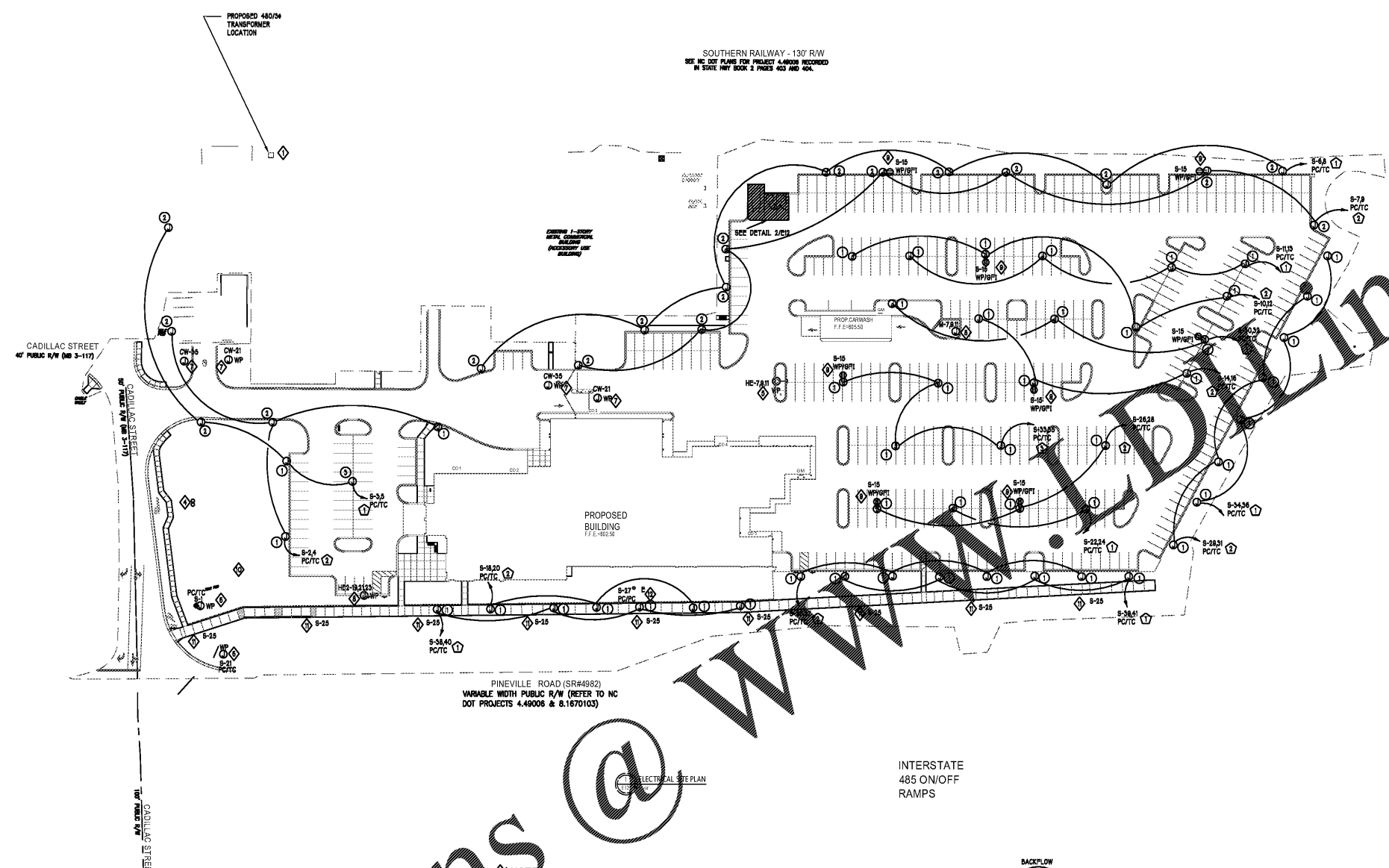

INTERSTATE
485 ON/OFF
RAMPS

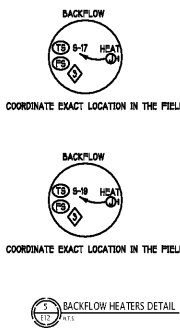

| VOLTAGE DROP TABLE | | | |
|--------------------|--------------|-----------|------------------------------|
| LOAD | VOLTAGE | WIRE SIZE | ONE-WAY DISTANCE FOR 5% DROP |
| 15A ON 20A BRKR | 208V L-L, 1φ | 10 | 217 FEET |
| 15A ON 20A BRKR | 208V L-L, 1φ | 8 | 350 FEET |
| 15A ON 20A BRKR | 208V L-L, 1φ | 6 | 520 FEET |
| 15A ON 20A BRKR | 208V L-L, 1φ | 4 | 809 FEET |
| 15A ON 20A BRKR | 208V L-L, 1φ | 3 | 1070 FEET |

* ALL VALUES ARE CALCULATED USING ELECTRONIC SOFTWARE

Order Plans @ WWWW.DLINE.com

- NOTES:**
- E.C. SHALL COORDINATE EXACT LOCATION OF UTILITY TRANSFORMER WITH POWER COMPANY.
 - E.C. SHALL COORDINATE ALL WIRING AND INSTALLATION OF FUEL TANK PANEL, FUEL TANK CIRCUITS AND E-STOP WITH TANK SUPPLIER. REFER DETAILS 4, 5 AND 7 ON SHEET EED FOR SCHEMATIC W/P.
 - COORDINATE THE EXACT NUMBER AND LOCATION OF FLOW AND TAMPER SWITCHES IN THE FIELD WITH THE SPRINKLER CONTRACTOR.
 - PROVIDE (2) 4" CONDUITS FROM PROVIDER STREET CONNECTION TO TELECOM ROOM.
 - PEDESTAL MOUNTED EV CHARGER, POWERED BY E.C. CHARGER BY OWNER. COORDINATE EXACT ELECTRICAL REQUIREMENT WITH MANUFACTURER PRIOR TO INSTALLATION.
 - COORDINATE WITH CLOCK TOWER/SIGN LOCATION, REFER TO CIVIL AND ARCHITECTURAL DRAWINGS.
 - LOW VOLTAGE TRANSFORMER FOR KEYPADS AND GATES. COORDINATE EXACT LOCATIONS WITH CIVIL ENGINEER.
 - EMPTY 1" CONDUIT WITH PULL STRING AND HAND HOLE FOR FUTURE EV CHARGER. ROUTE TO ELECTRICAL ROOM.
 - RECEPTACLE TO BE MOUNTED ON THE LIGHT POLE. E.C. TO COORDINATE WITH POLE MANUFACTURER.
 - SEE DETAIL 5 ON THIS SHEET FOR BACKFLOW HEATERS.
 - TOWN STANDARD STREET LIGHT, POWERED BY OWNER.
 - INGROUND LIGHT FIXTURE FOR FLAG POLE. COORDINATE EXACT LOCATION WITH OWNER PRIOR TO INSTALLATION.

- NOTES:**
- ALL LIGHTING TO BE TURNED ON AT DUSK AND TURNED OFF AT 12:00 MIDNIGHT WITH THE EXCEPTION OF THE ZONES AND TIMES INDICATED BELOW. THOSE ZONES BELOW WILL REMAIN ON UNTIL DAWN.
- ZONE 1A: JANUARY, MARCH, MAY, JULY, SEPTEMBER, NOVEMBER DUSK TO DAWN.
 - ZONE 1B: FEBRUARY, APRIL, JUNE, AUGUST, OCTOBER, DECEMBER DUSK TO DAWN.
 - ZONE 2: TURN ON AT DUSK AND OFF AT 12:00 MIDNIGHT.

- NOTES:**
- LIGHT FIXTURE AND POLE TO BE SPEC'D BY OTHERS. MAXIMUM FIXTURE WATTAGE 750W.
 - LIGHT FIXTURE AND POLE TO BE SPEC'D BY OTHERS. MAXIMUM FIXTURE WATTAGE OF 380W.
 - LIGHT FIXTURE AND POLE TO BE SPEC'D BY OTHERS. MAXIMUM FIXTURE WATTAGE OF 170W.

Revisions:

| Number | Date | Description |
|--------|------------|-----------------|
| 1 | 03/11/2020 | PERMIT COMMENTS |

Project Title:
SOUTH CHARLOTTE HYUNDAI

Project No: **4802.00**
Drawing Title:

ELECTRICAL SITE PLAN

SET ISSUE DATE
MAR 4, 2020

Sheet
E12

Sheet Template ID: CHEF-07-B
File: Z:\Projects\4802_South Charlotte Hyundai Redesign\4802E12 ELECTRICAL SITE PLAN_Plot.dwg, 3/11/2020 9:31 AM by NETAN AMETA; Saved: 3/2/2020 4:56 PM by KAMETA