

Sheet Template ID: CFE-F-07-B
 File: Z:\Projects\4802_South Charlotte Hyundai Redesign\4802P3 PARTIAL FIRST FLOOR SANITARY WASTE PLAN SERVICE; Plotfile: 3/1/2020 4:28 PM by ALEX E. LEVEN; Saved: 3/1/2020 4:14 PM by DPAYNE

in+EGRA
 an Intra Architecture, PLLC DBA
 110 East Kingston Avenue, Ste. 20
 Charlotte, NC 28203
 704.372.0001
 www.intra.com

THE DRAWING & WRITTEN MATERIAL HEREIN CONSTITUTE ORIGINAL WORK OF THE ARCHITECT, & AS SUCH, IS THE PROPERTY OF THE ARCHITECT. NO SERVICE ARE SUBJECT TO COPYRIGHT & MAY NOT BE REPRODUCED, TRANSMITTED, STORED, REPRODUCED OR USED IN ANY WAY WITHOUT EXPRESS WRITTEN CONSENT OF THE ARCHITECT
 © 2020

Seals:

 Alex E. Leven
 Professional Engineer
 State of North Carolina
 No. 027800

VP ENGINEERING
 VRETOS PAPPAS
 CONSULTING ENGINEERS, P.A.
 PO Box 23847, Charlotte, NC 28221
 2015 Clarkson Drive, Suite 180
 Charlotte, NC 28207
 704.372.1785
 www.vpe.com
 CORPORATE NC LICENSE #C-2409

Revisions:

Number	Date	Description

Project Title:
SOUTH CHARLOTTE HYUNDAI

Project No: **4802.00**

Drawing Title:
PARTIAL FIRST FLOOR SANITARY WASTE PLAN - SERVICE

SET ISSUE DATE
 MAR 4, 2020

Sheet:
P3

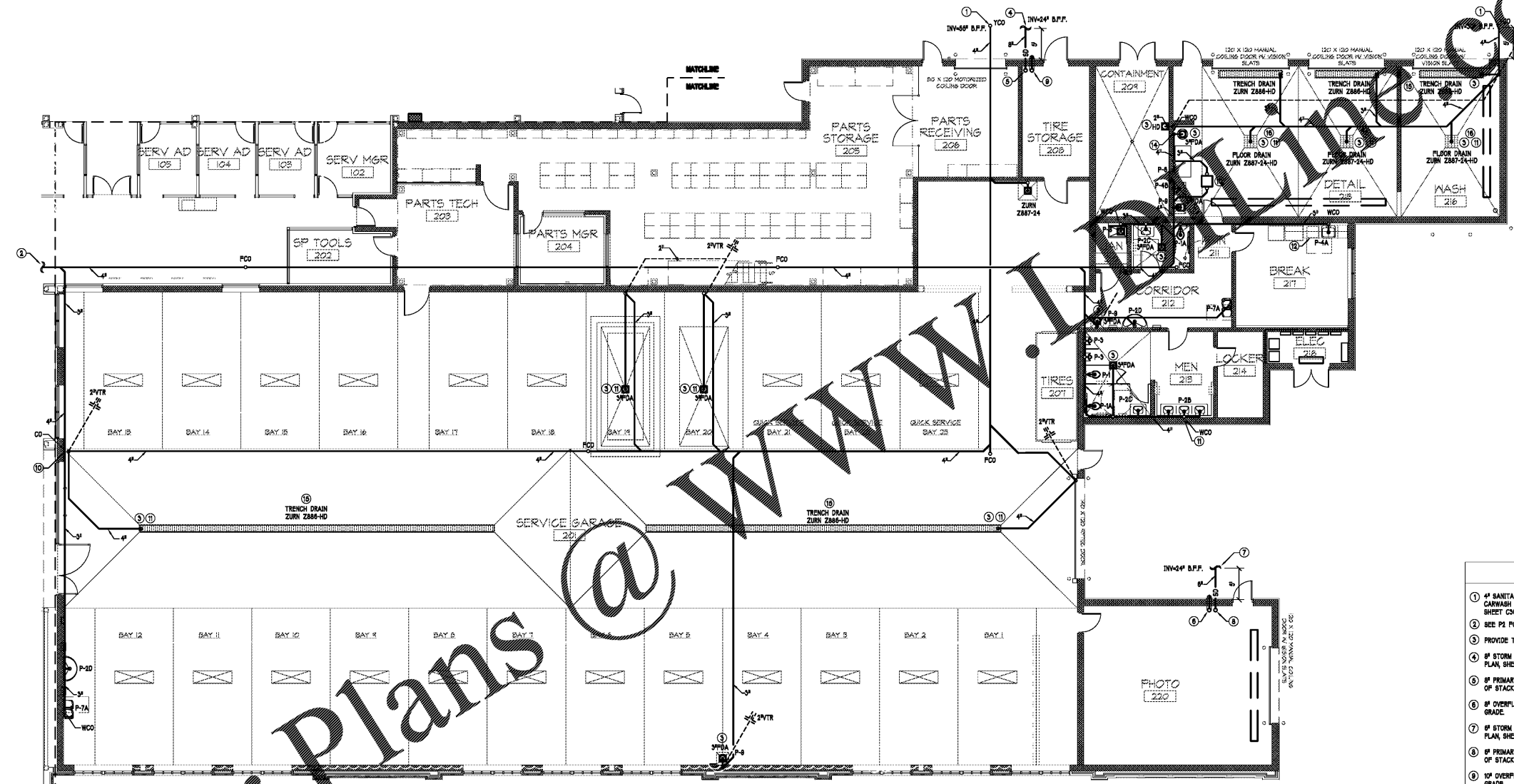

P3 PARTIAL FIRST FLOOR SANITARY WASTE PLAN - SERVICE

- CONSTRUCTION NOTES**
- 4" SANITARY WASTE TO OIL SEPARATOR LOCATED IN CARWASH AREA. SEE CIVIL GRADING & DRAINAGE PLAN SHEET C202, FOR CONTINUATION.
 - SEE P2 FOR CONTINUATION.
 - PROVIDE TRAP PRIMER IN ACCESSIBLE LOCATION.
 - 8" STORM DRAIN LINE - SEE CIVIL GRADING & DRAINAGE PLAN SHEET C202, FOR CONTINUATION.
 - 8" PRIMARY STORM DRAIN FROM ROOF, PROVIDE CO AT BASE OF STACK.
 - 12" OVERFLOW STORM DRAIN FROM ROOF TO DISCHARGE TO GRADE.
 - 8" STORM DRAIN LINE - SEE CIVIL GRADING & DRAINAGE PLAN SHEET C202, FOR CONTINUATION.
 - 8" PRIMARY STORM DRAIN FROM ROOF, PROVIDE CO AT BASE OF STACK.
 - 12" OVERFLOW STORM DRAIN FROM ROOF TO DISCHARGE TO GRADE.
 - LINT INTERCEPTOR RECESSED BELOW FLOOR, MODEL ZURN Z186-S. COVER TO BE PAINTED TO MATCH FINISH FLOOR.
 - P.C. TO VERIFY TRAP IS SET AT A MAXIMUM DISTANCE OF 10' FROM THE VENT.
 - DISHWASHER TO DRAIN TO KITCHEN SINK.
 - SANITARY WASTE PIPING TO BE STARTED AT MINIMUM 24" B.F.F. SLOPE PIPING IN ORDER TO AVOID CONFLICT WITH UNDERGROUND EXHAUST SYSTEM. SEE MECHANICAL PLANS FOR EXACT SIZE AND LOCATION OF EXHAUST PIPING.
 - SANITARY WASTE PIPING TO BE STARTED AT MINIMUM 24" B.F.F. SLOPE PIPING IN ORDER TO AVOID CONFLICT WITH UNDERGROUND EXHAUST SYSTEM. SEE MECHANICAL PLANS FOR EXACT SIZE AND LOCATION OF EXHAUST PIPING.
 - PROVIDE WITH GALVANIZED DUCTILE IRON, SLOTTED, AND RATED CLASS C GRATE.
 - PROVIDE WITH TRAFFIC RATED LID.

- GENERAL NOTES:**
- ALL PIPING AND OTHER SYSTEMS RUN IN OR ACROSS AREAS WITH EXPOSED CEILING SHALL BE GROUPED NEAT TOGETHER OR NEAR THE UNDERSIDE OF THE JOINTS. GC IS RESPONSIBLE FOR COORDINATION OF THIS AND THE OWNER PROVIDED EQUIPMENT.
 - RUN PLUMBING IN CHASE WALLS WHERE PROVIDED, REFER TO ARCHITECTURAL PLANS.

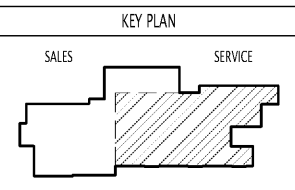

Order Plans @ www.intra.com