

File: P:\252536.00 Hyundai of S. Charlotte (DWG)_CD\1.2a; Plotfile: 3/4/2020 9:42 PM by CHRIS; Saved: 3/4/2020 9:41 PM by CHRIS

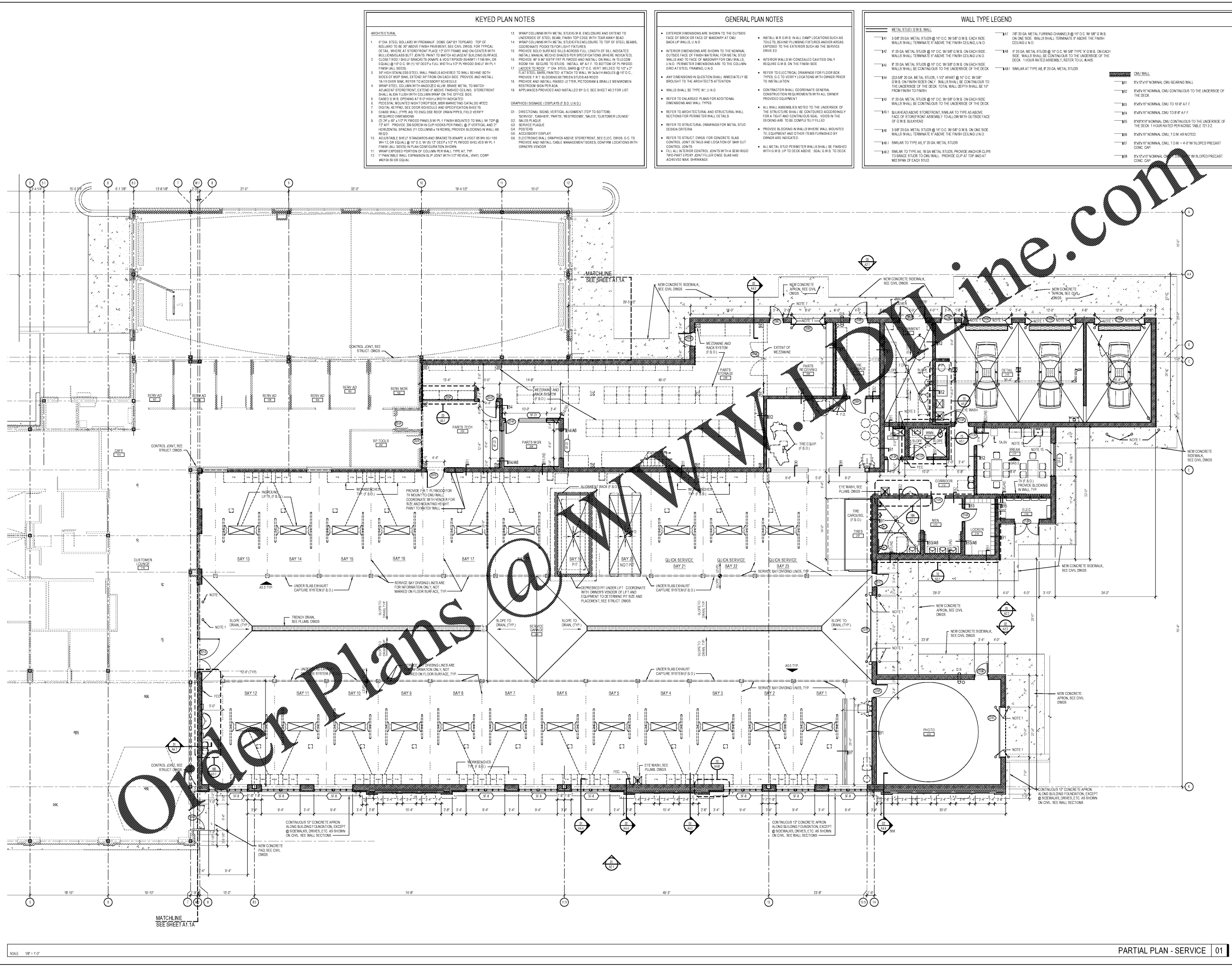

- ### KEYED PLAN NOTES
- ARCHITECTURAL**
1. 2" DIA. STEEL BOLLARD WITH FRAMING: COME GAP BY TOP EDGE. TOP OF BOLLARD TO BE 30" ABOVE FINISH FLOOR. SEE CIVIL DWGS. FOR TYPICAL DETAIL. WHERE AT STOREFRONT PLACE 1" OFF FRAME AND ON CENTER WITH WALLS/DOORS BUT CENTER POINT TO MATCH ADJACENT BUILDING SPACE.
 2. CLOSET ROD / SHELF BRACKET SQUARE AND 1/2" DIA. ROD / SHELF BRACKET SQUARE. PROVIDE 4" X 6" X 3/4" FOR 1" THICK AND INSTALL ON WALL IN TELECOM ROOM 154. REQUIRE TO BE: METAL 4" X 4" X 1/2" TO BOTTOM OF 1" WOOD FINISH (ALL SIDES).
 3. 3" HIGH STAINLESS STEEL WALL PANELS ADHERED TO WALL BEHIND BOTH SIDES OF BOP SIGN. EXTEND 3" FROM ON EACH SIDE. PROVIDE AND INSTALL 1/4" OVER BOP. REFER TO ACCESSORY SCHEDULE.
 4. 1/2" DIA. STEEL COLUMN WITH ANODIZED ALUM. BRACE METAL TO MATCH ADJACENT STOREFRONT. EXTEND 1" ABOVE FINISHED CEILING. STOREFRONT SHALL ALIGN FLUSH WITH COLUMN BRACE ON THE OUTSIDE SIDE.
 5. CASES 12" W. B. OPENING AT 1" OFF FINISH WITH INDICATED.
 6. PRECAST MOUNTED WOOD PANELS WITH 1" FINISH INDICATED TO WALL W/ TOP @ 17' 4 1/2". PROVIDE 3/8" SCREW IN CLIP HOOKS PER PANEL @ 2' VERTICAL AND 2' HORIZONTAL SPACING (11 COLUMNS @ 19" HOURS). PROVIDE BLOCKING IN WALL AS REQUIRED.
 7. DIGITAL KEYPAD. SEE SDCOR SCHEDULE AND SPECIFICATION SHEET.
 8. CHANGE WALL TYPE AND FINISH TO ROOF DRAIN/WALL. SEE SDCOR SCHEDULE AND SPECIFICATION SHEET.
 9. 12" X 4" X 1/2" PLYWOOD PANELS WITH 1" FINISH INDICATED TO WALL W/ TOP @ 17' 4 1/2". PROVIDE 3/8" SCREW IN CLIP HOOKS PER PANEL @ 2' VERTICAL AND 2' HORIZONTAL SPACING (11 COLUMNS @ 19" HOURS). PROVIDE BLOCKING IN WALL AS REQUIRED.
 10. ADJUSTABLE SHELF STANDARDS AND BRACKETS TO BRACKETS & VERTICAL BRACKETS 18" H. 1/2" DIA. STEEL BOLLARD WITH FRAMING: COME GAP BY TOP EDGE. TOP OF BOLLARD TO BE 30" ABOVE FINISH FLOOR. SEE CIVIL DWGS. FOR TYPICAL DETAIL. WHERE AT STOREFRONT PLACE 1" OFF FRAME AND ON CENTER WITH WALLS/DOORS BUT CENTER POINT TO MATCH ADJACENT BUILDING SPACE.
 11. 1" PAINTABLE WALL EXPANSION SLIP JOINT WITH 1/2" REVEAL, VINYL COPR. 1/8" DIA. ROD EQUAL.
 12. 1" PAINTABLE WALL EXPANSION SLIP JOINT WITH 1/2" REVEAL, VINYL COPR. 1/8" DIA. ROD EQUAL.
- SPRINKLER SIGNAGE (OVERLAYS F.B.O.)**
01. DIRECTIONAL SIGN: VERTICAL ALIGNMENT (TOP TO BOTTOM): SERVICE, CASHIER, PARTS, RESTROOMS, SALES, CUSTOMER LOUNGE!
 02. SIGN PLACED
 03. SERVICE PLACED
 04. POS SIGN
 05. ACCESSORY DISPLAY
 06. ELECTRONIC WALL GRAPHICS ABOVE STOREFRONT. SEE ELEC. DWG. 0.6 TO PROVIDE AND INSTALL CABLE MANAGEMENT DECKS, CONTROL LOCATIONS WITH OWNERS VENDOR.

- ### GENERAL PLAN NOTES
- EXTERIOR DIMENSIONS ARE SHOWN TO THE OUTSIDE FACE OF BRICK OR FACE OF MASONRY AT CMU BACK-UP WALLS, U.N.O.
 - INTERIOR DIMENSIONS ARE SHOWN TO THE NOMINAL OUTSIDE FACE OF FINISH MATERIAL FOR METAL, STUO WALLS AND TO FACE OF MASONRY FOR CMU WALLS, U.N.O. DIMENSIONS ARE TO THE COLUMN GRID AT STEEL FRAMING, U.N.O.
 - ANY DIMENSIONS IN QUESTION SHALL IMMEDIATELY BE BROUGHT TO THE ARCHITECT'S ATTENTION.
 - WALLS SHALL BE TYPE "A", U.N.O.
 - REFER TO ENLARGED PLANS FOR ADDITIONAL DIMENSIONS AND BACK-SYSTEM TYPES.
 - REFER TO ARCHITECTURAL AND STRUCTURAL WALL SECTIONS FOR PERMETER WALL DETAILS.
 - REFER TO STRUCTURAL DRAWINGS FOR METAL STUO DESIGN CRITERIA.
 - REFER TO STRUCT. DWGS FOR CONCRETE SLAB CONTROL JOINT DETAILS AND LOCATION OF SAW CUT CONTROL JOINTS.
 - FILL IN ALL UNBUILT CONTROL JOINTS WITH A SEMI-RIGID TWO-PART EPOXY JOINT FILLER. CMU SLAB HAS ACHIEVED MAX. SHRINKAGE.
- INSTALL M.G.W.B. IN ALL DAMP LOCATIONS SUCH AS TOILETS, BEHIND PLUMBING FIXTURES AND/OR AREAS EXPOSED TO THE EXTERIOR SUCH AS SERVICE DRIVE.
 - INTERIOR WALLS WITH CONDENSED CAVITIES ONLY REQUIRE G.W.B. ON THE FINISH SIDE.
 - REFER TO ELECTRICAL DRAWINGS FOR FLOOR BOX TYPES, G.C. TO VERIFY LOCATIONS WITH OWNER PROVIDED EQUIPMENT.
 - CONTRACTOR SHALL COORDINATE GENERAL CONSTRUCTION REQUIREMENTS WITH OWNER PROVIDED EQUIPMENT.
 - ALL WALL ASSEMBLIES NOTED TO THE UNDERSIDE OF THE STRUCTURE SHALL BE CONTINUED ACCORDINGLY FOR A TIGHT AND CONTINUOUS SEAL. VOIDS IN THE CEILING ARE TO BE COMPLETELY FILLED.
 - PROVIDE BLOCKING IN WALLS WHERE WALL MOUNTED TV EQUIPMENT AND OTHER ITEMS FURNISHED BY OWNER ARE INDICATED.
 - ALL METAL STUO PERMETER WALLS SHALL BE FINISHED WITH G.W.B. UP TO 2" DECK ABOVE. SEAL G.W.B. TO DECK

- ### WALL TYPE LEGEND
- METAL STUO G.W.B. WALL**
- W1 3-SP 20 GA METAL STUDS @ 16" O.C. W/ 5/8" G.W.B. EACH SIDE. WALLS SHALL TERMINATE ABOVE THE FINISH CEILING, U.N.O.
 - W2 2-SP 20 GA METAL STUDS @ 16" O.C. W/ 5/8" G.W.B. ON EACH SIDE. WALLS SHALL TERMINATE ABOVE THE FINISH CEILING, U.N.O.
 - W3 2-SP 20 GA METAL STUDS @ 16" O.C. W/ 5/8" G.W.B. ON EACH SIDE. WALLS SHALL BE CONTINUOUS TO THE UNDERSIDE OF THE DECK.
 - W4 2-SP 20 GA METAL STUDS, 1-1/2" APART @ 16" O.C. W/ 5/8" G.W.B. ON FINISH SIDES ONLY. WALLS SHALL BE CONTINUOUS TO THE UNDERSIDE OF THE DECK. TOTAL WALL DEPTH SHALL BE 10" FROM FINISH TO FINISH.
 - W5 2-SP 20 GA METAL STUDS @ 16" O.C. W/ 5/8" G.W.B. ON ONE SIDE. WALLS SHALL TERMINATE ABOVE THE FINISH CEILING, U.N.O.
 - W6 SIMILAR TO TYPE A4, @ 20 GA METAL STUDS.
- CMU WALL**
- W7 8" X 16" NOMINAL CMU CONTINUOUS TO THE UNDERSIDE OF THE DECK.
 - W8 8" X 16" NOMINAL CMU TO 18" F.A.F.F.
 - W9 8" X 16" NOMINAL CMU TO 8" F.A.F.F.
 - W10 8" X 16" NOMINAL CMU CONTINUOUS TO THE UNDERSIDE OF THE DECK. 1 HOUR RATED PER NIOSC 108.1 TO 17.2.
 - W11 8" X 16" NOMINAL CMU, T.O.M. AS NOTED.
 - W12 8" X 16" NOMINAL CMU, T.O.M. + 4" W/ SLOPED PRECAST CONC. CAP.
 - W13 8" X 16" NOMINAL CMU, T.O.M. + 4" W/ SLOPED PRECAST CONC. CAP.

in+EGRA
an Ingra Architecture, PLLC DBA
110 East Kingston Avenue, Ste. 20
Charlotte, NC 28203
704.372.0001
www.ingrainc.com

THE COPIES & WRITTEN MATERIAL HEREIN CONSTITUTE ORIGINAL WORK OF THE ARCHITECT AS INTELLECTUAL PROPERTY & INSTRUMENTS OF SERVICE. ARE SUBJECT TO COPYRIGHT & MAY NOT BE REPRODUCED, PHOTOCOPIED, REPRODUCED OR USED IN ANY WAY WITHOUT EXPRESS WRITTEN CONSENT OF THE ARCHITECT © P. IN+EGRA

REGISTERED ARCHITECT
CERT. NO. 38109
RICHARD CUEVAS
ARCHITECT
RICHARD CUEVAS

Scale: 03/04/2020

HYUNDAI
HYUNDAI OF SOUTH CHARLOTTE

Revisions:

| Number | Date | Description |
|--------|------|-------------|
| | | |
| | | |
| | | |
| | | |
| | | |

Project Title:
HYUNDAI SOUTH CHARLOTTE

10518 CADILLAC STREET
PINEVILLE, NC 28134

Project No.: 2536.00

Drawing Title:
PARTIAL PLAN SERVICE

SET ISSUE DATE
▶ MARCH 4, 2020 ◀

Sheet:
A1.2a

SCALE: 1/8" = 1'-0"

PARTIAL PLAN - SERVICE | 01