

VICINITY MAP
N.T.S.

SOUTHERN RAILWAY - 130' R/W
SEE NC DOT PLANS FOR PROJECT 4.49006 RECORDED IN STATE HWY BOOK 2 PAGES 403 AND 404.

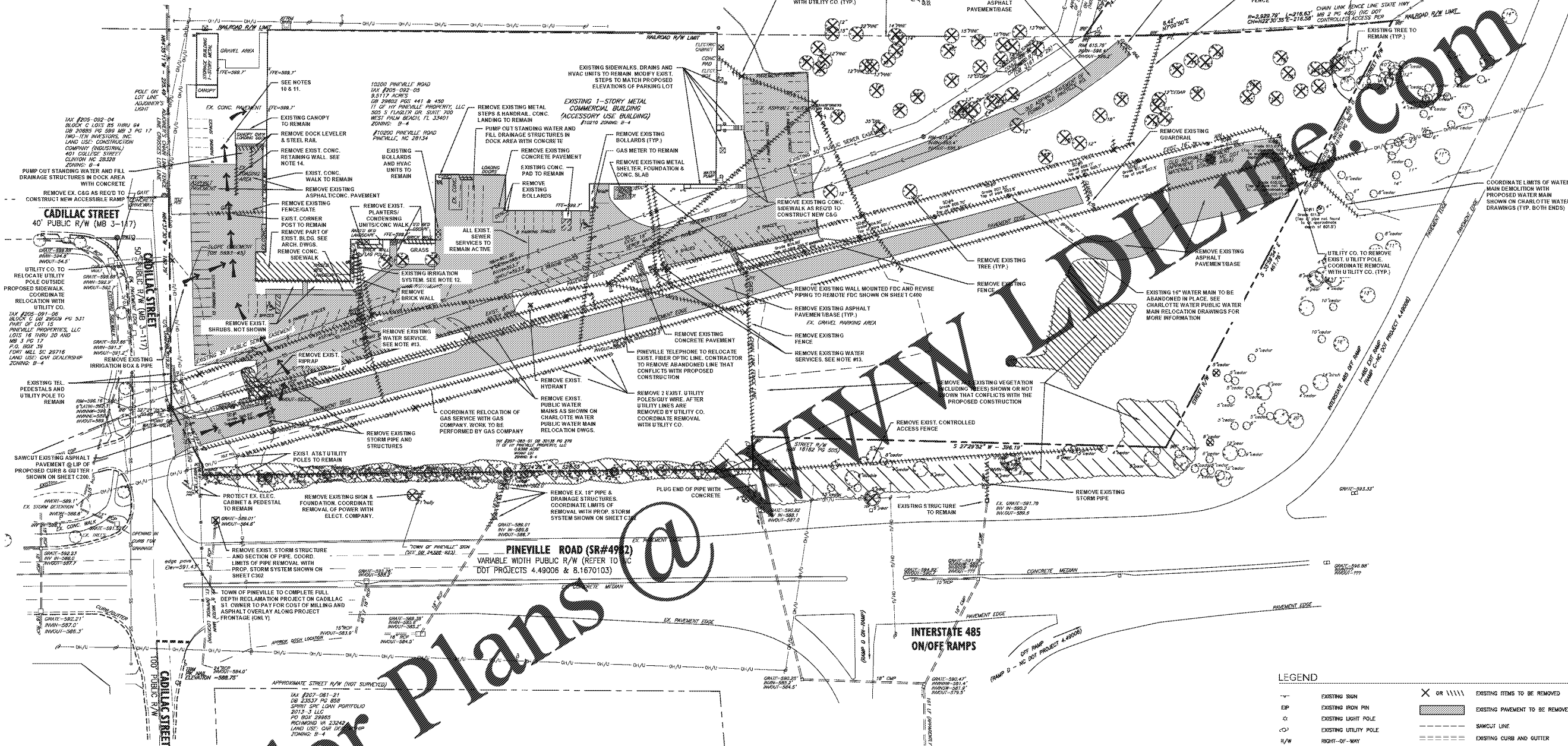

Order Plans @ www.dilme.com

BENESCH - INDEX OF SHEETS

- C100 EXISTING CONDITIONS/DEMOLITION PLAN
- C200 SITE PLAN
- C300 EROSION CONTROL PLAN PRE-DEVELOPED
- C301 EROSION CONTROL PLAN POST-DEVELOPED
- C302 GRADING AND DRAINAGE PLAN
- C400 UTILITY PLAN
- C500 SITE CONSTRUCTION DETAILS
- C501 SITE CONSTRUCTION DETAILS
- C502 SITE CONSTRUCTION DETAILS
- C503 SITE CONSTRUCTION DETAILS
- C504 BMP #1 DETAILS
- C505 BMP #2 DETAILS
- C506 SITE CONSTRUCTION DETAILS
- C507 SITE CONSTRUCTION DETAILS
- C600 LANDSCAPE PLAN
- C700 SPECIFICATIONS
- C701 SPECIFICATIONS
- C702 SPECIFICATIONS
- C703 SPECIFICATIONS
- C704 SPECIFICATIONS
- CHARLOTTE WATER DRAWINGS
- 1 OF 4 COVER SHEET
- 2 OF 4 PERMIT SHEET, GENERAL NOTES
- 3 OF 4 PROPOSED WATER MAIN PLAN & PROFILE
- 4 OF 4 PROPOSED WATER MAIN PLAN & PROFILE

DEMOLITION/CLEARING NOTES

1. BOUNDARY AND TOPOGRAPHIC INFORMATION TAKEN FROM A SURVEY PREPARED BY A.S. & J. WHELAN SURVEYORS DATED SEP. 14, 2018 AND UPDATED THRU FEB. 8, 2019 AND CONTRACTOR TO ADVISE OF ANY DISCREPANCY PRIOR TO ANY WORK BEING COMPLETED.
2. CONTRACTOR SHALL REMOVE EXISTING TREES, CONCRETE ASPHALT AND OTHER EXISTING STRUCTURES INDICATED ON PLAN. CONTRACTOR TO DISPOSE OF ALL DEBRIS TO AN APPROVED (LEGAL) OFF-SITE LOCATION.
3. PROTECT ADJACENT CURBS, TREES, BUILDINGS, UTILITIES AND OTHER ITEMS TO REMAIN FROM DAMAGE. CONTRACTOR SHALL BE RESPONSIBLE FOR REPAIR AND/OR PAYMENT OF ANY DAMAGED ITEMS TO REMAIN.
4. CONTRACTOR SHALL VERIFY LOCATION OF ALL UNDERGROUND UTILITIES PRIOR TO BEGINNING WORK. BOTH PUBLIC AND PRIVATE. CONTRACTOR IS FULLY RESPONSIBLE FOR ALL UNDERGROUND UTILITIES AND SHALL REPAIR ANY DAMAGE AS A RESULT OF THIS CONTRACT.
5. CONTRACTOR'S SURVEYOR SHALL REPORT ANY ENCROACHMENTS OR DISCREPANCIES GENERATED BY THIS CLEARING PLAN IMMEDIATELY TO AFRID BENESCH & COMPANY FOR DECISION.
6. CONTRACTOR'S SURVEYOR SHALL VERIFY CLOSURE AND ACCURACY OF CURVE DATA PRIOR TO COMMENCEMENT OF FIELD STAKING.
7. CONTRACTOR SHALL MAKE EVERY EFFORT TO SAVE ADDITIONAL TREES WHEREVER FEASIBLE.
8. NO SOIL DISTURBANCE OR COMPACTION, CONSTRUCTION MATERIALS, TRAFFIC, BURIAL PITS, TRENCHING OR OTHER LAND DISTURBING ACTIVITY ALLOWED IN THE TREE SAVE AREA.
9. CLEARING LIMITS ON THE PLAN INDICATE THE EXTENT OF ALL MAJOR CLEARING REQUIRED. CONTRACTOR IS ALSO RESPONSIBLE FOR ANY INCIDENTAL CLEARING REQUIRED FOR MINOR DISCREPANCIES IN GRADE, UTILITY OR STORM PIPE INSTALLATIONS, EROSION CONTROL MEASURES, ETC.
10. EXISTING BUILDINGS TO REMAIN OCCUPIED BY OWNER DURING CONSTRUCTION. GENERAL CONTRACTOR TO ACCOMMODATE OWNER'S USE DURING CONSTRUCTION.
11. GENERAL CONTRACTOR MUST ALLOW CONTINUOUS ACCESS TO THE EXISTING BUILDING DURING ALL PHASES OF CONSTRUCTION.
12. REMOVE ALL EXISTING IRRIGATION LINES & COMPONENTS (SHOWN AND NOT SHOWN) THAT CONFLICTS WITH THE PROPOSED CONSTRUCTION.
13. REMOVE EXISTING BACKFLOW PREVENTERS AND VAULT AND WATER SERVICES TO BLDG. COORDINATE LIMITS OF REMOVAL WITH PROP. WATER SERVICES SHOWN ON SHEET C400. COORDINATE REMOVAL OF DOMESTIC AND FIRE PROTECTION METERS WITH CLT WATER. THIS WORK MUST BE UNDERTAKEN AFTER THE NEW SERVICES TO THE EXISTING BUILDING ARE ACTIVE. DOMESTIC AND FIRE PROTECTION SERVICES SHALL BE ACTIVE AT ALL TIMES.
14. REMOVE VERTICAL SECTION OF CONCRETE RETAINING WALL WHERE WALL IS ADJACENT TO ASPHALT PAVEMENT (APPROX. 30' LONG). THE SECTION OF WALL ADJACENT TO THE CONCRETE PAVEMENT, NEAREST THE LOADING DOCK SHALL REMAIN.

LEGEND

EXISTING SIGN	EXISTING ITEMS TO BE REMOVED
EXISTING IRON PIN	EXISTING PAVEMENT TO BE REMOVED
EXISTING LIGHT POLE	SAWCUT CURB
EXISTING UTILITY POLE	EXISTING CURB AND GUTTER
RIGHT-OF-WAY	PROPERTY LINE
ACCESSIBLE SPACE	EXISTING FENCE
EXISTING TREE TO REMAIN	EXISTING UNDERGROUND ELECTRIC LINE
EXISTING TREE TO BE REMOVED	EXISTING OVERHEAD ELECTRIC LINE
EXISTING FIRE HYDRANT	EXISTING UNDERGROUND TELEPHONE LINE
EXISTING WATER VALVE	EXISTING WATER VALVE
EXISTING WATER METER	EXISTING SANITARY SEWER LINE
EXISTING SEWER MANHOLE	EXISTING WATER LINE
EXISTING STORM MANHOLE	EXISTING GAS LINE
EXISTING DRAINAGE STRUCTURE	EXISTING CONTOUR LINE
EXISTING CLEANOUT	TEMPORARY TREE PROTECTION BARRICADE
EXISTING SPOT ELEVATION	EXISTING TREELINE
EXISTING GAS VALVE	
EXISTING GAS METER	
SOFT DIG HOLES	

811
Know what's below.
Call before you dig.

SCALE: 1"=40'

NORTH

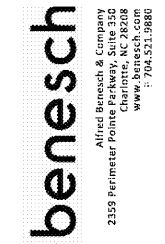

Alfred Benesch & Company
Professional Engineers, Surveyors
2559 Fairmead Pointe
Charlotte, NC 28208
www.benesch.com
704.521.9880

Corp. NC License: F-1320

Hyundai of South Charlotte
10518 Cadillac Street
Pineville, North Carolina

Project No: 17000070.02
Date: 03.04.2020
Revisions:

Sheet Title:
**Existing Conditions/
Demolition
Plan**

Sheet No:
C100