

IN-SLAB PLUMBING ROUGH-INS SCHEDULE										
MARK	ROUGH-IN HEIGHT	QTY	CW	HW	SANITARY WASTE	GAS SIZE	GAS: BTUH	ITEM	DESCRIPTION	REMARKS
P-1-W	N FLOOR	1			INDIRECT			1	BEVERAGE COUNTER	FLOOR SINK; INDIRECT WASTE FROM BEVERAGE CTR DRIP TRAY & ICE STORAGE
P-9-W	STUB UP	3			1 1/2"			9	HAND SINK	STUB UP LOCATION; SEE SHEET FOR FLOOR WALL ROUGH-IN
P-19-W	N FLOOR	1			INDIRECT			19	ICE & SODA DISPENSER	FLOOR SINK
P-72-W	N FLOOR	1			INDIRECT			72	ONE COMP PREP SINK	FLOOR SINK; INDIRECT WASTE FROM PREP SINK; SEE SHEET FOR ICE STORAGE BIN CONNECTION FOR FLOOR TROUGH; UNIT BY OTHERS; VERIFY ACTUAL SIZE & ACTUAL CONNECTION POINT LOCATION
P-76-W	N FLOOR	1			INDIRECT			76	ICE STORAGE BIN	FLOOR SINK
P-78-W	N FLOOR	1			INDIRECT			78	3 COMP POT/PAN SINK	FLOOR SINK

PLUMBING NOTES

- ALL ROUGH-INS SHOWN ARE FIGURED TO COME OUT OF THE FLOOR OR WALLS AND ARE SHOWN APPROXIMATELY WHERE THEY OCCUR IN THE FIXTURE.
- ALL PLUMBING TO BE ROUGHED IN THE WALLS RATHER THAN UP THROUGH THE FLOOR WHENEVER POSSIBLE.
- ALL MEASUREMENTS TAKEN FROM FINISHED WALLS OR FROM THE CENTER LINE OF COLUMNS.
- ALLOWANCES MUST BE MADE FOR VALVES, TRAPS, ETC.
- ALL DIMENSIONS TAKEN FROM FINISH LINE; MAY INCREASE TWO(2) INCHES OR DECREASE ONE(1) INCH WITH LEG ADJUSTMENT.
- ALL MECHANICAL STUBBING TO CENTER OF FLOOR TO BE UP SIX(6) INCHES OR LESS TO CLEAR EQUIPMENT BASES; THEN BRANCHED TO FINAL CONNECTION.
- ALL TWO(2) AND THREE(3) COMPARTMENT SINKS MUST HAVE CONTINUOUS WASTE INTO A SINGLE P-TRAP.
- ALL WATER LINES TO HAVE CUT-OFF VALVES.
- ROUGH-INS, PIPING, AND ALL CONNECTIONS TO ALL FOODSERVICE EQUIPMENT BE COMPLETED BY PLUMBING CONTRACTOR.
- PLUMBING CONTRACTOR SHALL SUPPORT ALL SUPPLY AND DRAIN LINES TIGHT AGAINST UNDERSIDE OF EQUIPMENT TO ALLOW SPACE FOR CLEANING.
- TRAPS/INTERCEPTORS ARE SIZED, LOCATED, AND SUPPLIED BY OTHERS.
- WHERE REQUIRED, TOOTH EQUIPMENT DRAINS ARE TO BE PIPED THROUGH GREASE TRAP/INTERCEPTOR AS DIRECTED BY LOCAL PLUMBING CODES.
- ROUGH-INS SHOWN ARE FOR EQUIPMENT SUPPLIED BY TRIMARK FOODCRAFT ONLY. CHECK WITH OWNER FOR EQUIPMENT NOT SUPPLIED BY TRIMARK FOODCRAFT.
- PLUMBING CONTRACTOR (IF SUPPLIED) WILL REQUIRE A PRESSURE REGULATING VALVE IF WATER PRESSURE AT DISHWASHER IS GREATER THAN WHAT DISHWASHER SPECIFICATIONS ALLOW.
- ATYPICAL KITCHEN GAS APPLIANCES OPERATE ON PRESSURES BETWEEN 5" AND 14" ON THE WATER COLUMN. VERIFY WITH MANUFACTURER SPECIFICATION SHEETS.
- PLEASE NOTE: HIGH PRESSURE GAS SYSTEMS MUST BE REDUCED TO BELOW 14" ON THE WATER COLUMN.
- THE ROUGH-INS SHOWN ON THIS DRAWING ARE REQUIRED FOR OPERATION OF EQUIPMENT SUPPLIED BY TRIMARK FOODCRAFT, ACCORDING TO MANUFACTURERS SPECIFICATIONS. THESE ROUGH-INS ARE MANUFACTURERS REQUIREMENTS FOR OPERATION OF EQUIPMENT ONLY. TRIMARK FOODCRAFT WILL NOT BE HELD LIABLE FOR ANY DEVIATION FROM THESE ROUGH-INS. IT SHALL BE THE RESPONSIBILITY OF THE MECHANICAL TRADES TO ENSURE THAT SUPPLY LINES, CARRY-OFFS, WIRE SIZES, ETC. MEET ALL LOCAL CODES.

PLUMBING LEGEND

- COLD WATER
- ⊕ HOT WATER
- ⊖ CHILLED WATER IN
- ⊕ CHILLED WATER RETURN
- DIRECT WASTE
- ⊕ FLOOR DRAIN
- ⊕ FLOOR SINK WITH FULL, THREE QUARTER OR HALF GRATE AS NOTED
- ⊕ FUNNEL FLOOR DRAIN
- ⊕ HUB FLOOR DRAIN
- ⊕ GAS DROP FROM MANIFOLD
- ⊕ SS STEAM SUPPLY
- ⊕ CR CONDENSATE RETURN
- ⊕ FILTERED WATER

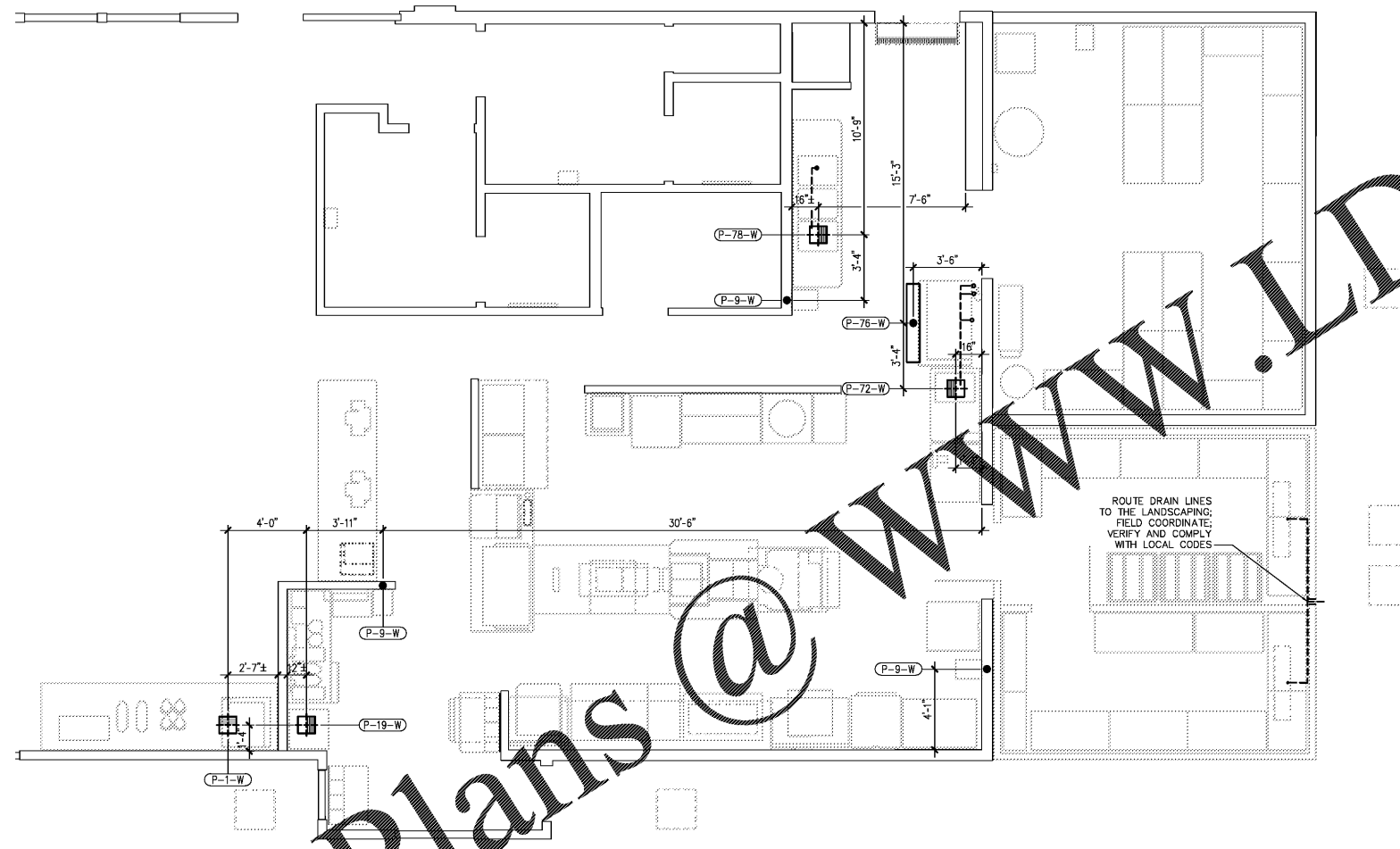
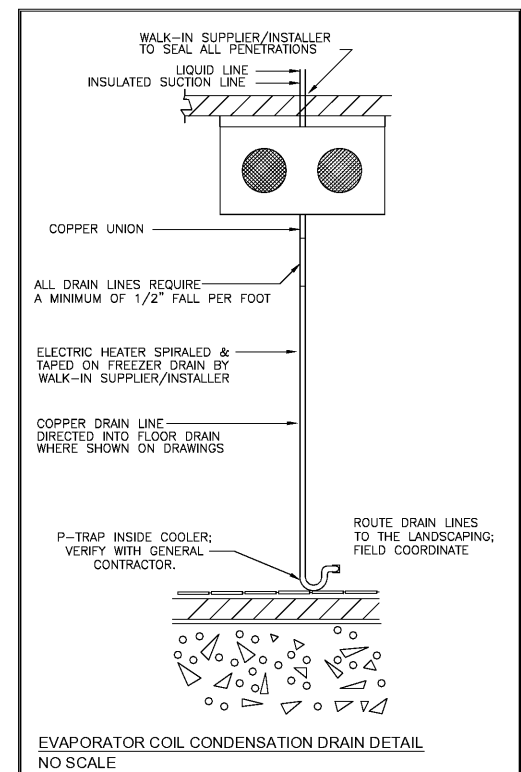

IN SLAB PLUMBING ROUGH-INS
SCALE: 1/4" = 1'-0"

ALL DRAWINGS PROVIDED BY TRIMARK FOODCRAFT DEPICT THE LAYOUT OF THE FOODSERVICE EQUIPMENT AND THEIR SUBSEQUENT POWER, GAS AND WATER REQUIREMENTS TO OPERATE PROPERLY. FOODSERVICE DRAWINGS ARE DESIGNED TO SUPPLEMENT THE OFFICIAL ARCHITECT'S STAMPED AND SEALED DRAWINGS AND ARE NOT MEANT TO REPLACE THEM OR BE USED IN LIEU OF THEM FOR ANY CONSTRUCTION PURPOSES NOT RELATED TO FOODSERVICE EQUIPMENT. THE DRAWINGS ARE DESIGNED TO BE SUBMITTED FOR HEALTH DEPARTMENT APPROVAL AND PERMITTING AND ARE NOT INTENDED TO BE SUBMITTED FOR CONSTRUCTION PERMITTING.

TriMark
Foodservice Equipment, Supplies and Design

FOODCRAFT

2601 Hope Church Road
Winston-Salem, NC 27103
p. 336.768.7520
f. 336.768.1708

trimarkusa.com

This document contains confidential information, is an instrument of a professional service, and the property of TriMark. It shall not be used on other projects or for the extension of this project without TriMark's written approval.

Owner and all Contractors to check and verify existing dimensions and conditions in the field before starting construction and to notify TriMark of any material or detail changes.

REVISIONS		
DATE	NO.	DESCRIPTION

Hardee's
Prince George, VA
BN2016 LD-R

Reference Set - 1st Release

PROJECT NUMBER: 19-101	
DATE:	8-6-2019
SCALE:	1/4" = 1'-0"
DRAWN BY: AH	APPROVED BY: RJ

SHEET TITLE:
IN-SLAB PLUMBING ROUGH-INS

SHEET NUMBER:
QF201