

Calculation Summary							
Label	CalcType	Units	Avg	Max	Min	Avg/Min	Max/Min
PAVED SURFACE READINGS	Illuminance	Fc	5.61	15.0	0.9	6.23	16.67
PROPERTY LINE READINGS	Illuminance	Fc	1.40	3.7	0.1	14.00	37.00

** - SPECIFY COLOR

LABEL	FIXTURE TYPE:	SYMBOL	FIXTURE QUANTITY	CONFIG	QUANTITY	TENSION TOP FITTERS	QUANTITY	EPA	MOUNTING HEIGHT	LLF	POLE TYPE:	QUANTITY	WIND LOAD	ALLOWED EPA
A	VPL-80L-235-5k-4w-UVV-RA-**		12	DBL90	6	TTFVIPER	6	2.00	20'	0.9	SES-18-40-1-TA-** (4')	6	90mph	7.2
P	RWSC-72L-5K-UD-U-**		22						9'	0.9				
Q	RWSC-36L-5K-DO-U-**		3						9'	0.9				

* PROJECT WIND LOAD CRITERIA BASED ON:
ASCE 7-10 WIND SPEEDS (3-SEC PEAK GUST MPH)
50 YEAR MEAN RECURRENCE INTERVAL

VIBER SERIES

DIMENSIONS

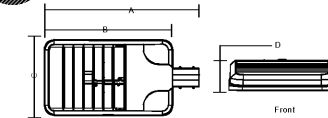

A	B	C	D	Weight	EPA
29.12"	24.19"	14.25"	4.13"	25.0 lbs	1.0 ft2
(704 mm)	(614 mm)	(362 mm)	(105 mm)	(11.3 kg)	

MOUNTING OPTIONS

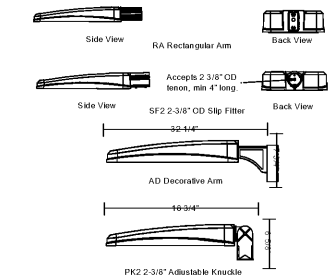

Order Plans

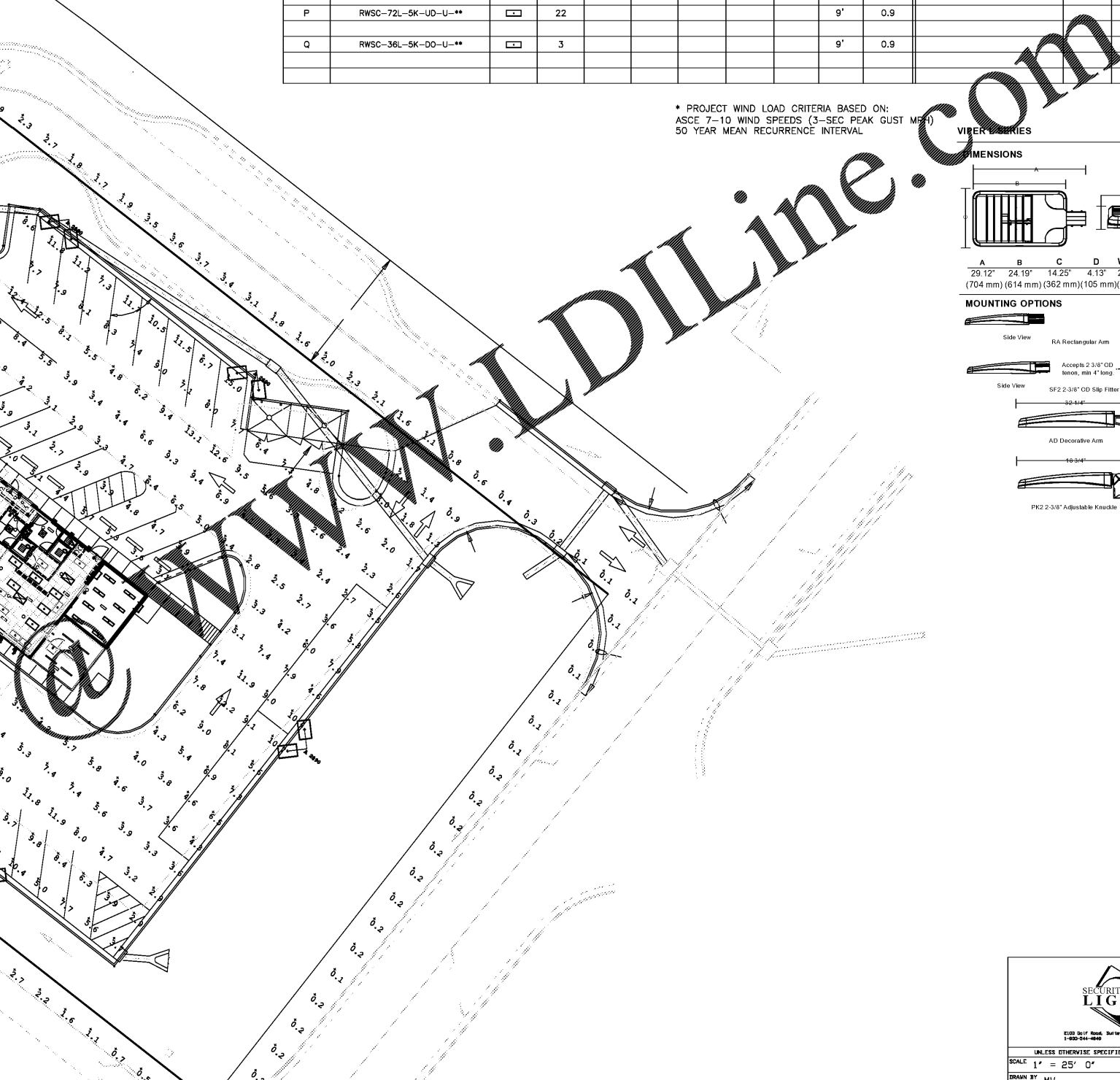

- NOTES:
1. THE FOOTCANDLE LEVELS AS SHOWN ARE BASED ON THE FOLLOWING CRITERIA. ANY SUBSTITUTIONS IN SPECIFIED FIXTURES OR CHANGES TO LAYOUT WILL AFFECT LIGHTING LEVELS SHOWN AND WILL NOT BE THE RESPONSIBILITY OF SECURITY LIGHTING.
 2. DISTANCE BETWEEN READINGS 10'

1. THIS LIGHTING DESIGN IS BASED ON INFORMATION SUPPLIED BY OTHERS TO SECURITY LIGHTING SYSTEMS. SITE DETAILS PROVIDED HEREON ARE REPRODUCED ONLY AS A VISUALIZATION AID. FIELD DEVIATIONS MAY SIGNIFICANTLY AFFECT PREDICTED PERFORMANCE. PRIOR TO INSTALLATION, CRITICAL SITE INFORMATION (POLE LOCATIONS, ORIENTATION, MOUNTING HEIGHT, ETC.) SHOULD BE COORDINATED WITH THE CONTRACTOR AND/OR SPECIFIER RESPONSIBLE FOR THE PROJECT.
2. LUMINAIRE DATA IS TESTED TO INDUSTRY STANDARDS UNDER LABORATORY CONDITIONS. OPERATING VOLTAGE AND NORMAL MANUFACTURING TOLERANCES OF LAMP, BALLAST, AND LUMINAIRE MAY AFFECT FIELD RESULTS.
3. CONFORMANCE TO FACILITY CODE AND OTHER LOCAL REQUIREMENTS IS THE RESPONSIBILITY OF THE OWNER AND/OR THE OWNER'S REPRESENTATIVE.
4. THIS LAYOUT MAY NOT MEET TITLE 24 OR LOCAL ENERGY REQUIREMENTS. IF THIS LAYOUT NEEDS TO BE COMPLIANT WITH TITLE 24 OR OTHER ENERGY REQUIREMENTS, PLEASE CONSULT FACTORY WITH SPECIFIC DETAILS REGARDING PROJECT REQUIREMENTS SO THAT REVISIONS MAY BE MADE TO THE DRAWING.



SITE LIGHTING PLAN	
SCALE	1" = 25' 0"
DRAWN BY	MW
POINT-BY-POINT FOOTCANDLE PLOT FOR	HARDEES Prince George, VA
STORE NUMBER	
DATE	4/12/19
DRAWING NUMBER	42205A

STOCKS ENGINEERING
801 EAST WASHINGTON STREET
NASHVILLE, N.C. 27856
WWW.STOCKSENGINEERING.COM
P.O. BOX 1108
PHONE: (252) 459-8196

BLN-C-1874
Hardees
BODDIE-NOELL ENTERPRISES, INC.
P.O. BOX 1908
ROCKY MOUNT, N.C. 27802-1908
(252) 987-2800

BN
HARDEES at
PRINCE GEORGE
COUNTY, VA.

COMMONWEALTH OF VIRGINIA
J. MICHAEL STOCKS
Lic. No. 003508
PROFESSIONAL ENGINEER
J. Michael Stocks
8/19/19

REVISIONS	
12/8/19	PRINCE GEORGE REVIEW
FILE NO.	2017-013
HORIZ. SCALE	1"=20'
VERT. SCALE	NONE

CE-11