



**McFarland Johnson**  
 2409 N. ROOSEVELT BOULEVARD  
 SUITE 4  
 KEY WEST, FLORIDA 33040  
 P:321-431-7029  
 mjinc.com

PROJECT MILESTONE  
**BID PLANS**

NO.	DATE	DESCRIPTION

CLIENT: **KEY WEST INTERNATIONAL AIRPORT**  
 PROJECT: **KEY WEST, FLORIDA**  
**AIRPORT MAINTENANCE STORAGE FACILITY PROJECT**

DRAWN	JES
DESIGNED	AJF
CHECKED	AJF
SCALE	1"=10'
DATE	MARCH 04, 2020
PROJECT	18221_05

IT IS A VIOLATION OF LAW FOR ANY PERSON, UNLESS THEY ARE ACTING UNDER THE DIRECT DIRECTION OF A LICENSED PROFESSIONAL ENGINEER, ARCHITECT, LANDSCAPE ARCHITECT, OR LAND SURVEYOR, TO ALTER AN ITEM IN ANY WAY. IF AN ITEM BEARING THE STAMP OF A LICENSED PROFESSIONAL IS ALTERED, THE ALTERING ENGINEER, ARCHITECT, LANDSCAPE ARCHITECT, OR LAND SURVEYOR SHALL STAMP THE DOCUMENT AND INCLUDE THE NOTATION "ALTERED BY" FOLLOWED BY THEIR SIGNATURE, THE DATE OF SUCH ALTERATION, AND A SPECIFIC DESCRIPTION OF THE ALTERATION.

DRAWING TITLE  
**GENERAL SITE LAYOUT PLAN**

DRAWING NUMBER  
**SP-01**

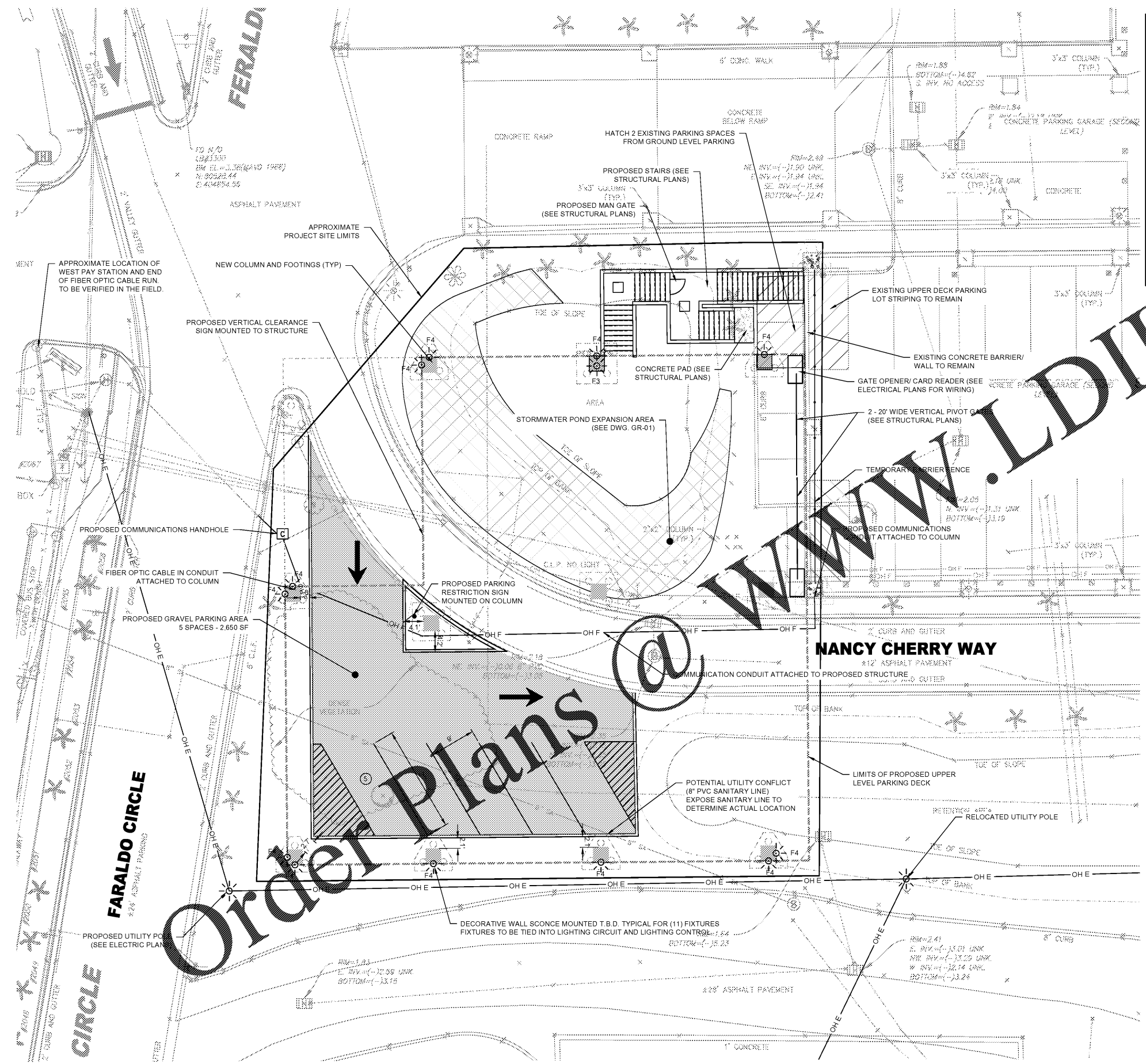
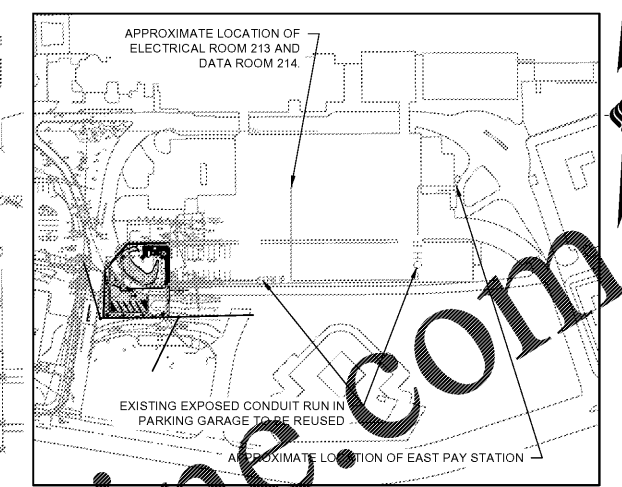

PARCEL RE= 00064840-000000  
 AK= 1065331  
 MONROE COUNTY FLIGHT STRIP  
 S 3501 ROOSEVELT BLVD  
 KEY WEST, FLORIDA 33040  
 152.25 ACRE

FLOOD ZONE = VE (EL+11)  
 LAND USE DISTRICT = PS  
 FUTURE LAND USE MAP = PS  
 BUILDING SETBACKS - REQUIRED/ PROVIDED  
 FRONT = 20' 175'  
 SIDE = 15' NA  
 REAR = 20' NA

STORMWATER RETENTION CALCULATIONS:  
 DISTURBED AREA = 0.3 ACRES  
 IMPERVIOUS AREA = 68%  
 TREATMENT VOLUME: 2,129 CF (BASED ON 25 YEAR STORM)  
 (SEE DWG. GR-01)

SITE PLAN REQUIREMENTS		
FEATURE	EXISTING	PROPOSED
OPEN SPACE	8804 SF	1381 SF
IMPERVIOUS AREA	2795 SF	10219 SF
PARKING SPACES	0	5
BUILDING FOOTPRINT	0 SF	0 SF

- LEGEND**
- PROPOSED PAVEMENT AREA
  - PROPOSED CURB
  - PROPOSED COMMUNICATION CABLE
  - PROPOSED OVERHEAD ELECTRIC
  - PROPOSED COMMUNICATION HANDHOLE
  - PROPOSED COLUMN
  - PROPOSED STORMWATER BASIN EXPANSION
  - NEW UNDERGROUND FIBER
  - FIBER IN CONDUIT ATTACHED TO STRUCTURE
  - LIGHT FIXTURES (SEE LIGHT FIXTURE SCHEDULE E SERIES DRAWINGS)

