



McFarland Johnson
 2409 N. ROOSEVELT BOULEVARD
 SUITE 4
 KEY WEST, FLORIDA 33040
 P: 321-431-7029
 mjinc.com

PROJECT MILESTONE
BID PLANS

NO.	DATE	DESCRIPTION

CLIENT: **KEY WEST INTERNATIONAL AIRPORT**
 KEY WEST, FLORIDA
 PROJECT: **AIRPORT MAINTENANCE STORAGE FACILITY PROJECT**

DRAWN	JES
DESIGNED	AJF
CHECKED	AJF
SCALE	1"=20'
DATE	MARCH 04, 2020
PROJECT	18221.05

IT IS A VIOLATION OF LAW FOR ANY PERSON, UNLESS THEY ARE ACTING UNDER THE DIRECT DIRECTION OF A LICENSED PROFESSIONAL ENGINEER, ARCHITECT, LANDSCAPE ARCHITECT, OR LAND SURVEYOR, TO ALTER AN ITEM IN ANY WAY. IF AN ITEM BEARING THE STAMP OF A LICENSED PROFESSIONAL IS ALTERED, THE ALTERING ENGINEER, ARCHITECT, LANDSCAPE ARCHITECT, OR LAND SURVEYOR SHALL STAMP THE DOCUMENT AND INCLUDE THE NOTATION "ALTERED BY" FOLLOWED BY THEIR SIGNATURE, THE DATE OF SUCH ALTERATION, AND A SPECIFIC DESCRIPTION OF THE ALTERATION.

DRAWING TITLE
CONSTRUCTION SAFETY AND PHASING PLAN

DRAWING NUMBER
CS-01

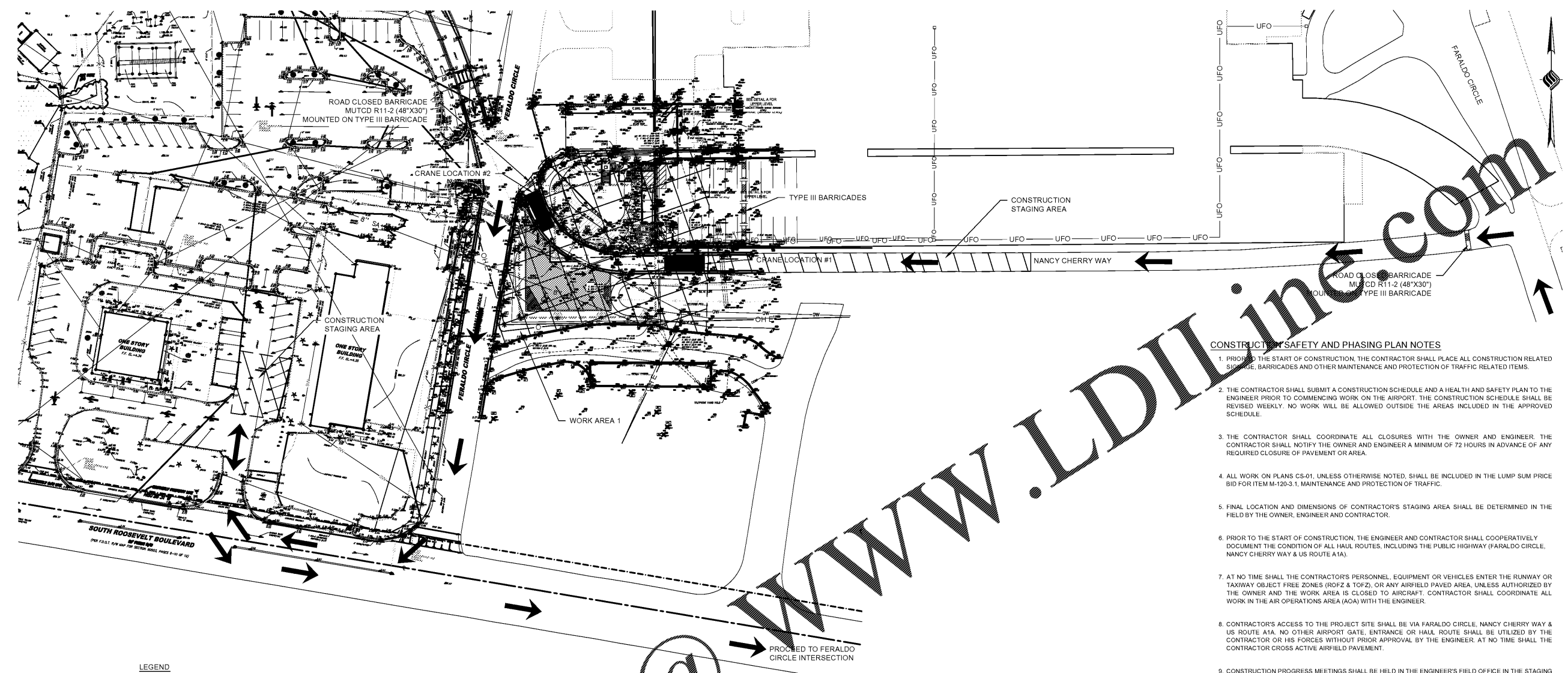

CONSTRUCTION SAFETY AND PHASING PLAN NOTES

- PRIOR TO THE START OF CONSTRUCTION, THE CONTRACTOR SHALL PLACE ALL CONSTRUCTION RELATED SIGNAGE, BARRICADES AND OTHER MAINTENANCE AND PROTECTION OF TRAFFIC RELATED ITEMS.
- THE CONTRACTOR SHALL SUBMIT A CONSTRUCTION SCHEDULE AND A HEALTH AND SAFETY PLAN TO THE ENGINEER PRIOR TO COMMENCING WORK ON THE AIRPORT. THE CONSTRUCTION SCHEDULE SHALL BE REVISED WEEKLY. NO WORK WILL BE ALLOWED OUTSIDE THE AREAS INCLUDED IN THE APPROVED SCHEDULE.
- THE CONTRACTOR SHALL COORDINATE ALL CLOSURES WITH THE OWNER AND ENGINEER. THE CONTRACTOR SHALL NOTIFY THE OWNER AND ENGINEER A MINIMUM OF 72 HOURS IN ADVANCE OF ANY REQUIRED CLOSURE OF PAVEMENT OR AREA.
- ALL WORK ON PLANS CS-01, UNLESS OTHERWISE NOTED, SHALL BE INCLUDED IN THE LUMP SUM PRICE BID FOR ITEM M-120-3.1, MAINTENANCE AND PROTECTION OF TRAFFIC.
- FINAL LOCATION AND DIMENSIONS OF CONTRACTOR'S STAGING AREA SHALL BE DETERMINED IN THE FIELD BY THE OWNER, ENGINEER AND CONTRACTOR.
- PRIOR TO THE START OF CONSTRUCTION, THE ENGINEER AND CONTRACTOR SHALL COOPERATIVELY DOCUMENT THE CONDITION OF ALL HAUL ROUTES, INCLUDING THE PUBLIC HIGHWAY (FARALDO CIRCLE, NANCY CHERRY WAY & US ROUTE A1A).
- AT NO TIME SHALL THE CONTRACTOR'S PERSONNEL, EQUIPMENT OR VEHICLES ENTER THE RUNWAY OR TAXIWAY OBJECT FREE ZONES (OZF & TOFZ), OR ANY AIRFIELD PAVED AREA, UNLESS AUTHORIZED BY THE OWNER AND THE WORK AREA IS CLOSED TO AIRCRAFT. CONTRACTOR SHALL COORDINATE ALL WORK IN THE AIR OPERATIONS AREA (AOA) WITH THE ENGINEER.
- CONTRACTOR'S ACCESS TO THE PROJECT SITE SHALL BE VIA FARALDO CIRCLE, NANCY CHERRY WAY & US ROUTE A1A. NO OTHER AIRPORT GATE, ENTRANCE OR HAUL ROUTE SHALL BE UTILIZED BY THE CONTRACTOR OR HIS FORCES WITHOUT PRIOR APPROVAL BY THE ENGINEER. AT NO TIME SHALL THE CONTRACTOR CROSS ACTIVE AIRFIELD PAVEMENT.
- CONSTRUCTION PROGRESS MEETINGS SHALL BE HELD IN THE ENGINEER'S FIELD OFFICE IN THE STAGING AREA, UNLESS OTHERWISE ARRANGED.
- ALL COSTS ASSOCIATED WITH THE PREPARATION, SET UP, TEAR DOWN AND RESTORATION OF THE CONTRACTOR'S STAGING AREA, INCLUDING FENCE, SHALL BE INCLUDED IN THE LUMP SUM PRICE BID FOR MOBILIZATION, ITEM M-100-5.1.
- THE CONTRACTOR SHALL STRIP AND STOCKPILE TOPSOIL WITHIN THE WORK AREA, FOR USE IN SITE RESTORATION AT THE CONCLUSION OF CONSTRUCTION. TOPSOIL STOCKPILES SHALL BE TEMPORARILY SEEDED AND EROSION AND SEDIMENT CONTROL MEASURES PLACED AROUND THE TOPSOIL STOCKPILES.
- THE CONTRACTOR'S ATTENTION IS DIRECTED TO, AND THE CONTRACTOR SHALL FULLY ADHERE TO, APPENDIX A OF THE CONTRACT DOCUMENTS, FEDERAL AVIATION ADVISORY CIRCULAR 150/5370-2G, OPERATIONAL SAFETY ON AIRPORTS DURING CONSTRUCTION.

PROJECT PHASING

- THE CONTRACT TIME OF COMPLETION FOR ALL WORK SHALL BE:
270 CALENDAR DAYS FROM THE DATE ON THE NOTICE TO PROCEED
- THE WORK OF THE CONTRACT SHALL BE PERFORMED IN ONE SINGLE WORK AREA AND SHOULD HAVE NO INTERFERENCE WITH AIRPORT OPERATIONS.
- THE CONTRACTOR SHALL PROVIDE THE ENGINEER WITH 14 DAYS ADVANCE NOTICE IN WRITING PRIOR TO THE START OF CONSTRUCTION, TO ALLOW FOR THE APPROPRIATE COORDINATION WITH FAA AND NOTIFICATION OF AIRPORT BUSINESSES AND TENANTS.
- A THREE (3)-DAY NOTICE IS REQUIRED FOR ISSUANCE OF NOTICES TO AIRMEN (NOTAMS) FOR THE WORK AREA. NOTAMS WILL BE ISSUED BY THE AIRPORT OWNER AND MANAGEMENT.
- DAYTIME WORK HOURS: 7:00 A.M. - 5:00 P.M. MONDAY - FRIDAY.
- THE CONTRACTOR SHALL PROVIDE ADEQUATE EQUIPMENT ON SITE TO CONTINUOUSLY MAINTAIN THE CONSTRUCTION HAUL ROUTE. ALL PUBLIC ROADWAYS SHALL BE INSPECTED AND CLEANED PRIOR TO THE CONTRACTOR LEAVING THE SITE ON A DAILY BASIS, OR AS ORDERED BY THE ENGINEER.
- THE CONTRACTOR SHALL MAINTAIN ACCESS ON ALL PUBLIC ROADS THROUGHOUT THE PROJECT. THIS SHALL INCLUDE ACCESS FOR AIRPORT EMPLOYEES, LAW ENFORCEMENT AND AIRPORT MAINTENANCE.
- LIQUIDATED DAMAGES: REFER TO SPECIAL PROVISIONS, PAGE IV-28, FOR BREAKDOWN.

LEGEND

	ORANGE CONSTRUCTION FENCE
	EXISTING CHAINLINK FENCE
	CONSTRUCTION FENCE
	CONTRACTOR'S HAUL ROUTE
	CONTRACTOR'S STAGING AREA
	WORK AREA I (ONLY WORK AREA)
	ROADWAY CLOSURE BARRIER
	ESTIMATED CRANE LOCATION

AIRPORT COMMUNICATIONS:
 RADIO FREQUENCY:
 CTA: 118.2
 UNICOM: 123.95
 ATIS: 136.675
 GROUND: 219.0700-2100
 TOWER: 118.2 257.8(0700-2100)
 ASC (WEATHER): (305) 292-4046
 AIRPORT MANAGER: (305) 292-3578
 CONTRACT TIME OF COMPLETION: XX DAYS

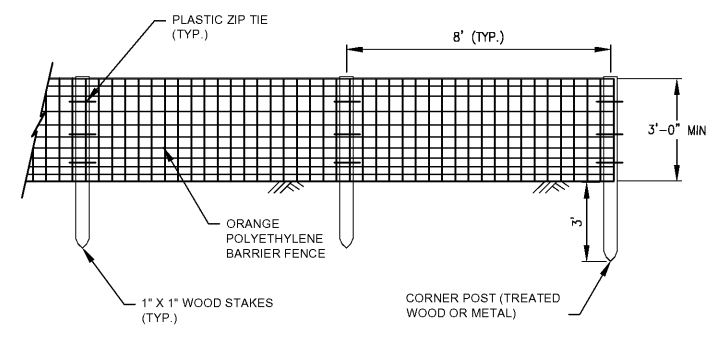

- NOTES:**
- CONTRACTOR SHALL PLACE FENCE IN THE LOCATIONS SHOWN ON THE PLANS OR AOB/E
 - CONTRACTOR SHALL INSPECT FENCE ON A DAILY BASIS AND SHALL REPAIR/REPLACE ANY DAMAGED SECTIONS AS REQUIRED OR AOB/E
 - IF REQUIRED, THE CONTRACTOR SHALL ADJUST THE PLACEMENT OF THE FENCE AS REQUIRED BY THE SEQUENCE OF WORK

2 CONSTRUCTION FENCE DETAIL
 NOT TO SCALE
 INCLUSIVE TO ITEM
 M-120-3.1

WORK AREA	DESCRIPTION OF WORK	OPERATIONAL IMPACTS	MPT MEASURES	LIMITATIONS/DURATION
I	- MOBILIZATION - CONSTRUCTION STAGING AREA - SURVEY & STAKEOUT - CONSTRUCTION FENCE - CLOSE NANCY CHERRY WAY - CONSTRUCT PARKING STRUCTURE - CONSTRUCT/MOVE UTILITIES - UNCLASSIFIED EXCAVATION - PARKING AREA INSTALLATION - TOPSOILING - PERFORMANCE TURF	- NONE: ALL WORK IS OUTSIDE OF TSA LIMITS AND A.O.A.	- STOP SIGN - CONSTRUCTION SILT FENCE	270 CALENDAR DAYS

