

RECEIVED
MAR 21 2018
1716 EAST SUNSHINE, SUITE 417
SPRINGFIELD, MISSOURI 65802

COMMONWEALTH OF VIRGINIA
JEFFREY S. SMITH
Lic. No. 18070

417-862-0558
417-862-3265
e-mail: architect@esterfischneider.com

CRAIG A. SCHNEIDER, AIA
ARCHITECT

1716 East Sunshine, Suite 417
Springfield, Missouri 65802

PROJECT:
NEW O'REILLY AUTO PARTS STORE
290 DEACON ROAD
FREDERICKSBURG, VA #4

FRAMING DETAILS

O'Reilly AUTO PARTS
CORPORATE OFFICES
293 SOUTH PATTERSON
SPRINGFIELD, MISSOURI 65802
(417) 862-2674 TELEPHONE

COMM # 4251
DATE: 11-2-18
REVISION
DATE: 3-25-19

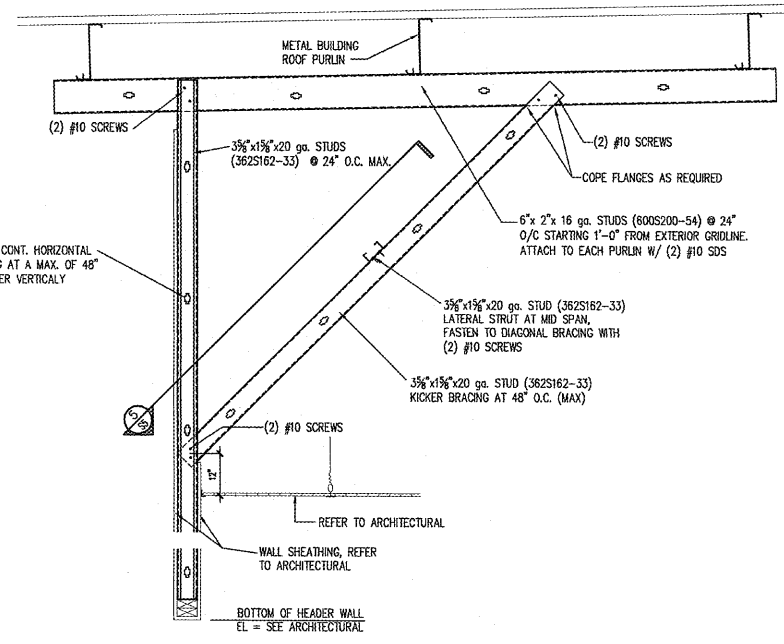

1 SECTION
S5 SCALE: 3/4" = 1'-0"

L 4x4x3/8"x1'-0" @ EACH PURLIN (FURNISHED BY CONTRACTOR UNDER SECTION 05 50 00 OF THE PROJECT MANUAL SPECIFICATIONS). ATTACH ANGLE TO PURLIN WEB W/ (2) 1/2" A307 BOLT.

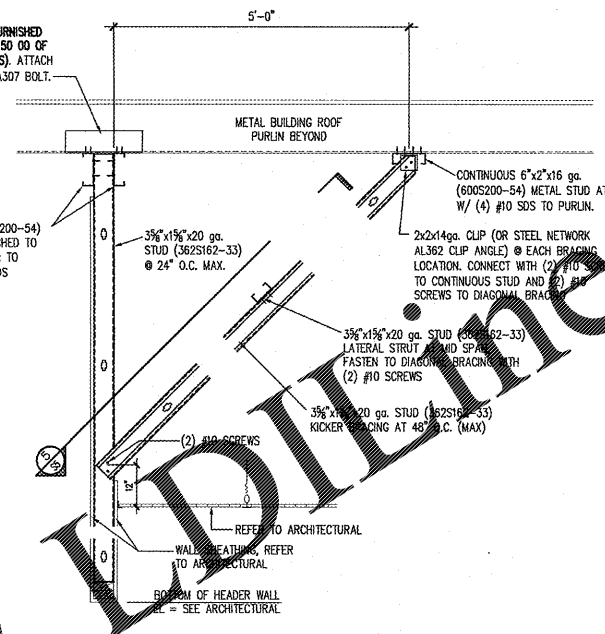

2 SECTION
S5 SCALE: 3/4" = 1'-0"

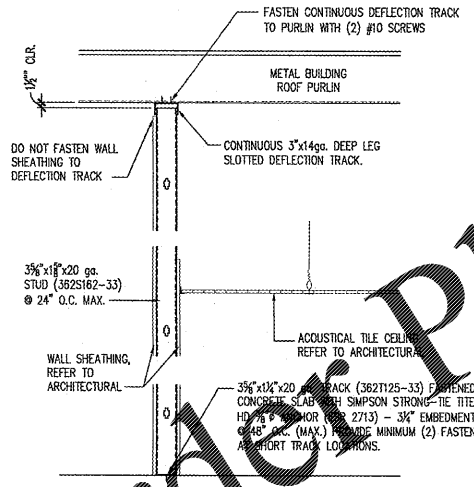

3 SECTION
S5 SCALE: 3/4" = 1'-0"

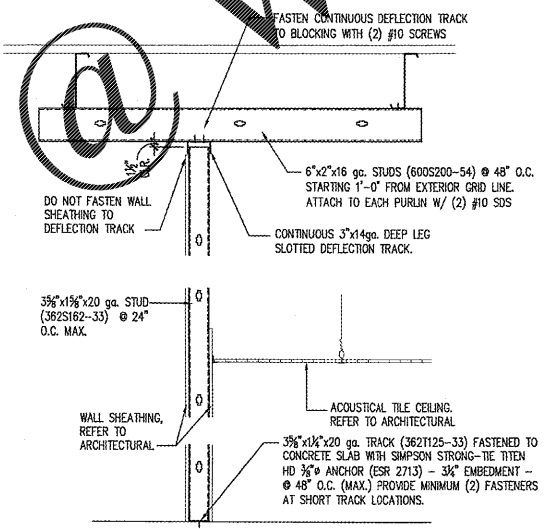

4 SECTION
S5 SCALE: 3/4" = 1'-0"

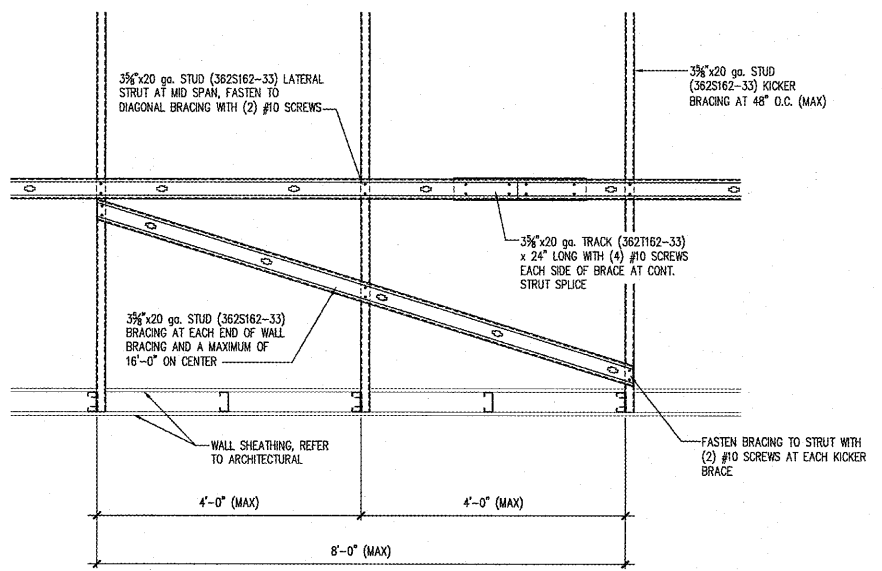

5 SECTION
S5 SCALE: 3/4" = 1'-0"

Order Plans

WWW.LDLINE.COM



Jeffrey S. Smith, P.E.
Jeffrey S. Smith P.E. 018070
P.O. Box 8102 * JOPLIN, MISSOURI 64802
PHONE: 417-824-0444 * FAX: 417-824-0430